

CALIFORNIA STATE COLLEGE, DOMINGUEZ HILLS

1971-72 CLASS SCHEDULE

FOURTH EDITION

(SPRING ONLY)

NOTE: All classes listed in this schedule are subject to cancellation if pre-enrollment does not reach the following levels:

Lower Division Courses - - - -	13
Upper Division Courses - - - -	10
Graduate Courses - - - - - - -	5

CALIFORNIA STATE COLLEGE, DOMINGUEZ HILLS
 1000 East Victoria Street
 Dominguez Hills, California 90246

When referring to the 1971-72 Class Schedules, please check the below codes for pertinent information concerning specific classes.

GENERAL NOTES:

1. Unless otherwise specified, classes will meet for a 50-minute duration beginning at the time shown.
2. Where class sections are indented, they represent sub-sections of a course. Students enrolling in such courses should note that enrollment in one each of the lecture and laboratory or discussion sub-sections is mandatory.

SPECIAL NOTES:

- A - Plus additional time to be arranged.
- B - To be cancelled if enrollment does not equal six or more.
- C - With field work and/or lab to be arranged.
- D - English 210/French 210/Spanish 210, the same class.
- E - With consent of instructor.
- F - Graduate standing and with consent of instructor.
- G - A simulated society will be conducted as part of the class.
- H - Senior standing and consent of instructor.
- I - See new or revised course description.
- J - Students should register for one discussion section as well as for lecture.
- K - Students in Section 1 should register for one discussion with one lab (sections 1 or 2) in addition to lecture.
- L - Consent of instructor and departmental approval.
- M - Students in Section 2 should register for one discussion with one lab (sections 3 or 4) in addition to lecture.
- N - Each student enrolling in H. & P.E. 101 must pay a \$10.00 fee which is used for off-campus facilities in bowling and golf, and for towel and clothing rental in all other sections.
- O - Saturday field trips to be arranged.
- P - Political Science 292, Special Topics in Political Science (Winter Quarter) is prerequisite to Political Science 292, Special Topics in Political Science (Spring Quarter).
- Q - Will emphasize music reading and theory.
- R - In Biology 210, students in lecture 1 must be in lab 1 or 3; and students in lecture 2 must be in lab 2.
- S - Times for each student will be arranged within the indicated periods.
- T - In Biology 214, students in lecture 1 must be in lab 1 or 3; and students in lecture 2 must be in lab 2.
- U - Times for each student will be arranged within the indicated periods, and additional time will be arranged for students enrolled for 4 units credit.
- V - Graduate standing and consent of Institute of Education.
- * - Upper division music majors, advanced in piano, and with consent of instructor.
- ** - Primarily for music majors or students with considerable prior piano experience. Others with consent of instructor.
- *** - Music and Theater Arts majors only; others with consent of instructor.
- **** - Primarily for music majors. Others only with consent of instructor.

CALIFORNIA STATE COLLEGE, DOMINGUEZ HILLS
FINAL EXAMINATION SCHEDULE (Revised)
WINTER AND SPRING QUARTERS 1971-72

1. Classes whose first or only weekly lecture class meeting is Monday, Wednesday or Friday are considered M classes.
2. Classes whose first or only weekly lecture class meeting is Tuesday or Thursday are considered T classes.
3. Classes starting on or within a specific hour are designated by that hour.
4. Exams will be held in the regular classroom, except for classes which meet only once a week on Wednesday, Thursday, or Friday. For such classes, a different room assignment will be announced by the instructor.
5. Any conflicts should be reported to the instructors involved.

<u>Class</u>	<u>Exam Time</u>	<u>Exam Day-Winter</u>	<u>Exam Day-Spring</u>
M-8 a.m.	8:00-10:00 a.m.	Tuesday, March 14	Monday, June 12
M-9	8:00-10:00 a.m.	Wednesday, March 15	Tuesday, June 13
M-10	8:00-10:00 a.m.	Thursday, March 16	Wednesday, June 14
M-11	8:00-10:00 a.m.	Friday, March 17	Thursday, June 15
M-12	10:30 a.m.-12:30 p.m.	Tuesday, March 14	Monday, June 12
M-1 p.m.	10:30 a.m.-12:30 p.m.	Wednesday, March 15	Tuesday, June 13
M-2	10:30 a.m.-12:30 p.m.	Thursday, March 16	Wednesday, June 14
M-3	10:30 a.m.-12:30 p.m.	Friday, March 17	Thursday, June 15
M-4	6:00-8:00 p.m.	Tuesday, March 14	Monday, June 12
M-6	6:00-8:00 p.m.	Wednesday, March 15	Tuesday, June 13
M-8 p.m.	6:00-8:00 p.m.	Thursday, March 16	Wednesday, June 14
T-8 a.m.	1:00-3:00 p.m.	Friday, March 17	Thursday, June 15
T-9	1:00-3:00 p.m.	Thursday, March 16	Wednesday, June 14
T-10	1:00-3:00 p.m.	Wednesday, March 15	Tuesday, June 13
T-11	1:00-3:00 p.m.	Tuesday, March 14	Monday, June 12
T-12	3:30-5:30 p.m.	Friday, March 17	Thursday, June 15
T-1 p.m.	3:30-5:30 p.m.	Thursday, March 16	Wednesday, June 14
T-2	3:30-5:30 p.m.	Wednesday, March 15	Tuesday, June 13
T-3	3:30-5:30 p.m.	Tuesday, March 14	Monday, June 12
*T-4	8:30-10:30 p.m.	Wednesday, March 15	Tuesday, June 13
*T-6	8:30-10:30 p.m.	Thursday, March 16	Wednesday, June 14
*T-8	8:30-10:30 p.m.	Tuesday, March 14	Monday, June 12

*Indicates Revision

A time in the college calendar is set aside for final examinations because most professors use them for student evaluation. This period is a regular part of the college quarter, and a professor may prefer to use it for another form of evaluation.

ANSWERS TO YOUR QUESTIONS

Where to Find Them

<u>SUBJECT OF QUESTIONS</u>	<u>WHOM TO SEE</u>	<u>ROOM NUMBER</u>	<u>EXTENSION</u>
Address Change	Admissions & Records	Window J-103C	304
Advisor, Assignment of:			
Undeclared Major	Counseling Center	I-102D	224
Declared Majors	Major Departments	
Aptitude Tests	Counseling Center	I-102D	224
Commencement	Assitant to President	M-145	254
Concurrent Enrollment	Admissions & Records	Window J-103C	217
Counseling:			
Vocational	Counseling Center	I-102D	224
Personal	Counseling Center	I-102D	224
Financial Aid	Financial Aids Office	I-102	224
Degree Application	Admissions & Records	Window J-103C	217
Disqualification	Admissions & Records	Window J-103C	208
Draft Information	Admissions & Records	Window J-103C	302
Economic Opportunity Program	E.O.P. Office	W-100C	307
Emergency Messages	Dean of Students	J-103A	221
Employment:			
Business, Industrial, Government Placement Office	224
Student (part-time)	Placement Office	224
Teacher and Education	Placement Office	224
Enrollment Verification	Admissions & Records	Window J-103C	208
Entrance Examinations	Testing Center	I-102	224
Excess Unit Requests	Advisers	
Fees:			
Payment of	See Registration Procedures	
Refund Application	Business Office	Cashier's Window	300
Financial Aid	Financial Aids Office	I-102	224
Foreign Students:			
Advising	Counseling Center	I-102D	310
Admission Status	Admissions & Records	Window J-103C	217
Graduate Requirements	Admissions & Records	Window J-103C	217
Health Insurance	Health Center.	W-102	228
Housing Off-Campus	Student Activities	W-122	218
Loans	Financial Aids Office	I-102	224

NOTICE: Many Room, Building, and Phone Changes will be made during the Winter and Spring Quarters, as the new buildings become available.

<u>SUBJECT OF QUESTION</u>	<u>WHOM TO SEE</u>	<u>ROOM NUMBER</u>	<u>EXTENSION</u>
Health Services	Health Center	W-102	228
International Programs	Marshall Bialosky, Advisor	D-145	293
Name Change	Admissions & Records	Window J-103C	304
Organizations and Clubs	Student Activities	W-122	218
Probation, Academic	Admission & Records	Window J-103C	208
Program Changes	Admissions & Records	Window J-103C	304
Readmission	Admissions & Records	Window J-103C	208
Recruiting:			
Industrial	Placement Office		224
Military	Placement Office		224
Educational	Placement Office		224
Selective Service Information	Admissions & Records	Window J-103C	302
Scholarships	Counseling Center	I-102D	310
Student Activities Card (Duplicate)	Admissions & Records	Window J-103C	304
Student Government	Student Activities	W-122	218
Summer School	Summer Session Office	M-110	254
Teacher Placement	Placement Office		224
Teaching Credentials:			
Application	Institute of Teacher Education	SBS-A226	268
Information on Elementary	Institute of Teacher Education	SBS-A226	268
Information on Secondary	Institute of Teacher Education	SBS-A226	268
Test Information	Testing Center		224
Transcripts	Admissions & Records	Window J-103C	304
Transferred Units, Evaluation of	Admissions & Records	Window J-103C	209
Veteran Affairs	Admissions & Records	Window J-103C	302
Withdrawal from School or Classes	Admissions & Records	Window J-103C	208
Xerox Services (student)	Library	G-120	351

Pass/No Credit Option - Students selecting the Pass/No Credit option must do so by the end of the second week of instruction of the quarter. For additional conditions and limitations of the Pass/No Credit option, consult the college catalog for 1971-72.

GENERAL INFORMATION

Admission

Prospective students, whether for part-time or full-time programs of study, must file an application for admission and other supporting documents within the announced filing period. To enroll in classes, applicants must be formally admitted to the college for that quarter. Procedures for admission are published in the College Catalog. Application forms may be obtained from the Office of Admission and Records (J-103C).

Health Clearance

A physical examination and health interview are required to each new student prior to registration. These should be completed prior to the time of registration. Students will not be allowed to pick up registration materials until they have secured health clearance from the Health Office (Room W-102).

Advising

New students are assigned academic advisors during the orientation/registration period for their first quarter of attendance. Each student is responsible for maintaining his own personal copies of college transcripts for advising purposes and should take these transcripts with him when meeting with an advisor. Students should consult their advisor when planning their program of study. An advisor's signature is required on the Course Request for new students.

Concurrent Enrollment

A student enrolled at the college may enroll concurrently for additional courses at another institution only by filing a PETITION FOR CONCURRENT ENROLLMENT with the Office of Admissions and Records (J-103C) after securing written approval from their academic advisor. Permission will not be granted when the study list in the proposed combined program exceeds the units authorized at this college for full-time study.

REGISTRATION

Each student registers in the California State College, Dominguez Hills, at times scheduled for this purpose. Early registration by mail is available to continuing students and those new students admitted early in the admissions cycle. New students eligible for early registration will be notified by mail: others register in person. Registration covers filling out official cards, enrolling in courses, paying fees, and receiving a REGISTRATION/STUDENT ACTIVITY card.

The continuing student should consult the academic calendar, official bulletin boards and student newspaper for information regarding early registration schedules.

CLOSED CLASSES

During registration a number of classes close and not all students are able to obtain either a complete program or the most desired. Outlined below are some suggestions which should enable almost all students to resolve the difficulties created by closed courses or sections:

1. ADDED COURSES ON BULLETIN BOARD. Check the bulletin board outside the Office of Admissions and Records for added courses. There may be a course which could be added to your program to fulfill degree major or elective requirements.
2. ALTERNATE SECTIONS. Check the CLASS SCHEDULE to see if there are other sections of the same course available at different times.
3. ALTERNATE COURSES. Consider alternate courses which could be substituted this quarter in place of the original course preference.
4. WAITING LIST. Ask to be placed on a waiting list for closed course. Departmental or interdepartmental offices maintain waiting lists for closed courses. Upon request you will be added to the waiting list. As spaces become available because of other students dropping or withdrawing once the quarter has begun, students on the waiting list are allowed to add the course.
5. FIRST CLASS MEETING. Go to the first scheduled meeting of a closed class. Students who do not attend the first meeting of a course are dropped by the instructor.
6. CONSULT ADVISOR. If, after considering all of the above alternatives, you still have less than the number of units in which you wished to be enrolled, seek the help of your advisor. He may be able to suggest alternatives that have been overlooked.

One final point to remember is this: The closer you are to graduation, the higher your priority for registration and thus chances for obtaining a complete program are greatly increased.

NEW PROCEDURE

To assist the college in providing course offerings more responsive to student needs, a new procedure is now available for students to request courses that are not scheduled. This is an experimental procedure, and the difficult financial problems of the college make it rather unlikely that more than one or two additional courses can be added each quarter. Nevertheless, if you would like to submit such a request, obtain a "Schedule Addition Request Form" from either the Bookstore or the Registrar's Office. Read the directions on the reverse of the form, fill it out, and deposit it at the Registrar's Office as soon as possible.

SCHEDULE OF REGISTRATION FEES

Tuition is not charged to legal residents of California. All students pay the regular fees shown below. Auditors pay the same fees as students registering for credit. All fees are subject to change by the Trustees of the California State Colleges.

Fees for each quarter are payable at the time of registration. No individual will be admitted to class prior to payment of registration fees.

APPLICATION FOR ADMISSION TO THE COLLEGE

Application Fee \$20.00

FEES REQUIRED AT REGISTRATION (per quarter)

Materials and Service Fee

0 to 3.9 units \$26.50
 4 to 7.9 units 30.00
 8 to 11.9 units 33.00
 12 or more units 39.00

Student Activity Fee

Students enrolling for 6 or less units 3.50
 Students enrolling for more than 6 units:
 Fall Quarter 10.00
 Winter and Spring Quarters 5.00

Facilities Fee - All Students 2.00

Non-resident Tuition Fee (in addition to the other Registration fees):

U.S. Citizens

Per unit or fraction thereof 25.00
 Maximum charge - 15 units or more 370.00
 Per academic year 1,110.00

Parking Fees:

All students	\$ 9.00
Alternate vehicle (evidence of ownership of vehicle must be presented)	1.00
Two-wheeled motorized vehicles	2.25

OTHER FEES

Late Registration (payable the day instruction begins)	5.00
Failure to meet administratively required time limit or appointment	2.00
Check returned for any cause	2.00
Items lost or broken	cost
Transcript of Record	1.00
Library books and other library items	Cost+1.00
Diploma fee	4.00

REFUND OF FEES

Refunds are not automatic. Applications for refund of fees are obtained from the Cashier and must be filed in the Office of Admissions and Records within the time limits specified. Applications received by the Registrar on or before the first day of instruction of each quarter are considered as having an effective date of the first day of instruction of that quarter.

Penalty fees (unless collected in error), the Late Registration Fee, and the Facilities Fee are not refundable.

Materials and Service Fee

To be eligible for partial refund, a student who is withdrawing from the college must file a refund petition with the Registrar not later than 14 days after the first day of instruction. \$10.00 will be retained by the college to cover the cost of registration.

Non-Resident and Foreign Tuition Fee

If the refund petition is filed with the Registrar before or during the first week of the quarter, 100% of the tuition fee will be refunded; during the second week of the quarter, 75%; during the third week of the quarter, 50%; during the fourth week of the quarter, 25%.

Parking Fee

Petitions for refund of the Parking Fee must be filed with the Campus Security Office. If the petition is filed before or during the first 25 calendar days of the quarter, 66% of the Parking Fee will be refunded; from the 26th to the 50th calendar days of the quarter, 33%; on or after the 51st calendar day, 0%.

Consult the Business Office of the college for further information.

GENERAL REGULATIONSExcess Units

For undergraduate students in good academic standing, the normal program load is the equivalent of four full courses (16 units). To this may be added activity courses having a value of one-half course or less. A student may enroll for more than 18 units by securing the written approval of his academic advisor on his program card prior to submitting his registration materials.

First Class Meeting

You should report to the first meeting of your scheduled classes. Classes begin on Wednesday, March 29, 1972. Check the Schedule of Classes for room numbers. You are responsible for attendance in the courses and specific sections in which you have enrolled.

Students who enroll in a class but do not attend its first scheduled class meeting and do not contact the instructor beforehand WILL BE AUTOMATICALLY DROPPED BY THE INSTRUCTOR from the class and their place given to waiting students who were unable to enroll at the time of registration.

Change of Program

A change-of-program after registration is any change that is made in a student's official study list. Such a change includes: dropping a class, adding a class, changing the number of units for a class in which the student is registered, changing the section of the same course.

A change-of-program must be made before the deadline date listed for each quarter in the official college calendar. Students are provided with a set of DROP/ADD cards. Additional forms may be obtained from the Registrar. No change is effective until the change-of-program form has been filed with the Registrar. If a student officially drops a class by the end of the third week of instruction, the course will not be recorded on the student's permanent record. If a class is dropped beginning the fourth week and through the eighth week of instruction, a grade of W or NC shall be assigned. Refer to the college catalog (p. 173) for details of dropping a class after the eighth week of instruction.

Official Withdrawal from the College

Students who wish to withdraw from the college are urged to consult the Dean of Students prior to official withdrawal. Official withdrawal is necessary if a student leaves the college at any time after registration and does not intend to complete the quarter. The forms for initiating this process may be obtained from the Office of Admissions and Records.

When official withdrawal from the college occurs before the quarterly deadline for dropping classes (the third week of instruction), there is no academic penalty. However, if official withdrawal occurs after the third week of instruction, different procedures must be followed. (See page 173 of 1971-72 catalog.)

Conditions for readmission shall be clearly indicated on the withdrawal form. A student who withdraws under satisfactory conditions shall be classified as a continuing student for the next quarter.

Credit by Examination

If a student in residence and in good standing has had preparation in a given subject because of unusual opportunities and feels that he has covered the content of a course, he may contact the Office of the Dean of the appropriate School about credit by examination. If an examination is given, it will be comprehensive. A pass or fail grade will be assigned and will become part of the student's permanent record. Courses by examination will not count toward residence requirements of the college.

Auditors

Auditors must register in the usual way and pay the same fees as would be charged if the courses were taken for credit. Enrollment as an auditor is subject to approval of the instructor; a student registered as an auditor may be required to participate in any or all classroom activities at the discretion of the instructor. Credit for courses audited will not be granted on the basis of the audit. No record of audit appears on the student's permanent record card nor are transcripts issued for audited courses.

A student who wished to audit a course in addition to his regular program must obtain the approval of the instructor and pay the fees required as if the course were taken for credit.

An audited course should be taken into consideration when planning a program so that the study load will not be excessive.

SELECTIVE SERVICE

Selective Service information is available at the Office of Admissions. Students subject to Selective Service should keep their local boards informed of all situations which might affect their draft classification.

Verification of enrollment in full-time programs will be submitted to the Selective Service Boards by the Office of Admissions. Any change of status during the quarter, such as dropping courses or withdrawal, will be reported to the Local Board by the Office of Admissions.

An undergraduate student must be enrolled in sufficient units per quarter to complete requirements for the degree in the normal time of 12 quarters.

DEGREE CANDIDATES

Candidates for a baccalaureate degree must file an application for graduation by the end of the first week of classes of the second quarter of the senior year, in accordance with the following schedule:

Fall Quarter for March graduation
Winter Quarter for June graduation
Spring Quarter for Summer graduation
Spring Quarter for December graduation

Candidates for master's degrees must file an application for graduation by the end of the first week of classes of the final quarter.

All applications must be filed in the Office of Admissions and Records. A change in graduation date may be reported by filing the necessary form with the Admissions and Records. (Degree checks remain valid while the student is in continuous attendance at the college even though the graduation date has been changed.)

GRADUATING SENIORS WHO PLAN TO CONTINUE INTO GRADUATE STATUS

Students who plan to graduate in March 1972 and intend to continue at Dominguez Hills as graduate-level students for the Spring Quarter 1972, are required to file a NOTICE OF INTENTION TO REGISTER AS A GRADUATE STUDENT. This notice is in the form of a card which should be picked up at the Office of Admissions and Records and returned with the registration materials for the Spring Quarter 1972.

CHANGE OF NAME OR ADDRESS

If you have made a change of name or address which has not been reported to the Office of Admissions and Records, please come to the Office of Admissions and Records and request the CHANGE OF ADDRESS form. It is very important that the Office of Admissions and Records is informed of any change, so that you will receive all mailings.

Watt Campus, also known as Stevenson Village, and also known as old campus.

Small College Campus, also known as new campus.

Social and Behavioral Sciences Building.

Library, also known as Educational Resources Center, and sometimes also called Administration Building.

Field House.

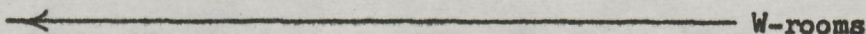
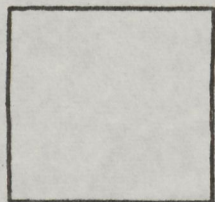

Victoria Street

N

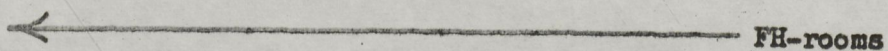
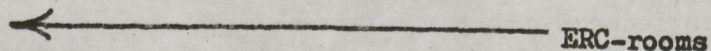
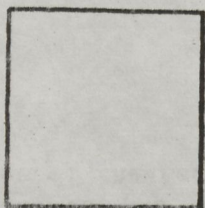
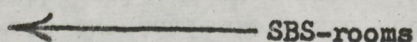
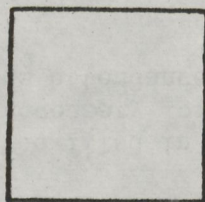
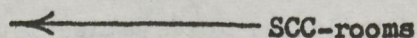
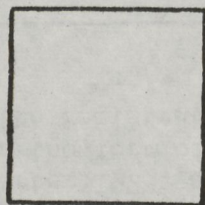
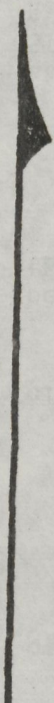

<u>Code No.</u>	<u>Department and Number</u>	<u>Title</u>	<u>Sec.</u>	<u>Instructor</u>	<u>Foot- notes</u>	<u>Days</u>	<u>Hours</u>	<u>Units</u>	<u>Bldg/Room*</u>
<u>AFRO-AMERICAN STUDIES</u>									
8600	290	Seminar in Afro-American Studies	1	Eleazu	E	WF	11:00-12:40	4	SCC-E143
<u>AMERICAN BUSINESS & ECONOMIC SYSTEMS</u>									
9100	290	Seminar in American Business & Economic Systems	1	Miles	E	MW	12:00-1:40	4	SBS-E026
<u>AMERICAN STUDIES</u>									
4900	290	Seminar in American Studies	1	Garber	E	MF	10:00-11:40	4	SBS-B010
4901	290	Seminar in American Studies	2	Vaughn	E	MWThF	2:00	4	W248
4902	290	Seminar in American Studies	3	Garber	E	TTh	4:00-5:40	4	SCC-E143
4903	290	Seminar in American Studies	4	Smith	E	W	12:00-1:40	4	SBS-A132
						MF	1:00		
<u>ANTHROPOLOGY</u>									
7700	110	Cultural Anthropology	1	Kuykendall		TWThF	8:00 am	4	SBS-D125
7701	200	Basic Studies Anthropology	1	Eggers		TTh	2:00-3:40	4	SBS-D125
7702	212	Language & Culture	1	Fenton		TTh	4:00-5:40	4	SBS-D125
7703	215	Ethnology of Religion	1	Kuykendall		TWThF	10:00	4	SBS-E026
7705	230	Indians of North America	1	Fenton		MW	4:00-5:40	4	SBS-G026
7706	232	Contemporary Cultures of Latin America	1	Pope		MWThF	10:00	4	SCC-F172
7707	235	Peoples of East Asia	1	Kuykendall		TWThF	9:00	4	SBS-E022
7708	238	Peoples of Sub-Saharan Africa	1	Eggers		MW	11:00-12:40	4	SBS-B001
7709	240	Social Anthropology	1	Fenton		MW	8:00-9:40pm	4	SBS-E026
7716	250	Archaeology & Prehistory	1	Eggers		MW	2:00-3:40	4	SCC-E167
7710	260	Folklore	1	Pope		MWThF	2:00	4	SBS-G026
7711	275	Field Studies	1	Kuykendall	C	F	11:00	4	SBS-E016
7712	285	Ethnological Theory	1	Givens		MW	3:00-4:40	4	SBS-B040
7713	292	Special Topics	1	Pope		MW	12:00-1:40	4	SBS-A104
7714	298	Independent Study	1		L	TBA	TBA	2	TBA
7715	298	Independent Study	2		L	TBA	TBA	4	TBA

*See Map page 12

<u>Code No.</u>	<u>Department and Number</u>	<u>Title</u>	<u>Sec.</u>	<u>Instructor</u>	<u>Foot- notes</u>	<u>Days</u>	<u>Hours</u>	<u>Units</u>	<u>Bldg/Room*</u>
<u>ART</u>									
1500	100	Basic Studies Art	1	Ivers		MTWF	8:00 am	4	ERC-D126
1501	100	" " "	2	Ivers		MTWF	12:00	4	ERC-D126
1502	100	" " "	3	Brown		MTWF	1:00	4	ERC-G149
1503	100	" " "	4	Harshman		MW	6:00-7:40	4	ERC-D126
1521	100	" " "	5	Harshman		TTh	4:00-5:40	4	ERC-D126
1505	175	Visual Elements Workshop	1	White	A	W	3:00-6:00	2	SCC-L149
1506	179	Beginning Drawing	1	White	A	Th	3:00-6:00	2	ERC-D131
1507	180	Painting & Drawing Workshop I	1	White	A	M	6:00-9:00	2	ERC-D131
1522	190	3-Dimensional Workshop	1	Goders	A	Sat	9:00-12:00	2	ERC-D134
1523	210	Art of Greece & Rome	1	Neuerburg		MWThF	9:00	4	ERC-D126
1508	220	Renaissance Art	1	Brown		MTWF	12:00	4	ERC-G149
1509	231	Twentieth Century Art	1	Toyoshima		MWThF	9:00	4	ERC-G149
1510	236	Oriental Art II	1	Toyoshima		MWThF	8:00 am	4	ERC-G149
1511	250	Amer. Art & Amer. Society	1	Ivers		MTWF	10:00	4	ERC-G149
1512	253	Art of California & the South- west	1	Neuerburg		MWThF	10:00	4	ERC-D126
1513	254	Afro-American Art	1	Booker		TTh	6:00-7:40	4	ERC-D126
1514	255	History of Urban Aesthetics	1	Janick		TTh	4:00-5:40	4	ERC-G149
1516	280	Painting & Drawing Workshop II	1	White	A	T	6:00-9:00	2	ERC-D131
1517	291	Special Studies in Art: Mannerism: Twilight of the Renaissance	1	Brown		MTWF	3:00	4	ERC-D126
1518	295	Seminar in Theories of Art Criticism	1	Harshman	H	MW	4:00-5:40	4	ERC-D126
1519	297	Directed Research	1	Neuerburg	H	TBA	TBA	4	TBA
1520	298	Independent Study	1	White	H	TBA	TBA	4	TBA

<u>Code No.</u>	<u>Department and Number</u>	<u>Title</u>	<u>Sec.</u>	<u>Instructor</u>	<u>Foot- notes</u>	<u>Days</u>	<u>Hours</u>	<u>Units</u>	<u>Bldg/Room*</u>
<u>BEHAVIORAL SCIENCES</u>									
6000	290	Seminar in Behavioral Sciences	1	Ryave	E	MW	9:00-10:40	4	SBS-BO43
6001	290	" " "	2	Shellberg	E	TTh	9:00-10:40	4	SBS-B138
6002	290	" " "	3	Stephens	E	WF	11:00-12:40	4	SBS-B138
6003	290	" " "	4		E	MF	12:00-1:40	4	SBS-B131
6004	290	" " "	5	Givens	E	TTh	3:00-4:40	4	SBS-A110
6005	290	" " "	6	Simon	E	MW	6:00-7:40	4	SBS-G026
6006	410	Seminar in Theory	1		F	TTh	6:00-7:40	4	SBS-E016
6007	416	Studies in Research Literature	1		F	MW	6:00-7:40	4	SBS-E016
6008	420	Critique of Programs & Practices	1	Paulhe	F	TTh	4:00-5:40	4	SBS-E016
6009	440	Seminar in Applied Behavioral Sciences	1		F	TTh	8:00-9:40pm	4	SBS-E016
6010	497	Directed Research	1		F	TBA	TBA	2	TBA
6011	497	Directed Research	2		F	TBA	TBA	4	TBA
6012	498	Directed Reading	1		F	TBA	TBA	2	TBA
6013	498	Directed Reading	2		F	TBA	TBA	4	TBA
6014	499	Thesis	1		F	TBA	TBA	1	TBA
6015	499	"	2		F	TBA	TBA	2	TBA
6016	499	"	3		F	TBA	TBA	3	TBA
6017	499	"	4		F	TBA	TBA	4	TBA
6018	499	"	5		F	TBA	TBA	5	TBA
6019	499	"	6		F	TBA	TBA	6	TBA
6020	499	"	7		F	TBA	TBA	7	TBA
6021	499	"	8		F	TBA	TBA	8	TBA
6022	499	"	9		F	TBA	TBA	9	TBA
5033	Psychology 440	Seminar in Social Psychology	1	Shellberg	F	TTh	4:00-5:40	4	W248
8342	Sociology 450	Seminar in Interaction Processes	1	Paulhe	F	MW	8:00-9:40pm	4	SBS-E016

<u>Code No.</u>	<u>Department and Number</u>	<u>Title</u>	<u>Sec.</u>	<u>Instructor</u>	<u>Foot- notes</u>	<u>Days</u>	<u>Hours</u>	<u>Units</u>	<u>Bldg/Room*</u>
<u>BIOLOGY</u>									
5700	102	Basic Studies Biology (lec)	1	Morafka		MTW	10:00	4	SCC-E139
5701	102	Basic Studies Biology (lec)	2	Lydon		MWF	12:00	4	SCC-E139/D138
5702	102	Basic Studies Biology (lec)	3	Yu		TTh	4:00-5:15	4	SCC-E139/D138
5703	102	Basic Studies Biol. (lab)	1			W	9:00-11:50	-	SCC-F158
5704	102	Basic Studies Biol. (lab)	2			W	1:00-3:50	-	SCC-F130
5705	102	Basic Studies Biol. (lab)	3	Lydon		T	8:00-10:50	-	SCC-E127
5706	102	Basic Studies Biol. (lab)	4	Colvin		F	8:00-10:50	-	SCC-E127
5707	102	Basic Studies Biol. (lab)	5			T	1:00-3:50	-	SCC-F150
5708	110	Principles of Biology (lec)	1	Brest		TWF	8:00	4	SCC-E139
5709	110	Principles of Biol. (lab)	1	Brest		M	9:00-11:50	-	SCC-F150
5710	114	Principles of Biology (lec)	1	Morafka		MTW	1:00	4	SCC-E139/D138
5711	114	Principles of Biol. (lab)	1	Morafka		Th	9:00-11:50	-	SCC-E127
5712	114	Principles of Biol. (lab)	2	Chi		Th	2:00-4:50	-	SCC-F150
5737	210	Organism Biology I (lec)	1	Brest		WF	10:00	4	SCC-D138
5738	210	Organism Biology I (lab)	1	Brest		WF	1:00-3:50	-	SCC-F150
5713	214	Developmental Biology (lec)	1	Arora	T	MW	12:00	4	SCC-E145
5714	214	Developmental Biology (lec)	2	Arora	T	TTh	10:00	4	SCC-D138
5715	214	Developmental Biol. (lab)	1	Arora	T	MW	1:00-3:50	-	SCC-E127
5716	214	Developmental Biol. (lab)	2	Arora	T	TTh	2:00-4:50	-	SCC-E127
5718	220	Cell Biology (lec)	1	Lydon		MW	8:00 am	4	SCC-D138
5719	220	Cell Biology (lab)	1	Lydon		MW	9:00-12:00	-	SCC-E127
5722	232	Ecology (lec)	1			TTh	6:00-7:15	4	SCC-F172
5723	232	Ecology (lab)	1			TTh	7:20-8:45	-	SCC-E127
5725	246	Human Heredity (lec)	1	Chi		MW	4:00-5:15	4	SCC-E139/D138
5726	246	Human Heredity (lab)	1	Chi		Th	9:00-11:50	-	SCC-F150
5727	252	Animal Physiology (lec)	1	Kalland		WF	1:00	4	SCC-E145
5728	252	Animal Physiology (lab)	1	Kalland		WF	9:00-11:50	-	SCC-F150
5735	256	Human Anatomy & Physiology (lec)	1	Colvin		MWTh	11:00	4	SCC-F166
5736	256	Human Anat. & Phys. (lab)	1	Colvin		M	1:00-3:40	-	SCC-F150
5729	294	Senior Seminar (lec)	1	Kalland		W	4:00-5:40	1	SCC-D154
5730	295	Selected Topics in Biol. (lec)							
		(Plant Taxonomy & Evolution)	1	Kuramoto		MW	1:00	4	SCC-K148
5731	295	" " " " (lab)	1	Kuramoto		TTh	8:00-10:50	-	SCC-F158
5732	297	Directed Research	1		U	T	8:00-10:50	2	SCC-F150
5733	297	Directed Research	1		U	F	1:00-3:50	-	SCC-E127
5734	412	Seminar in Biological Bases of Behavior	1	Colvin		MW	4:00-5:40	4	SBS-G022

<u>Code No.</u>	<u>Department and Number</u>	<u>Title</u>	<u>Sec.</u>	<u>Instructor</u>	<u>Foot- notes</u>	<u>Days</u>	<u>Hours</u>	<u>Units</u>	<u>Bldg./Room*</u>
<u>BUSINESS ADMINISTRATION</u>									
9603	401	Business & Its Environment	1	Blyn		MW	6:00-7:40	4	SBS-A116
9604	401	Business & Its Environment	2			M	4:30-6:10	4	SBS-A116
						Sat	10:00-11:40		
9600	410	Management Theory	1			MW	8:00-9:40pm	4	SBS-A116
9601	411	Organizational Theory & Behavior	1	Ross		TTh	6:00-7:40	4	SBS-A116
9602	420	Quantitative Methods in Business	1	Wang		TTh	8:00-9:40pm	4	SBS-A116
<u>CHEMISTRY</u>									
2800	100	Basic Studies: Struc of Matter	1	Gash		TWThF	10:00	4	SCC-E173
2801	100	" " " " "	2	Duncan		MTWF	1:00	4	W245
2802	100	" " " " "	3	Seely		TTh	4:00-5:40	4	W231
2803	100	" " " " "	4	Wiley		MW	6:00-7:40	4	SCC-E139/D138
2804	102	Basic Studies Chemistry	1			MWThF	11:00	4	W231
2805	102	" " " " "	2	Seely		MTWF	12:00	4	W231
2806	102	" " " " "	3	Wilk		MTWF	3:00	4	W231
2807	102	" " " " "	4	Gash		MW	4:00-5:40	4	W231
2808	110	Gen'l & Quantitative Chem (lec)	1	de la Camp		MWF	12:00	4	SCC-J146
2809	110	Gen'l & Quan. Chem. (lab)	1	de la Camp		F	1:00-3:50	-	W106
2827	110	Gen'l & Quan. Chem (lab)	2	Duncan		F	9:00-11:50	-	W106
2810	114	Gen'l & Quantitative Chem (lec)	1	Wilk		MW	1:00	4	W231
2811	114	Gen'l & Quan. Chem (lab)	1	Seely		MW	9:00-11:50	-	W106
2812	114	Gen'l & Quan. Chem (lab)	2	Kudrna		MW	2:00-4:50	-	W106
2813	114	Gen'l & Quan. Chem (lab)	3	Wilk		TTh	8:00-11:50	-	W106
2814	114	Gen'l & Quan. Chem (lab)	4	de la Camp		TTh	2:00-4:50	-	W106
2815	213	Organic Chemistry Laboratory II	1	Kudrna		TTh	2:00-5:50	2	W105
2817	214	Organic Chemistry III	1	Kudrna		MTWF	12:00	4	W246
2818	224	Physical Chemistry (lec)	1	Duncan		MW	8:00 am	4	W109
2819	224	Physical Chemistry (lab)	1	Duncan		MW	9:00-11:50	-	W108
2820	250	Biochemistry	1	Marmor		TWThF	8:00 am	4	W200E
2821	251	Laboratory in Biochemistry	1	Garcia		WF	9:00-11:50	2	W105
2822	270	Chemical Oceanography (lec)	1	Marmor		MTTh	10:00	4	W109
2823	270	Chemical Oceanography (lab)	1	Marmor		T	12:00-2:50	-	W108
2824	286	American Science & Technology	1	Imai		MW	6:00-7:40	4	SCC-E145
2825	297	Directed Research	-			TBA	TBA	2	TBA
2826	297	Directed Research	-			TBA	TBA	4	TBA

*See Map page 12

<u>Code No.</u>	<u>Department and Number</u>	<u>Title</u>	<u>Sec.</u>	<u>Instructor</u>	<u>Foot- notes</u>	<u>Days</u>	<u>Hours</u>	<u>Units</u>	<u>Bldg/Room*</u>
<u>CHINESE</u>									
3600	112	Third Quarter Chinese	1	Furukawa		MTWF	1:00	4	W241
<u>EARTH & SPACE SCIENCES</u>									
4000	290	Seminar in the Earth & Space Sciences	1	Kalland		TTh	4:00-5:40	4	SCC-E145
<u>EAST ASIAN STUDIES</u>									
3800	290	Seminar in East Asian Studies	1	Hata	E	MW	12:00-1:40	4	SBS-E016

<u>Code No.</u>	<u>Department and Number</u>	<u>Title</u>	<u>Sec.</u>	<u>Instructor</u>	<u>Foot- notes</u>	<u>Days</u>	<u>Hours</u>	<u>Units</u>	<u>Bldg/Room*</u>
<u>ECONOMICS</u> (Also see Business Administration)									
7900	100	Basic Studies Economics	1	Gaston		MW	4:00-5:40	4	SCC-F172
7901	110	Introductory Economics	1	Billes		MW	11:00-12:40	4	SCC-E167
7918	110	Introductory Economics	2	Billes		TTh	6:00-7:40	4	SBS-DO25
7902	111	Introductory Economics	1	Kidane		TWThF	9:00	4	SBS-FO21
7903	211	Intermediate Macro-Economic Theory	1	Harris		MWThF	5:00	4	SCC-K147
7904	213	Economics of the Firm	1	Wang		TTh	9:00-10:40	4	SCC-K148
7919	213	Economics of the Firm	2	Wang		TTh	6:00-7:40	4	SBS-EO22
7905	215	American Economic History	1	Buck		MTWTh	10:00	4	SBS-FO25
7920	215	American Economic History	2	Buck		MTWTh	2:00	4	SBS-FO21
7906	222	Monetary & Fiscal History of the United States	1	Gaston		MW	6:00-7:40	4	SBS-DO25
7907	227	Fiscal and Monetary Theory	1	Harris		MWThF	3:00	4	SBS-GO26
7908	230	Labor & the American Economy	1	Miles		MTWTh	10:00	4	SCC-K147
7909	245	Economic Development & Underdevelopment	1	Kidane		TWThF	10:00	4	SCC-E143
7921	254	Corporate Financial Management	1			TTh	6:00-7:40	4	SCC-E167
7911	255	Theory & Use of Business Accounting	1	Miles		MW	8:00-9:40am	4	SBS-F125
7922	255	Theory & Use of Business Accounting	2			TTh	8:00-9:40pm	4	SCC-E167
7912	260	Management in Theory & Practice	1	Lee		TTh	8:00-9:40am	4	SBS-F125
7913	262	Legal Foundations of Business	1	Colboth		MTWTh	3:00	4	SBS-BO43
7914	275	Government & the American Economy	1			MW	6:00-7:40	4	SCC-E167
7923	280	The Economics of Urban Areas	1	Kidane		TF	12:00-1:40	4	SBS-EO26
7915	285	Economic Policy & Social Values	1	Peoples		TTh	6:00-7:40	4	SBS-EO26
7924	295	Senior Seminar in Economics	1	Harris		MW	12:00-1:40	4	SBS-A116
7916	298	Independent Study	1		L	TBA	TBA	2	TBA
7917	298	Independent Study	2		L	TBA	TBA	4	TBA

<u>Code No.</u>	<u>Department and Number</u>	<u>Title</u>	<u>Sec.</u>	<u>Instructor</u>	<u>Foot- notes</u>	<u>Days</u>	<u>Hours</u>	<u>Units</u>	<u>Bldg/Room*</u>
<u>EDUCATION</u>									
3700	210	Motivation & Learning (lec)	1	Desberg		MTW	10:00	4	SBS-B131
3701	210	Motivation & Learning (lab)	1	Desberg		W	11:00-1:30	-	SBS-B131
3702	210	Motivation & Learning (lec)	2	Taylor		MW	4:00-5:20	4	SBS-B131
3703	210	Motivation & Learning (lab)	2	Taylor		W	6:00-8:30	-	SBS-B131
3705	240	Workshop in Methods: Social Studies	1C	Carrison	V	MW	4:00-5:20	3	SCC-K148
3706	250	Workshop in Methods: Humanities	1C	Gutierrez/Riddell	V	T	3:00-5:30	3	ERC-A115
3707	260	Workshop in Methods: Math	1A	Gipson	V	MW	4:00-5:20	3	SBS-A104
3708	260	Workshop in Methods: Math	2B	Gipson	V	MW	2:00-3:20	3	SBS-B001
3709	270	Workshop in Methods: Science	1A	Larson	V	TTh	4:00-5:20	3	SBS-A104
3710	270	Workshop in Methods: Science	2B	Larson	V	TTh	2:00-3:20	3	SBS-A104
3711	280	Workshop in Methods: Language Arts	1	Francis	V	MW	6:00-7:30	3	SCC-K148
3712	292	Supervised Teaching in Elementary School	1		V	TBA	TBA	4	TBA
3713	297	Seminar in Student Teaching in Elementary School	1A	Bohman	V	W	2:00-3:40	2	SBS-B131
3733	297	Seminar in Student Teaching in Elementary School	2B	Aquino	V	T	2:00-3:40	2	SBS-B131
3734	297	Seminar in Student Teaching in Elementary School	3C	Gutierrez	V	TBA	TBA	2	TBA
3714	392	Supervised Teaching in the Secondary School	1			TBA	TBA	4	TBA
3715	397	Seminar in Student Teaching in Secondary School	1D	Assmann	V	T	2:00-3:40	2	SBS-B138
3735	397	Seminar in Student Teaching in Secondary School	2E	Warshaw	V	Th	2:00-3:40	2	SBS-B138
3716	400	Seminar: The Critique & Analysis of Research in Education	1	Taylor	V	TTh	4:00-5:40	4	SBS-D021
3717	420	The Process of Curriculum Dev.	1	Moss	V	S	9:00-12:00	4	SBS-B001
3718	431	Seminar in Reading: Diagnosis and Remediation	1	Aquino	V	TTh	4:00-5:40	4	SBS-B001
* * 3733	222	Education of the Mexican American	1			TTh	6:00-7:40	4	SBS-A104

<u>Code No.</u>	<u>Department and Number</u>	<u>Title</u>	<u>Sec.</u>	<u>Instructor</u>	<u>Foot- notes</u>	<u>Days</u>	<u>Hours</u>	<u>Units</u>	<u>Bldg/Room*</u>
3719	445	European Educational Systems	1	Assmann	V	TTh	6:00-7:40	4	SBS-DO21
3720	451	Seminar: Bio-Psychological Issues in Learning & Development	1	Goldman	V	TTh	4:00-5:40	4	SCC-E157
3721	453	Seminar in Identification & Study of Pupil Differences	1		V	MW	4:00-5:40	4	SBS-DO21
3722	455	Seminar: Socio-Cultural Aspects of Learning & Development	1	Carrison	V	MW	6:00-7:40	4	SBS-DO21
3723	461	Seminar in Curriculum Planning for the Gifted	1	Belasco	V	Th	6:00-9:20	4	SBS-BO01
3724	471	Practicum in Teaching the Disadvantaged	1	Epps	V	TTh	4:00-5:40	4	SCC-K148
3725	476	Seminar: Issues in Education	1		V	M	6:00-7:40	4	SBS-BO01
3726	485	Seminar: Advanced Philosophy of Education	1	Calatrello	V	MW	4:00-5:40	4	SBS-BO01
3727	498	Independent Study	1		E	TBA	TBA	2	TBA
3729	498	Independent Study	2		E	TBA	TBA	4	TBA
3728	499	Thesis	1		F	TBA	TBA	1	TBA
3730	499	Thesis	2		F	TBA	TBA	2	TBA
3731	499	Thesis	3		F	TBA	TBA	3	TBA
3732	499	Thesis	4		F	TBA	TBA	4	TBA
8032	History 386	History & Philosophy of Educ.	1C	Calatrello	V	MW	2:00-3:40	4	SBS-A110
1431	Math 342	Mathematics for Elementary Teachers	1	Larmore	V	MW	6:00-7:40	4	W246

<u>Code No.</u>	<u>Department and Number</u>	<u>Title</u>	<u>Sec.</u>	<u>Instructor</u>	<u>Foot- notes</u>	<u>Days</u>	<u>Hours</u>	<u>Units</u>	<u>Bldg/Room*</u>
<u>ENGLISH</u>									
9500	100	Basic Studies English I	1			MWThF	11:00	4	SBS-G022
9501	100	" " " I	2	Elliott		MTWTh	2:00	4	SBS-G022
9502	100	" " " I	3	L. Smith		TTh	4:00-5:40	4	SBS-E026
9503	101	Basic Studies English II	1			TWThF	8:00 a.m.	4	SBS-DO21
9504	101	" " " II	2			TTh	4:00-5:40	4	SBS-B040
9505	101	" " " II	3	Heffernan		MW	6:00-7:40	4	SBS-B040
9506	102	Basic Studies Literature	1	Santas		MWThF	8:00 a.m.	4	SBS-B040
9507	102	" " " "	2			MWThF	8:00 a.m.	4	W205
9508	102	" " " "	3			MTWF	10:00	4	SBS-DO21
9509	102	" " " "	4			MWThF	11:00	4	SBS-DO21
9510	102	" " " "	5			MWThF	11:00	4	SBS-B040
9511	102	" " " "	6			MTWF	12:00	4	SBS-DO21
9512	102	" " " "	7	Eliet		MTWF	12:00	4	SBS-B040
9513	102	" " " "	8			MTWF	1:00	4	SBS-G022
9514	102	" " " "	9			MTWTh	2:00	4	SBS-DO21
9515	102	" " " "	10			MTWTh	3:00	4	SBS-DO21
9516	102	" " " "	11			MW	4:00-5:40	4	SBS-G022
9517	102	" " " "	12	L. Smith		MW	6:00-7:40	4	SBS-G022
9518	111	The Devices of Persuasion	1			MW	6:00-7:40	2	SBS-G022
9519	121	Theater Practicum	1	Vaughn		MW	3:00-4:40	2	SCC-J127
9520	130	Understanding Fiction	1	Eliet		MTWF	10:00	4	SCC-E157
English/ French/Spanish									
9521	210	The Study of Language	1	Mohr		MTWTh	9:00	4	SBS-DO21
9522	213	History of the English Language	1	Mohr		MTWTh	8:00 a.m.	4	SBS-G022
9524	216	Linguistic Analysis	1	Duncan		MW	9:00-10:40	4	SBS-G022
9525	220	Drama Workshop - Acting	1	Wheatley	A	TF	2:00-3:40	2	ERC-B124
9526	220	Drama Workshop - Performance	2	Marienthal	A	TTh Sat	7:00-8:40 TBA	2	SCC-J127
9527	222	Introduction to Film	1	Marienthal		TF	4:00-5:40	4	ERC-B118
9528	230	Readings in British Literature: Non-Dramatic Poetry	1	Riddell		MW	6:00-7:40	4	SCC-E157
9529	231	Readings in British Literature: Drama and Prose	1	Mahon		MWThF	8:00 a.m.	4	SCC-E157
9530	231	Readings in British Literature: Drama and Prose	2	Bullaro		TTh	6:00-7:40	4	SCC-F166

*See Map page 12

<u>Code No.</u>	<u>Department and Number</u>	<u>Title</u>	<u>Sec.</u>	<u>Instructor</u>	<u>Foot- notes</u>	<u>Days</u>	<u>Hours</u>	<u>Units</u>	<u>Bldg/Room*</u>
<u>ENGLISH</u>									
9531	235	Readings in World Literature	1	Mahon		MWThF	9:00	4	SCC-E157
9532	235	Readings in World Literature	2	Bullaro		TTh	8:00-9:40 pm	4	SCC-E157
9533	237	Contemporary Mexican American Literature	1	Moesser		MWThF	11:00	4	W245
9534	238	Literature of China & Japan	1	Furukawa		MTWF	3:00	4	W243
9535	240	American Literature I	1	Santas		MWThF	11:00	4	SCC-E157
9536	240	American Literature I	2	Tracy		MW	4:00-5:40	4	SCC-E157
9537	241	American Literature II	1	Heffernan		MTWTh	3:00	4	SCC-E157
9538	243	Black Poetry	1			TTh	6:00-7:40	4	SCC-E157
9539	244	Afro-American Literature	1			MTWF	1:00	4	SCC-E157
9540	245	Literary Criticism	1	Shafer		MTWF	12:00	4	SBS-G022
9541	250	Advanced Composition	1	Wells		MTWF	3:00	4	SBS-G022
9542	262	History of the Theater II	1	Vaughn		MWThF	1:00	4	W243
9543	265	Development of the English Drama	1	Heffernan		MW	8:00-9:40 am	4	SCC-D154/E153
9544	267	Shakespeare	1	Eliet		MTWF	1:00	4	SCC-D154/E153
9545	267	Shakespeare	2	Rankin		MW	2:00-3:40	4	SCC-D154/E153
9546	269	Modern Theater	1	Marienthal		TWThF	2:00	4	SCC-E157
9547	270	20th Century Experiments in Literary Form	1	Rankin		TTh	2:00-3:40	4	SCC-D154/E153
9548	281	Semantics	1	Elliott		TTh	9:00-10:40	4	SBS-G022
9549	294	Seminar: Special Topics in Linguistics	1	Duncan	E	MW	12:00-1:40	4	W205
9550	295	Seminar: Special Topics in British Literature	1	Shafer	H	MTWF	10:00	4	SBS-B040
9551	295	Seminar: Special Topics in British Literature	2	Riddell	H	TTh	4:00-5:40	4	SBS-A116
9552	295	Seminar: Special Topics in British Literature	3	L. Smith	H	MW	8:00-9:40 am	4	W241
9553	296	Seminar: Special Topics in American Literature	1	Santas	H	MWThF	9:00	4	SCC-E173
9554	296	Seminar: Special Topics in American Literature	2	Tracy	H	MWThF	11:00	4	SCC-E153
9555	298	Independent Study: Senior Project	1		E	TBA	TBA	4	TBA
9556	299	Independent Study	1		E	TBA	TBA	4	TBA

*See Map page 12

<u>Code No.</u>	<u>Department and Number</u>	<u>Title</u>	<u>Sec.</u>	<u>Instructor</u>	<u>Foot- notes</u>	<u>Days</u>	<u>Hours</u>	<u>Units</u>	<u>Bldg/Room*</u>
<u>ENGLISH</u>									
9557	434	Seminar: Studies in Renaissance Literature (1500-1603)	1	Riddell	F	TTh	6:00-7:40	4	SBS-B040
9559	449	Seminar: Studies in Modern British Literature	1	Rankin	F	TTh	4:00-5:40	4	SCC-D154
9560	491	Seminar: Special Topics in British Literature	1	Bullaro	F	MW	6:00-7:40	4	SCC-D154
9569	491	Special Topics in British Literature: Norse Backgrounds to British Literature	2	Duncan	F	TTh	2:00-3:40	4	SBS-A116
9561	493	Seminar: Special Topics in American Literature	1	Wells	F	MTWF	2:00	4	SCC-F166
9562	494	Seminar: Topics in Linguistic Theory	1	Elliott	F	MW	4:00-5:40	4	SCC-E153
9563	499	Thesis	1		F	TBA	TBA	1	TBA
9564	499	Thesis	2		F	TBA	TBA	2	TBA
9565	499	Thesis	3		F	TBA	TBA	3	TBA
9566	499	Thesis	4		F	TBA	TBA	4	TBA
9567	499	Thesis	5		F	TBA	TBA	5	TBA
9568	499	Thesis	6		F	TBA	TBA	6	TBA

<u>Code No.</u>	<u>Department and Number</u>	<u>Title</u>	<u>Sec.</u>	<u>Instructor</u>	<u>Foot-notes</u>	<u>Days</u>	<u>Hours</u>	<u>Units</u>	<u>Bldg/Room*</u>
<u>FOUNDATIONS OF NATURAL SCIENCE</u>									
8400	290	Seminar in the Foundations of Natural Science	1	Armacost		MW	4:00-5:40	4	W253
<u>FRENCH</u>									
3100	110	First Quarter French	1	Hewitt		TWThF	3:00	4	W250
3102	112	Third Quarter French	1	Lauerhass		MTWTF	12:00	4	W249
3104	122	Sixth Quarter French	1	Lauerhass		MTWTF	1:00	4	W249
9521	French/ English/ Spanish 210	The Study of Language	1	Mohr		MTWTh	9:00	4	SBS-D021
3105	232	Explication de Textes	1	Hewitt		TWThF	10:00	4	W250
3106	252	History of French Literature I	1	DiLena		MW	4:00-5:40	4	W250
3107	270	The Teaching of French as a Living Language	1	Lenard		MW	6:00-7:40	4	SBS-A104

*See Map page 12

<u>Code No.</u>	<u>Department and Number</u>	<u>Title</u>	<u>Sec.</u>	<u>Instructor</u>	<u>Foot- notes</u>	<u>Days</u>	<u>Hours</u>	<u>Units</u>	<u>Bldg/Room*</u>
<u>GEOGRAPHY</u>									
8100	100	Basic Studies Geography (lec)	1	Forbes		MWF	11:00	4	SBS-EO26
8101	100	Basic Studies Geog. (lab)	1	Forbes		Th	10:00-12:00	-	SCC-L149
8102	100	Basic Studies Geog. (lab)	2	Forbes		Th	2:00-4:00	-	SCC-L149
8103	100	Basic Studies Geography (lec)	2	Stepenske		MWTh	3:00	4	SBS-EO26
8104	100	Basic Studies Geog. (lab)	1	Stepenske		T	2:00-3:40	-	SBS-A004
8105	100	Basic Studies Geog. (lab)	2	Stepenske		Th	10:00-11:40	-	SBS-A004
8106	110	Elements of Geography (lec)	1	Eves		MTW	10:00	4	SBS-A110
8107	110	Elements of Geog. (lab)	1	Eves		Th	10:00-12:00	-	SCC-J146
8108	150	Field Study in Geography (En- vironmental Perception Emphasis)	1	Eves		M	12:00	2	SBS-A004
				Fieldwork		W	12:00-4:00	-	Field
8109	150	Field Study in Geography (Physical Emphasis)	2	Forbes		W	1:00	2	SBS-A004
				Fieldwork		S	TBA	-	Field
8110	150	Field Study in Geography	3	Bullock	C	W	12:00	2	SCC-L149
8111	205	Cartography (lec)	1	Forbes		Th	9:00	4	SBS-A004
8112	205	Cartography (lab)	1	Forbes		MWF	8:00-10:00	-	SBS-A004
8120	206	Quantitative Models (lec)	1			MWF	1:00	4	SBS-BO37
8121	206	Quantitative Models (lab)	1			T	1:00-2:40	-	SBS-A110
8113	222	Contemporary Environmental Problems	1			TTh	7:00-8:40	4	SBS-BO37
8114	222	Contemporary Environmental Problems	1			S	TBA	-	TBA
8115	224	Population & the Environment	1			MW	4:00-5:40	4	SBS-A110
8116	235	Urban Geography	1	Eves		MTWTh	4:00	4	SCC-J146
8117	260	Geography of the U.S. & Canada	1	Smith		MWThF	9:00	4	SBS-EO26
8118	264	Geography of Latin America	1	Hudson		MTThF	10:00	4	SBS-FO21
8119	270	Geography of East Asia	1			MW	7:00-8:40pm	4	SBS-BO37

*See Map page 12

<u>Code No.</u>	<u>Department and Number</u>	<u>Title</u>	<u>Sec.</u>	<u>Instructor</u>	<u>Foot- notes</u>	<u>Days</u>	<u>Hours</u>	<u>Units</u>	<u>Bldg/Room*</u>
<u>GERMAN</u>									
3200	110	First Quarter German	1	Tangner		MWThF	8:00 am	4	W250
3201	111	Second Quarter German	1	Tangner		MWThF	9:00	4	W249
3202	112	Third Quarter German	1	Tangner		MWThF	11:00	4	W241
<u>HEALTH & PHYSICAL EDUCATION</u>									
7100	100	Basic Studies Health (lec)	1	Nupp		TTh	9:00	2	W253
7102	100	Basic Studies Health (lec)	2	Nupp		WF	9:00	2	W253
7103	100	Basic Studies Health (lec)	3	Nupp		TTh	4:00	2	W253
7104	101	Basic Studies Activity (Archery/coed)	1	Hayes		MW	11:00	½	FH
7105	101	Basic Studies Activity (Badminton/coed)	2	Hayes		TTh	10:00	½	FH
7106	101	Basic Studies Activity (Basketball/men)	3	Easley		MW	12:00	½	FH
7107	101	Basic Studies Activity (Bowling/coed)	4	Johnson		M	2:00-4:00	½	FH
7108	101	Basic Studies Activity (Fencing/coed)	5	Hayes		MW	12:00	½	FH
7109	101	Basic Studies Activity (Figure Control/women)	6	Hayes		TTh	9:00	½	FH
7110	101	Basic Studies Activity (Figure Control/women)	7	Hayes		MW	10:00	½	FH
7111	101	Basic Studies Activity (Golf/coed)	8	Johnson		MW	11:00	½	FH
7112	101	Basic Studies Activity (Golf/coed)	9	Johnson		TTh	2:00	½	FH
7113	101	Basic Studies Activity (Physical Conditioning/men)	10	Nupp		WF	1:00	½	FH
7114	101	Basic Studies Activity (Senior Life Saving)	11	Hayes		TTh	3:00	½	FH
7115	101	Basic Studies Activity (Intermediate Swimming/coed)	12	Hayes		TTh	2:00	½	FH
7116	101	Basic Studies Activity (Beginning Swimming/coed)	13	Hayes		MW	2:00	½	FH
7117	101	Basic Studies Activity (Tennis/Intermediate/coed)	14			WF	12:00	½	FH

*See Map page 12

<u>Code No.</u>	<u>Department and Number</u>	<u>Title</u>	<u>Sec.</u>	<u>Instructor</u>	<u>Foot- notes</u>	<u>Days</u>	<u>Hours</u>	<u>Units</u>	<u>Bldg/Room*</u>
<u>HEALTH & PHYSICAL EDUCATION</u>									
7118	101	Basic Studies Activity (Tennis/coed)	15	Nupp		TTh	2:00	½	FH
7119	101	Basic Studies Activity (Volleyball/coed)	16	Hayes		TTh	1:00	½	FH
7131	101	Basic Studies Activity (Modern Dance)	17			TTh	2:00	½	FH
7132	101	Basic Studies Activity (Folk Dance)	18			TTh	3:00	½	FH
7133	101	Basic Studies Activity (Tennis/coed/beginning)	19			WF	11:00	½	FH
7134	101	Basic Studies Activity (Volleyball/coed)	20			MW	1:00	½	FH
7120	118	First Aid (lec)	1	Easley		MW	11:00	2	FH
7121	136	Sports in American Life (lec)	1	Easley		MW	10:00	2	W232A
7122	150	Intermediate Athletics (Baseball/men)	1	Easley	E	MTWThFS	TBA	1	FH
7123	150	Intermediate Athletics (Golf/men)	2	Johnson	E	MTWThFS	TBA	1	FH
7124	150	Intermediate Athletics (Tennis/men)	3	Dike	E	MTWThFS	TBA	1	FH
7125	150	Intermediate Athletics (Tennis/women)	4		E	MTWThFS	TBA	1	FH
7126	150	Intermediate Athletics (Volleyball/men)	5		E	MTWThFS	TBA	1	FH
7127	150	Intermediate Athletics (Badminton/coed)	6	Hayes	E	MTWThFS	TBA	1	FH
7128	203	Exercise Physiology (lec)	1	Nupp		TWTh	10:00	4	W253
7130	203	Exercise Physiology (lab)	1	Nupp		F	10:00-12:50	-	FH
7129	290	Senior Seminar in Physical Education	1	Johnson		MTWTh	9:00	4	W232A

Code No.	Department and Number	Title	Sec.	Instructor	Foot- notes	Days	Hours	Units	Bldg/Room*
<u>HISTORY</u>									
8000	100	Basic Studies History	1			MF	10:00-11:40	4	SBS-B037
8001	100	" " "	2	Kilfoil		WTh	2:00-3:40	4	SBS-B037
8002	100	" " "	3	Orozco		MTThF	10:00	4	SBS-D125
8003	150	Research Methods & Field Study	1	Auld	C	W	2:00-3:40	4	SBS-E022
8004	150	" " " "	2	Dosh	C	F	12:00-1:40	4	SBS-E016
8005	150	" " " "	3	Shin	C	W	2:00-3:40	4	SBS-A116
8006	150	" " " "	4	Seps	C	T	2:00-3:40	4	SBS-B001
8007	210	Seminar in Historical Study	1	Kilfoil		MW	6:00-7:40	4	SBS-F021
8008	220	The Ancient World	1	Dosh		TWThF	10:00	4	W244
8009	222	High Middle Ages	1	Udeze		MW	10:00-11:40	4	SBS-B109
8010	224	Early Modern Europe	1	Dosh		TTh	2:00-3:40	4	SBS-E022
8011	228	Twentieth Century Europe	1	Holter		TWThF	9:00	4	SBS-B037
8012	232	Modern England	1	Auld		TWThF	9:00	4	SCC-E143
8013	234	British Empire & Commonwealth	1	Auld		TTh	4:00-5:40	4	SBS-F025
8014	237	Modern Germany	1	Seps		TTh	6:00-7:40	4	SBS-E120
8015	237	Modern Germany	2	Seps		MW	4:00-5:40	4	SCC-E143
8016	242	United States: Early National Period	1	Kilfoil		TTh	6:00-7:40	4	SBS-F021
8017	247	Women in History	1	Garber		TF	12:00-1:40	4	SBS-F025
8018	251	Labor in American Society	1			TTh	4:00-5:40	4	SBS-F125
8019	252	History of American Thought	1	Cady		TTh	8:00-9:40 pm	4	SBS-B043
8020	253	The Asians in America	1	Hata		MTWTh	8:00 am	4	SBS-B043
8021	254	The Afro-American from Africa through Reconstruction	1	Gopaul		MW	4:00-5:40	4	SBS-B010
** 8022	255	The Afro-American from Recon- struction to the Present	1	Gopaul		MWThF	11:00	4	SBS-A104
8023	257	California & the Southwest	1	Orozco		MTThF	11:00	4	SBS-B043
8024	264	Mexico	1	Orozco		MWThF	2:00	4	SBS-F125
8033	272	Modern China	1	Shin		MW	10:00-11:40	4	SBS-B103
8034	280	History of Science	1	Goodstein		WF	10:00-11:40	4	SCC-K148
8026	275	Africa: Pre-Colonial Period	1	Udeze		MTWTh	9:00	4	SBS-F025
8027	284	The City in History	1	Cady		MF	8:00-9:40 am	4	SCC-J146
8028	292	Special Topics in History: Urban Architecture in America	1	Cady		MW	4:00-5:40	4	SBS-F025
8029	292	Special Topics in History: Topics in Afro-American History	2			TF	12:00-1:40	4	SBS-E120
8030	298	Independent Study	1		L	TBA	TBA	2	TBA
8031	298	Independent Study	2		L	TBA	TBA	4	TBA
8032	386	History & Philosophy of Education	1C	Calatrello		MW	2:00-3:40	4	SBS-A110
** 8035	254	The Afro-American from Africa through Reconstruction	2	Clark		MW	4:00-5:40	4	SCC-J146

*See Map page 12

<u>Code No.</u>	<u>Department and Number</u>	<u>Title</u>	<u>Sec.</u>	<u>Instructor</u>	<u>Foot- notes</u>	<u>Days</u>	<u>Hours</u>	<u>Units</u>	<u>Bldg/Room*</u>
<u>INFORMATION SYSTEMS</u>									
2700	290	Seminar in Information Systems	1	Ehrlich		TTh	6:00-7:40	4	SCC-K148
<u>JAPANESE</u>									
5100	112	Third Quarter Japanese	1	Furukawa		MTWF	12:00	4	W241
<u>LATIN-AMERICAN STUDIES</u>									
4400	290	Seminar in Latin American Studies	1	Chaffee	E	MW	11:00-12:40	4	SBS-G026
<u>LINGUISTICS</u>									
9900	290	Seminar in Linguistics	1	Mohr	H	TF	12:00-1:40	4	W205

*See Map page 12

<u>Code No.</u>	<u>Department and Number</u>	<u>Title</u>	<u>Sec.</u>	<u>Instructor</u>	<u>Foot- notes</u>	<u>Days</u>	<u>Hours</u>	<u>Units</u>	<u>Bldg/Room*</u>
<u>MATHEMATICS</u>									
1400	010	Algebra & Trigonometry	1	Chang		MWThF	8:00 am	4	W246
1401	010	Algebra & Trigonometry	2	Ralston		MTWF	12:00	4	W253
1402	100	Basic Studies Mathematics	1	Larmore		MTWTh	9:00	4	W246
1403	100	" " "	2	Hart		MTWF	10:00	4	W200E
1404	100	" " "	3	Ralston		MTWF	3:00	4	W200E
1405	100	" " "	4	Matthews		MTThF	2:00	4	W231
1406	100	" " "	5	Armacost		MTWTh	11:00	4	W244
1407	100	" " "	6	Gould		MTWF	4:00	4	W246
1408	110	Differential & Integral Calculus I	1	Larmore		MTWTh	8:00 am	4	W232A
1409	110	Diff. & Integral Calc. I	2	Ehrlich		MTWTh	3:00	4	W232A
1410	112	Diff. & Integral Calc. II	1	Wiegmann		MTThF	8:00 am	4	W231
1411	112	Diff. & Integral Calc. II	2	Gould		MTWF	2:00	4	W253
1412	114	Diff. & Integral Calc. III	1	Ralston		MTWF	1:00	4	W246
1413	116	Diff. & Integral Calc. IV	1	Chang		MWThF	11:00	4	W200E
1414	150	Elementary Stat. & Problt'y	1	Book		MWThF	8:00 am	4	W253
1415	150	" " "	2	Book		MWThF	11:00	4	W253
1432	150	" " "	3	Hart		MTWF	2:00	4	W246
1433	150	" " "	4			TTh	6:00-7:40	4	SCC-E143
1416	160	Intro. to Data Processing	1	Jones		MW	6:00-7:40	4	SCC-F166
1417	162	Machine Level Programming	1	Jones		MTWTh	4:00	4	W200E
1418	210	Differential Equations	1	Hart		MTWF	12:00	4	W200E
1419	212	Advanced Analysis	1	Chang		MWThF	9:00	4	W252
1420	214	Advanced Analysis	1	Armacost		MTWTh	2:00	4	W200E
1421	220	Functions of Complex Variables	1	Jones		MTWTh	2:00	4	W232A
1423	230	Linear Algebra	1	Wiegmann		MTThF	9:00	4	W200E
1424	236	Mathematical Logic I	1	Gould		MTWF	1:00	4	W253
1425	238	Mathematical Logic II	1	Matthews		MTThF	3:00	4	W252
1426	250	Probability & Statistics I	1	Matthews		MTThF	10:00	4	W246
1427	252	Probability & Statistics II	1	Book		MWThF	10:00	4	W252
1428	266	Numerical Analysis I	1	Ehrlich		MTWTh	2:00	4	W252
1429	297	Directed Study in Info. Sys.	1			TTh	TBA	2	TBA
1430	297	" " " " "	1			TBA	TBA	4	TBA
1431	342	Mathematics for Elementary Teachers	1	Larmore		MW	6:00-7:40	4	SCC-J146

*See Map page 12

<u>Code No.</u>	<u>Department and Number</u>	<u>Title</u>	<u>Sec.</u>	<u>Instructor</u>	<u>Foot- notes</u>	<u>Days</u>	<u>Hours</u>	<u>Units</u>	<u>Bldg/Room*</u>
<u>MUSIC</u>									
1700	100	Basic Studies Music	1	Girard		MWThF	11:00	4	SCC-E173
1701	100	" " "	2			MW	2:00-3:40	4	SCC-E173
1702	100	" " "	3	Cobos		TTh	6:00-7:40	4	SCC-E173
1703	112	Music Theory III	1	Steiner		MTWTh	2:00	4	ERC-A115
1704	180	College Chorale	1	Steiner	A	MTW	1:00	1	ERC-A103
1705	181	Class Voice	1	Galanos		MW	9:00 am	1	ERC-A115
1706	190	Early Instruments	1	Wilk		MW	12:00	1	ERC-A109
1707	191 **	Class Piano	1	Bunger		T	12:00	1	ERC-A121
						Th	11:00		
1708	191 **	Class Piano	2	Bunger		MW	12:00	1	ERC-A121
1709	191 ****	Class Piano	3	Steiner		MW	3:00	1	ERC-A121
1721	191 ****	Class Piano	4	Girard		WF	10:00	1	ERC-A115
1710	192	Instrumental Ensemble	1	Camesi		MWF	11:00	1	ERC-A109
1711	212	Advanced Theory III	1	Bunger		MTWTh	9:00	4	ERC-A121
1712	215	Composition	1	Bunger		MW	10:00-11:40	4	ERC-A121
1713	218	Romantic & Modern Music	1	Camesi		MTWF	1:00	4	ERC-A115
1714	252	Afro-American Music	1	Bradford		MW	7:00-8:40pm	4	SCC-E173
1715	255	Music of China & Japan	1	Shindo		TTh	6:00-7:40	4	ERC-A115
1716	270	20th Century Composers: Their Writings & Their Music	1			MW	4:00-5:40	4	ERC-A103
1717	291 *	Individual Lessons - Piano	1	Bunger		T	8:00 am	1	ERC-A121
1718	291 *	Individual Lessons - Piano	2	Bunger		Th	8:00 am	1	ERC-A121
1719	295	Performance	1	Camesi		T	2:00-3:40	1	ERC-A109
1720	296	Conducting	1	Camesi		MWF	2:00	3	ERC-A121

<u>Code No.</u>	<u>Department and Number</u>	<u>Title</u>	<u>Sec.</u>	<u>Instructor</u>	<u>Foot- notes</u>	<u>Days</u>	<u>Hours</u>	<u>Units</u>	<u>Bldg/Room*</u>
<u>PHILOSOPHY</u>									
0300	200	Basic Studies	1			MTWF	10:00	4	W231
0301	200	Basic Studies	2	Fay		TTh	2:00-3:40	4	W233
0302	200	Basic Studies	3	Shimomisse		MW	4:00-5:40	4	W233
0315	200	Basic Studies	4	Grossman		MW	8:00-9:40pm	4	SBS-B043
0303	217	Values and the Future	1	Fay		MWThF	11:00	4	W243
0304	220	Aesthetics	1	Grossman		TTh	4:00-5:40	4	W243
0305	240	Symbolic Logic	1	Boxill		MWThF	8:00 am	4	W243
0306	250	Epistemology	1	Grossman		MW	4:00-5:40	4	W243
0307	252	Philosophy of Natural Science	1	Boxill		MWThF	10:00	4	W243
0308	255	American Pragmatism	1	Fay		MTWF	1:00	4	W233
0309	260	Selected Works in Existential Thought	1	Lewis		MTWF	12:00	4	W233
0310	270	Philosophy in the Modern World	1			MTWF	8:00 am	4	W233
0311	270	Philosophy in the Modern World	2	Lewis		MTWF	10:00	4	W233
0312	271	Analytic Philosophy	1	Boxill		MWThF	9:00	4	W243
0316	272	Philosophical Issues in Third World Social Thought	1			MW	2:00-3:40	4	SBS-A104
0313	285	Philosophies of Eastern Civilization	1			MWThF	9:00	4	W233
0314	295	Seminar, History of Philosophy	1	Shimomisse	H	MW	2:00-3:40	4	W249
0317	298	Independent Study	1		H	TBA	TBA	4	TBA

*See Map page 12

<u>Code No.</u>	<u>Department and Number</u>	<u>Title</u>	<u>Sec.</u>	<u>Instructor</u>	<u>Foot- notes</u>	<u>Days</u>	<u>Hours</u>	<u>Units</u>	<u>Bldg/Room*</u>
<u>PHYSICS</u>									
2500	102	Basic Studies Physics	1	Alt		MTWTh	10:00	4	SCC-E145
2501	102	Basic Studies Physics	2	Lee		MWThF	11:00	4	SCC-E145
2502	102	Basic Studies Physics	3	Klapman		MW	6:00-7:40	4	SCC-E143
2503	114	General Physics (lec)	1	Wiley		MTW	2:00	4	SCC-E145
2504	114	General Physics (lab)	1	Imai		Th	9:00-11:50	-	SCC-F138
2505	114	General Physics (lab)	2	Imai		Th	2:00-4:50	-	SCC-F138
2506	116	Introductory Modern Physics	1	Evett		MTWF	8:00 am	4	SCC-E145
2507	150	Physical Geology (lec)	1	Kuramoto		MW	4:00-5:15	4	SCC-F130
2508	150	Physical Geology (lab)	1	Kuramoto		T	2:00-4:50	-	SCC-F130
2509	200	Basic Studies Earth & Space Sciences	1	Alt		MTWTh	9:00	4	SCC-E145
2510	200	Basic Studies Earth & Space Sciences	2	Imai		MW	8:00-9:40pm	4	SCC-E145
2511	206	Modern Physics: Its Impact on 20th Century Thought	1	Evett		MTWF	9:00	4	SCC-D138/E139
2512	210	Theoretical Mechanics I	1	Lee		MWThF	10:00	4	SCC-F130
2513	252	Geophysics	1			TTh	6:00-7:40	4	SCC-E145
2514	260	Quantum Mechanics	1	Lee		MWThF	8:00 am	4	SCC-K148
2515	281	Laboratory on Selected Topics in Physics	1	Alt		T	1:00-3:50 (3 more hours TBA)	2	SCC-F138
2516	297	Directed Research	1			TBA	TBA	2	TBA
2517	297	Directed Research	2			TBA	TBA	4	TBA

*See Map page 12

<u>Code No.</u>	<u>Department and Number</u>	<u>Title</u>	<u>Sec.</u>	<u>Instructor</u>	<u>Foot- notes</u>	<u>Days</u>	<u>Hours</u>	<u>Units</u>	<u>Bldg/Room*</u>
<u>POLITICAL SCIENCE</u>									
8200	100	Basic Studies Political Science	1	Chaffee		MTWTh	10:00	4	SCC-E167
8201	100	" " " "	2	O'Hara		MTWF	1:00	4	SBS-D025
8202	100	" " " "	3			TTh	4:00-5:40	4	SBS-D025
8203	151	Methods of Political Analysis	1			MTWF	1:00	4	SBS-E022
8218	210	Issues in American National Government	1			MW	4:00-5:40	4	SCC-E167
8205	214	American Political Parties and Elections	1	Palmer		TTh	4:00-5:40	4	SBS-G022
8219	234	American Foreign Policy	1	O'Hara		MTWF	3:00	4	SBS-F021
8220	236	Theories of International Relations	1	Martin		MTWF	2:00	4	SBS-E026
8221	238	New States in World Politics	1			TTh	4:00-5:40	4	SBS-B043
8206	239	Government and Politics of the Soviet Union	1			MTWF	12:00	4	SBS-D025
8207	248	The Politics of Developing Areas	1	Martin		MTWF	10:00	4	SBS-D025
8208	250	History of Political Ideas	1	Stephens		TWThF	8:00 am	4	SBS-F025
8209	251	Modern Political Thought	1	Kaplan		MTWF	3:00	4	SBS-F025
8210	252	Theories of the Political System	1	Kaplan		MW	4:00-5:40	4	SBS-D025
8211	254	American Political Thought	1	Kaplan		MTWF	12:00	4	SBS-B037
8222	260	American Constitutional Law: Distribution of Power	1			MW	4:00-5:40	4	SBS-E026
8212	261	American Constitutional Law: Civil Rights	1	Heneghan		TTh	9:00-10:40	4	SBS-B043
8213	270	Public Opinion and Propaganda	1	Palmer		TTh	6:00-7:40	4	SBS-B043
8215	295	Seminar in Political Science	1	Stephens	E	WF	9:00-10:40	4	SBS-A104
8216	298	Independent Study	1		L	TBA	TBA	2	TBA
8217	298	Independent Study	2		L	TBA	TBA	4	TBA

<u>Code No.</u>	<u>Department and Number</u>	<u>Title</u>	<u>Sec.</u>	<u>Instructor</u>	<u>Foot- notes</u>	<u>Days</u>	<u>Hours</u>	<u>Units</u>	<u>Bldg/Room*</u>
<u>PSYCHOLOGY</u>									
5000	100	Basic Studies Psychology	1	Henschel		MWThF	8:00 am	4	SBS-DO25
5001	100	" " "	2	Henschel		MWThF	9:00	4	SBS-DO25
5002	100	" " "	3	Adams		MTWTh	3:00	4	SBS-DO25
5003	125	Intro. the Research Methods (lec)	1	Wilcox		MWTh	11:00	4	SBS-F125
5004	125	Intro. to Res. Methods (lab)	1	Wilcox		M	12:00-2:30	-	W244
5005	125	Intro. to Res. Methods (lab)	2	Wilcox		T	12:00-2:30	-	W244
5006	150	Elementary Statistical Analysis	1	Pieszko		MTWTh	8:00 am	4	SCC-E143
5007	150	Elementary Statistical Analysis	2	Henschel		MTWTh	9:00	4	W244
5008	205	History and Systems	1	Adams		MW	4:00-5:40	4	SBS-FO21
5009	205	History and Systems	2			MWThF	11:00	4	SBS-FO25
5010	210	Fundamentals of Learning (lec)	1	Simon		MWTh	10:00	4	SBS-A116
5011	210	Fund. of Learning (lab)	1	Simon		Th	2:00-4:30	4	SBS-A132
5012	212	Theories of Learning	1	Simon		MW	1:00-2:40	4	SCC-K147
5013	218	Comparative Psychology (lec)	1	Adams		MWTh	2:00	4	SCC-E143
5014	218	Comparative Psychology (lab)	1	Adams		T	12:00-3:00	-	SBS-A132
5015	231	Measurement in Psychology (lec)	1	Pieszko		MTW	10:00	4	SCC-L149
5016	231	Measurement in Psych. (lab)	1	Pieszko		Th	10:00-12:00	-	SBS-BO37
5017	240	Social Psychology	1	Moinat		MW	9:00-10:40	4	SBS-GO22
5018	250	Developmental Psychology	1	Paul		MTWTh	9:00	4	SBS-GO26
5019	250	Developmental Psychology	2	Paul		MTWTh	10:00	4	SBS-F125
5020	250	Developmental Psychology	3	Cole		MTWTh	2:00	4	SBS-FO25
5021	250	Developmental Psychology	4	Bercovici		MW	4:00-5:40	4	SBS-D125
5022	258	Seminar in Cognitive Psychology	1	Marsh		TTh	4:00-5:40	4	W244
5023	260	Theories of Personality	1	Porro		TWThF	2:00	4	SBS-DO25
5024	260	Theories of Personality	2	Roberts		WF	4:00-5:40	4	W244
5025	263	Abnormal Personality	1	Paul		MTWTh	11:00	4	SCC-F172
5026	265	Counseling Theory	1	Stodola	C	MW	8:35-9:50am	4	SCC-K147
5034	276	Psychology of Female Identity	1	Navar		MW	12:00-1:40	4	SCC-E173
5035	277	Seminar in Cognititve Psych.	1	Marsh		TTh	4:00-5:40	4	SBS-B131
5036	280	Psychology of the Mexican American I	1	Navar		TTh	9:00-10:40	4	SBS-A104
5037	282	Psychological Development of the Black Child	1			TTh	6:00-7:40	4	SBS-FO25
5027	283	Psychology of the Black Experience	1	Garcia		MW	4:00-5:40	4	SBS-BO43
5028	283	Psychology of the Black Experience	2	Washington		MW	4:00-5:40	4	SBS-A116

*See Map page 12

<u>Code No.</u>	<u>Department and Number</u>	<u>Title</u>	<u>Sec.</u>	<u>Instructor</u>	<u>Foot- notes</u>	<u>Days</u>	<u>Hours</u>	<u>Units</u>	<u>Bldg/Room*</u>
<u>PSYCHOLOGY</u>									
5029	295	Senior Seminar in Psychology	1		E	TTh	2:00-3:40	4	SCC-K147
5030	295	Senior Seminar in Psychology	2	Shellberg	E	MF	2:00-3:40	4	SBS-A116
5031	297	Directed Research	1		L	TBA	TBA	2/4	TBA
5032	298	Independent Study	1		L	TBA	TBA	2/4	TBA
5033	440	Seminar in Social Psychology	1	Shellberg	F	TTh	4:00-5:40	4	W248

11
 *See Map page 12

<u>Code No.</u>	<u>Department and Number</u>	<u>Title</u>	<u>Sec.</u>	<u>Instructor</u>	<u>Foot- notes</u>	<u>Days</u>	<u>Hours</u>	<u>Units</u>	<u>Bldg/Room*</u>
<u>SOCIOLOGY</u>									
8300	110	Introduction to Sociology	1	Ryave		MWThF	11:00	4	SBS-DO25
8301	120	Elem. Statistical Analysis (lec)	1	Loether		MTW	9:00	4	SBS-A116
8343	120	Elem. Stat. Analysis (lab)	1	Loether		Th	8:00-9:40pm	-	SBS-A132
8302	120	Elem. Statistical Analysis (lec)	2	McMaster		MTW	12:00	4	SBS-A110
8344	120	Elem. Stat. Analysis (lab)	2	McMaster		Th	10:00-11:40	-	SBS-A110
8345	120	Elem. Statistical Analysis (lec)	3			TThF	2:00	4	SBS-BO10
8346	120	Elem. Stat. Analysis (lab)	3			W	2:00-3:40	-	SBS-BO10
8303	150	Field Studies I	1	Quicker	C	F	10:00	2	SBS-EO16
8304	150	Field Studies I	2		C	M	12:00	2	SCC-E143
8305	150	Field Studies I	3	Seidner	C	T	3:00	2	SBS-EO16
8306	200	Basic Studies Sociology	1	Riskin		MW	12:00-1:40	4	SBS-F125
8307	205	Methods of Sociological Research	1	McCurtis		TWThF	9:00	4	SBS-EO16
8308	205	Methods of Sociological Research	2	Seidner		MTWF	2:00	4	SBS-EO16
8309	205	Methods of Sociological Research	3	Quicker		TTh	4:00-5:40	4	SBS-G026
8347	205	Methods of Sociological Research	4	Bryan		TTh	4:00-5:40	4	SBS-BO10
8310	206	Quantitative Analysis (lec)	1			TWTh	3:00	4	SCC-E143
8311	206	Quantitative Analysis (lab)	1			M	2:00-3:40	4	SCC-L149
8312	210	Social Stratification & Class	1	Hovard		MWThF	10:00	4	SBS-E120
8313	211	Social Organizations & Compara- tive Institutions	1	Blischke		MW	4:00-5:40	4	SBS-BO37
8348	213	Sociology of Education	1	Blischke		MW	2:00-3:40	4	SCC-F172
8314	215	Selected Contemporary Social Problems	1	Katz		MWThF	11:00	4	SBS-E120
8315	216	Black Communities	1	McCurtis		TWThF	8:00	4	SBS-E120
8316	217	Sociology of Rurual & Urban Mexican Americans	1			MTWF	1:00	4	SBS-D125
8317	220	Population & Society	1			TTh	6:00-7:40	4	SBS-F125
8318	229	Sociology of Adult Life & Aging	1	Raphael		MW	2:00-3:40	4	SBA-E120
8319	235	Social Movements: The New Feminists	1			MW	10:00-11:40	4	SBS-A132
8320	235	Social Movements: Asians in America	2			MW	4:00-5:40	4	SBS-F125
8321	240	Social Psychology: Sociological Perspectives	1	Christie		MWThF	11:00	4	SBS-FO21

*See Map page 12

<u>Code No.</u>	<u>Department and Number</u>	<u>Title</u>	<u>Sec.</u>	<u>Instructor</u>	<u>Foot- notes</u>	<u>Days</u>	<u>Hours</u>	<u>Units</u>	<u>Bldg/Room*</u>
<u>SOCIOLOGY</u>									
8322	251	Field Studies II	1	Hovard	C	Th	9:00	2	SBS-A132
8323	251	Field Studies II	2	Bryan	C	F	11:00	2	SBS-G026
8324	251	Field Studies II	3	Laws	C	T	12:00	2	SBS-G026
8325	251	Field Studies II	4	Raphael	C	W	1:00	2	SBS-BO43
8326	251	Field Studies II	5	Riskin	C	T	1:00	2	SBS-BO43
8327	251	Field Studies II	6	McMaster	C	Th	2:00	2	SBS-E016
8328	254	Sociology of Knowledge	1	Bomser		MW	4:00-5:40	4	SBS-E120
8329	255	Modern Sociological Theories	1	Loether		MTWTh	10:00	4	SBS-G026
8330	255	Modern Sociological Theories	2	Riskin		TTh	2:00-3:40	4	SBS-E120
8331	255	Modern Sociological Theories	3	Bomser		TTh	4:00-5:40	4	SBS-E120
8349	255	Modern Sociological Theories	4	Bryan		TTh	6:00-7:40	4	SBS-D125
8332	257	Social Analysis & the Foundations of Social Theory	1	Christie		MWThF	9:00	4	SBS-A146
8333	260	Minority Racial & Ethnic Rela- tions	1			MTWTh	9:00	4	SBS-E120
8334	265	Deviant Behavior	1	Laws		MTWTh	8:00 am	4	SBS-G026
8350	269	Juvenile Delinquency	1	Quicker		TWThF	2:00	4	SBS-BO43
8336	270	Field Studies in Urban Problems	1	Christie	C	F	10:00	2	SBS-G026
8337	270	Field Studies in Urban Problems	2	Bomser	C	M	3:00	2	SBA-E016
8351	270*	Field Studies in Urban Problems*	3	Blischke		Th	4:00	2	SBS-B138
8338	295	Senior Seminar in Sociology	1	Charnofsky	E	MW	12:00-1:40	4	W248
8339	295	Senior Seminar in Sociology	2	Raphael	E	TTh	4:00-5:40	4	SBS-A146
8351	295	Senior Seminar in Sociology	3			MW	3:00-4:40	4	SBS-B138
8340	298	Independent Study	1		L	TBA	TBA	2	TBA
8341	298	Independent Study	2		L	TBA	TBA	4	TBA
8342	450	Seminar in Interaction Process	1	Paulhe	F	MW	8:00-9:40pm	4	SBS-E016

*Note: Limited to Students in Early Childhood Education

*See Map page 12

<u>Code No.</u>	<u>Department and Number</u>	<u>Title</u>	<u>Sec.</u>	<u>Instructor</u>	<u>Foot- notes</u>	<u>Days</u>	<u>Hours</u>	<u>Units</u>	<u>Bldg/Room*</u>
<u>SPANISH</u>									
3400	110	First Quarter Spanish	1	Monsanto		MTWTh	2:00	4	W245
3401	112	Third Quarter Spanish	1	Moesser		MWThF	8:00 am	4	W245
3402	120	Fourth Quarter Spanish	1	Lauerhass		MTWF	9:00	4	W250
3403	122	Sixth Quarter Spanish	1	Monsanto		MW	4:00-5:40	4	W245
9521	Spanish/ English/ French 210	The Study of Language	1	Mohr		MTWTh	9:00	4	SBS-DO21
3404	211	The Structure of Spanish	1	Beym		TWThF	10:00	4	W245
3405	214	Spanish Phonology	1	Beym		TWThF	2:00	4	W243
3406	232	Explicacion de Textos	1	Sanchez		MTWTh	3:00	4	W245
3407	256	History of Spanish American Literature II	1	Moesser		MWThF	9:00	4	W245
3408	270	The Teaching of Spanish as a Living Language	1	Beym		TTh	4:00-5:40	4	W245
3409	295	Seminar in Special Topics in Spanish or Spanish American Literature: Don Quijote	1	Monsanto		MW	6:00-7:40	4	SCC-E153
3410	298	Independent Study	1	Sanchez	L	TBA	TBA	4	TBA

THEATER ARTS

1900	290	Seminar in Theater Arts	1	Wheatley	H	MTWF	10:00	4	SCC-D154
------	-----	-------------------------	---	----------	---	------	-------	---	----------

TWENTIETH CENTURY THOUGHT & EXPRESSION

0400	200	Intro. to 20th Century Studies	1	Tracy		MWThF	9:00	4	SCC-F172
0401	200	" " " " "	2	Holter		WF	10:00-11:40	4	SBS-E022
0404	200	" " " " "	3	Lenard		MTWTh	2:00	4	W250
0402	290	Seminar in 20th Century Thought & Expression	1	Toyoshima	H	MW	11:00-12:40	4	ERC-A127
0403	290	Seminar in 20th Century Thought & Expression	2	Lewis	H	MW	2:00-3:40	4	W205

URBAN STUDIES & ENVIRONMENTAL DESIGN

8900	290	Seminar in Urban Studies	1		E	TTh	2:00-3:40	4	SBS-A146
------	-----	--------------------------	---	--	---	-----	-----------	---	----------

*See Map page 12

<u>Code #</u>	<u>Department & No.</u>	<u>Type of Change</u>
8036	History 292 (Sec 3)	NEW SECTION ADDED - Special Topics:Communism in China-Sec 3-Shin - TTh-10:00-11:40 - 4 units - SBS-EO22
5100	Japanese 112	Now scheduled to meet MWThF - 9:00 in W-205
1434	Math 114	NEW SECTION ADDED - Diff. & Integral Calc. III - Sec 2 - Hart - MTWF - 12:00 - 4 units - W-243
1703	Music 112	Now scheduled to meet MTWTh - 1:00
1704	Music 180	Now scheduled to meet MTW - 2:00
1718	Music 291 (Sec 2)	CANCELLED
1719	Music 295	Now scheduled to meet TTh - 10:00
1722	Music 290****	NEW SECTION ADDED - Individual Lessons-Brass Instruments - Sec 1 - Camesi - 1 unit - days, hours & room TBA
0312	Philosophy 271	CANCELLED
0313	Philosophy 285	Now scheduled to meet MWThF - 11:00
2512	Physics 210	CANCELLED
8223	Poli. Sci. 241	NEW SECTION ADDED - Politics of East Asia - Sec 1 - Lee - MW - 6:00-7:40 - 4 units - SBS-FO25
5004	Psych 125 (Lab 1)	Now scheduled to meet W - 12:00-2:30
5043	Psych 125 (Lec 2)	NEW SECTION ADDED - Introduction to Research Methods-Lec Sec 2 - Moinat - ThF - 4:00-5:40-4 units-SBS-B115
5044	Psych 125 (Lab 2)	NEW SECTION ADDED - Introduction to Research Methods-Lab Sec 3 - Moinat - T - 6:00-8:30 pm - SBS-B115
5014	Psych 218 (Lab)	Now scheduled to meet T - 12:00-2:30
5043	Psych 218 (Lab)	NEW SECTION ADDED - Comparative Psychology-Lab Sec 2-Adams-T - 3:00-5:30 - SBS-A132
5039	Psych 231 (Lec 2)	NEW SECTION ADDED - Measurement in Psych-Lec Sec 2-Stodola MWTh - 11:00 - 4 Units - SCC-K147
5040	Psych 231 (Lab 2)	NEW SECTION ADDED - Measurement in Psych-Lab Sec 2-Stodola-T - 12:00-1:40 - SCC-K147
5022	Psych 258	CANCELLED
5027	Psych 283 (Sec 1)	Now scheduled to meet MW - 6:00-7:40 in SBS-D125
5028	Psych 283	CANCELLED
5038	Psych 292	NEW SECTION ADDED - Seminar on Special Topics in Psychology - Sec 1 - Bercovici-"V"-TTh-4:00-5:40-4 units-SBS-F017
5041	Psych 297	NEW SECTION ADDED - Directed Research-"L"-4 units-TBA
5042	Psych 298	NEW SECTION ADDED- Independent Study-"L"-4units TBA
8343	Sociology 120 (Lab-1)	Now scheduled to meet Th - 8:00-9:40 am
8317	Sociology 220	CANCELLED
8333	Sociology 260	CANCELLED
8353	Sociology 295 (Sec 4)	NEW SECTION ADDED - Senior Seminar in Sociology - Sec 4 - Griner - MW-12:00-1:40-4 units-SBS-D115
3406	Spanish 232	Now scheduled to meet MW - 2:00-3:40 in SBS-F017
1900	Theater Arts 290	Now scheduled to meet MWThF - 10:00
0404	20th Cent 200 (Sec 3)	Now scheduled to meet TTh - 4:00-5:40
0405	20th Cent 290 (Sec 3)	NEW SECTION ADDED - Seminar in 20th Century Thought & Expression-Sec 3-Brown-"H"-MW-4:00-5:40-4 units-SBS-A146

NOTE:

Other changes, too recent to be included on this listing, are posted on the bulletin board outside the Office of Admissions and Records.

CHANGES TO SPRING CLASS SCHEDULE *

<u>Code #</u>	<u>Department & No.</u>	<u>Type of Change</u>
4901	Amer. Studies 290	CANCELLED
4903	Amer. Studies 290	Now scheduled to meet MW 1:00-2:40 in SBS-A132.
7709	Anthropology 240	Now scheduled to meet MW 6:00-7:40 pm in SBS-E026
7711	Anthropology 275	CANCELLED
1517	Art 291	CANCELLED
6006	Beh. Sci. 410	CANCELLED
5739	Biology 232	NEW SECTION ADDED - Ecology (lec) - Sec 2 - Epley -"F"- MW - 6:00-7:15 - 4 units - SCC-F172
5740	Biology 232	NEW SECTION ADDED - Ecology (lab) - Sec 2 - Epley - MW - 7:20-8:45 pm - SCC-E127
9604	Bus. Adm. 401	CANCELLED
2821	Chemistry 251	CANCELLED
3600	Chinese 112	Now scheduled to meet MWThF-11:00 in W-246
7925	Economics 260	NEW SECTION ADDED - Management in Theory & Practice - Sec 2 - Stage - MW - 8:00-9:40 pm - 4 units - SBS-D125
3711	Education 280	Now scheduled to meet W - 5:30-8:00 in SCC-K148.
3737	Education 252	NEW SECTION ADDED - Language Development of the Child-Sec 1- Bercovici/Francis-"V"-Sat-9:00-12:00-4 units-SBS-F017
3739	Education 260	NEW SECTION ADDED - Workshop in Methods:Math-Sec 3C-"V"- 3 units - Days, hours & room TBA
3719	Education 445	Now scheduled to meet MW - 8:00-9:40 pm
3738	Education 297	NEW SECTION ADDED - Seminar in Early Childhood Teaching- Sec 4-Epps-"V"-M-6:00-7:40 pm-2 units-SBS-A110
9502	English 100	CANCELLED
9514	English 102 (Sec 9)	CANCELLED
9515	English 102 (Sec 10)	CANCELLED
9517	English 102 (Sec 12)	CANCELLED
9534	English 238	Now scheduled to meet MWThF - 3:00.
9542	English 262	Now scheduled to meet MTWF - 1:00.
9550	English 295	CANCELLED
9552	English 295 (Sec 3)	Now scheduled to meet 8:00-9:40 pm - MW in SBS-B040.
3105	French 232	CANCELLED
3106	French 252	CANCELLED
3108	French 298	NEW SECTION ADDED - Independent Study -"H"-4 units - TBA
8122	Geography 115	NEW SECTION ADDED - Map & Aerial Photograph Interpretation- Sec 1-Forbes-MW-1:00-2:40-2 units-SBS-B009
8108	Geography 150 (Sec 1)	CANCELLED
8109	Geography 150 (Sec 2)	CANCELLED
8123	Geography 150	NEW SECTION ADDED - Field Study in Geog (Physical Emphasis)- Sec 4-Paige/Bullock-F-10:00-2 units-SBS-A004-Sat. fieldtrip
8124	Geography 298	NEW SECTION ADDED - Independent Study-4 units-TBA
7119	H&PE 101 (Sec 16)	Now scheduled to meet TTh - 10:00
7133	H&PE 101 (Sec 19)	Now scheduled to meet MW - 2:00
7122	H&PE 150 (Sec 1)	Now scheduled to meet MTWThF - 1:00-3:00.
7124	H&PE 150 (Sec 3)	Now scheduled to meet MTWThF - 3:00-6:00.
7125	H&PE 150 (Sec 4)	Now scheduled to meet MW 12:00-2:00.
8015	History 237 (Sec 2)	Now scheduled to meet MW - 12:00-1:40 in SBS-E120
8037	History 252 (Sec 2)	NEW SECTION ADDED - History of American Thought-Sec 2-Cady- TTh-8:00-9:40 am-4 units-SBS-A110
823	History 257	Now scheduled to meet MTThF - 9:00 - SCC-E167
8024	History 264	Now scheduled to meet MTThF - 2:00 - SBS-F125
8029	History 292 (Sec 2)	Now scheduled to meet WF - 12:00-1:40 in SBS-F021

NEW ROOM ASSIGNMENTS - SPRING QUARTER

<u>Course</u>	<u>Room</u>	<u>Course</u>	<u>Room</u>	<u>Course</u>	<u>Room</u>
<u>Afro-Amer. St.</u>		<u>Behavioral Sci.</u>		<u>Business Admn</u>	
290	SCC-E143	290-Sec 1	SBS-B043	401-Sec 1	SBS-A116
<u>Am Bus & Econ Sys</u>		290-Sec 2	SBS-B138	410	SBS-A116
290	SBS-E026	290-Sec 3	SBS-B138	411	SBS-A116
<u>Amer. Studies</u>		290-Sec 4	SBS-B131	420	SBS-A116
290-Sec 1	SBS-B010	290-Sec 5	SBS-A110		
290-Sec 3	SCC-E143	290-Sec 6	SBS-G026	<u>Chemistry</u>	
290-Sec 4	SBS-A132	416	SBS-E016	100-Sec 1	SCC-E173
<u>Anthropology</u>		420	SBS-E016	100-Sec 2	W-245
110	SBS-D125	440	SBS-E016	100-Sec 3	W-231
200	SBS-D125			100-Sec 4	SCC-K147
212	SBS-D125	<u>Biology</u>		102-Sec 1	W-231
215	SBS-E026	102-Lec 1	SCC-F166	102-Sec 2	W-231
230	SBS-G026	102-Lec 2	SCC-E157	102-Sec 3	W-231
232	SCC-F172	102-Lec 3	SCC-E167	102-Sec 4	W-231
235	SBS-E022	102-Lab 1	SCC-E127	110-Lec 1	SCC-J146
238	SBS-B001	102-Lab 2	SCC-F130	110-Lab 1	W-106
240	SBS-E026	102-Lab 3	SCC-E127	110-Lab 2	W-106
250	SCC-E167	102-Lab 4	SCC-E127	114-Lec 1	W-231
260	SBS-G026	102-Lab 5	SCC-F150	114-Lab 1	W-106
285	SCC-K147	110-Lec 1	W-249	114-Lab 2	W-106
292	SBS-A104	110-Lab 1	SCC-E127	114-Lab 3	W-106
<u>Art</u>		114-Lec 1	SCC-F172	114-Lab 4	W-106
100-Sec 1	ERC-D126	114-Lab 1	SCC-E127	213	W-105
100-Sec 2	ERC-D126	114-Lab 2	SCC-F150	214	W-246
100-Sec 3	ERC-G149	210-Lec 1	W-249	224-Lec 1	W-248
100-Sec 4	ERC-D126	210-Lab 1	SCC-F158	224-Lab 1	W-108
100-Sec 5	ERC-D126	214-Lec 1	SCC-E145	250	W-200E
175	SBS-B010	214-Lec 2	W-249	270-Lec 1	W-205
179	ERC-D131	214-Lab 1	SCC-E127	270-Lab 1	W-108
180	ERC-D131	214-Lab 2	SCC-E127	286	SCC-E145
190	ERC-D134	220-Lec 1	SCC-D138		
210	ERC-D126	220-Lab 1	SCC-F158	<u>Chinese</u>	
220	ERC-G149	232-Lec 1	SCC-F172	112	W-246
231	ERC-G149	* 232-Lab 1	SCC-E127	<u>Earth & Space Sciences</u>	
236	ERC-G149	246-Lec 1	SCC-F166	290	SCC-E145
250	ERC-G149	246-Lab 1	SCC-F150	<u>East Asian Studies</u>	
253	ERC-D126	252-Lec 1	SCC-E145	290	SBS-E016
254	ERC-D126	252-Lab 1	SCC-F150		
255	ERC-G149	256-Lec 1	SCC-F166		
280	ERC-D131	256-Lab 1	SCC-F150		
295	ERC-D126	294-Lec 1	SCC-D154		
		295-Lec 1	SCC-K148		
		295-Lab 1	SCC-F150		
		297	SCC-F150		
		412	SBS-G022		
		*232-Lec 2	SCC-F172		
		232-Lab 2	SCC-E127		

SCC = Small College Campus

SBS = Social & Behavioral
Sciences Building

ERC = Educational Resources
Center (Library Bldg)

W = Watt Campus

<u>Course</u>	<u>Room</u>	<u>Course</u>	<u>Room</u>	<u>Course</u>	<u>Room</u>
<u>Economics</u>		<u>Education</u>		<u>English</u>	
100	SCC-F172	445	SBS-DO21	265	SCC-D154/EI
110-Sec 1	SCC-E167	451	SCC-E157	267-Sec 1	SCC-D154/EI
110-Sec 2	SBS-DO25	453	SBS-DO21	267-Sec 2	SCC-D154/EI
111	SBS-FO21	455	SBS-DO21	269	SCC-E157
211	SCC-K147	461	SBS-BO01	270	SCC-D154/EI
213-Sec 1	SCC-K148	471	SCC-K148	281	SBS-G022
213-Sec 2	SBS-EO22	476	SBS-BO01	294	W-205
215-Sec 1	SBS-FO25	485	SBS-BO01	295-Sec 2	SBS-A116
215-Sec 2	SBS-FO21			295-Sec 3	SBS-BO40
222	SBS-DO25	<u>English</u>		296-Sec 1	SCC-E173
227	SBS-G026	100-Sec 1	SBS-G022	296-Sec 2	SCC-E153
230	SCC-K147	100-Sec 2	SBS-G022	434	SBS-BO40
245	SCC-E143	101-Sec 1	SBS-DO21	449	SCC-D154
254	SCC-E167	101-Sec 2	SBS-BO40	491-Sec 1	SCC-D154
255-Sec 1	SBS-FL25	101-Sec 3	SBS-BO40	491-Sec 2	SBS-A116
255-Sec 2	SCC-E167	102-Sec 1	SBS-BO40	493	SCC-F166
260-Sec 1	SBS-FL25	102-Sec 2	W-205	494	SCC-E153
260-Sec 2	SBS-D125	102-Sec 3	SBS-DO21		
262	SBS-BO43	102-Sec 4	SBS-DO21	<u>Foundations of Natural Science</u>	
275	SCC-E167	102-Sec 5	SBS-BO40	290	W-253
280	SBS-EO26	102-Sec 6	SBS-DO21		
285	SBS-EO26	102-Sec 7	SBS-BO40	<u>French</u>	
295	SBS-A116	102-Sec 8	SBS-G022	110	SBS-D115
		102-Sec 11	SBS-G022	112	W-249
		111	SBS-G022	122	W-249
<u>Education</u>		121	SCC-J127	210	SBS-DO21
210-Lec 1	SBS-B131	130	SCC-E157	270	SBS-A104
210-Lab 1	SBS-B131	210	SBS-DO21		
210-Lec 2	SBS-B131	213	SBS-G022	<u>Geography</u>	
210-Lab 2	SBS-B131	216	SBS-BO01	100-Lec 1	SBS-EO26
222	SBS-A104	220-Sec 1	ERC-B124	100-Lab 1	SBS-A010
240	SCC-K148	220-Sec 2	SCC-J127	100-Lab 2	SBS-A004
250	ERC-A115	222	ERC-B118	100-Lec 2	SBS-EO26
252	SBS-FO17	230	SCC-E157	100-Lab 1	SBS-A004
260-Sec 1A	SBS-A104	231-Sec 1	SBS-EO22	100-Lab 2	SBS-A004
260-Sec 2B	SBS-BO01	231-Sec 2	SCC-F166	110-Lec 1	SBS-A110
260-Sec 3C	TBA	235-Sec 1	SBS-E120	110-Lab 1	SCC-J146
270-Sec 1A	SBS-A104	235-Sec 2	SCC-E157	115	SBS-BO09
270-Sec 2B	SBS-A104	237	W-245	150-Sec 3	SBS-A004
280	SCC-K148	238	W-243	150-Sec 4	SBS-A004
297-Sec 1A	SBS-E131	240-Sec 1	SCC-E157	205-Lec 1	SBS-A004
297-Sec 2B	SBS-E131	240-Sec 2	SCC-E157	205-Lab 1	SBS-BO09
297-Sec 3C	TBA	241	SCC-E157	206-Lec 1	SBS-A110
297-Sec 4	SBS-A110	243	SCC-E157	206-Lab 1	SBS-BO09
397-Sec 1D	SBS-E138	244	SCC-E157	222-Lec 1	SBS-BO37
397-Sec 2E	SBS-B138	245	SBS-G022	222-Lab 1	TBA
400	SBS-DO21	250	SBS-G022	224	SBS-A110
420	SBS-BO01	262	W-243	235	SCC-J146
431	SBS-BO01			260	SBS-EO26
				264	SBS-BO37
				270	SBS-BO37

<u>Course</u>	<u>Room</u>	<u>Course</u>	<u>Room</u>	<u>Course</u>	<u>Room</u>
<u>German</u>		<u>History</u>		<u>Mathematics</u>	
110	W-250	280	SCC-K148	230	W-200E
111	W-249	275	SBS-F025	236	W-253
112	W-241	284	SCC-J146	238	W-246
		292-Sec 1	SBS-F025	250	W-246
<u>Health & PE</u>		292-Sec 2	SBS-F021	252	W-252
100-Lec 1	W-253	386	SBS-A110	266	W-252
100-Lec 2	W-253	292-Sec 3	SBS-E022	342	SCC-J146
100-Lec 3	W-253				
136	W-232A	<u>Information Systems</u>		<u>Music</u>	
203	W-253	290	SCC-K148	100-Sec 1	ERC-D126
290	SCC-F166			100-Sec 2	ERC-A127
NOTE: All Health & PE		<u>Japanese</u>		100-Sec 3	ERC-A127
courses not listed		112	W-205	112	ERC-A121
above are scheduled				180	ERC-A103
to meet in the FH.		<u>Latin-American Studies</u>		181	ERC-A115
		290	SBS-G026	190	ERC-A109
				191-Sec 1	ERC-A121
<u>History</u>		<u>Linguistics</u>		191-Sec 2	ERC-A121
100-Sec 1	SBS-B037	290	W-205	191-Sec 3	ERC-A121
100-Sec 2	SBS-B037			191-Sec 4	ERC-A115
100-Sec 3	SBS-D125	<u>Mathematics</u>		192	ERC-A127
150-Sec 1	SBS-E022	010-Sec 1	W-246	212	ERC-A121
150-Sec 2	SBS-E016	010-Sec 2	W-253	215	ERC-A121
150-Sec 3	SBS-A116	100-Sec 1	W-246	218	ERC-A115
150-Sec 4	SBS-B001	100-Sec 2	W-200E	252	SCC-E173
210-	SBS-F021	100-Sec 3	W-200E	255	ERC-A115
220	W-244	100-Sec 4	W-231	270	ERC-A103
222	SBS-B109	100-Sec 5	W-244	290	TBA
224	SBS-E022	100-Sec 6	W-246	291	ERC-A121
228	SBS-B037	110-Sec 1	W-232A	295	ERC-A109
232	SCC-E143	110-Sec 2	W-244	296	ERC-A121
234	SBS-F025	112-Sec 1	W-231		
237-Sec 1	SBS-E120	112-Sec 2	W-253	<u>Philosophy</u>	
237-Sec 2	SBS-E120	* 114	W-246	200-Sec 1	W-231
242	SBS-F021	116	W-200E	200-Sec 2	W-233
247	SBS-F025	150-Sec 1	W-253	200-Sec 3	W-233
251	SBS-F125	150-Sec 2	W-253	200-Sec 4	SBS-B043
252-Sec 1	SBS-B043	150-Sec 3	W-246	217	W-243
252-Sec 2	SBS-A110	150-Sec 4	SCC-E143	220	W-243
253	SBS-B043	160	SCC-F166	240	W-243
254-Sec 1	SBS-E022	162	W-200E	250	W-243
254-Sec 2	SCC-J146	210	W-200E	252	W-243
255	SBS-A104	212	W-252	255	W-233
257	SCC-E167	214	W-200E	260	W-233
264	SBS-F125	220	W-232A	270-Sec 1	W-233
272	SBS-F017	* 114-Sec 2	W-243	270-Sec 2	W-233
				272	SBS-A104
				285	W-233
				295	W-249

<u>Course</u>	<u>Room</u>	<u>Course</u>	<u>Room</u>	<u>Course</u>	<u>Room</u>
<u>Physics</u>		<u>Psychology</u>		<u>Sociology</u>	
102-Sec 1	SCC-E145	100-Sec 1	SBS-D025	110	SBS-D025
102-Sec 2	SCC-E145	100-Sec 2	SBS-D025	120-Lec 1	SBS-A116
102-Sec 3	SCC-E143	100-Sec 3	SBS-D025	120-Lab 1	SBS-A116
114-Lec 1	SCC-E145	125-Lec 1	SBS-F125	120-Lec 2	SBS-A110
114-Lab 1	SCC-F138	125-Lab 1	SBS-A146	120-Lab 2	SBS-A110
114-Lab 2	SCC-F138	125-Lab 2	W-244	120-Lec 3	SBS-B010
116	SCC-E145	125-Lec 2	SBS-B115	120-Lab 3	SBS-B115
150-Lec	SCC-E143	125-Lab 1	SBS-B115	150-Sec 1	SBS-E016
150-Lab	SCC-F158	150-Sec 1	SCC-E143	150-Sec 2	SCC-E143
200-Sec 1	SCC-E145	150-Sec 2	W-244	150-Sec 3	SBS-E016
200-Sec 2	SCC-E145	205-Sec 1	SBS-F021	200	SBS-F125
206	SCC-E157	205-Sec 2	SBS-F025	205-Sec 1	SBS-F016
252	SCC-E145	210-Lec	SBS-A116	205-Sec 2	SBS-E016
260	SCC-K148	210-Lab	SBS-A132	205-Sec 3	SBS-G026
281	SCC-F138	212	SCC-K147	205-Sec 4	SBS-B010
		218-Lec	SBS-D021	206-Lec 1	SCC-E143
		218-Lab 1	SBS-A132	206-Lab 1	SBS-A146
		218-Lab 2	SBS-A132	210	SBS-E120
		231-Lec 1	SBS-A116	211	SBS-E016
		231-Lab 1	SBS-B037	213	SCC-F172
		231-Lec 2	SCC-K147	216	SBS-E120
		231-Lab 2	SCC-K147	217	SBS-D125
		240	SBS-G022	221	SBS-E120
		250-Sec 1	SBS-G026	229	SBS-E120
		250-Sec 2	SBS-F125	235-Sec 1	SCC-J146
		250-Sec 3	SBS-F025	235-Sec 2	SBS-F125
		250-Sec 4	SBS-D125	240	SBS-F021
		260-Sec 1	SBS-D025	251-Sec 1	SBS-A132
		260-Sec 2	W-244	251-Sec 2	SBS-G026
		263	SCC-F172	251-Sec 3	SBS-G026
		265	SCC-K147	251-Sec 4	SBS-B043
		276	SCC-E173	251-Sec 5	SBS-B043
		277	SBS-B131	251-Sec 6	SBS-F016
		280	SBS-A104	254	SBS-E120
		282	SBS-F025	255-Sec 1	SBS-G026
		283-Sec 1	SBS-D125	255-Sec 2	SBS-E120
		292	SBS-F017	255-Sec 3	SBS-E120
		295-Sec 1	SCC-K147	255-Sec 4	SBS-D125
		295-Sec 2	SBS-A116	257	SBS-A116
		440	W-248	265	SBS-E120
				269	SBS-B043
				270-Sec 1	SBS-G026
				270-Sec 2	SBS-E016
				270-Sec 3	SBS-E138
				295-Sec 1	SBS-B010
				295-Sec 2	SBS-A146
				295-Sec 3	SBS-B138
				295-Sec 4	SBS-D115
				450	SBS-E016
<u>Political Science</u>					
100-Sec 1	SCC-E167				
100-Sec 2	SBS-D025				
100-Sec 3	SBS-D025				
151	SBS-E022				
210	SCC-E167				
214	SBS-G022				
234	SBS-F021				
238	SBS-B043				
239	SBS-D025				
248	SBS-D025				
250	SBS-F025				
251	SBS-D025				
252	SBS-D025				
254	SBS-B037				
260	SBS-E026				
261	SBS-B043				
270	SBS-B043				
295	SBS-A104				
241	SBS-F025				

<u>Course</u>	<u>Room</u>
<u>Spanish</u>	
110	W-245
112	W-245
120	W-250
122	W-245
210	SBS-DO21
211	SBS-D115
214	SBS-D115
232	SBS-FO17
256	W-245
270	SBS-EL16
295	SCC-EL53
<u>Theater Arts</u>	
290	SCC-D154
<u>20th Century T & E</u>	
200-Sec 1	SCC-F172
200-Sec 2	SBS-E022
200-Sec 3	W-250
290-Sec 1	SBS-EL16
290-Sec 2	W-205
290-Sec 3	SBS-A146
<u>Urban Studies</u>	
290	SBS-A146