

*California State University, Dominguez Hills*

# SESSIONS

# Summer '87



**1** *First Session*  
*June 3 through July 14, 1987*

**2** *Second Session*  
*June 22 through July 31, 1987*

*Many evening classes.*

*Includes  
University Extension.*

# Summer '87 at CSU Dominguez Hills

## WHAT'S IN THIS BULLETIN

If you want to add a stimulating educational dimension to your or your child's summertime activities, CSUDH has a program for you.

Described in this 1987 Summer Sessions Bulletin are a variety of university credit and non-credit courses and programs. Pages 7-24 of the Bulletin are devoted to the description and schedule of summer academic courses, offered on the CSUDH campus. If you are interested in completing a degree, obtaining theory and skills in a specific field for career advancement, or exploring new subjects for personal enrichment, you probably will find an appropriate course in the Summer Sessions Bulletin. All of these courses are offered for residence credit which can be applied toward a degree at CSUDH or at another institution.

In pages 24-28 of this Bulletin you will discover our summer Extension schedule, consisting of shorter, non-credit courses and workshops for adults and children. These programs meet either on campus or in our classrooms at the Redondo Beach Community Center. You may enroll in both degree-credit (Summer Sessions) and non-credit courses during the summer. But please familiarize yourself with the policies and procedures pertaining to Summer Sessions or Extension enrollment.

If you have questions about the Extension program not answered in this Bulletin, telephone 213/516-3741. If you have questions about Summer Sessions, telephone 213/516-3746.

## SUMMER SESSIONS DATES

**First Session:**  
June 3 - July 14

**Second Session:**  
June 22 - July 31

## CSUDH CAMPUS

CSU Dominguez Hills is located in a park-like setting on 346 acres. The land once was part of the Rancho San Pedro which now encompasses most of the South Bay area of Los Angeles County. Rancho San Pedro was established in 1784 by Juan José Dominguez as a land grant from the king of Spain.

Today, students at CSU Dominguez Hills may choose from more than 100 academic programs and concentrations at the bachelor's and master's levels. The academic offerings include liberal arts and sciences and applied programs. The University also features the innovative Small College, which is an interdisciplinary college-within-a-university. Classes at CSU Dominguez Hills are small, and the instruction is personalized.

The campus is home of the 7-Eleven Olympic Velodrome, which hosted the track cycling events of the 1984 Olympic Games. Excellent recreational facilities, tennis courts, tracks and swimming pool, round out the study program.

The Summer Sessions student body is diverse and interesting. College students from across the country as well as professionals and first-time college students study together with predominately regular session CSUDH faculty.

## SUMMER SESSIONS PROGRAM

1987 Summer Sessions consists of two separate and overlapping six-week Summer Sessions offering about 250 courses chosen from the regular University *Catalog* and a number of special summer-only courses which are designed to enhance our summer academic program. All Summer Sessions courses are offered for *residence credit, which is applicable toward degrees offered at CSUDH or other universities.*

CSUDH Summer Sessions is a financially self-supporting program. This means that instructional costs are paid entirely through student fees. All Summer Sessions students, resident and non-resident, pay the same fee per unit and one-time student fees, as indicated in this schedule of classes.

## TABLE OF CONTENTS

Admission .....	1
Registration .....	1
Academic Calendar .....	2
Tuition and Fees .....	3
Academic Information .....	4
Student Services .....	5
Courses of Instruction .....	7
Anthropology .....	7
Art .....	7
Behavioral Sciences .....	7
Biology .....	7
Business .....	8
Chemistry .....	9
Communications .....	9
Computer Science .....	9
Dance .....	9
Earth Sciences .....	10
Economics .....	10
Education .....	10
English .....	12
Geography .....	12
Health Sciences .....	12
History .....	13
Humanities .....	13
Library .....	13
Linguistics .....	13
Marriage and Family Counseling .....	13
Mathematics .....	13
Mexican American Studies .....	14
Music .....	14
Philosophy .....	15
Physical Education .....	15
Physics .....	15
Political Science .....	15
Psychology .....	15
Public Administration .....	16
Science, Mathematics and Technology .....	16
Sociology .....	16
Spanish .....	16
Theatre Arts .....	16
Special Summer Credit Programs .....	17
Summer Sessions Course Schedule .....	18
Extended Education Summer Courses .....	24
Maps .....	29
Summer Sessions	
Registration Form .....	inside back cover

Although care is taken to ensure the accuracy of all information in this *Bulletin*, there may be unintended error, and changes or deletions without notification.

## WHO MAY REGISTER IN SUMMER SESSIONS

College students, graduates of high school, or individuals sufficiently knowledgeable to profit from college courses may register for Summer Sessions. High school juniors and seniors, with letters of recommendation, may enroll in lower-division courses (see details on page 5).

If you are a visiting student, it is especially important that you read the section on classification and numbering of courses and the description of the courses you intend to take to insure that you have fulfilled all prerequisites for the course(s) and that the course(s) will satisfy your academic program.

Registration in CSUDH Summer Sessions courses does not constitute admission to the University as a regular student. If you are interested in admission to the University, inquire or apply at the University Information and Service Center, Small College Complex A-130, 213/516-3696.

## HOW TO USE THIS BULLETIN TO REGISTER

Registration in CSUDH Summer Sessions is simple, and in most cases can be completed entirely through a mail-in procedure. Formal application to the University is *not* necessary, and transcripts are *not* required.

Some Summer Sessions courses, however, have prerequisites or special qualifications which are noted in the course descriptions. In certain cases, before the request to register can be processed, permission to enroll in a course first must be obtained from the instructor or departmental office, or students may be asked to provide proof of completion of prerequisites.

To attend Summer Sessions classes, registration for courses must be completed, including full payment of fees, by the appropriate deadline dates (refer to Calendar on page 2). *For information on registering in University Extension courses, please see page 28.*

**To register, use this Bulletin as follows:**

1. Select the course you wish to take from the Summer Sessions course descriptions beginning on Page 7. Courses are listed alphabetically by academic department. Departments within the School of Management and Center for Quality Education are listed alphabetically under business Administration and Education. Read descriptions carefully, noting prerequisites or special consents.
2. After selecting courses, turn to the Summer Sessions class scheduling information, stating on page 18. This listing indicates which Session (1st or 2nd) the course is offered in, and highlights dates of intensive and offcycle

courses; these special course dates are shown under the course title.

3. Read the information and policies section of this bulletin carefully; for policies on Summer Sessions, see page 2. Failure to understand fully withdrawal and refund policies may affect your academic status and cost you money.

*Summer Sessions students are responsible for knowing the policies and deadlines governing their enrollments.*

4. Carefully complete the Summer Sessions Registration Form on the inside of the back cover of this Bulletin. (If you are registering for both Summer Sessions and Extension courses, please use the separate registration forms provided and write separate checks.) For Advance Registration, mail or deliver the forms and payment to the Summer Sessions office (ERC C508, CSUDH, Carson, Ca. 90747) by *May 20* for First Session courses or *June 8* for Second Session courses. Please enclose a stamped, self-addressed envelope for your validated receipt/ID card. For information about other ways to register please see below.

## Ways to Register in Summer Sessions

(For *adding* courses to your schedule after you have registered for a Session, refer to add instructions.)

### Advance Registration

The procedure described above is the most convenient method of registering in Summer Sessions. To insure your seat in a course, we recommend using advance registration.

Advance registration can be completed by mailing the Summer Sessions registration form with total fee payment and a stamped-self addressed envelope to the Summer Sessions Office by *May 20* for First Session and *June 8* for Second Session. Advance registrations also may be delivered to the Office of Summer Sessions during regular working hours, 8 a.m.-5 p.m., Monday through Friday, until the advance registration deadline for each Session. The Summer Sessions Office is located in the University Extension office, Educational Resources Building, room C-508.

### General Walk-in Registration

If you are not able to submit your registration and complete payment of fees by the deadline dates for advance registration, you can register for Summer Sessions on general registration days which will be held immediately preceding the start of each Session.

General walk-in registration will take place in the Small College Complex, in and around the Admissions and Records office. Report first to SCC E139 to begin the process. General registration will take place *June 1 and 2, Monday and Tuesday, 10 a.m.-6 p.m. for First Session registration, and on June 19, Friday, 10 a.m.-6 p.m. for Second Session registration.*

Please bring the completed Summer Sessions registration form in this Bulletin and complete fee payment. Requests for enrollment will be processed on a first-come basis.

### Late Registration

(For *adding* courses to a program, see add procedures.)

The late registration period begins on the first day of the Session. Students may register for a Session during the first two weeks of the Session. Registration for First Session will be accepted until *June 16*; for Second Session until *July 3*. Completion of late registration is dependent upon availability of seats for each class and is subject to a \$25.00 late registration processing fee.

Report to the Summer Sessions office (ERC C508) for a Permit to Late Register. Then obtain the instructor's signature approval on the permit for each course and return the permit to the Summer Sessions office to complete the registration and fee payment. Registration is not official until fees are paid. The Summer Sessions Office is open Monday through Thursday 8:00 a.m. to 6:00 p.m., June 3-July 2, and 8:00 a.m. to 5:00 p.m. on Friday.

### Non-Standard Date or Offcycle Courses

In order to register for a course which begins after the first week of the Session (special dates are listed with class scheduling information), the student must complete the late registration procedure by the stipulated deadline date of the Session the course begins in.

### Program Verification and Student Identification

If you use advance registration, a Summer Sessions identification/receipt card is sent by mail in the self-addressed stamped envelope you provide. It is important to retain this card, as it is required for using University resources, including the library and purchasing textbooks, and for completing academic transactions. If you do not receive an identification/receipt card by the first day of your scheduled class(es), ATTEND CLASS AS SCHEDULED. Your receipt will arrive shortly.

An official University Enrollment Report is mailed by the third week of the Session. Please check this report to verify that you have been enrolled in the correct courses or sections of courses. If there are discrepancies, report immediately to the Summer Sessions office (ERC C-508).

## CHANGE OF PROGRAM

### Adding Courses

If you wish to add a course after you have registered for a Session, you must file a Change of Program form available in the Summer Sessions Office (ERC C508).

**Add, prior to first week.** Students may not add or exchange courses prior to the first day of the Session.

**Add, first week** (First Session, June 3-9; Second Session, June 22-26). During the first week of a Session, adding a course to your program requires the instructor's signature on the change of program form.

**Add, second week and until the beginning of final exam week** (First Session, June 10 through July 7; Second Session, June 29 through July 24). The instructor's and the school dean's or associate dean's signatures are required on the change of program form. Return the change of program to the Summer Sessions Office. Non-matriculated or visiting students obtain the signatures of the instructor and the Dean of Extended Education.

No adding of courses is permitted during final exams week. (First Session, July 8-14; Second Session July 27-31.)

Students may exchange one class for another *within* the same Session without penalty, if the unit and tuition value is the same.

If you will exceed a maximum unit load by adding courses, you also must submit a Petition to Exceed Maximum Units, available in the Summer Sessions Office (refer to policy on maximum load).

### Drop/Partial Withdrawal

If you decide to drop a course, you must file a change of program form with the Summer Sessions Office and an application for a refund of fees, if eligible. (If you are dropping all courses you enrolled in, follow withdrawal procedures.) Refer also to Refund policies.

**Drop, prior to first day of Session.** To drop a course before a Session begins, file a change of program form and an application for refund of fees in the Summer Sessions office.

**Drop, first week** (First Session, June 3-9; Second Session, June 22-26). Summer Sessions students may drop or withdraw from a course prior to and during the first week of a Session without permanent record of enrollment, or "W" on transcript, and without the instructor's signature.

**Drop, second through fifth weeks** (First Session, June 9-July 7; Second Session, June 29-July 24). During the second and until the final week of the Session the instructor's and the school dean's or associate dean's signatures for each course are required on the change of program form to drop. Non-matriculated or visiting students need the signatures of the instructor and the Dean of Extended Education.

*If a student drops or withdraws after the first week of a Session, a grade of "W" for the course(es) will appear on the student's permanent transcript.*

### Complete Withdrawal from Session

To withdraw from all courses you requested, complete and submit a Withdrawal form, and, if you are eligible for a refund, an application for a refund of fees. Withdrawal forms are available in the Summer Sessions office.

**Complete withdrawal, prior to first day of Session.** If you find it necessary to drop all of your courses before a Session begins, you must cancel your registration and you may be eligible to receive a full refund of fees, less a \$10 nonrefundable processing fee. *A completed withdrawal form and a request for a refund of fees must be received by the Summer Sessions office by June 2 for First Session or by June 19 for Second Session.*

**Complete withdrawal, first week** (First Session, June 2-9; Second Session June 22-26). You may withdraw from the Session during the first week without a record of enrollment and without the instructor's signature. Complete a withdrawal form and an application for refund of fees and submit these forms to the Summer Sessions office.

**Complete withdrawal, second through fifth week** (First Session, June 10-July 7; Second Session, June 29-July 24). A grade of "W" for each course appears on the permanent transcript if student withdraws after the first week of the Session and is doing passing work. To withdraw from all courses after the first week of instruction, complete a withdrawal form, obtain the signatures of the instructor and school dean (or Dean of Extended Education, if you are not a regular student) on the withdrawal form. Complete an application for any refund of fees if you are eligible. Submit these completed forms to the Summer Sessions office.

### Late Withdrawal

Withdrawal from classes during exam week (last week of the Session) is not permitted, except in such cases as accident or serious illness where circumstances causing the withdrawal are clearly beyond the student's control, and the assignment of a grade of Incomplete is not practical. Such requests require a Petition with the signature and approval of the instructor and the school dean (Dean of Extended Education for visiting or non-matriculated students). This petition is available in the Summer Sessions office and must be filed in the Summer Sessions office (ERC C508) with documentation by the last day of the Session in which the student was enrolled (First Session, July 14; Second Session, July 31). If eligible for a refund of fees, a student must file an application for refund of fees when the petition is submitted.

## SUMMER SESSIONS CALENDAR

For complete details refer to policies, pages 1-3.

Activity	Session 1	Session 2	Offcycle Non-standard Date
Session Dates	June 3- July 14	June 22- July 31	Varies, see schedule
Advance registration deadline	May 20	June 8	May 20 or June 10 depending on start date
General Registration In-Person	June 1,2	June 19	—
First Day of Session	June 3	June 22	See class schedule
Late Registration period (\$25 fee assessed)	June 3- June 16	June 22- July 2	—
Last Day to Return Textbooks	June 10	June 26	—
Last Day to Drop/Withdrawal without Record of Enrollment (without "W" on record)	June 19	June 26	One week after course begins
Request for Credit-No Credit (CR/NC) Grading Option	June 9	June 26	One week after course begins
Last Day to Drop/Withdrawal (with "W" on record)	July 7	July 24	Until beginning of last week of instruction
Last Day to Add a Course to Program	July 7	July 24	—
Holiday, Campus Closed	July 3	July 3	—

## TUITION AND FEES

Fees and refunds are subject to change by the Trustees of the California State University. Full payment of all tuition and fees must be made at the time of registration or adding a course. Payment of tuition and fees may be made by check, money order, cash (except mail-in registration) and Visa or MasterCard/MasterCard. Checks and money orders are payable to CALIFORNIA STATE UNIVERSITY, DOMINGUEZ HILLS.

Until total fees are paid, registration is not valid.

### Tuition

Total course fee is listed in the Schedule with the course information. Some courses, such as laboratory or activity courses, have higher costs and may have fees that are higher than the standard instructional fee.

Standard instructional lecture fee per unit .....\$82.00  
Special course fee ..... as listed

### Fees

Student activity ... \$3.00 pay once per summer  
Student union ... \$10.00 pay once per summer  
Late registration ..... \$25.00  
Returned check ..... \$10.00  
Transcript ..... \$4.00 each

### Parking Fees

Six-week auto decal ..... \$13.50  
Nine-week auto decal ..... \$20.50  
Ten-week auto decal ..... \$22.50  
Short term, per week ..... \$2.25  
Two-wheeled vehicle ..... \$5.75  
Single entry/machines ..... \$0.75 (3 quarters)

Parking fees for Summer Sessions are not accepted during the advance registration period for the First Session. On and after the first day of general walk-in registration (June 1), parking decals may be purchased at the Cashiers Office, Small College Complex, B-135. June 1 through June 4 Cashier's office is open from 9:00 a.m. to 7:00 p.m. After June 4 the office is open 9:00 a.m. to 5:00 p.m. On Friday the office is open 9:00 a.m. to 4:00 p.m.

### Returned Checks

All returned checks, whether for insufficient funds or stop payments, are considered to be enforceable debts. A \$10.00 fee is charged for any dishonored check and a \$25.00 late registration fee. In such cases, the University will notify the student by letter that the check must be redeemed by a stipulated deadline. Failure to redeem a dishonored check by the stipulated deadline date will result in a hold placed on all academic records; transcripts, for instance, will not be issued if you have outstanding financial obligations to the University.

## REFUND OF TUITION FEE

**Refunds are not automatic. Even if the University cancels a scheduled course, you must make an application to have your tuition/fees refunded.** Refunds are subject to change without notice by the Trustees of the California State University System. Amounts of refund are calculated according to the Formula for Refunds established in Title 5 of the California Administrative Code.

Applications for refund of fees are available from the Summer Sessions Office. This form must be filed *in person* with the Summer Sessions Office. A cash register receipt and the tear off receipt from the add/drop form (if applicable) must accompany the written request. No transaction will be made without a receipt. Students must submit refund requests by the published deadlines (refer to Calendar and Refund Schedule). The effective date of the refund request (for purposes of calculating amount refunded) is the day it is received by the Summer Sessions Office.

Allow approximately six weeks from the date the request is received for processing refunds.

### Refund Schedule

The formula used for calculating the amount of fees refunded is as follows. If you apply for a refund prior to the first day of the Session, you may receive total tuition *minus \$10.00*. If you apply for a refund on the first or second day of the Session, you may receive total tuition *minus the fee for one unit*. During the remainder of the first week of the Session, if you apply, you may receive total tuition *minus one unit times 65%*. During the second week of the Session, if you apply, you may receive total tuition *minus one unit times 25%*. After the second week, none of the fee may be refunded.

Please note that tuition refunds are based upon the *start date of the Session* and not upon the first day a particular course meets.

### Six or Five-Week Sessions

No. of Units	Amt. paid	Prior to first day of Session	First two days of Session	Any other day of first week	Any day second week
1	\$ 82.00	72.00	none	none	none
2	164.00	154.00	82.00	53.30	20.50
3	246.00	236.00	164.00	106.60	41.00

### Three or Four-Week Sessions

No. of Units	Amt. paid	Prior to first day of Session	First two days of Session	Any other day of first week	Any day second week
1	\$ 82.00	72.00	none	none	none
2	164.00	154.00	82.00	53.30	none
3	246.00	236.00	164.00	106.60	none

### Parking Fee Refund Schedule

Six-week Session	Paid	First 10 days	Second 10 days	Balance of Session
Auto	13.50	9.00	4.00	none
Cycle	5.75	3.75	2.00	none

## Refund of Parking Fees

Written application for a refund of parking fees must be accompanied by a permit or decal which the University has issued. Applications for refund of parking fees are submitted to the Cashiers Office.

### Exchange of Fees

Students may not apply payment for units in the First Session to units in Second Session (or *vice versa*). Students must apply for a refund of fees for one Session and then register and pay fees for the other Session.

### Cancelled Course Policy

If you are enrolled in a course that is cancelled for any reason, you must arrange for another course by completing a change of program form or by making written application, in person, for a refund of fees. The University does not refund fees automatically in the event of a course cancellation.

## COURSE NUMBERING SYSTEM

The course numbering system for the University is based upon three-digit numbers, as follows:

- 000-099 Sub-collegiate courses, not for baccalaureate credit.
- 100-199 Lower division courses, normally taken in the sophomore year.
- 200-299 Lower division courses, normally taken in the sophomore year.
- 300-399 Upper division courses, normally taken in the junior year.
- 400-499 Upper division courses, normally taken in senior year.
- 500-599 Graduate courses, normally limited to graduate students.

## SCHOOL OF MANAGEMENT ADVISEMENT CENTER

Social & Behavioral Sciences Building, A-326, 213/516-3561

All Summer Sessions students who wish to enroll in 300- or 400-level business courses or accounting 231 must obtain approval to enroll from the Advisement Center. Visiting or non-matriculated students are asked to bring transcripts, grade reports, and/or college records to the Center when seeking approval. The hours for advisement are as follows:

April 1-May 20, Monday & Tuesday, 8:30 am - 6:30 pm; Wednesday & Thursday, 8:30 am - 4:30 pm; Friday, CLOSED.

June 1,2, General Registration (University Center), 10:00 am - 6:00 pm

June 3-16, Monday through Thursday, 10:00 am - 6:00 pm; Friday, CLOSED.

June 17 - End of first Summer Session, Monday through Thursday, 9:00 am - 5:00 pm

Visiting or non-matriculated students who wish to enroll in graduate (500-level) courses, please go to SBS, A-328, 213/516-3465.

For questions regarding advance registration in Summer Sessions business courses, please contact the Summer Sessions office.

## SEMESTER UNIT EQUIVALENCY

1987 Summer Sessions courses are offered for semester units. The University converted to the semester system in Fall 1986. To calculate quarter unit equivalency to semester credits use this base formula: 1 semester unit equals 1.5 quarter units.

## GRADE REPORTS AND TRANSCRIPTS

Student performance in each course is reported at the end of the Session by one of the following grades (with grade points earned):

GRADE	GRADE POINTS
A Excellent	4.0
AB	3.5
B Very good	3.0
BC	2.5
C Satisfactory	2.0
CD	1.5
D Barely passing	1.0
F Failure	0.0
I Incomplete (not counted in grade average)	0.0
W Withdrawal (not counted in grade average)	0.0
U Unauthorized Withdrawal (counted as units attempted in grade point average)	0.0
RD Report Delayed	0.0

The following grades are to be used for approved courses only.

CR — Credit (not counted in grade average, but units allowed). Undergraduate level only

NC — No Credit (not counted in grade average, no units allowed).

SP — Satisfactory Progress (credit is deferred until completion of course sequence).

A report of final grades assigned in classes will be mailed to you about three weeks after the end of the session.

A student may obtain an official transcript of enrollment and grades by completing a request for transcript form available at the office of Admissions and Records. This request should be filed no earlier than the last week of the session in which the student is enrolled. Allow at least three weeks after the end of the session for delivery of the transcript copy. A fee of \$4.00 is charged for the first transcript request. Transcripts are not issued to a student whose record indicates financial obligation to the University.

Grades for nonstandard-date courses will be posted with standard course grades at end of Session.

## AUDIT

Summer students may audit a course on a space available basis with the permission of the instructor. Auditors pay regular course fees. To enroll as an auditor, submit a change of program form with the instructor's signature to the Summer Sessions office.

Students must officially change their status in a course from credit to audit by the end of the first week of instruction.

## CREDIT/NO CREDIT GRADING

According to current Credit/No Credit grading procedures, the Credit (CR) grade is the equivalent of an A, B, or C letter grade, and the No Credit (NC) grade is the equivalent of a CD, D, or F. CR/NC grades are recorded on student transcripts. An undergraduate may elect to be graded CR/NC in particular courses, subject to conditions which are described in the University Catalog. To receive a Credit/No Credit grade in a Summer Session course (except when the course is graded solely on Credit/No Credit basis), the student must complete the proper card, available in the Summer Sessions office by the end of the first week of instruction.

## MAXIMUM STUDENT UNIT LOAD

The total units a summer student may earn:

Session 1 only	7 units
Session 2 only	7 units
Sessions 1 and 2	10 units

Exceptions to the above are based on proven academic ability and the feasibility of the student's schedule. Students wishing to exceed these unit limits must obtain and complete a special petition available in the Summer Sessions office and request permission from the dean of the school governing their major. Visiting students or non-matriculated students must request permission from the Dean of Extended Education.

## INDEPENDENT STUDY

Independent or directed study courses are intended for the regularly enrolled, matriculated student in order to enhance or supplement his/her curriculum. To enroll for independent or directed study, the student must obtain a contract from the Summer Sessions office. This contract must be completed, including signature of Dean, and submitted with student's registration. A student will not be registered for independent or directed study unless a completed contract has been submitted. Only course numbers listed with departments may be used; be sure the correct Session and number of units are on the contract. The same registration deadlines and policies apply to independent study.

## FINAL EXAMINATIONS

Final examinations are administered during the final week the course is scheduled to meet. Usually the examination is given on the last day the course meets. No adds or drops will be accepted during or after the last week the class meets.

## GENERAL STUDIES

The General Studies program is the nucleus of the undergraduate curriculum at CSUDH, deliberately structured to provide the intellectual and effective foundation required of a well-educated person. One major purpose of the program is to assure that students who enter the University at the lower division level acquire appropriate knowledge, experiences, and skills in the liberal arts and sciences. Another major purpose is to assure that students are not only able to make connections between their general studies work and other course work in the baccalaureate program, but more importantly, are stimulated to pursue life-long education in the liberal arts and science fields. The philosophy underlying General Studies offerings is that they are courses for nonspecialists, presenting subject matter related to the wider context of knowledge and stimulating interest in life-long learning. General Studies courses present breadth, deal with representative concepts, and provide some integration of concepts.

Several of the courses which comprise this curriculum are offered in Summer Sessions. These General Studies courses are designated by the "GS" symbol. For an overview of the General Studies program consult the University *Catalog*, pages 165-170.

## HIGH SCHOOL STUDENTS

### Summer Sessions

Qualified high school students who will enter the junior or senior year in Fall 1987 may be admitted to register for Summer Session lower division (100 level) courses with a letter of recommendation from the school principal or counselor and written authorization from the parents. The letters should be addressed to the Dean of Extended Education, California State University, Dominguez Hills. Students will pay regular summer fees, and the course credit they earn may be applicable to a degree from CSUDH or another institution.

### Academic Year

Through a special program call "A Plus" (Academics Plus), high school students may take one or two classes per term on our campus. To be admitted as an A Plus student, the student must: (1) be a junior or senior, (2) submit an official A Plus application form, (3) have a 3.0 GPA or better, (4) have completed prerequisite coursework, (5) be enrolled in a high school college preparatory program, (6) have the approval of the high school principal and counselor, and have parental authorization. For more information about A Plus application forms and fees, call the Director, School and College Relations, 213/516-3699.

## ADVISEMENT FOR SUMMER COURSES

Regularly enrolled students may obtain academic advisement for their summer schedules during Spring Semester when faculty and advisors are available. Informal advisement will be available during General Walk-In registration on June 1, 2, 19. The Summer Session Office does not provide academic advisement. Many questions are answered in the University *Catalog* which includes course descriptions and course prerequisites in addition to policies and programs of the University. The *Catalog* is sold at the University Bookstore.

## ENTRY LEVEL MATHEMATICS REQUIREMENT

Students wishing to enroll in any Summer Sessions mathematics classes except MAT 003 and 005 will have to provide evidence of having satisfied the ELM requirements. This requirement can be satisfied by any of the following methods.

1. Passing the ELM examination administered by the University Testing Office (call 516-3909 for information).
2. Satisfactory test score on the ACT/SAT test. Test scores must be sent directly to Summer Sessions office by the testing agency.
3. Transcripts showing passing grades on college level mathematics courses. Transcripts must be sent directly to the Summer Session office by the college where the course was taken. California State University, Dominguez Hills graduates can have their records verified by the Office of Admissions and Records.

Due to the time involve in requesting records and having them sent, students expecting to take mathematics courses should request verification to be sent to the Summer Sessions office at least two months before the anticipated date of enrollment. *Official verification must be received by the Summer Sessions office before the student can enroll in mathematics classes.*

### Student Services

## STUDENT HOUSING

Pueblo Dominguez Student Apartments.  
P.O. Box 6228, Carson, CA 90749-6228  
213/516-4228

Information regarding on-campus housing while attending CSUDH Summer Sessions may be obtained by writing or phoning the Office of Student Apartments.

## SUMMER SESSIONS OFFICE

Educational Resources Center C508, 213/516-3746

Processing of advance registration, late registration, adds, drops, withdrawals, and other academic transactions related to Summer Sessions enrollment will take place in the Summer Sessions office. General Registration on June 1, 2, and 19 will take place in the Small College area.

Summer Sessions office hours are 8:00 a.m. - 5:00 p.m., Monday through Friday, April 1 through June 2. During the first two weeks of each Session, June 3 through June 16 and June 22 through July 9, the office will be open from 8:00 a.m. - 6:00 p.m., Monday through Thursday; 8:00 a.m. - 5:00 p.m., Friday. After July 9, the office will be open 8:00 a.m. - 5:00 p.m., Monday through Friday. The office is closed on weekends and on July 3, a University holiday.

## PARKING

Small College Complex A122, 213/516-3639

All vehicles parked on this campus must have a valid parking decal either on the left rear bumper or hanging from the rear-view mirror. On motorcycles, the decal is affixed to the front left fork. Single entry parking permits can be obtained for 75¢ (3 quarters) from a vending machine near the entrance of each general parking lot. Restricted parking areas are enforced at all times. Parking decals for Summer Sessions can be purchased at the Cashier's Office (SCC B130).

*For more information about the University's parking regulations, please contact the Director of Public Safety.*

## DISABLED STUDENT SERVICES

Student Health Center A106,  
213/516-3660/TDD/516-4028

Disabled Student Services is committed to the student with a disability and his or her right to an equal educational experience. Students having a disability which is either permanent or temporary in nature, are eligible for a variety of support services including:

- Admissions/Registration Assistance
- Priority Registration
- Readers-Notetakers-Interpreters
- Assistive devices and equipment loans
- Information and referral

Information regarding these and other services can be obtained by calling Disabled Student Services.

---

## UNIVERSITY BOOKSTORE

Small College Complex F130, 213/516-3789

Textbooks, course materials, the University *Catalog*, supplies, giftwares, and clothing are available at the Bookstore. Summer hours are as follows:

June 1-10, Monday-Thursday, 8:30 a.m.-7:00 p.m.

June 5, Friday, 8:30 a.m.-4:00 p.m.

June 11-June 19, 8:30 a.m.-4:00 p.m.

June 22-25, Monday-Thursday, 8:30 a.m.-7:00 p.m.

June 26-August 21, 8:30 a.m.-4:00 p.m.

July 3, Friday, closed (Holiday).

The Bookstore is closed on weekends. Bookstore hours are subject to change.

*The last day to return textbooks for First Session is Wednesday, June 10, 1987. The last day to return textbooks for Second Session is Friday, June 26, 1987.*

---

## UNIVERSITY LIBRARY

Educational Resources Center, 213/516-3714

During the summer, the library will be open according to the following schedule:

### First Summer Session June 3-July 14

Monday-Thursday 7:00 a.m.-8:00 p.m.

Friday 7:00 a.m.-5:00 p.m.

July 3 CLOSED

Saturday 9:00 a.m.-1:00 p.m.

(July 13, 20, 27

and July 11 only)

Sunday CLOSED

### Second Summer Session After July 14

Monday-Friday 7:00 a.m.-5:00 p.m.

Saturday and

Sunday CLOSED

---

## INFORMATION AND SERVICE CENTER

Small College Complex A130, 213/516-3696

The Information and Service Center, located at the front of the campus, aids the campus population, prospective University applicants, and community members by providing essential, centralized information on campus resources, activities and programs. The Center also makes appropriate referrals to other campus units. Brochures, maps, directories, and other materials are available to students and visitors.

Center functions include maintaining a centralized calendar of campus activities, handling all application requests, providing information on admission policies and procedures, giving pre-admission and general academic advising, and answering questions on general academic policies. Summer hours are: Monday through Thursday, 8 a.m.-9 p.m., Friday 8 a.m.-5 p.m.

---

## EVENING SERVICES

Small College Complex A130, 213/516-3696

Evening Services are provided for the University summer student population in the Information Center.

On Monday through Thursday evenings, 5 to 9 p.m., staff is available to assist students with admission information, University academic policies, notary services, after-hours Admissions and Records office support, withdrawal and refund procedures, and delivery and go-between services.

Generally, we attempt to assist evening students so that they may function with the same effectiveness and convenience as during the day.

---

## OFFICE OF ACTIVITIES/ THE UNION

Cafeteria/Union Area, 213/516-3559

The Office of Activities (and temporary union), which is part of Student Programs, is located in the north and west wings of the Commons. The staff is dedicated to providing a rich, multifaceted schedule of events throughout the academic year.

The Office of Activities provides an activity lounge, meeting room, television viewing area, game area, mini do-it-yourself postal service, and a check-out service for games and other equipment to serve the needs of students, faculty and staff. Information about campus-wide student activities is available at the service desk.

The staff works closely with the Associated Students and can answer questions about student government. The Office of Activities also works with recognized student groups.

---

## TESTING OFFICE

Small College Complex C144A, 213/516-3909

The Testing Office provides the following services:

National Test Programs —

Information and registration materials for the GRE, SAT, ACT, DAT, LSAT, GMAT, MCAT, CLEP (credit by exam programs) and CBEST.

Individual Diagnostic Testing —

Interest inventories and other diagnostic instruments are administered to students who have been referred by counselors in the Student Development or Health and Psychological Services.

---

## CAFETERIA AND FOOD SERVICE

Cafeteria Student Area G120, 213/516-3814

The Cafeteria will be open throughout the summer, Monday through Friday, 8 a.m. until 2 p.m.

In addition, vending machines are located on the ground floor of the Educational Resources Center (library) and of the Social and Behavioral Science building. For the convenience of evening students, a catering truck will be parked on campus near the Social and Behavioral Science building.

---

## VETERANS' SERVICES

Small College Complex A130, 213/516-3643

The office of Veteran Affairs provides a wide variety of services and programs for veterans and veterans' dependents in reaching their educational and career goals. Veterans are assisted in dealing with the Veterans Administration, the State of California, the Department of Veterans Affairs, and with problems that are a barrier to their success on campus.

Veterans are encouraged to utilize the following services, available for both day and evening students:

- Pre-admission advisement
- Community referral services
- Veterans' benefits counseling
- Tutorial Assistance
- Special admissions to the University
- Vocational Rehabilitation Program
- Academic Advisement

---

## HEALTH PROGRAMS AND PSYCHOLOGICAL COUNSELING

Student Health Center A141, 213/516-3818

The Health Programs and Psychological Counseling unit offers personal counseling and group counseling during the Summer Sessions. Students must have attended Spring Semester 1987 in order to be eligible for counseling.

---

## ADMINISTRATIVE OFFICERS

W. Ann Reynolds, Ph.D., Chancellor of the California State University.

John A. Brownell, Ph.D., Acting President  
Administrative officers, Summer Sessions.

Joseph W. Braun, Ph.D., Dean, Extended Education.

Joanne Zitelli, Ph.D., Administrator, Summer Session.



# Summer Sessions Courses of Instruction

## ANTHROPOLOGY

Social and Behavioral Sciences G322, 213/516-3443

**ANT 315 Magic and Religion (3).** A comparative analysis of magico-religious systems in their cultural setting and the role of the supernatural in human societies.

**ANT 370 Peoples of the Old World (3).** A survey of one or more cultural regions of the Old World. Specific topics and areas may vary; for example: Europe, Sub-Saharan Africa, Middle East, India, Asia, Southeast Asia, Pacific.

**ANT 494 Independent Study (3).**

**Prerequisite:** Consent of instructor.

Independent study of a particular problem under the direction of a member of the anthropology department. Summer students must obtain contract form from *Summer Sessions Office*; completed form, with signatures of instructor and dean, must be submitted with request for enrollment.

## ART

Humanities and Fine Arts A111, 213/516-3310

**ART 301 Arts and Crafts for the Non-Major (3).** Development, experience, and application of arts and crafts projects of special value to Liberal Studies and Recreation majors.

**ART 383 Silkscreen (3).** An introduction to basic stencil printmaking processes.

**ART 388 The Human Figure in Painting (3).** **Prerequisite:** ART 180 is required; ART 373 is recommended. Study of the structural and symbolic implications of human form in terms of painting techniques and styles. Problems emphasizing the development of personal expression.

**ART 495-21 Special Topics: Inside Los Angeles Art — Tours to Museums, Galleries, Artists' Studios (3).** This seminar brings students into direct contact with art of the twentieth century, focusing especially upon contemporary art of Los Angeles. In-depth discussions with many professional artists of national importance offer to students a rare opportunity to examine the art of their time with the aid of its creators. The course is designed to give non-art students a rich understanding of new art, and to develop in art students a real-world relationship with the profession to which they aspire. Students will be responsible for their own transportation arrangements.

**ART 495-22 Special Topics: The History of Landscape Art (3).** Examining the history of landscape subject matter in art from prehistoric cave painting to contemporary abstract art and sculptural environments brings students into contact with a wealth of insights regarding man's relationship to nature, God, and being through many centuries. Slide lectures, readings in literature and involvement with music bring together much moving and magnificent art in one focused analysis. Field trips will include a tour of the Noguchi Sculpture Garden. Of particular interest is the emphasis upon American artists who have used the environment for their works, such as Walter de Maria (*The Lightning Field*) The Christo (*Running Fence*, etc.)

## BEHAVIORAL SCIENCES

Social and Behavioral Sciences B334, 213/516-3435

**BEH 597 Directed Reading in the Behavioral Sciences (3).** **Prerequisite:** Graduate standing; consent of instructor. In consultation with a faculty member, assignment of readings in Behavioral Sciences that may be used as background information for preparation examination; or, for orientation in little known areas; or, for reading in areas of special interest that may serve as introduction to research proposal. Choice of area requires prior consent of advisor. Summer students must obtain contract form from *Summer Sessions Office*; completed form, with signatures of instructor and dean, must be submitted with request for enrollment.

## BIOLOGY

Natural Sciences and Mathematics A124, 213/516-3381

**GS**

**BIO 102 General Biology (3).**

Representative topics in modern biology, emphasizing the present state of knowledge and the major means whereby this knowledge is being expanded. Concurrent enrollment in BIO 102 Lab required.

**BIO 220 Introductory Microbiology (3).**

**Prerequisite:** BIO 102 and CHE 102 or equivalents. The nature and activities of microorganisms, their effects on the environment and human affairs. Microbiology laboratory techniques. Concurrent enrollment in BIO 220 Lab required. Not open for credit toward the Biology major or to students with credit in Biology 324.

**BIO 250 Elements of Human Anatomy and Physiology (3).** **Prerequisite:** BIO 102 or equivalent. Basic principles of anatomical structure and physiological processes of human organ systems. Not open for credit toward the Biology major.

**BIO 251 Elements of Human Anatomy and Physiology Laboratory (1).** **Prerequisites:** BIO 250 or concurrent enrollment. Laboratory work and demonstrations in the anatomical structure and processes occurring in man. Not open for credit toward the Biology major.

**GS**

Courses fulfilling CSUDH General Studies requirements.

**BUSINESS  
ADMINISTRATION/  
SCHOOL OF  
MANAGEMENT**

Social and Behavioral Sciences A326, 213/516-3561

300-, 400- and 500-level business courses and Accounting 231 require special approval; see page 4.

**BUS 445 International Business (3).**  
**Prerequisites:** FIN 360, MGT 310 and MKT 350. An introduction to international business with an emphasis on the additional risks, uncertainties and difficulties of business conducted across national boundaries; examines the financial, management, legal, accounting, and marketing areas.

**BUS 490 Management Policy Seminar (3).**  
**Prerequisites:** Senior status and completion of all Business core courses; BUS 445, FIN 480, and QMS 423 may be taken concurrently (priority will be given to graduating seniors). An integrating capstone course dealing with problems of business management; uses actual business cases for analysis and decision-making.

**Accounting and Business Law**  
Social and Behavioral Sciences D325, 213/516-3556

**ACC 230 Financial Accounting (3).**  
**Prerequisites:** MAT 101 or MAT 171. Topics covered will include concepts, recording transactions, adjustments, worksheets, cash receivables, inventories, plant and equipment, liabilities, partnerships, corporations, balance sheet, income statement, statement of changes in financial position.

**ACC 231 Managerial Accounting (3).**  
**Prerequisite:** ACC 230. Topics covered will include objectives, concepts, job order and process costing, cost patterns, cost-volume-profit, contribution margin, profit planning, standard costs, flexible budgets, decentralized operation, product processing, relevant cost.

**ACC 330 Intermediate Accounting I (3).**  
**Prerequisite:** ACC 231. Professional level accounting, conceptual framework, income statement, balance sheet, cash, short-term investments, receivables, inventories, fixed and

intangible assets, depreciation, long-term investments, funds, other assets, present value.

**ACC 333 Income Taxation I (3).**  
**Prerequisite:** ACC 231. Federal income tax law as related to individuals and sole proprietorships.

**ACC 337 Cost Accounting (3).**  
**Prerequisite:** ACC 231. The nature, objectives, and procedures of cost accounting and control; job costing and process costing; joint product costing; standard costs; theories of cost allocation and absorption; uses of cost accounting data for management decision-making.

**LAW 240 Legal Aspects of Business Transactions (3).** Analysis of the legal process; functions and operations with a federal system; contracts, sales, agency.

**Computer Information Systems**  
Social and Behavioral Sciences D321, 213/516-3579

**CIS 270 Introduction to Computers and Data Processing (3).** **Prerequisite:** MAT 101 or equivalent. Introduction to computer systems with emphasis on the impact of computers and their use; elements of programming.

**Finance and Quantitative Methods**  
Social and Behavioral Sciences D321, 213/516-3557

**FIN 360 Business Finance (3).**  
**Prerequisites:** ACC 230, ECO 210 and MAT 171. A survey of the decision framework for financial management; forecasting and planning, major investment and financing decisions, control and interaction with capital markets.

**FIN 480 Economics of the Firm (3).**  
**Prerequisite:** ECO 210, ECO 211 and QMS 321. Applications of economic theory to management decisions; emphasis on analysis and quantitative techniques appropriate for solving forecasting, production, cost and pricing problems under various market conditions; computer applications when appropriate.

**FIN 563 Financial Decision Analysis (3).**  
**Prerequisite:** FIN 561 or equivalent. Application of financial theories and practice to decision-making through the use of cases, problems, and readings.

**QMS 321 Introduction to Business Statistics (3).** **Prerequisite:** MAT 171. Theory of statistics and its applications in business decision-making. Topics include probability theory, probability applications, random sampling, estimation hypothesis testing, regression and correlation.

**QMS 322 Production Management (3).**  
**Prerequisite:** QMS 321. Analysis of the management function in the production area with emphasis on computer applications and practical problem-solving. Includes international developments.

**QMS 423 Introduction of Operations Research (3).** **Prerequisite:** QMS 321. Use of deterministic, probabilistic, and computer-based methods in support of management decision-making, with emphasis on computer applications and practical problems.

**Management**  
Social and Behavioral Sciences D321, 213/516-3551

**MGT 310 Management Theory (Principles of Management) (3).** Focuses on the management processes of planning, organizing, leading, and controlling; includes discussions of social and ethical issues in business; case studies and written reports.

**MGT 312 Organizational Behavior (3).**  
**Prerequisite:** MGT 310. Causes and consequences of individual and group behavior in business, organizational communications, interpersonal relations, and conflict resolution; cases and role-playing.

**MGT 513 Human Behavior in Organizations (3).** **Prerequisite:** Graduate standing. A systematic study of the dynamics of behavior in organizational settings at the individual, group and inter-group levels. Topics include motivation, problem solving, communication, decision-making, job design, organizational changes and conflict resolution; cases, advanced readings and research.

**Marketing**  
Social and Behavioral Sciences D321, 213/516-3552

**MKT 350 Principles of Marketing (3).**  
**Prerequisites:** ECO 210 and MAT 171. Survey of the marketing function, including the marketing environment and target markets; marketing strategy with emphasis on the marketing mix; social and ethical responsibilities of marketing.

**MKT 552 Marketing Management Seminar (3).** **Prerequisite:** MKT 551 or equivalent. Strategies and techniques of marketing management; emphasis on decision-making as applied to product, design, distribution, pricing and promotion; analysis of current marketing issues; and international dimensions; case histories, problems, case analysis, and research projects required.

**CHEMISTRY**

Natural Sciences and Mathematics B202, 213/516-3376

**GS** **CHE 102 Chemistry for the Citizen (3).** A non-mathematical treatment of the basic principles of chemistry and their application to various facets of life in a highly technological society.

**Pre-Medical/Dental Organic Chemistry****June 15 through August 21**

Students must enroll for the entire program through advance registration, either by mail or in person at the Summer Session Office, ERC C508, by May 20.

Designed for pre-medical and pre-dental students, this ten-week program corresponds to a full year of organic chemistry with lab. The two sequential courses offer 8 semesters units — the required minimum in organic chemistry for professional schools. The course is helpful in preparing for DAT and MACT.

**CHE 200 Organic Chemistry I (3).** A detailed study of organic molecular structure, reaction mechanisms, stereo-chemistry, and synthesis with emphasis on aliphatic and aromatic systems. **Prerequisite:** One year of General Chemistry.

**CHE 201 Organic Chemistry Laboratory I (1).** Basic experimental techniques of organic chemistry. **Prerequisite:** Enrollment in CHE 200.

**CHE 202 — Organic Chemistry II (3).** Continuation of Chemistry 200 with emphasis on the chemistry of organic compounds containing oxygen, nitrogen and sulfur. **Prerequisite:** Chemistry 200.

**CHE 203 — Organic Chemistry Laboratory II (1).** Preparation of organic compounds and qualitative organic analysis. **Prerequisite:** CHE 201 and enrollment in CHE 202.

**COMMUNICATIONS**

Humanities and Fine Arts A334, 213/516-3313

**GS** **COM 130 Film Classics (3).** Viewing and analysis of selected American and foreign films of the sound era which represent milestones in the development of the cinema. Guest filmmakers and performers from the industry will discuss various screenings with the class.

**COM 487 TV Production Workshop (3).** **Prerequisite:** COM 384 and COM 385, and consent of instructor or department. Production of a broadcast quality documentary video tape for public airing on the University's cable TV channel. Each student must write, produce, direct, and edit a professional quality program within broadcast standards. Students will be asked to purchase videotape and to make their own travel arrangements.

**COM 495 Special Topic: Effects of Mass Media (3).** Analysis, with examples from motion picture, television, and radio, of the major psychological and sociological effects of contemporary mass media on modern society. Examination of controversial issues such as violence, pornography, sexism, and subliminal advertising in the media.

**COMPUTER SCIENCE**

Natural Sciences and Mathematics A132, 213/516-3398

**CSC 111 Introduction to Computers and Basic Programming (3).** Introduction to computer programming with particular emphasis on small systems through programming in the BASIC language.

**CSC 121 Introduction to Computer Science and Programming I (3).** **Prerequisite:** MAT 151 or equivalent. Survey of computer science. Organization of sequential, digital machines: CPU, I/O, storage, communications devices. Function of operating system: translators, editors, peripheral control, utilities. The development, description and analysis of elementary algorithms in Pascal.

**CSC 123 Introduction to Computer Science and Programming II (3).** **Prerequisite:** CSC 121. Continuation of CSC 121. Fundamental programming concepts using arrays, records, pointers, linked lists, trees and recursion. Good style, documentation and structure will be emphasized. Introduction to the analysis of algorithms for efficiency and correctness. The language of instruction is Pascal.

**CSC 221 Assembly Language and Introduction to Computer Organization (3).** **Prerequisite:** CSC 123. Programming problems in assembly language. Writing and using macros. Features of modern computer hardware and operating systems.

**CSC 241 High Level Languages: ADA (3).** **Prerequisite:** CSC 111 or CSC 121 or equivalent. Syntax and programming in a specific high level language. May be repeated for credit with different languages. Specific language offered: ADA.

**CSC 311 Data Structures (3).** **Prerequisites:** CSC 123 and MAT 261. More advanced and detailed treatment of concepts of data organization introduced in CSC 123. Includes lists, trees, graphs and storage allocation and collection. Applications to such areas as symbol tables, string search and optimization.

**CSC 321 Programming Languages (3).** **Prerequisites:** CSC 221, CSC 229 and MAT 261. A comparative study of programming languages. Characteristics of languages and formal description of languages. Assignments in several languages.

**CSC 331 Computer Organization (3).** **Prerequisites:** CSC 221, PHY 130 and MAT 261 or concurrent enrollment. Structure of the modern digital computer. Introduction to Boolean algebra and design of digital circuits. Arithmetic, control, storage and input/output systems.

**CSC 341 Operating Systems (3).** **Prerequisite:** CSC 331 and MAT 261. Overall structure of batch and time-shared operating systems. Scheduling of jobs, CPU and I/O devices. Paged and segmented memory management. I/O programming and file handling. Synchronization of concurrent processes.

**CSC 351 File Processing (Data Access Methods) (3).** **Prerequisite:** CSC 311. Methods of constructing and accessing files of information. Emphasis on the relationships between file organization, processing options and supporting devices and the analytical techniques necessary to make an intelligent choice among these alternatives.

**DANCE**

Field House C003, 213/516-3761

**DAN 100 Dance Exercise (1).** Dynamic rhythmic dance movements designed to increase cardiovascular endurance, muscular endurance, muscular strength and flexibility.

**GS** Courses fulfilling CSUDH General Studies requirements.

## EARTH SCIENCES

Natural Sciences and Mathematics B202, 213/516-3376

**GS** **EAR 100 Introduction to Earth Sciences (3).** Volcanoes, earthquakes, oceanic processes and continental drift. Meets certain general studies requirements (is fundamental to Earth Sciences majors/minors), and has wide-ranging applications in art, commerce, public policy, and science. Field trip.

## ECONOMICS

Social and Behavioral Sciences A306, 213/516-3446

**ECO 210 Economic Theory 1A Microeconomics (3).** Introductory microeconomic theory; resource allocation, output determination; production theory, income distribution.

**ECO 211 Economic Theory 1B Microeconomics (3).** Introductory macroeconomic theory; national income accounting, national income determination, monetary and fiscal policy.

## EDUCATION/CENTER FOR QUALITY EDUCATION

Humanities and Fine Arts C316, 213/516-3516

### Graduate Education

**GED 500 Research Methods in Education (3).** **Prerequisite:** Graduate standing. Examination of assumptions and techniques of educational research. Review of pertinent research studies emphasizing their applicability to educational problems. Statistical concepts, research methodology and computer applications are included.

**GED 501 Seminar in Learning and Development (3).** **Prerequisite:** Graduate standing. Theory, research and practice related to learning and development. Emphasis on biological and psychological factors in individual differences. Includes study of affective and cognitive development.

**GED 525 Bilingual-Multicultural Teaching Methods (3).** **Prerequisite:** Graduate standing. The study of selected bilingual approaches to, and methods of, teaching social studies, science, mathematics, and language arts.

**GS** Courses fulfilling CSUDH General Studies requirements.

**GED 527 Resource Specialist I: Program Planning (3).** **Prerequisite:** Graduate standing; consent of instructor and Clear California Special Education Specialist Credential. Surveys current special education laws and practices regulating appropriate identification, assessment, program planning, placement, parent appeal, and coordination of services for the education of the mildly handicapped in public and private schools. Required for California Resource Specialist Certificate.

**GED 528 Resource Specialist II: Indirect Services (3).** **Prerequisite:** Graduate standing; consent of instructor and Clear California Special Education Specialist Credential. Surveys, demonstrates, and applies indirect service principles to the identification, assessment, modification of curriculum and instruction, selection of community resources, vocational planning, and behavior management of the mildly handicapped in their regular classrooms, homes and communities.

**GED 535 Introduction to Computers in Education (3).** Presents the uses of computers in educational settings, including: computer assisted instruction, criteria for software and hardware selection, computer-assisted testing, and an introduction to programming. Laboratory in educational computing provides experience in the following areas: Word processing, LOGO and BASIC programming, computerized gradebooks, computer-assisted testing and computer graphics.

**GED 559 Generic Practicum with Exceptional Children (4).** **Prerequisite:** Consent of instructor. Supervised practice in assessment and instruction of exceptional

children with various disabilities and developmental levels. Includes evaluation and reporting of pupil progress. Allows the candidate to experience the commonalities and differences among special education programs serving the learning, severely, physically, communication and visually handicapped. CR/NC grading.

**GED 566 Practicum: Directed Teaching with the Severely Handicapped (5).** **Prerequisite:** Consent of instructor. Supervised experience practice teaching in an approved public or private school special education program for severely handicapped students. Focuses on the management of curriculum, behavior, instruction and professional relations appropriate to teaching the severely handicapped in school and community settings.

**GED 569 Practicum: Directed Teaching with the Learning Handicapped (5).** **Prerequisite:** Graduate standing; consent of instructor. Supervised practice teaching in an approved public or private special education program for learning handicapped students. Focuses on the management of curriculum, behavior, instruction and professional relations appropriate to teaching the learning handicapped in elementary, secondary and post-secondary settings.

**GED 581 Principles of Educational and Psychological Assessment (3).** **Prerequisite:** Graduate standing; consent of instructor. Examines individual and group standardized tests. Course includes an examination of test theory, test bias, techniques and theories for understanding affective, cognitive, and behavioral characteristics of students.

## California Has a Teacher Shortage

Our Schools Will Need  
120,000 New Credentialed People by 1995  
and 180,000 by 1990

### Teachers are Needed In:

Elementary Education	Special Education
Secondary Education	Educational Administration
(particularly Mathematics and Science)	Reading
Bilingual Education	School Psychology

See the Education classes in this schedule for courses offered this semester. For information on earning a Teacher Credential, call the appropriate representative listed below.

Services Credentials: Dr. Nancy Detjen/Dr. Donald Woodington, Administrative, 516-3912 Dr. Charmayne Bohman, Pupil Personnel, 516-3512 Dr. Charmayne Bohman/Dr. Dale Scherba, School Psychology, 516-3915	Specialist Credentials: Dr. Max Conteras, Bilingual/Crosscultural, 516-3904  Special Education — Dr. Karl Skinrud, Learning Handicapped, 516-3923 Dr. Doris Okada, Severely Handicapped, 516-3812
--	---

Certificates:  
Computer-Based Education, Dr. Peter Desberg, 516-3908

**GED 582 Group Dynamics for Personal Growth (3).** **Prerequisite:** Consent of instructor. Provides a personal growth experience for students. The experiential aspects of the course will provide the basis for an analysis of group dynamics. Application of techniques for understanding self and others and developing good interpersonal skills. CR/NC grading.

**GED 594 Independent Study (3).** **Prerequisite:** Graduate standing. Independent study undertaken under the supervision of a faculty member. Summer students must obtain contract form from *Summer Sessions Office*; completed form, with signatures of instructor and dean, must be submitted with request for enrollment.

**GED 594-12 Independent Study: Black Heritage For Educators (3).** This course is designed as an Independent Study course. It is also designed to fulfill the Los Angeles Unified School District (and other districts in this area) salary step requirement for a 3-unit course on a *specific ethnic group*. (Students may select another ethnic group for study with instructor approval: e.g., Mexican-American Heritage, Vietnam-American Heritage, etc.) Students will research such topics as Black traditions, political/socio-economic conditions of Black Americans versus the population as a whole, past and current coping mechanisms, current legislation, future planning, leaders and personalities. The class will meet as a group during the first week to plan research projects. Thereafter, students will make individual appointments with instructor at mutually convenient times to discuss progress on the projects.

**GED 597 Fieldwork in Counseling (3).** **Prerequisite:** Field experience directly related to functions and responsibilities of certified school counselors. Experience in two different settings, including a cross-cultural experience, is required. CR/NC grading.

**GED 598 Fieldwork for School Psychologists (3).** **Prerequisite:** Graduate standing; consent of instructor. Supervised training in elementary and secondary school settings. Students must complete a minimum of 90 days of fieldwork and meet competency requirements in psycho-educational assessment, planning and evaluation, counseling, consultation, and behavior management. Course is repeatable for credit until all competencies are completed. CR/NC grading.

**GED 599 Thesis (2-6).** **Prerequisite:** Consent of instructor. The student will execute an individually planned research effort or a creative project. Students work under individual supervision with assigned faculty. May be repeated up to six units. Summer students must obtain contract form from *Summer Sessions Office*; completed form, with signatures of instructor and dean, must be submitted with request for enrollment.

## Teacher Education

**TED 402 Motivation and Learning (3).** **Prerequisite:** TED 304 and TED 305 are recommended. The psychology of learning and motivation as it relates to instruction; emphasis on the application of learning principles to classroom learning situations. Survey of applicable research from educational psychology and psychology. This is a prerequisite for student teaching.

**TED 403 The Teaching of Reading - Elementary or Secondary (3).** **Prerequisite:** TED 304, TED 305, TED 402 are recommended. Procedures and materials for teaching reading in elementary and secondary schools, including the use of recent media and methods. Interpretation of significant research as it pertains to decoding, comprehension, reading for bilingual students and linguistically different populations. The use of tests to diagnose and teach in the classroom. This is a prerequisite for student teaching.

**TED 404 Fieldwork in the Teaching of Reading - Elementary/Secondary (1).** **Prerequisite:** TED 403 is required; TED 304, TED 305 and TED 402 are recommended. Lesson plans and teaching critiqued in microteaching and audiotaped lessons. Elementary students teach basal, language experience, decoding and structural analysis lessons, as well as reading in the content areas. Secondary students teach vocabulary, study skills and comprehension in their discipline.

**TED 405 Mainstreaming Children With Special Needs (3).** **Prerequisite:** TED 304, TED 305, TED 402, TED 403 are recommended. A course to facilitate the integration of handicapped children into the regular classroom. Covers legal responsibilities, diagnostic/prescriptive teaching, problem solving and visits to special education facilities. This is a recommended prerequisite for student teaching.

**TED 413 Elementary Methods In Art, Music and Physical Education (3).** **Prerequisite:** TED 304, TED 305, TED 402 and TED 403. Methods and materials for elementary art, music and physical education that include instructional planning, lesson presentation, techniques, preparation and utilization of appropriate materials, media and strategies. CR/NC grading.

**TED 415 Multicultural Perspectives For Teachers (3).** Analysis and application of the concept of cultural pluralism to the task of teaching multicultural populations. Prepares teachers and prospective teachers to recognize the values of cultural differences and to utilize appropriate methods and materials. (Note: L.A. Unified School District — and other districts — require 2 courses in multicultural populations to qualify for the next step on their salary ladders. This course fulfills the requirement for one course in general multicultural populations. GED 594-12 fulfills the second course requirements for a course specific to one ethnic group.)

**TED 430 Student Teaching: Elementary (4).** **Prerequisite:** Consent of instructor. Student teaching with a master teacher in a multicultural/multiethnic elementary classroom. CR/NC grading.

**TED 436 Seminar: Elementary Student Teachers (1).** **Prerequisite:** Consent of instructor. Problem solving and use of competency checklists in student teaching at the elementary level. CR/NC grading.

**TED 440 Student Teaching: Secondary (4).** **Prerequisite:** Consent of instructor. Student teaching with master teachers at the junior and senior high school level in Multicultural/Multiethnic classrooms. CR/NC grading.

**TED 456 Seminar: Secondary Student Teachers (1).** **Prerequisite:** Consent of instructor. Problem solving and use of competency checklists in student teaching at the secondary level. CR/NC grading.

**TED 467 Teaching Methods I - Secondary Interns: Classroom Management, Discipline and Curriculum Design (3).** Covers classroom discipline, management and organization. Focuses on the learning task, teacher behavior, classroom environment, curriculum design and instruction. Includes lesson and unit planning and instructional strategies. CR/NC grading.

## RELATED COURSES:

- EDU 851 - Workshop in Multicultural Humanities, pg. 27
- EDU 857 - Children's Art and Language Expression, pg. 27
- EDU 873 - Newspapers in the Classroom, pg. 27
- PHY 402 - Workshop in Physical Sciences for Teachers, pg. 15

**ENGLISH**

Humanities and Fine Arts E315, 213/516-3322

**ENG 088 Developmental Reading (3).**  
**Prerequisite:** E.O.P./Bridge students only. (no baccalaureate credit) Intensive work in basic reading and writing skills with special emphasis on reading and writing that students will do in college. Students whose reading scores in the CSU English Placement Test are T-142 or below are required to complete this course prior to enrolling in English 110. May be taken concurrently with ENG 099. Graded CR/NC.

**ENG 099 Basic Writing Workshop (3).**  
**Prerequisite:** E.O.P./Bridge students only. (no baccalaureate credit) Composition for students whose English Placement Test T-scores are T-150 or lower; focus on clear correct sentences, introduction to paragraphing in the context of the essay. Essays concentrate on narrative and personal experience leading to exposition. May be taken concurrently with ENG 088. Graded CR/NC.

**GS ENG 110 Freshman Composition I (3).** **Prerequisite:** English Placement Test T-score above 150 or test score exemption or successful completion of English 099, and/or successful completion of English 088 are required. Students from campuses other than CSUDH will be exempt from this prerequisite, but they will be asked to offer evidence of enrollment on another campus. Basic writing skills emphasizing analytic exposition. Helps students express ideas and convey information in writing. Graded A-C/NC.

**GS ENG 111 Freshman Composition II (3).** **Prerequisite:** ENG 110 or equivalent. Reinforcement of basic writing skills with emphasis on persuasion and argumentation. Includes a documented essay. Helps students to write convincing arguments and to assemble, organize, and document evidence supporting a thesis. Graded A-C/NC.

**ENG 314 English Syntax: The Grammar Course (3).** This course, designed for current and prospective teachers, will undertake a comprehensive survey of English grammar. Using a number of criteria, the class will develop a framework for understanding and classifying the "traditional" — and often varied — terminology used to describe the major syntactic structures of English. When appropriate, the class will also use the insights provided by current linguistic research about how speakers' knowledge of their language should be described. However, the main goal of the course will be control and ordering of the systematic chaos of traditional grammar. This course will satisfy the English Syntax requirement of the Single-subject Waiver Programs in English and in TESL.

**ENG 325 Poetry (3).** **Prerequisite:** ENG 111. Analysis of poetry of varied forms; emphasis on major American and British writers from different periods.

**ENG 344 Afro-American Prose (3).**  
**Prerequisite:** ENG 111. Selected Afro-American works of fiction and non-fiction. Analysis of themes, techniques and symbols. Special attention given to folkloric elements; i.e., blues, dozens, folktales, etc. as they are employed in the literature.

**ENG 350 Advanced Composition (3)**  
**Prerequisites:** ENG 111 or equivalent. Rhetorical modes, techniques of emphasis, strategies of editing and revising. May not be counted toward major/minor, may count only twice toward elective credit. Satisfies graduation competency-in-writing requirement. Graded A-C/NC.

**ENG 352 Writing and Speaking Skills for Management (3).** **Prerequisite:** ENG 111, satisfying the junior-level competency in writing requirement; JEPET (score of 7 or better) or certification writing course such as ENG 250. Students from campuses other than CSUDH will be exempt from this prerequisite, but they will be asked to offer evidence of enrollment on another campus. Principles and skills of effective communication within organizational management. This course concentrates on eliciting desired responses through various types of business communication in writing. May be counted only once toward major/minor and twice for elective credit. Graded A-C/NC.

**ENG 494 Independent Study (1,2,3)**  
**Prerequisite:** Consent of instructor and department chair. In consultation with a faculty member, extensive reading in some area or a project involving original research or creative writing. Summer students must obtain contract form from *Summer Sessions Office*; completed form, with signatures of instructor and dean, must be submitted with request for enrollment.

**ENG 590 Seminar in Literature (3).** The literature of modernism is by definition an international movement. Much of the best modern writing, however, has been regional or national in origin, and most of the greatest "English" literature has been written by Americans and Irishmen. This seminar will investigate the paradox of regional roots versus cosmopolitan ambitions in three pairs of American and Irish writers: William Faulkner and James Joyce, William Carlos Williams and W. B. Yeats, Flannery O'Connor and Samuel Beckett.

**ENG 594 Independent Study (1,2,3).**  
**Prerequisite:** Consent of instructor or department chair. In consultation with a faculty member, the student will investigate in detail current scholarship in some area, or will undertake a project involving original research or creative writing. Summer student must obtain contract from *Summer Sessions Office*; completed form, with signatures of instructor and dean, must be submitted with request for enrollment.

**GEOGRAPHY**

Social and Behavioral Sciences A306, 213/516-3448

**GEO 359 Geography of California (3).** The physical, cultural and regional geography of California. The land and its modifications. Spatial distribution of resources. Population, migration and urbanization. Problems and prospects.

**GEO 395 Special Topics: Environmental Issues and the Future (3).** An examination of the environmental issues facing our world today. Subjects to be discussed include pollution, toxic waste, population growth; natural resources, including forests, water, and related topics.

**GEO 494 Independent Study (1-3).**  
**Prerequisite:** Consent of instructor. Independent Study of particular geographic or environmental problem under the supervision of a member of the Geography staff. Summer students must obtain contract form from *Summer Sessions Office*; completed form, with signatures of instructor and dean, must be submitted with request for enrollment.

**GEO 498 Directed Research (1-3).**  
**Prerequisite:** Consent of instructor. Directed Research of a particular geographic or environmental problem under the direction of a member of the Geography staff. Summer students must obtain contract form from *Summer Sessions Office*; completed form, with signatures of instructor and dean, must be submitted with request for enrollment.

**HEALTH SCIENCES**

Student Health Center A141, 213/516-3818

**HEA 250 Normal and Pathological Gait (2).** **Prerequisite:** Consent of instructor or department. Learn to recognize gait and postural deviations, determine cause and suggest mechanical remedies. Students will evaluate patients and videotapes, review EMG and force plate recordings, compare results of surgery, therapy, and mechanical aids.

**HEA 252 Strength, Materials and Fastening Technology (2).** Prerequisite: Consent of instructor or department chair. Principles of stress, strain, Young's Modulus. Plastic/metal choices. Preferred metal alloys, heat treatment, plastic polymer. Polymer chemistry and mechanical properties of plastics. Material designators, relationship of alloys to material properties. Selection of most appropriate orthotic/prosthetic materials.

**HEA 300 Health In Public Education (3).** Topics for teaching health courses in the public schools: substance use and abuse, nutrition, mental-emotional disorders, accident prevention, emergency health service and disease, and personal, family, community, environmental and consumer health.

**HEA 315 Dynamics of Health Communication (3).** Prerequisite: HEA 314. Fundamentals, principles, and skills of interpersonal and group processes in health related occupations. Special emphasis on theory and techniques of interviewing, small group dynamics, crisis intervention and interpersonal management skills in ethnically and culturally diverse urban settings.

**HEA 316 Medical Science (3).** Prerequisites: BIO 250 and BIO 251. Causes of disease and the underlying mechanisms of pathologic processes. Specific discussions of immune disorders, infections, cancer, and diseases of blood and lymph, cardiovascular, respiratory, gastrointestinal, hepatobiliary, genitourinary, endocrine, and neurologic systems.

**HEA 342 Lower Limb Orthotics II (3).** Prerequisite: Consent of instructor or department. Continuation of HEA 340. Patient evaluation, prescription recommendations, orthoses measurements, fabrication and fitting. Lower limb biomechanics, gait analysis, and motor disability. Fabrication and fitting of several knee-ankle-foot orthoses.

**HEA 352 Below-Knee Prosthetics II (3).** Prerequisite: Consent of instructor or department. Fabrication, fitting, and dynamic alignment of patellar-tendon bearing prostheses. All fittings include test sockets, bench, static and dynamic alignments. Four sockets completed using PTB and PTS designs. Medical management, prescription considerations. One completed below knee prosthesis.

## HISTORY

Social and Behavioral Sciences A306, 213/516-3448

**HIS 101 History of the United States (3).** A study of the ideals, creeds, institutions, and behavior of the peoples of the United States. Meets the State requirement in U.S. History.

**GS HIS 111 The Western World: The Modern Experience (3).** Significant institutions and ideas of European civilization in the modern era, sixteenth century to the present.

**HIS 370 Studies in Religious History: A History of the Early Church to A.D. 500 (3).** A comprehensive survey of the rise/origins of early Christian society and the growth of the church as an institution.

**HIS 395 Special Topics: South Africa — Peoples and Policies (3).** The historical, social and economic forces which have generated the program of racial segregation commonly called *apartheid*.

**HIS 494 Independent Study (3).** Independent study of a particular problem under the direction of a faculty member of the History Department. Summer students must obtain contract form from *Summer Sessions Office*; completed form, with signatures of instructor and dean, must be submitted with request for enrollment.

## HUMANITIES

Humanities and Fine Arts E303, 213/516-3317

**GS HUM 100 Introduction to the Humanities (3).** Examines the inter-relationships among the humanities (art, literature, music and philosophy) in Western culture by teaching the theme of tradition and change in selected periods.

**GS HUM 310 Key Concepts: Political Propaganda in Film and Literature (3).** Film and literature are used as propaganda weapons to persuade, frighten, justify, entertain, and instruct audiences in every part of the globe. Course uses a variety of politically oriented films and essays to broaden students' artistic, aesthetic, and political-history perspectives.

## LIBRARY

Education Resources Center D407, 213/516-3700

**GS LIB 150 Library Skills and Strategies (2).** Designed to acquaint students with the use of academic libraries. Practical exercises will develop skills for effectively utilizing library resources to fulfill research needs. Recommended for all students. Concurrent enrollment in LIB 150 Lab required.

## LINGUISTICS

Humanities and Fine Arts A338, 213/516-3636

**GS LIN 100 Introduction to Language (3).** An overview of current knowledge about human language: its structure and function, its cultural and social environment, its universality, and its relationship to other aspects of human knowledge and behavior. Designed as a General Studies course in the Humanities especially for students not majoring in a foreign language.

## MARRIAGE AND FAMILY COUNSELING

Social and Behavioral Sciences B334, 213/516-3435

**MFC 580 Cross-Cultural Family Values and Behavior (3).** Prerequisite: Consent of instructor. Cultural factors affecting human behavior in complex societies. Emphasis upon the cultural behavior of the major ethnic groups in the United States as it relates to family organization and critical life choices. Required of MFCC students, or may substitute SOC 506, Seminar in the Sociology of Racial and Ethnic Relations.

## MATHEMATICS

Natural Sciences and Mathematics A132, 213/516-3378

**MAT 003 Beginning Algebra (3).** Prerequisite: E.O.P./Bridge students only. Topics covered include integers and rational numbers, polynomials, factoring, integer exponents, linear equations in one unknown, rational expressions, and word problems. This course is appropriate for students needing a review in algebra and, in conjunction with MAT 005, can be used as a preparation for the ELM examination. Credit earned from this course will not count toward a Bachelor's degree. CR/NC grading.

**MAT 005 Elementary Algebra and Geometry (3).** Prerequisite: E.O.P./Bridge students only. Topics covered include quadratic equations, linear inequalities, systems of linear equations, graphs, square roots, geometry and, in conjunction with MAT 003, can be used as a preparation for the ELM examination. Credit earned from this course will not count toward a Bachelor's degree. CR/NC grading.

*Mathematics courses  
continue on page 14.*

**GS** Courses fulfilling CSUDH General Studies requirements.

**GS** **MAT 101 Algebra (3).** Prerequisites: MAT 005 or one year of high school algebra and fulfillment of the ELM requirement. Topics include polynomial equations, graphing, determinants, systems of equations, radical and exponential expressions, complex numbers, logarithmic expressions and calculations, progressions and series, the binomial theorem. A-C/NC grading.

**MAT 131 Elementary Statistics and Probability (3).** Prerequisite: MAT 005 or one year of high school algebra and fulfillment of the ELM requirement. A practical course in probability and statistics including such topics as the binomial and normal distributions, confidence intervals, T, F, and chi-square tests, linear regression and correlations, and conditional probability.

**MAT 151 Pre-Calculus Mathematics (3).** Prerequisite: MAT 101 or equivalent with a grade of C or better. Topics covered include the function concept, exponential and logarithmic functions, and plane trigonometry.

**GS** **MAT 171 Calculus for Management and Life Sciences I (4).** Prerequisite: MAT 101 or equivalent with a grade of C or better. Functions, linear equations, the derivative and its applications, the integral and its applications, and partial derivatives.

**GS** **MAT 191 Calculus I (4).** Prerequisite: MAT 151 or equivalent with a grade of C or better. Differential and integral calculus of one variable: limites, continuity, derivatives, applications of derivatives, integration, Fundamental Theorem of Calculus, applications of the integral, exponential and logarithmic functions. Elements of geometry as needed to develop the calculus.

**GS** **MAT 193 Calculus II (4).** Prerequisite: MAT 191 or equivalent with a grade of C or better. Differentiation and integration of Trigonometric functions, techniques of integration, conic sections, polar coordinates, parametric equations, and solid analytic geometry.

**GS** **MAT 261 Discrete Mathematics I (3).** Prerequisites: Programming experience and either MAT 173 or MAT 193 or equivalent with a grade of C or better. Set Theory, logic, Boolean algebra, graph theory, and matrix algebra, with applications to computers and computer programming.

## MEXICAN AMERICAN STUDIES

Humanities and Fine Arts A340, 213/516-3326

**MAS 300 Introduction to Mexican-American Studies (3).** Prerequisite: MAS 100 is recommended. An introduction to the historical, political, psychological, and social aspects of the Mexican-American experience. Includes an analysis of the various forces and circumstances that make up the second largest minority in the United States. This course meets the intent of Assembly Bill 1117 of September 4, 1969.

## MUSIC

Humanities and Fine Arts A332, 213/516-3543

**MUS 109 Introduction to Musicianship (1)** An activity course in which students will begin exercises in music perception skills. Pitch matching, identification of musical patterns, beginning ear-training and sight-singing drills. Preparation for the Musicianship Proficiency Exam.

**GS** **MUS 110 Music Fundamentals (3).** Prerequisite: Concurrent enrollment in MUS 109 is recommended. Music rudiments taught through reading, writing, harmonizing and creating songs, includes principles of notation, key signatures, scales, intervals, triads and chord progressions. Satisfies a requirement in General Studies.

**MUS 180, 280, 380, 480 Individual Lessons (1).** Prerequisite: Consent of instructor. Individual instruction in the student's major performance medium. Development of technique and repertoire. One-half hour lesson each week. Individual lesson times are arranged with the studio teacher. Some lessons may be off-campus. Public performance and jury evaluation expected. Lessons are available in VOICE, PIANO, HARPSICHORD, ORGAN, FLUTE, OBOE, CLARINET, BASSOON, SAXOPHONE, TRUMPET, HORN, TROMBONE, TUBA, PERCUSSION, VIOLIN, VIOLA, CELLO, STRING BASS, HARP, CLASSICAL GUITAR, LUTE, COMMERCIAL GUITAR, and ELECTRIC BASS. Primarily for performance majors. Instrument fee may be required.

**MUS 209 Musicianship Skills (1).** Prerequisites: MUS 101, MUS 109, and MUS 110 are recommended. Ear training, sight-singing, rhythm, keyboard harmony, and melodic and rhythmic dictation. This course is meant to parallel work in Music 210 and 211.

**MUS 210 Music Theory I (3).** Prerequisite: Consent of instructor. The theory of music with emphasis on materials derived from the Common Practice Period (1700-1900). The vocabulary of diatonic scales and modes, chords and their relationships, phrase structure and cadences, harmonic progressions, non-harmonic tones and the technique of harmonization.

**MUS 294 Independent Study (1-3).** Prerequisites: Consent of instructor and department chair. In consultation with a Music faculty member, the student investigates a scholarly topic or undertakes directed research of a creative project. Summer students must obtain contract form from *Summer Sessions Office*; complete form, with signatures of instructor and dean, must be submitted with request for enrollment.

**MUS 330 Audio Recording (3).** Theory and practice of sound recording. Acoustics, psychoacoustics, microphones and microphone techniques, consoles, mixers, signal processing and analog tape machines.

**MUS 335 Music Synthesis (3).** Techniques, equipment, theory, and history of electronic music. Psychoacoustics, classical tape studio techniques, and a conceptual approach to sound synthesis using modular synthesizers.

**MUS 435 Advanced Music Synthesis (3).** Prerequisites: MUS 330 and consent of instructor. A continuation of MUS 330. Digital synthesizer concepts and history of computer music. Computer control of analog synthesizers, theory and use of MIDI specification, direct software and hardware sound synthesis theory.

**MUS 486 Twentieth Century Music (3).** Prerequisite: MUS 101 and MUS 110 or consent of instructor. Stravinsky, Schoenberg, Bartok, Cowell, Varese, Cage, Glass and other composers representing the various movements in twentieth century music.

**MUS 494 Independent Study (1-3).** Prerequisites: Consent of instructor and department chair. In consultation with a Music faculty member, the student investigates a scholarly topic or undertakes a creative project.

**MUS 496 Music Internship (1,3).** Prerequisite: Consent of department chair. Students participate in an off-campus internship with an approved employer. Provides for an integration of academic study and related work experience. CR/NC grading.



## PHILOSOPHY

Humanities and Fine Arts E313, 213/516-3328

**GS PHI 102 Humanity, Nature and God (3).** Critical examination of perennial philosophical issues such as the existence of God, free will, truth. Both Western and non-Western perspectives are discussed. Gives student general understanding of his/her societal context. Essays as well as exams.

**GS PHI 120 Critical Reasoning (3).** Introduction to methods of critical thinking including the nature of arguments, formal and informal fallacies, deductive and inductive arguments. Provides students with critical skills in both academic and non-academic context.

**PHI 494 Independent Study (1-3).**  
**Prerequisite:** PHI 250 is recommended. Study of a particular philosophical or religious problem, individually or as a team or group, under the direction of a faculty member. Only 3 units may be used for Philosophy minor requirements. Summer students must obtain contract form from *Summer Sessions Office*; completed form, with signatures of instructor and dean, must be submitted with request for enrollment.

**PHI 495 Special Topics: Religion and Philosophy (3).** Study and discussion of current beliefs and views on religion, God, the Bible, and related questions.

## PHYSICAL EDUCATION

Fieldhouse C003, 213/516-3761

**PED 218 First Aid and CPR (3).** Provides opportunity to qualify for American Red Cross certification in Standard First Aid and CPR. Students study and practice administering first aid techniques; examine accident and injury preventive measures; and train to master cardiopulmonary resuscitation techniques.

**PED 494 Physical Education: Independent Study (1-3).** **Prerequisite:** Physical Education Major or Minor; upper division standing. Advanced study in physical education, with each student participating in a special project mutually agreed upon by student and instructor. Summer students must obtain contract form from *Summer Sessions Office*; completed form, with signatures of instructor and dean, must be submitted with request for enrollment.

**PED 594 Physical Education: Independent Study (1-3).** Advanced study in physical education with each master's degree student participating in a special project mutually agreed upon by student and instructor. Summer students must obtain contract form from *Summer Sessions Office*; completed form, with signatures of instructor and dean, must be submitted with request for enrollment.

## PHYSICS

Natural Sciences and Mathematics B202, 213/516-3591

**GS PHY 100 Patterns in Nature (3).** Unifying principles of elastic, sound, light and matter waves. Models of nature. Successes and failures of wave and particle models and their synthesis. Designed for non-science students. Partially meets the lower division General Studies requirement in Natural Sciences.

**PHY 108 Physical Science II (3).**  
**Prerequisite:** PHY 106 or equivalent. Electricity and magnetism and light. Atomic structure, chemical families and bonding. Applications to Astronomy.

**PHY 120 Elements of Physics (4).**  
**Prerequisite:** High school or college algebra. Motion, energy, waves and heat treated from a non-calculus point of view.

**PHY 122 Elements of Physics II (4).**  
**Prerequisite:** PHY 120. Electricity, magnetism and light. Nuclear radiation. Quantum phenomena. Atomic structure.

**PHY 132 General Physics II (5).**  
**Prerequisites:** PHY 130 and MAT 193 or concurrent enrollment. Waves, light, electricity and magnetism.

**PHY 402 Workshop in Physical Sciences for Teachers (3).** A lecture-demonstration course designed for in-service teachers of fourth through eighth grades. Approaches and subject matter will be consistent with the California Science Framework Addendum. Topics frequently found in the textbooks of these grades will be covered in depth. Students will develop lesson plans and construct appropriate demonstrations with low cost everyday objects for use in their classes. Approximate materials cost \$20.

## POLITICAL SCIENCE

Social and Behavioral Sciences G322, 213/516-3434

**POL 101 American Institutions (3).** A study of contemporary political institutions, with emphasis on the philosophy, structure, and behavior of the American political system, including the State of California. Meets State requirement in U.S. Constitution and California State and Local government.

**POL 310 Current Issues in American Government (3).** Analysis and critical evaluation of recent major issues, conflicts and problems in American government and institutions. Current issues might include social and health services, energy, environment, multinational corporations, military spending, taxation, political economy, criminal justice, and civil rights.

**POL 328 Cultural Pluralism in American Politics (3).** Discusses the issues of political socialization and cultural differences in the American political arena. Analyzes the political orientations of various ethnic groups in the United States, their cultural and socioeconomic backgrounds, and their levels of political participation and interaction with American political institutions.

**POL 494 Independent Study (2-3).**  
**Prerequisite:** Consent of instructor. Independent study of a particular problem under the direction of a member of the Political Science Department. Summer students must obtain contract form from *Summer Sessions Office*; completed form, with signatures of instructor and dean, must be submitted with request for enrollment.

## PSYCHOLOGY

Social and Behavioral Sciences A336, 213/516-3427

**PSY 350 Developmental Psychology (3).** The cognitive, psychological and social development of the child from birth to adolescence. Fieldwork at discretion of instructor.

**PSY 363 The Abnormal Personality (3).** The causes and manifestations of abnormal behavior. Field study and case study.

**PSY 494 Independent Study (2-3).**  
**Prerequisite:** Consent of instructor. A reading program of selected topics conducted under the supervision of a faculty member. Summer students must obtain contract form from *Summer Sessions Office*; completed form, with signatures of instructor and dean, must be submitted with request for enrollment.

**PSY 498 Directed Research (2-3).**  
**Prerequisite:** Consent of instructor. The student develops and completes an individual study under faculty supervision. Summer students must obtain contract form from *Summer Sessions Office*; completed form, with signatures of instructor and dean, must be submitted with request for enrollment.

**GS** Courses fulfilling CSUDH General Studies requirements.

## PUBLIC ADMINISTRATION

Natural Sciences and Mathematics A143, 213/516-3444

**PUB 375 Essentials of Risk Management (3).** **Prerequisite:** PUB 305 or its equivalent; PUB 324 is recommended. Course provides opportunity to demonstrate ability to identify and analyze insurance risks and then develop attractive solutions to reduce, transfer, assume, or avoid that risk; includes use of probabilities and decision-making models.

**PUB 510 Seminar: Public Financial Management (4).** **Prerequisite:** Consent of instructor. Examination of methods, processes and problems in the administration and budgeting of public revenues, revenue generation, forecasting, cost control, financial management cases.

## SCIENCE, MATHEMATICS AND TECHNOLOGY

Natural Sciences and Mathematics A115, 213/516-3373

**SMT 100 Basic Word Processing (1).** **Prerequisite:** E.O.P./Bridge students only. Introduction to the use of microcomputers for wordprocessing and document preparation. CR/NC grading.

**GS SMT 310 Science and Technology (3).** An assessment of the interrelationships of Science and Technology. Study of the development of technological advances and the scientific principles behind them.

**SMT 312 Natural Processes and Human Welfare (3).** **Prerequisite:** Completion of lower division General Studies science requirement is required; upper division standing is recommended. Impact of natural events on human activities and vice versa. Mankind's uneasy relationship with atmosphere, ocean and not-so-solid earth.

**GS SMT 314 Introduction to Cosmology (3).** An introduction to the major theories of the origin and structure of the universe and the evidence for them, with attention to the way earlier ideas have been incorporated in modern thought. The Big Bang Theory will be examined in depth.

## SOCIOLOGY

Social and Behavioral Sciences G322, 213/516-3431

**SOC 334 Women in Society (3).** The goal of this course is to analyze the changing role of women in contemporary societies. In 1961 Simone de Beauvoir wrote that women were secondary to men. In the 1980s women have made strides toward equality on all levels. This course is designed to explore women's efforts toward equality by examining their roles cross culturally. Students will analyze women's changing roles in Third World societies, such as

their participation in liberation struggles, and their involvement in processes of development, as compared to women's role in the United States and other industrial societies. Cases from African nations will be considered in terms of women's participation in the labor force, politics, and the economic structure.

**SOC 395-11 Special Topics: Media and Society (3).** A study of the impact of mass media on social processes, American institutions and social change. Particular attention is given to dissemination of information by television, newspapers, film, and implications for attitudinal and/or behavioral effects.

**SOC 395-12 Special Topics: Immigrants and Ethnic Groups of the 1980's (3).** This course will explore the changing roles and interactions of new immigrants and ethnic groups in Los Angeles. The class will begin by considering various learning methods to study inter-group relations. These efforts will then permit us to focus on current issues involving work experience and special interest groups (service industries vs. manufacturing industries) in changing social structures. Life styles, attitudes, beliefs and quality of life issues will be examined.

**SOC 395-13 Special Topics: Counseling and the Changing American Family (3).** While the impact of recent marriage and divorce trends has yet to be felt, we are witnessing a slowdown in the rate of first marriages, and divorce trends has yet to be felt, we are witnessing a slowdown in the rate of first marriage after divorce accompanied by an increase in divorce. Is the "American" family going to survive? Just as the extended family was replaced by the nuclear family, is the nuclear family being replaced by single parent family or "transitional living arrangements?" Is marriage becoming a part-time career, a phase in one's life cycle, rather than a lifetime status that is synonymous with being adult? If so, what roles does counseling play in preparing adults in adapting to such changes? How will increasing communications, teaching married folks how to relate to each other, provide answers to changing societal definitions of marriage and divorce? These and other related questions will be addressed in this course which examines the relationship between counseling strategy and the changing American family.

**SOC 395-21 Special Topics: Sex Roles and Society (3).** All you ever wanted to know about sex and sex roles in contemporary society. "Traditional" versus "liberated" definitions of male and female roles. Conventional and unconventional sexual relationships. Differences in gender roles by race, ethnicity, and class.

**SOC 494 Independent Study (1,3).** **Prerequisite:** Consent of instructor. A reading program of selected topics conducted under the

supervision of a faculty member. Summer students must obtain contract form from *Summer Sessions Office*; completed form, with signatures of instructor and dean, must be submitted with request for enrollment.

**SOC 550 Seminar in Interaction Processes (3).** Experience in both the theoretical and practical study of microsociology. Stress on the small group, with specific concern for problems such as communication, leadership, decision-making, gamesmanship, equilibrium, and change. Relevant research literature reviewed, and laboratory experiments in interaction processes conducted.

**SOC 597 Directed Reading (1-3).** Assignment of a reading list formulated under consultation with a supervising faculty member. Summer students must obtain contract form from *Summer Sessions Office*; completed form, with signatures of instructor and dean, must be submitted with request for enrollment.

**SOC 598 Directed Research (1-3).** Independent research under the direction of a member of the Sociology faculty. Summer students must obtain contract form from *Summer Sessions Office*; completed form, with signatures of instructor and dean, must be submitted with request for enrollment.

**SOC 599 Graduate Capstone In Sociology (1-5).** **Prerequisites:** SOC 505, SOC 555, SOC 511 or SOC 550 and Advancement to Candidacy in Sociology Graduate Program is required. Supervised thesis, special project, or comprehensive examinations in sociology.

## SPANISH

Humanities and Fine Arts A338, 213/516-3315

**SPA 151 Introduction to Hispanic Culture (3).** **Prerequisite:** E.O.P./Summer Bridge Students only. A designated geographical area studies course focusing on patterns of culture in the Spanish-speaking world. Specific topics include Mexico and the Southwestern U.S., or Contemporary Spain. Conducted in English.

**SPA 341 Advanced Conversation (3).** **Prerequisite:** SPA 221 or equivalent. Intensive conversation leading to fluency in the use of idiomatic, everyday Spanish and the development of a comprehensive, practical vocabulary. Useful for public service, as well as for the bilingual/cross-cultural credential program.

## THEATRE ARTS

University Theatre A101, 213/516-3588

**THE 120 Fundamentals of Speech (2).** Basic oral communication skills, with practice in a variety of speech-oriented situations.

## Travel Study Programs

### LONDON SEMESTER PROGRAM

#### Fall Semester 1987

Study British literature, history and culture with expert CSU faculty as you enjoy living in central London and exploring the city's attractions. The London Business Semester offers a variety of courses in business and international business.

The fourteen-week program is co-sponsored by the CSU Extended Education network and the American Institute for Foreign Study, which is responsible for non-academic arrangements. In London, a complete social program including your housing and meals, will be arranged by A.I.F.S. — an organization with extensive experience in foreign study programs. Twelve semester credits are earned upon successful completion of course work. (Enrollment in this travel study program is open to non-CSUDH participants who meet the academic qualification for participation.)

For further information about the London Semester program and the Fall 87 semester call the Extension office at 213/516-3746 for a brochure.

### MEXICO: MORELIA AND ITS ENVIRONS

— June 28 through July 18, 1987

— Learn Spanish in Mexico

Enjoy 21 days in Mexico studying Spanish and experiencing Mexican culture with Dr. Ben Pena. Explore the rich colonial and pre-Colombian traditions of Morelia and its surrounding villages and towns.

Morelia, capital of the state of Michoacan, is located in the beautiful central highland plateau of Mexico. There, among some of the finest colonial architecture in Mexico, participants in this program will live with selected Morelian families and attend morning classes in a beautifully maintained colonial building.

#### STUDY PROGRAM

All participants will enroll for 3 units of university credit; either Spanish 230, Conversation, or Spanish 341, Advanced Conversation. These courses help you to use Spanish skills immediately in real-life situations. At least one year of college Spanish or consent of Dr. Pena is required to participate.

Dr. Ben Pena, faculty director of the program, is associate professor of Spanish at CSUDH and has extensive experience in teaching career-related Spanish.

#### TRAVEL AND TOURS

Participants will fly from Los Angeles to Mexico City with a connecting flight to Morelia. In addition to discovering the cultural riches and natural beauty of Morelia, participants, with guides, will tour important historical and archaeological sites in the region surrounding Morelia. Weekly one-day excursions include trips to: Santa Clara del Cobre, famous for handcrafted copperwork; Capula, known for its pottery; Tzin Tzun Tzan, a pre-Colombian archaeological site featuring pyramids and a sacrificial altar; Janitzio, an island on Lake Patzcuaro; Patzcuaro, a fascinating city with a wonderful museum of Mexican crafts.

#### COST OF PROGRAM

Total cost of the 1987 program is \$1,300. This price includes round trip airfare (Los Angeles-Mexico City-Morelia); all scheduled travel and tours; food and lodging for three weeks; instructional fees for 3 semester units of upper division credit. Minimum and maximum enrollment quotas apply.

For more information or to apply to the "Mexico: Morelia" travel study program, please contact Dr. Ben Pena, 213/516-3315, or the Division of Extended Education, 213/516-3741.

## Special Summer Credit Programs

### ELEMENTS OF PHYSICS I & II

A non-calculus, two-semester course in introductory physics designed for life science majors (biology, pre-med) is offered in an intensive ten-week format. Physics 120 is offered June 16-July 16; Physics 122 is offered July 20-August 20. This program should be helpful for MACT & DAT. Students *must* enroll for both lecture and laboratory of one course, but may take PHY 120 or PHY 122, or both. Each course is offered for 4 semester units. See scheduling information on page 23.

### CSU SUMMER ARTS '87

July 5 through August 1

Join a one- to four-week resident program in the arts on the beautiful San Luis Obispo campus this summer. The program features professional workshops in the performing and visual arts with nationally recognized guest artists.

For more information, contact the Special Programs Office of the Office of the Chancellor, California State University, 400 Golden Shore, Suite 318, Long Beach, CA 90802-4275. Phone: 213/590-5768.

### RESOURCE SPECIALIST CERTIFICATE WORKSHOPS

Two 3-week workshops are designed to meet the state guidelines for the Resource Specialist Certificate required of all teachers employed as special education Resource Specialist since June 30, 1981. Resource Specialists employed prior to that date may also find this workshop valuable in providing indirect services to handicapped children in the public school. At this time the total program at CSUDH for the state Resource Specialist Certificate consists of three courses:

GED 527 RESOURCE SPECIALIST I:

Program Planning

GED 528 RESOURCE SPECIALIST II:

Indirect Services

GED 529 RESOURCE SPECIALIST III:

Advance Services

Each course is offered for 3 semester units.

The first two courses, (GED 527 and GED 528) will be offered this summer as 3-week evening workshops M, T, W, Th from 5-8:50 p.m. (See course listing for time and place.) Following successful completion of the summer workshops, participants may then satisfy the advanced services component (GED 529) during Fall Semester. GED 529 completes requirements for the clear Resource Specialist Certificate approved by the state Commission on Teacher Credentialing (June 1984).

For further information on admission to this certificate program contact the Graduate Education Department Secretary, or Dr. Skindrud, Coordinator, Special Education, 213/516-3522.

### PRE-MEDICAL DENTAL ORGANIC CHEMISTRY

Designed for pre-medical and pre-dental students, this ten-week program corresponds to a full year of organic chemistry with lab. CHE 300/301 is scheduled for the first five weeks, followed by CHE 302/303 for the second five weeks. The two sequential courses offer 8 semester units — the required minimum in organic chemistry for professional schools.

Students who have taken the program in previous summers have also found it very useful in preparing for DAT and MCAT.

The tuition fee for the program is \$736.00 plus \$13.00 student fees. See page 19 for class meeting information.

Instructors: James Lyle, Ph.D., professor of Chemistry; Ulrich de la Camp, Ph.D., professor of Chemistry; Thomas Reilly, Ph.D., associate professor of Chemistry.

# Summer Sessions Course Schedule

## GUIDE TO THE SUMMER SESSIONS COURSE SCHEDULE

Sections of courses are listed alphabetically by the name of the academic department. However, departments within the Center for Quality Education and the School of Management are listed, respectively, under "Education" and "Business." Please read course descriptions as well for prerequisites or special consents or qualifications to enroll.

Please note that sections are identified as offered in either First or Second Session by the first digit of the section number:

- section numbers beginning with '1' signify First Session course, e.g. 11;
- section numbers beginning with '2' signify Second Session course, e.g. 12;
- section numbers beginning with '6' signify that dates are non-standard, e.g. 61. Special dates are listed under the title.

For your convenience courses are grouped by Session within departmental heading.

Since First and Second Sessions overlap, please be sure to check that the Summer Sessions courses you select do not conflict and that you do not exceed — without permission — the maximum unit load.

## COURSE CANCELLATION AND SCHEDULE CHANGES

The University reserves the right to make changes in this schedule as printed. When enrollment in any class is not sufficient to justify its continuance, the course may be cancelled. Faculty may be reassigned from one section to another to adjust the distribution of enrollment. Meeting times may also be changed when circumstances require.

If the University cancels a class, the student will receive a full refund of fees UPON APPLICATION FOR REFUND. Or student may register in another class in the same Session without charge of a late fee.

Sched. Number	Dept. & Course Number	Sess.	Sec.	Title	Units	Course Type	Instructor	Days	Hours	Bldg/Room	Fees
<b>Anthropology • First Session</b>											
13392	ANT 315	1	1	Magic & Religion	3	LEC	K Kuykendall	TTH	8:00 - 11:30AM	SBS B203	\$246
13381	ANT 370	1	1	Peoples Of The Old World	3	LEC	J Calvert	MWF	9:00 - 11:20AM	SBS A144	\$246
13241	ANT 494	1	1	Independent Study	3	SUP	Staff	TBA	TBA		\$246
<b>Art • First Session</b>											
12316	ART 301	1	1	Arts/Crafts For Non-Major	3	ACT	S Smith	MTWTH	12:30 - 4:00PM	HFA A115	\$246
12320	ART 383	1	1	Silkscreen	3	ACT	S Smith	MTWTH	9:00 - 12:30PM	HFA A115	\$246
12331	ART 388	1	1	Human Figure in Painting	3	ACT	J Hosticka	MW	9:00 - 4:00PM	HFA A106	\$280
<b>Art • Second Session</b>											
10555	ART 495	2	1	Special Stud in Art His: L.A. Galleries & Museums	3	LEC	S Ballatore	MW	12:30 - 4:00PM	ERC G149	\$246
10566	ART 495	2	2	Special Stud in Art His: History of Landscape Art	3	LEC	S Ballatore	TTH	12:30 - 1:30PM	ERC G149	\$246
<b>Behavioral Science • Second Session</b>											
15024	BEH 597	2	1	Directed Reading	3	SUP	F Hosokawa	TBA	TBA		\$246
<b>Biology • Off-Cycle Session</b>											
14324	BIO 102	6	1	General Biology 6/22 - 8/7	3	LEC	R Giacosisie	MW	9:00 - 11:10AM	SBS B110	\$246
13996	BIO 102	6	1L	General Biology Lab 6/22 - 8/7		LAB	R Giacosisie	MW	11:30 - 2:00PM	NSM B110	
15654	BIO 102	6	2	General Biology 6/22-8/7	3	LEC	R Giacosisie	MW	9:00 - 11:10AM	SBS B110	\$246
14825	BIO 102	6	2L	General Biology Lab 6/22 - 8/7		LAB	R Giacosisie	TTH	9:00 - 11:30AM	NSM B110	
14851	BIO 220	6	1	Introductory Microbiology 6/22 - 8/7	3	LEC	M Forgiarini	TTH	8:30 - 10:40AM	NSM D129	\$340
14862	BIO 220	6	1L	Introductory Microbio Lab 6/22 - 8/7		LAB	M Forgiarini	TTH	11:00 - 2:00PM	NSM C151	
14011	BIO 250	6	1	Elem Hum Anat & Physiol 6/22 - 8/7	3	LEC	M Dupree	MWF	8:00 - 10:30AM	NSM D123	\$328
14022	BIO 251	6	1L	Elem Hum Anatomy Phys Lab 6/22 - 8/7	1	LAB	M Dupree	MW	11:00 - 2:00PM	NSM C121	
<b>Business Administration (School of Management)</b> 300-, 400- and 500-level business courses and Accounting 231 require special approval; see page 4.											
<b>Business Administration • First Session</b>											
11255	BUS 445	1	1	International Business	3	LEC	G Wang	MW	12:30 - 4:00PM	SBS B110	\$246
14814	BUS 490	1	1	Management Policy Seminar	3	LEC	B Tesfay	TTH	6:00 - 9:30PM	SBS D219	\$246
<b>Accounting • First Session</b>											
10043	ACC 230	1	1	Financial Accounting	3	LEC	R Mazhin	MW	6:00 - 9:30PM	SBS A144	\$246
11211	ACC 231	1	1	Managerial Accounting	3	LEC	D Barnett	MW	6:00 - 9:30PM	SBS B137	\$246
11222	ACC 330	1	1	Intermediate Accounting I	3	LEC	C Chang	MW	6:00 - 9:30PM	SBS E220	\$246
11233	ACC 333	1	1	Income Taxation I	3	LEC	R Jaffe	TTH	6:00 - 9:30PM	SBS B137	\$246
11244	ACC 337	1	1	Cost Accounting	3	LEC	M El-Badawi	TTH	6:00 - 9:30PM	SBS B209	\$246
<b>Computer Information Systems • First Session</b>											
11266	CIS 270	1	1	Int to Comp and Data Proc	3	LEC	M Pine	TTH	9:00 - 12:30PM	SBS B231	\$266
15271	CIS 270	1	2	Int to Comp and Data Proc	3	LEC	M Pine	TTH	6:00 - 9:30PM	SBS B209	\$266

Sched. Number	Dept. & Course Number	Sess. Sec.	Title	Units	Course Type	Instructor	Days	Hours	Bldg/Room	Fees
<b>Finance • First Session</b>										
11281	FIN 360	1 1	Business Finance	3	LEC	R Ulivi	MW	12:30 - 4:00PM	SBS B140	\$246
11292	FIN 480	1 1	Economics of the Firm	3	LEC	C Lopilato	MW	9:00 - 12:30PM	SBS B143	\$246
11303	FIN 563	1 1	Fin Decision Analysis	3	LEC	R Ulivi	MW	6:00 - 9:30PM	SBS B140	\$246
<b>Law • First Session</b>										
11314	LAW 240	1 1	Legal Aspects of Bus Trans	3	LEC	F Strier	TTH	6:00 - 9:00PM	SBS B140	\$246
<b>Management • First Session</b>										
13882	MGT 310	1 1	Management Theory	3	LEC	B Chrispin	TTH	9:00 - 12:30PM	SBS D225	\$246
11174	MGT 310	1 2	Management Theory	3	LEC	R Dowling	MW	6:00 - 9:30PM	SBS E122	\$246
13904	MGT 312	1 1	Organizational Behavior	3	LEC	R Nehrbass	MW	12:30 - 4:00PM	SBS E122	\$246
11196	MGT 513	1 1	Hmn Beh in Organizations	3	LEC	R Nehrbass	MW	6:00 - 9:30PM	SBS E126	\$246
<b>Marketing • First Session</b>										
13926	MKT 350	1 1	Principles of Marketing	3	LEC	J Kitson	MW	6:30 - 10:00PM	SBS B143	\$246
11340	MKT 552	1 1	Marketing Management Sem.	3	SEM	J Kitson	TTH	6:30 - 10:00PM	SBS A204	\$246
<b>Quantitative Methods Systems • First Session</b>										
11373	QMS 321	1 1	Intro to Bus Statistics	3	LEC	B Yavas	TTH	6:00 - 9:30PM	SBS B238	\$246
11384	QMS 322	1 1	Production Management	3	LEC	E Chu	MW	6:00 - 9:30PM	SBS B110	\$246
14221	QMS 423	1 1	Intro Operations Research	3	LEC	B Yavas	TTH	12:30 - 4:00PM	SBS B140	\$246
<b>Chemistry • First Session</b>										
11756	CHE 102	1 1	Chemistry for the Citizen	3	LEC	T Reilly	MW	9:00 - 12:50PM	NSM D129	\$246
<b>Chemistry • Off-Cycle Session</b>										
15293	CHE 300	6 1	Organic Chemistry I 6/15 - 7/20	3	LEC	J Lyle	MTWTH	10:00 - 12:00PM	NSM C221	\$246
15304	CHE 300	6 2	Organic Chemistry I 6/15 - 7/20	3	LEC	U De La Camp	MTWTH	10:00 - 12:00PM	NSM C221	\$246
15326	CHE 301	6 1L	Organic Chemistry I Lab 6/15 - 7/15	1	LAB	J Lyle	MTW	1:00 - 4:00PM	NSM C351	\$122
15422	CHE 301	6 2L	Organic Chemistry I Lab 6/15 - 7/15	1	LAB	U De La Camp	MTW	1:00 - 4:00PM	NSM C339	\$122
14420	CHE 302	6 1	Organic Chemistry II 7/21 - 8/21	3	LEC	J Lyle	MTWTH	10:00 - 12:00PM	NSM C221	\$246
14431	CHE 302	6 2	Organic Chemistry II 7/21 - 8/21	3	LEC	T Reilly	MTWTH	10:00 - 12:00PM	NSM C221	\$246
14442	CHE 303	6 1L	Organic Chemistry II Lab 7/21 - 8/19	1	LAB	J Lyle	MTW	1:00 - 4:00PM	NSM C351	\$122
14453	CHE 303	6 2L	Organic Chemistry II Lab 7/21 - 8/19	1	LAB	T Reilly	MTW	1:00 - 4:00PM	NSM C339	\$122
<b>Communications • First Session</b>										
10570	COM 130	1 1	Film Classics	3	LEC	H Marienthal	TTH	9:00 - 12:30PM	ERC C112	\$246
13532	COM 487	1 1	TV Production Workshop	3	LEC	G Vinovich	W	6:30 - 9:30PM	ERC H120	\$246
10592	COM 495	1 1	Spec Topics in Com: Effects of Mass Media	3	LEC	G Vinovich	TTH	6:00 - 9:30PM	HFA A324	\$246
<b>Computer Science • First Session</b>										
11885	CSC 123	1 1	Intro to CSC and Prog II	3	LEC	Staff	MW	6:00 - 9:30PM	NSM D123	\$266
11896	CSC 221	1 1	Asmby and Intro to Org	3	LEC	A Cravetz	TTH	6:00 - 9:30PM	NSM C239	\$266
11922	CSC 311	1 1	Data Structures	3	LEC	P Rosenberg	MW	6:00 - 9:30PM	NSM C235	\$266
11944	CSC 321	1 1	Programming Languages	3	LEC	M Chaudhri	TTH	6:00 - 9:30PM	NSM D123	\$266
11955	CSC 331	1 1	Computer Organization	3	LEC	F Chimenti	MW	9:00 - 12:30PM	NSM D123	\$266
11970	CSC 351	1 1	Data Management	3	LEC	W Ryder	TTH	9:00 - 12:30PM	NSM D123	\$266
<b>Computer Science • Second Session</b>										
11841	CSC 111	2 1	Intro Computers and Basic	3	LEC	D Bradfield	MTWTH	9:00 - 10:50AM	SCC E139	\$266
13930	CSC 111	2 2	Intro Computers and Basic	3	LEC	W Ryder	MW	6:00 - 9:30PM	SCC E139	\$266
11863	CSC 121	2 1	Intro to CSC and Prog I	3	LEC	C William	MTWTH	11:00 - 12:50PM	SBS B137	\$266
11874	CSC 123	2 2	Intro to CSC and Prog II	3	LEC	L Larmore	MTWTH	9:00 - 10:50AM	SBS B137	\$266
11900	CSC 241	2 1	High Level Languages: ADA	3	LEC	L Larmore	TTH	6:00 - 9:30PM	NSM D129	\$266
11911	CSC 311	2 1	Data Structures	3	LEC	L Larmore	MTWTH	11:00 - 12:50PM	NSM D123	\$266
11933	CSC 321	2 1	Programming Languages	3	LEC	C Williams	MTWTH	9:00 - 10:50AM	NSM C213	\$266
11966	CSC 341	2 2	Operating Systems	3	LEC	C Williams	MW	6:00 - 9:30PM	NSM D129	\$266
<b>Dance • First Session</b>										
14033	DAN 100	1 1	Dance Exercise	1	ACT	D Berney	MTWTH	11:00 - 12:15PM	GYM A102	\$ 82
<b>Earth Sciences • First Session</b>										
11981	EAR 100	1 1	Intro to Earth Sciences	3	LEC	M Schwartz	TTH	9:00 - 12:30PM	NSM B222	\$246
<b>Economics • First Session</b>										
11410	ECO 210	1 1	Economic Theory 1A Micro	3	LEC	F Billes	TTH	2:00 - 5:30PM	SBS A144	\$246
11421	ECO 211	1 1	Economic Theory 1B Macro	3	LEC	R Freed	TTH	6:00 - 9:30PM	SBS B231	\$246

Sched. Number	Dept. & Course Number	Sess. Sec	Title	Units	Course Type	Instructor	Days	Hours	Bldg/Room	Fees
<b>Education (Center for Quality Education)</b>										
<b>Graduate Education • First Session</b>										
10113	GED 528	1 1	Resource SP II: Indir Ser 6/3 - 6/23	3	LEC	J Jackson	MTWTH	5:00 - 8:50PM	HFA A230	\$246
10161	GED 581	1 1	Princ Ed Psyc Assessment	3	LEC	D Scherba	TTH	4:00 - 6:30PM	ERC D131	\$246
10172	GED 582	1 1	Group Dynam Pers Growth 6/3 - 6/25	3	LEC	C Bohman	WTH	4:00 - 9:40PM	HFA A211	\$246
10183	GED 582	1 2	Group Dynam Pers Growth 6/3 - 6/25	3	LEC	N Detjen	WTH	4:00 - 9:40PM	HFA A217	\$246
12460	GED 594	1 1	Independent Study	3	SUP	Staff	TBA	TBA		\$246
14663	GED 594	1 2	Independent Study: Blk Heritage/ 6/8 First Meet.	3	SUP	M Carrison	M	5:30 - 7:00PM	HFA A219	\$246
12482	GED 597	1 1	Fieldwork Counseling	3	SUP	D Scherba	TBA	TBA		\$330
15234	GED 597	1 2	Fieldwork Counseling	3	SUP	C Bohman	TBA	TBA		\$330
12493	GED 598	1 1	Fieldwk School Psych	3	SUP	D Scherba	TBA	TBA		\$330
15120	GED 599	1 1	Thesis	2	SUP	Staff	TBA	TBA		\$164
12504	GED 599	1 2	Thesis	3	SUP	Staff	TBA	TBA		\$246
12515	GED 599	1 3	Thesis	4	SUP	Staff	TBA	TBA		\$328
12526	GED 599	1 4	Thesis	5	SUP	Staff	TBA	TBA		\$410
<b>Graduate Education • Second Session</b>										
10076	GED 500	2 1	Research Meth In Edu	3	LEC	J Cooper	MTWTH	4:00 - 5:50PM	HFA A229	\$246
10080	GED 501	2 1	Seminar in Learn & Dev	3	SEM	J Jackson	TW	1:00 - 4:30PM	HFA A219	\$246
10091	GED 525	2 1	Bill/Mult Teaching Methods	3	LEC	Staff	TTH	5:30 - 9:00PM	HFA A219	\$246
10102	GED 527	2 1	Resource Sp I: Prog Plan 6/24 - 7/14	3	LEC	Staff	MTWTH	5:00 - 8:50PM	HFA A223	\$246
12530	GED 535	2 1	Intro to Computers In Ed	3	LEC	P Desberg	MW	1:00 - 4:00PM	HFA A229	\$246
12375	GED 559	2 1	Generic Prac Except Child 6/22 - 1st Meet 9:00AM	4	SUP	D Okada	MTWTHF	8:30 - 12:30PM	HFA A230	\$420
12386	GED 566	2 1	Prac: Dir Tchg Sev Handicp	5	SUP	D Okada	MTWTHF	TBA	TBA	\$600
12390	GED 569	2 1	Prac: Dir Tchg Sev Handicp 6/22 - 1st Meet 9:00AM	5	SUP	K Skindrud	MTWTHF	8:00 - 2:00PM	HFA A330	\$600
12471	GED 594	2 1	Independent Study	3	SUP	Staff	TBA	TBA		\$246
12541	GED 599	2 1	Thesis	2	SUP	Staff	TBA	TBA		\$164
12552	GED 599	2 2	Thesis	3	SUP	Staff	TBA	TBA		\$246
12563	GED 599	2 3	Thesis	4	SUP	Staff	TBA	TBA		\$328
12574	GED 599	2 4	Thesis	5	SUP	Staff	TBA	TBA		\$410
<b>Teacher Education • Second Session</b>										
10382	TED 402	2 1	Motivation and Learning	3	LEC	P Desberg	MW	5:00 - 8:30PM	HFA A221	\$246
10393	TED 403	2 1	Teaching of Reading	3	LEC	P Ellis	TTH	9:00 - 12:30PM	HFA A228	\$246
10404	TED 404	2 1	Fieldwork: Reading	1	SEM	S Prescott	W	9:00 - 11:30AM	HFA A228	\$ 82
10415	TED 405	2 1	Mainstrm Ch/Spec Need	3	LEC	D Wolff	MW	12:30 - 4:00PM	ERC D120	\$246
10426	TED 405	2 2	Mainstrm Ch/Spec Need	3	LEC	D Wolff	MW	5:00 - 8:30PM	HFA A224	\$246
12773	TED 413	2 1	Elem Meth In Art/Music/PE	3	LEC	Staff	TTH	1:00 - 5:15PM	GYM A104	\$246
15385	TED 415	2 1	Multic Perspective Tchrs	3	LEC	M Carrison	MW	12:30 - 4:00PM	ERC E127	\$246
12784	TED 430	2 1	Student Teaching Elem	3	SUP	D Laos	TBA	TBA		\$360
10463	TED 436	2 1	Sem: Elem Student Teach	1	SEM	D Laos	M	3:30 - 5:30PM	HFA A330	\$ 82
13521	TED 440	2 1	Student Teach-Secondary	3	SUP	L Cook	TBA	TBA		\$360
10485	TED 456	2 1	Sem: Second Student Teach	1	SEM	L Cook	M	3:30 - 5:30PM	HFA A211	\$ 82
10496	TED 467	2 1	Teach Meth I: Secondary	3	LEC	S Prescott	TTH	1:00 - 4:30PM	HFA A324	\$246
<b>English • First Session</b>										
10651	ENG 088	1 1	Developmental Reading Summer Bridge Students Only	3	LEC	E Smith	MTWTH	11:00 - 12:50PM	HFA A219	\$ 60
10662	ENG 088	1 2	Developmental Reading Summer Bridge Students Only	3	LEC	E Smith	MTWTH	4:00 - 5:50PM	HFA A227	\$ 60
10673	ENG 099	1 1	Basic Writing Workshop Summer Bridge Students Only	3	LEC	G Johnson	MW	6:00 - 9:30PM	HFA A222	\$ 60
10684	ENG 110	1 1	Freshman Composition I	3	LEC	J Rosewall	MW	9:00 - 12:30PM	HFA A221	\$246
10695	ENG 111	1 1	Freshman Composition II	3	LEC	J Rosewall	MW	12:30 - 4:00PM	HFA A230	\$246
10710	ENG 344	1 1	Afro-American Prose	3	LEC	G Johnson	MW	12:30 - 4:00PM	HFA A223	\$246
10732	ENG 350	1 1	Advanced Composition	3	LEC	J Vaughn	TTH	9:00 - 12:30PM	HFA A227	\$246
10743	ENG 352	1 1	Writ Spkg Skills Mgmt	3	LEC	M Shafer	MW	12:30 - 4:00PM	HFA A228	\$246
15046	ENG 467	1 1	Shakespeare	3	LEC	M Shafer	MW	9:00 - 12:30PM	HFA A222	\$246
13554	ENG 494	1 1	Independent Study	1	SUP	Staff	TBA	TBA		\$ 82
12342	ENG 494	1 2	Independent Study	2	SUP	Staff	TBA	TBA		\$164
12423	ENG 494	1 3	Independent Study	3	SUP	Staff	TBA	TBA		\$246
13543	ENG 594	1 1	Independent Study	1	SUP	Staff	TBA	TBA		\$ 82
12445	ENG 594	1 2	Independent Study	2	SUP	Staff	TBA	TBA		\$164
12456	ENG 594	1 3	Independent Study	3	SUP	Staff	TBA	TBA		\$246
<b>English • Second Session</b>										
14346	ENG 314	2 1	English Syntax: The Grammar Course	3	LEC	J Bailard	MW	12:30 - 4:00PM	HFA A324	\$246
10706	ENG 325	2 1	Poetry	3	LEC	S Waterworth	TTH	12:30 - 4:00PM	HFA A229	\$246
10721	ENG 350	2 1	Advanced Composition	3	LEC	T Gianotti	MW	6:00 - 9:30PM	HFA A229	\$246
10754	ENG 352	2 1	Writ Spkg Skills Mgmt	3	LEC	Staff	TTH	6:00 - 9:30PM	HFA A229	\$246
10776	ENG 590	2 1	Seminar In Literature	3	SEM	T Gianotti	MW	12:30 - 4:00PM	HFA A222	\$246

Sched. Number	Dept. & Course Number	Sess.	Sec.	Title	Units	Course Type	Instructor	Days	Hours	Bldg/Room	Fees
<b>Geography • First Session</b>											
11432	GEO 359	1	1	Geography of California	3	LEC	C Moser	TTH	8:00 - 11:30AM	SBS A104	\$246
11443	GEO 395	1	1	Spec Topics in Geography: Environ. Issues & Future	3	LEC	C Moser	TTH	6:30 - 10:00PM	SBS A104	\$246
13252	GEO 494	1	1	Independent Study	1	SUP	Staff	TBA	TBA		\$ 82
13263	GEO 494	1	2	Independent Study	2	SUP	Staff	TBA	TBA		\$164
13274	GEO 494	1	3	Independent Study	3	SUP	Staff	TBA	TBA		\$246
13311	GEO 498	1	1	Directed Research	1	SUP	Staff	TBA	TBA		\$ 82
13451	GEO 498	1	2	Directed Research	2	SUP	Staff	TBA	TBA		\$164
13322	GEO 498	1	3	Directed Research	3	SUP	Staff	TBA	TBA		\$246
<b>Geography • Second Session</b>											
13440	GEO 395	2	1	Spec Topics in Geography: Environ. Issues & Future	3	LEC	C Moser	TTH	8:00 - 11:30AM	SBS A104	\$246
13285	GEO 494	2	1	Independent Study	1	SUP	Staff	TBA	TBA		\$ 82
13296	GEO 494	2	2	Independent Study	2	SUP	Staff	TBA	TBA		\$164
13300	GEO 494	2	3	Independent Study	3	SUP	Staff	TBA	TBA		\$246
13333	GEO 498	2	1	Directed Research	1	SUP	Staff	TBA	TBA		\$ 82
13344	GEO 498	2	2	Directed Research	2	SUP	Staff	TBA	TBA		\$164
13355	GEO 498	2	3	Directed Research	3	SUP	Staff	TBA	TBA		\$246
<b>Health Science • Second and Off-Cycle Session</b>											
14066	HEA 250	6	1	Normal & Pathological Gait 6/9 - 8/11	2	LAB	T Lunsford	T	4:00 - 6:00PM	TBA	\$320
14070	HEA 252	6	1	Strngth-Materl & Fast Tech 6/4 - 8/6	2	LAB	T Lunsford	TH	4:00 - 6:00PM	TBA	\$320
15153	HEA 300	2	1	Health in Pub. Education	3	LEC	Staff	TTH	1:00 - 4:30PM	ERC D120	\$246
11476	HEA 315	2	1	Health Communication 6/17 - 8/19	3	LEC	S Pavey	TTH	6:00 - 9:30PM	SHC A145	\$246
13495	HEA 316	6	1	Medical Science 6/17 - 8/21	3	LAB	C Walker	W	6:00 - 9:45PM	SHC A145	\$246
13506	HEA 342	6	1	Lower Limb Orthotics II 6/5 - 8/7	3	LAB	T Lunsford D Clark	F	8:00 - 4:30PM	NSM E029	\$480
13510	HEA 352	6	1	Below Knee Prosthetic II 6/3 - 8/5	3	LAB	R Chavez E Ayyappa	W	8:00 - 4:30PM	NSM C109	\$480
<b>History • First Session</b>											
11513	HIS 101	1	1	History of United States	3	LEC	D Hata	MW	8:00 - 11:30AM	SBS B140	\$246
11524	HIS 111	1	1	Western World: Modern Exp	3	LEC	C Udeze	TTH	8:00 - 11:30AM	SBS A204	\$246
13226	HIS 494	1	1	Independent Study	3	SUP	Staff	TBA	TBA		\$246
<b>History • Second Session</b>											
11535	HIS 370	2	1	Studies in Religious Hist: Christian Church to 500 AD	3	LEC	C Udeze	TWTH	11:30 - 1:50PM	SBS A204	\$246
11546	HIS 395	2	1	Special Topic in History: So. Africa Peoples	3	LEC	C Udeze	TTH	6:00 - 9:30PM	SBS E126	\$246
13366	HIS 494	2	1	Independent Study	3	SUP	Staff	TBA	TBA		\$246
<b>Humanities • First Session</b>											
10802	HUM 100	1	1	Introduction to Humanities	3	LEC	P Rodney	MTWTH	9:00 - 10:50AM	HFA A224	\$246
10813	HUM 310	1	1	Key Concepts: Political Propaganda/Film and Literature	3	LEC	H Marienthal	TTH	12:30 - 4:00PM	ERC C112	\$246
<b>Humanities • Second Session</b>											
15116	HUM 100	2	1	Introduction to Humanities	3	LEC	D Lewis	MTWTH	9:00 - 10:50AM	HFA B324	\$246
<b>Library • First Session</b>											
13716	LIB 150	1	1	Lib Skills and Strategies	2	LEC	S Gogin	TTH	9:00 - 12:30PM	ERC D121	\$164
13705	LIB 150	1	1L	Lib Skills and Strategies		ACT	S Gogin	TBA	TBA		
<b>Linguistics • Second Session</b>											
15702	LIN 100	2	1	Introduction to Language	3	LEC	J Bailard	MW	9:00 - 12:30PM	HFA A227	\$246
<b>Marriage and Family Counseling • First Session</b>											
11550	MFC 580	1	1	Cross-Cul Fam Val & Beh	3	LEC	H Charnofsky	TTH	6:30 - 10:00PM	SBS E122	\$246
<b>Mathematics • First Session</b>											
13764	MAT 005	1	1	Elem Algebra & Geometry	3	LEC	Staff	TTH	6:30 - 10:00PM	SBS F225	\$246
12040	MAT 101	1	1	Algebra	3	LEC	Staff	MW	9:00 - 12:30PM	SBS F225	\$246
12084	MAT 151	1	1	Pre-Calculus Mathematics	3	LEC	Staff	MW	6:30 - 10:00PM	SBS B215	\$246
12106	MAT 171	1	1	Calc for Mgt Life Sci I	4	LEC	Staff	MTWTH	9:00 - 11:30AM	SBS D121	\$328
15562	MAT 191	1	1	Calculus I	4	LEC	Staff	MTWTH	9:00 - 11:30AM	SBS D125	\$328
13775	MAT 261	1	1	Discrete Mathematics I	3	LEC	Staff	MTTH	9:00 - 11:20AM	SBS E122	\$246

Mathematics courses continue on pg. 22.

Sched. Number	Dept. & Course Number	Sess. Sec.	Title	Units	Course		Days	Hours	Bldg/Room	Fees
					Type	Instructor				
<b>Mathematics • Second Session</b>										
13720	MAT 003	2 1	Beginning Algebra Summer Bridge Students Only	3	LEC	Staff	MTWTH	9:00 - 10:50AM	SBS B215	\$ 60
13742	MAT 003	2 2	Beginning Algebra	3	LEC	Staff	TTH	6:30 - 10:00PM	SBS B215	\$246
12600	MAT 003	2 3	Beginning Algebra	3	LEC	Staff	MTWTH	11:00 - 12:50PM	SBS B215	\$ 60
13753	MAT 005	2 2	Elem Algebra & Geometry Summer Bridge Students Only	3	LEC	Staff	TTH	6:20 - 9:30PM	SBS D225	\$ 60
15536	MAT 101	2 1	Algebra	3	LEC	Staff	TWTH	9:00 - 11:20AM	SBS B238	\$246
15540	MAT 101	2 2	Algebra	3	LEC	Staff	TTH	6:30 - 10:00PM	SBS B143	\$246
12073	MAT 131	2 1	Elem Stat & Probability	3	LEC	Staff	MW	6:30 - 10:00PM	SBS B238	\$246
12095	MAT 171	2 1	Calc For Mgt Life Sci I	4	LEC	Staff	MTTH	6:00 - 9:15PM	SBS D121	\$328
15573	MAT 191	2 1	Calculus I	4	LEC	Staff	TWTH	6:00 - 9:15PM	SBS D125	\$328
12143	MAT 193	2 1	Calculus II	4	LEC	Staff	MTWTH	9:00 - 11:30AM	SBS B209	\$328
12154	MAT 261	2 1	Discrete Mathematics I	3	LEC	Staff	MW	6:30 - 10:00PM	SBS D225	\$246
<b>Mexican American Studies • Second Session</b>										
10846	MAS 300	2 1	Intro Mexican Amer Stud	3	LEC	M Dominguez	MW	9:00 - 12:30PM	HFA A227	\$246
<b>Music • First Session</b>										
13576	MUS 109	1 1	Intro to Musicianship	1	ACT	J Hill	MTWTH	3:00 - 4:05PM	HFA A207	\$ 82
10872	MUS 110	1 1	Music Fundamentals	3	LEC	D Bradfield	MTWTH	6:00 - 7:50PM	HFA A204	\$246
13580	MUS 180	1 1	Individual Lessons	1	SUP	Staff	TBA	TBA	TBA	\$ 82
12644	MUS 209	1 1	Musicianship Skills	1	ACT	J Hill	MTWTH	3:00 - 4:05PM	HFA A207	\$ 82
12666	MUS 280	1 1	Individual Lessons	1	SUP	Staff	TBA	TBA	TBA	\$ 82
13602	MUS 294	1 1	Independent Study	1	SUP	Staff	TBA	TBA	TBA	\$ 82
13635	MUS 294	1 2	Independent Study	2	SUP	Staff	TBA	TBA	TBA	\$164
13646	MUS 294	1 3	Independent Study	3	SUP	Staff	TBA	TBA	TBA	\$246
11023	MUS 330	1 1	Audio Recording	3	LEC	J Hill	MTWTH	1:00 - 2:50PM	HFA A202	\$246
13672	MUS 380	1 1	Individual Lessons	1	SUP	Staff	TBA	TBA	TBA	\$ 82
13694	MUS 480	1 1	Individual Lessons	3	SUP	Staff	TBA	TBA	TBA	\$ 82
11093	MUS 486	1 1	20th Century Music	3	LEC	Staff	MTWTH	4:00 - 5:50PM	HFA A204	\$246
15466	MUS 494	1 1	Independent Study	1	SUP	Staff	TBA	TBA	TBA	\$ 82
15470	MUS 494	1 2	Independent Study	2	SUP	Staff	TBA	TBA	TBA	\$164
15481	MUS 494	1 3	Independent Study	3	SUP	Staff	TBA	TBA	TBA	\$246
15411	MUS 496	1 1	Music Internship	1	SUP	D Champion	TBA	TBA	TBA	\$ 82
15433	MUS 496	1 2	Music Internship	3	SUP	D Champion	TBA	TBA	TBA	\$246
<b>Music • Second Session</b>										
13591	MUS 180	2 1	Individual Lessons	1	SUP	Staff	TBA	TBA	TBA	\$ 82
10920	MUS 210	2 1	Music Theory I	3	LEC	J Hill	MTWTH	5:30 - 7:20PM	HFA A202	\$246
12670	MUS 280	2 1	Individual Lessons	1	SUP	Staff	TBA	TBA	TBA	\$ 82
12681	MUS 294	2 1	Independent Study	1	SUP	D Champion	TBA	TBA	TBA	\$ 82
13613	MUS 294	2 2	Independent Study	2	SUP	D Champion	TBA	TBA	TBA	\$164
13624	MUS 294	2 3	Independent Study	3	SUP	D Champion	TBA	TBA	TBA	\$246
11034	MUS 335	2 1	Music Synthesis	3	LEC	Staff	MTWTH	11:00 - 12:50PM	HFA A202	\$246
14766	MUS 380	2 1	Individual Lessons	1	SUP	Staff	TBA	TBA	TBA	\$ 82
11060	MUS 435	2 1	Adv Music Synthesis	3	LEC	D Bradfield	MTWTH	11:00 - 12:50PM	HFA A202	\$246
13683	MUS 480	2 1	Individual Lessons	1	SUP	Staff	TBA	TBA	TBA	\$ 82
15492	MUS 494	2 1	Independent Study	1	SUP	Staff	TBA	TBA	TBA	\$ 82
15503	MUS 494	2 2	Independent Study	2	SUP	Staff	TBA	TBA	TBA	\$164
15514	MUS 494	2 3	Independent Study	3	SUP	Staff	TBA	TBA	TBA	\$246
15444	MUS 496	2 1	Music Internship	1	SUP	D Champion	TBA	TBA	TBA	\$ 82
15455	MUS 496	2 2	Music Internship	3	SUP	D Champion	TBA	TBA	TBA	\$246
<b>Philosophy • First Session</b>										
14921	PHI 120	1 1	Critical Reasoning	3	LEC	D Lewis	MTWTH	11:30 - 1:20PM	ERC D126	\$246
14954	PHI 494	1 1	Independent Study	1	SUP	Staff	TBA	TBA	TBA	\$ 82
14674	PHI 494	1 2	Independent Study	2	SUP	Staff	TBA	TBA	TBA	\$164
14486	PHI 494	1 3	Independent Study	3	SUP	Staff	TBA	TBA	TBA	\$246
<b>Philosophy • Second Session</b>										
12736	PHI 102	2 1	Humanity, Nature & God	3	LEC	W Hagan	TTH	9:00 - 12:30PM	HFA A221	\$246
14910	PHI 120	2 1	Critical Reasoning	3	LEC	R Vanterpool	MTWTH	11:30 - 1:20PM	ERC D131	\$246
15013	PHI 494	2 1	Independent Study	1	SUP	Staff	TBA	TBA	TBA	\$ 82
14685	PHI 494	2 2	Independent Study	2	SUP	Staff	TBA	TBA	TBA	\$164
14512	PHI 494	2 3	Independent Study	3	SUP	Staff	TBA	TBA	TBA	\$246
15584	PHI 495	2 1	Special Topics: Religion & Philosophy	3	LEC	W Hagan	TTH	6:00 - 9:30PM	HFA A228	\$246
<b>Physical Education • First Session</b>										
10312	PED 218	1 1	First Aid and CPR	3	LEC	D Berney	MTWTH	1:30 - 3:50PM	HFA A227	\$246
10323	PED 218	1 2	First Aid and CPR	3	LEC	J Ragonesi	MW	6:00 - 9:30PM	HFA A227	\$246
12692	PED 494	1 1	PE Independent Study	1	SUP	J Poole	TBA	TBA	TBA	\$ 82
14965	PED 494	1 2	PE Independent Study	3	SUP	J Poole	TBA	TBA	TBA	\$246
12714	PED 594	1 1	PE Independent Study	3	SUP	J Poole	TBA	TBA	TBA	\$246



Sched. Number	Dept. & Course Number	Sess. Sec	Title	Units	Course Type	Instructor	Days	Hours	Bldg/Room	Fees
<b>Physical Education • Second Session</b>										
10301	PED 218	2 1	First Aid and CPR	3	LEC	D Berney	MTWTH	9:00 - 10:50AM	HFA A223	\$246
12703	PED 494	2 1	PE Independent Study	1	SUP	J Poole	TBA	TBA		\$ 82
14976	PED 494	2 2	PE Independent Study	3	SUP	Staff	TBA	TBA		\$246
12725	PED 594	2 1	PE Independent Study	3	SUP	J Poole	TBA	TBA		\$246
<b>Physics • First Session</b>										
12176	PHY 100	1 1	Patterns in Nature	3	LEC	T Will	TTH	5:30 - 9:00PM	NSM C213	\$246
14582	PHY 108	1 1	Physical Science II	3	LEC	T Will	TWTH	1:15 - 2:45PM	NSM B242	\$302
14593	PHY 108	1 1L	Physical Science II Lab		ACT	T Will	TWTH	2:50 - 4:55PM	NSM B242	
<b>Physics • Second and Off-Cycle Session</b>										
12191	PHY 120	6 1	Elements of Physics I 6/15 - 7/16	4	LEC	Staff	MTWTH	9:00 - 11:00AM	NSM C235	\$460
13801	PHY 120	6 1L	Elements of Physics 1 Lab 6/15 - 7/16		ACT	Staff	MTWTH	11:10 - 1:10PM	NSM B242	
12213	PHY 122	6 1	Elements of Physics II 7/20 - 8/20	4	LEC	Staff	MTWTH	9:00 - 11:00AM	NSM C235	\$460
13834	PHY 122	6 1L	Elements of Physics II Lab 7/20 - 8/20		ACT	Staff	MTWTH	11:10 - 1:10PM	NSM B242	
12235	PHY 132	6 1	General Physics II 6/16 - 8/20	5	LEC	Staff	TTH	5:30 - 8:00PM	NSM C235	\$486
12246	PHY 132	6 1L	General Physics II Lab 6/14 - 8/20		ACT	Staff	W	5:30 - 9:20PM	NSM B243	
14722	PHY 402	2 1	Workshop Phy.Sci for Teach.	3	LEC	H Lee	MW	1:30 - 4:30PM	NSM C235	\$246
<b>Political Science • First Session</b>										
14755	POL 101	1 1	American Institutions	3	LEC	A Fisher	TTH	9:00 - 12:30PM	SBS A144	\$246
11594	POL 328	1 1	Cult Pluralism in Amer Pol	3	LEC	Staff	TTH	6:30 - 10:00PM	SBS B203	\$246
12832	POL 494	1 1	Independent Study	2	SUP	Staff	TBA	TBA		\$164
12843	POL 494	1 2	Independent Study	3	SUP	Staff	TBA	TBA		\$246
<b>Political Science • Second Session</b>										
11561	POL 101	2 1	American Institutions	3	LEC	A Fisher	MW	6:30 - 10:00PM	SBS A204	\$246
11583	POL 310	2 1	Issues American Govern	3	LEC	A Fisher	MW	9:00 - 12:30PM	SBS A204	\$246
12854	POL 494	2 1	Independent Study	2	SUP	Staff	TBA	TBA		\$164
12865	POL 494	2 2	Independent Study	3	SUP	Staff	TBA	TBA		\$246
<b>Psychology • First Session</b>										
12935	PSY 494	1 1	Independent Study	2	SUP	Staff	TBA	TBA		\$164
12880	PSY 494	1 2	Independent Study	3	SUP	Staff	TBA	TBA		\$246
15105	PSY 498	1 1	Directed Research	2	SUP	Staff	TBA	TBA		\$164
12924	PSY 498	1 2	Directed Research	3	SUP	Staff	TBA	TBA		\$246
<b>Psychology • Second Session</b>										
11605	PSY 350	2 1	Developmental Psychology	3	LEC	B Kin	MW	8:00 - 11:30AM	SBS D225	\$246
11616	PSY 363	2 1	The Abnormal Personality	3	LEC	A Bohart	TTH	6:00 - 9:30PM	SBS A144	\$246
12891	PSY 494	2 1	Independent Study	2	SUP	Staff	TBA	TBA		\$164
12902	PSY 494	2 2	Independent Study	3	SUP	Staff	TBA	TBA		\$246
12946	PSY 498	2 1	Directed Research	2	SUP	Staff	TBA	TBA		\$164
12950	PSY 498	2 2	Directed Research	3	SUP	Staff	TBA	TBA		\$246
<b>Public Administration • First Session</b>										
11351	PUB 375	1 1	Essentials of Risk Mgmt	3	LEC	A Liberman	MW	6:00 - 9:30PM	SBS F225	\$246
<b>Public Administration • Off-Cycle Session</b>										
11362	PUB 510	6 1	Sem: Public Financial Mgt 6/3 - 7/27	4	LEC	J Smith	MW	6:00 - 9:30PM	SBS F125	\$328
<b>Science, Mathematics and Technology • First Session</b>										
12272	SMT 310	1 1	Science and Technology	3	LEC	E Garcia	MW	1:30 - 5:00PM	NSM C239	\$246
12294	SMT 312	1 1	Natural Processes	3	LEC	M Reiter	MWF	9:00 - 11:20AM	NSM B213	\$246
12762	SMT 314	1 1	Introduction to Cosmology	3	LEC	H K Lee	MW	5:30 - 9:00PM	NSM C239	\$246
<b>Science, Mathematics and Technology • Second Session</b>										
13786	SMT 100	2 1	Basic Wordprocessing Summer Bridge Students Only	1	LEC	Staff	F	9:00 - 11:30AM	ERC A315	\$ 20
12283	SMT 310	2 1	Science and Technology	3	LEC	E Garcia	TTH	1:30 - 5:00PM	NSM C239	\$246

■ Session dates: First, June 3 - July 14; Second, June 22 - July 31 ■

# University Extension Summer Courses

Sched. Number	Dept. & Course Number	Section & Session	Course Title	Units	Course Type	Instructor	Days	Hours	Bldg/Room	Fees
<b>Sociology • First Session</b>										
11653	SOC 395	1 1	Special Topics: Media and Society	3	LEC	W McCoy	TWTH	9:00 - 11:20AM	SBS E126	\$246
11631	SOC 395	1 2	Special Topics: Immigrants & Ethnic Grps	3	LEC	L Ragonesi	MW	6:00 - 9:30PM	SBS B203	\$246
15035	SOC 395	1 3	Special Topics: Coun. & Changing Am Fam 6/3 - 7/9	3	LEC	D Bryan	WTH	6:00 - 9:45PM	SBS E305	\$246
12961	SOC 494	1 1	Independent Study	1	SUP	Staff	TBA	TBA		\$ 82
12972	SOC 494	1 2	Independent Study	3	SUP	Staff	TBA	TBA		\$246
11664	SOC 550	1 1	Sem Interaction Processes	3	SEM	H Charnofsky	TTH	2:30 - 6:00PM	SBS F121	\$246
12983	SOC 597	1 1	Directed Reading	1	SUP	Staff	TBA	TBA		\$ 82
12994	SOC 597	1 2	Directed Reading	3	SUP	Staff	TBA	TBA		\$246
13005	SOC 598	1 1	Directed Research	1	SUP	Staff	TBA	TBA		\$ 82
13020	SOC 598	1 2	Directed Research	3	SUP	Staff	TBA	TBA		\$246
13031	SOC 599	1 1	Grad Capstone	1	SUP	Staff	TBA	TBA		\$ 82
13042	SOC 599	1 2	Grad Capstone	2	SUP	Staff	TBA	TBA		\$164
13075	SOC 599	1 3	Grad Capstone	3	SUP	Staff	TBA	TBA		\$246
13101	SOC 599	1 4	Grad Capstone	4	SUP	Staff	TBA	TBA		\$328
13090	SOC 599	1 5	Grad Capstone	5	SUP	Staff	TBA	TBA		\$410
<b>Sociology • Second Session</b>										
11620	SOC 334	2 1	Women in Society	3	LEC	H Lueker	MW	6:00 - 9:30PM	SBS F121	\$246
11642	SOC 395	2 1	Special Topics: Sexual Roles & Society	3	LEC	D Robertson	TTH	6:00 - 9:30PM	SBS B110	\$246
13112	SOC 494	2 1	Independent Study	1	SUP	Staff	TBA	TBA		\$ 82
13123	SOC 494	2 2	Independent Study	3	SUP	Staff	TBA	TBA		\$246
13134	SOC 597	2 1	Directed Reading	1	SUP	Staff	TBA	TBA		\$ 82
13145	SOC 597	2 2	Directed Reading	3	SUP	Staff	TBA	TBA		\$246
13156	SOC 598	2 1	Directed Research	1	SUP	Staff	TBA	TBA		\$ 82
13160	SOC 598	2 2	Directed Research	3	SUP	Staff	TBA	TBA		\$246
13171	SOC 599	2 1	Grad Capstone	1	SUP	Staff	TBA	TBA		\$ 82
13182	SOC 599	2 2	Grad Capstone	2	SUP	Staff	TBA	TBA		\$164
13193	SOC 599	2 3	Grad Capstone	3	SUP	Staff	TBA	TBA		\$246
13215	SOC 599	2 4	Grad Capstone	4	SUP	Staff	TBA	TBA		\$328
13204	SOC 599	2 5	Grad Capstone	5	SUP	Staff	TBA	TBA		\$410
<b>Spanish • Second Session</b>										
15676	SPA 151	2 1	Intro to Hispanic Culture Summer Bridge Students Only 6/22 - 7/31	3	LEC	P Sanchez	MTWTH	1:30 - 3:20PM	ERC D126	\$246
11141	SPA 341	2 1	Advanced Conversation 6/22 - 7/17	3	LEC	F Lauerhass	MWF	9:00 - 12:15PM	HFA A225	\$246
<b>Theatre Arts • First Session</b>										
13370	THE 120	1 1	Fundamentals of Speech	2	LEC	P Rodney	MTWTH	12:30 - 1:40PM	UT A102	\$164
<b>Theatre Arts • Second Session</b>										
14980	THE 120	2 1	Fundamentals of Speech Summer Bridge Students Only	2	LEC	P Rodney	MTWTH	11:00 - 12:10PM	UT A102	\$ 40
14991	THE 120	2 2	Fundamentals of Speech Summer Bridge Students Only	2	LEC	P Rodney	MTWTH	2:00 - 3:10PM	UT A102	\$ 40
15002	THE 120	2 3	Fundamentals of Speech Summer Bridge Students Only	2	LEC	C Walker	MTWTH	6:00 - 8:30PM	UT A102	\$ 40

## University Extension Summer Courses

### SCIENCE TECHNOLOGY ENRICHMENT PROGRAM (STEP)

Session I: June 29-July 9  
Session II: July 20-30

For students entering 7th, 8th, or 9th grades in Fall 1987

The STEP project is designed to reinforce and enrich students' understanding of science and mathematics through creative and innovative courses led by local junior and senior high school faculty.

Students enroll in two classes per session. Classes meet Monday through Thursday. The program is divided into two sessions: June 29 to July 9 and July 20 to July 30. The course fee is

\$80 for one two-week session (two classes), \$150 for both two-week sessions (four classes). All classes meet in the Natural Sciences and Mathematics Building on the CSUDH campus.

The Courses:

- BACKYARD SCIENCE
- DRIVING THE OUTSIDE WORLD WITH AN APPLE
- ESCAPS: ENRICHED STUDIES IN COMPUTER-BASED PROBLEM SOLVING
- MARINE BIOLOGY
- NEIGHBORS: MICROBES ALL AROUND US
- THE SCIENCE OF PHOTOGRAPHY
- USE A COMPUTER TO MAKE REPORTS — CORRECTLY

And more . . . for a complete brochure and application, phone 213/516-3741.

## CONSERVATORY OF MUSIC, DANCE AND DRAMA

The Conservatory offers children, teens and adults the opportunity to explore artistic experiences. Classes are limited to ensure ample personal attention by faculty.

### ORFF SCHULWERK

Prepares children for later musical instruction by developing hand and body coordination, sense of pitch, and beginning note reading.

To register, use Sequence Number 10-041-0, plus the course number listed below.

- 3-5 yrs., course no. 535. 11:15 a.m.-noon.
- 6-10 yrs., course no. 536. noon-12:45 p.m.

► Saturdays, May 30-August 8. 10 meetings, (no class July 4). CSUDH campus, HFA A204. \$55.

**BALLET**

Improves grace, flexibility, posture, and self-image while providing a solid grounding in classical ballet technique.

To register, use Sequence Number 10-081-0, plus course number listed below.

- 3-5 yrs., course number 522, 10-10:45 a.m.
- 6-8 yrs., course number 521, 9-9:45 a.m.
- 9-12 yrs., course number 523, 11-11:45 a.m.
- Teens and adults, beginning/grade I, course number 524, 12:30-1:15 p.m.
- Teens and adults, grade II, course number 525, 1:30-2:15 p.m.
- Advanced, course number 526, 2:30-3:15 p.m.

► **Saturdays, May 30-August 8.** 10 meetings, (no class July 4). CSUDH campus, University Theatre rehearsal hall. \$55.

**PRIVATE MUSIC LESSONS**

Lessons begin the week of May 25. Students will perform in a music recital on August 9. Call the Department of Music at 213/516-3543 to arrange a lesson time with an instructor.

To register, use Sequence Number 10-041-0, plus the course number listed below.

Course Numbers:

- 501 Piano
- 502 Violin, Viola
- 503 Cello
- 504 String Bass
- 505 Flute
- 506 Oboe
- 507 Clarinet
- 508 Saxophone
- 509 Trumpet
- 510 Trombone
- 511 French Horn
- 512 Tuba
- 513 Drums and Percussion
- 514 Guitar
- 515 Electric Bass
- 516 Voice
- 517 Recorder

► **Week of May 25-week of August 8.** Holiday, week of June 29-July 4. Time TBA. (10) 30 minute lessons.) \$100.

**CREATIVE DRAMA AND ACTING**

Basic techniques of creative drama, speech and movement skills taught through the use of theater games and other activities.

To register, use Sequence Number 10-071-0, plus the course number, listed below.

- 6-9 yrs., course no. 540, 11-11:45 a.m.
- 10-12 yrs., course no. 541, noon-12:45 p.m.
- Teens and returning students, course no. 542, 1-1:45 p.m.

► **Saturdays, May 30-August 8.** 10 meetings, (no class July 4). CSUDH campus, HFA A202. \$55.

**BEGINNING RHYTHMIC GYMNASTICS FOR GIRLS 5-10 YEARS**

This after-school program will introduce girls to the fun and skills of rhythmic gymnastics. The sessions will help girls develop strength, flexibility, balance and grace. Techniques for ballet, modern, and jazz dance will be covered as students learn to work with balls, ropes, hoops, clubs and ribbons.

SANDI SHANNON CONLEY, Coach, West Coast Waves Rhythmic Gymnastics Team; member of the National Rhythmic Gymnastics Team four times.

NOTE: Registration fees must be paid on or before first class meeting.

**FOR GIRLS AGES 5-7**

► **Monday, June 29-July 27. 1-2 p.m.** 5 meetings. Redondo Beach Community Center, rm. 7. \$30. Non-credit. Seq. No. 08-350-0570-01.

**FOR GIRLS AGES 7-10**

► **Monday, June 29-July 27. 2-3 p.m.** 5 meetings. Redondo Beach Community Center, rm. 7. \$30. Non-credit. Seq. No. 08-350-0570-02.

**ACUPRESSURE FOR HEALTH AND RELAXATION**

Acupressure is similar to the technique of acupuncture but does not use needles. This simple yet effective technique promotes natural healing by stimulating selected pressure points of the body.

The instructor, a Certified Acupuncturist, will discuss the history of acupressure and its place in Western medicine. The latest scientific studies and discoveries also will be presented.

Through lecture and demonstration, participants will learn the therapeutic acupressure points and techniques. Clinical applications of acupressure for health maintenance, minor pain problems, reducing stress and tension, emergency first aid, and insomnia will be discussed.

PEDRO CHAN, Ph.D., is a Certified Acupuncturist and is the Executive Director of the Center for Chinese Medicine. He is author of several texts, including *Finger Acupressure*, which has sold more than one-half million copies in four languages.

► **Tuesdays, June 23-July 14. 7-9 p.m.** 4 meetings. Redondo Beach Community Resource Center, rm. 7. \$60. 1 Continuing Education Unit. Seq. No. 12-011-0902.

**INTRODUCTION TO CALIFORNIA WINES**

Develop an appreciation for the wines of California in an in-depth class on the red and white varietal wines of our state. In this tasting tour of wine, you'll be savoring wines representative of the five general geographical areas of California viticulture.

How and where the grapes are grown will be discussed, as well as the correct process for tasting wine — whether it is a Sherry or a Zinfandel. You will also learn the specialized vocabulary for wine and how to read a wine label.

Please bring three glasses to each meeting; we also recommend that you bring bread or cheese to each class meeting to clear your palate.

JERRY SNYDER is General Manager and wine connoisseur for Bill's Fine Liquors, located in Manhattan Beach.

► **Thursday, July 16-August 13. 7-9:30 p.m.** 5 meetings. Redondo Beach Community Resource Center, rm. 7. \$65, plus \$24 materials fee. Non-credit. Seq. No. 13-011-0506.

**HYPNOSIS: A NATURAL WAY TO SUCCESS**

Discover how to use hypnosis to control pain, lose weight, quit smoking, or release your potential for intellectual and emotional growth. This one-day workshop will provide useful techniques and background on the history, myths, and misconceptions of hypnosis.

Participants will learn principles of induction, eye fixation, and deepening techniques. The dangers of self-hypnosis and the appropriate and inappropriate uses of hypnosis will also be discussed. Participants are encouraged to bring recorders and tape to record this six-hour workshop.

Other topics:

- Exam preparation
- Reducing stress
- How to phrase post-hypnotic suggestions

JOHN H. DAVIS, M.S.W., L.C.S.W., is a Licensed Clinical Hypnotherapist.

► **Saturday, July 18. 9 a.m.-3 p.m.** 1 meeting. Redondo Beach Community Resource Center, rm. 7. \$50. Non-credit. Seq. No. 20-000-0502.

See page 29 for a map to the Redondo Beach Community Resource Center.

## ENTREPRENEURSHIP AND INNOVATION — THE AMERICAN DREAM

This seminar outlines a practical approach to the process of introducing a product to the marketplace. The instructor, an inventor who has successfully marketed several products, will guide participants through each step of the procedure, from developing an idea through evaluation, protection, financing, and marketing.

Many people are mystified by entrepreneurship because of the many hats entrepreneurs must wear. The workshop will address such questions as "How can one person handle all aspects of the business? How do starting entrepreneurs approach the unknown, and how do they solve problems?" The necessary elements for delivering a product to the marketplace will also be discussed.

Extensive question-and-answer and group interactions are encouraged, to address specific problems and solutions. Each participant will receive a 50-page reference manual at no cost.

WILLIAM S. SEIDEL is an industrial designer and entrepreneur who teaches at San Francisco State University. He is an art director/designer for McGraw-Hill and is the creator of the Unball, which is sold throughout the United States. He has invented and marketed products for the fashion industry, pet industry, robotics and electronics industries, furniture, architecture and solar industries.

► **Saturday, June 27. 9 a.m.-4 p.m.** 1 meeting. Redondo Beach Community Resource Center, rm. 8. \$55. Non-credit. Seq. No. 05-091-0561.

## EFFECTIVE TIME MANAGEMENT

If there doesn't seem to be enough hours in the day for you to complete your work, you probably need to examine how well you use those hours. Learn to build a successful system for using time effectively with this comprehensive seminar.

The class will examine time management problems, and help you increase your motivation and goal setting. You'll learn to set priorities, master time-saving strategies, minimize interruptions and maximize your work space. In addition, you'll learn how to increase your personal efficiency and effectiveness by delegating responsibility and using a time log in your daily time management.

Participants will receive a free "Day Timer" personal organizer system.

DAVID I. WAGEMAKER is a Senior Development Management Trainer at Hughes Aircraft.

► **Saturday, July 18. 9 a.m.-4:30 p.m.** 1 meeting. Redondo Beach Community Resource Center, rm. 8. \$60. Non-credit. Seq. No. 05-061-0539.

## THE PROFESSIONAL TOUCH

Whether you are beginning your career, climbing the corporate ladder, or changing careers, you want to be recognized as a professional. Professionals who are achievers know that "dressing for success" is not the only secret to moving ahead. They realize that self-confidence and polish contribute to their self-presentation and help them to stand out and be noticed.

The seminar teaches techniques that will help you to command attention, contribute to your personal power, and help you to make an impact on the people and events that can help or hinder your career. You will learn how to assess your strengths and build them into a positive professional image.

Other topics:

- Achieving credibility
- Appearing authoritative
- Voice projection
- Controlling nervousness and fear
- Correct business behavior

EVE CAPPELLO, Ph.D., is Director of the A.C.T. Institute (Assert Consciously Today), and is a professional behavior consultant.

► **Saturday, June 27. 9:30 a.m.-noon.** 1 meeting. Redondo Beach Community Resource Center, rm. 7. \$35. Non-credit. Seq. No. 06-041-0505.

## STARTING A CONSULTING PRACTICE

Whether you're considering becoming a consultant or are already in the business, this comprehensive class can help you sell your skills most effectively. Discover how to promote yourself by gaining exposure and enhancing your professional reputation. You'll learn how to set up your business on a full- or part-time basis.

Topics include applicable laws, considerations of home-based businesses, costs to expect, protecting your service through contract and letter of agreement, setting a fee, avoiding pitfalls of the trade and what customers seek from consultants. You'll also learn how to ensure success for your business by examining the profession in the 80s and deciding on an image for your consulting business.

JEFFREY D. FIGLER, M.B.A., J.D., teaches for the San Diego State University, College of Business Administration.

► **Thursday, July 9. 6:30-9:30 p.m.** 1 meeting. Redondo Beach Community Resource Center, rm. 7. \$40. Non-credit. Seq. No. 05-996-0546.

## FINDING AND FINANCING REAL ESTATE FORECLOSURES

Today's home foreclosures are at a 50-year high. Statewide there were 170,000 loan defaults in 1982, 61,000 in Los Angeles County alone. These properties can be picked up by knowledgeable investors and quickly resold for cash profits of 100 to 1,500 percent.

David Small, a local attorney, will share his expertise in purchasing these properties with you and outline a clear, step by step method so that you can learn how to pick up houses, condos and any real estate at a fraction of its true value.

Until now, the techniques used to finance multi-million dollar deals such as financing 100 percent of the property, cash to the buyer, and advanced forms of nothing down have been little known outside of large scale properties. These techniques will be applied to houses during the seminar's afternoon session.

Other seminar topics include:

- Finding foreclosures
- Buying for little or nothing down
- Buying without a real estate license
- Getting people in foreclosure to call you
- Taking over low-interest loans
- Selecting the right properties for fast profit
- Saving on taxes
- Protecting yourself under foreclosure laws
- Financing the property 100 percent

Pre-registration recommended.

DAVID SMALL, J.D., is president of Small Time, Inc.

► **Saturday, July 11. 10 a.m.-5 p.m.** 1 meeting. Redondo Beach Community Resource Center, rm. 8. \$80; plus \$15 for optional workbook, payable in class. 0.6 Continuing Education Unit. Seq. No. 05-011-0901.

## HOW TO START, RUN, AND STAY IN BUSINESS

Discover how to form and operate your own business. This one-day seminar provides the necessary information for successfully launching yourself into business. Learn to select the right kind of business, and how to finance, insure, and promote it.

The workshop addresses the questions:

- What's the best kind of business for me?
- How can I raise money for my business?
- What's the best legal form?
- What about recordkeeping and taxes?
- Do I need any licenses or permits?
- How can I get free advertising?

PATRICIA KISHEL, M.B.A., and GREGORY F. KISHEL, M.B.A., co-authors of *How to Start, Run and Stay in Business*.

► **Saturday, June 20. 10 a.m.-4 p.m.** 1 meeting. Redondo Beach Community Resource Center, rm. 7. \$60. Non-credit. Seq. No. 05-996-0561.

## WORKSHOP IN MULTICULTURAL HUMANITIES

Explore the ways in which various cultures utilize art to celebrate holidays and festivals. Learn to use art from around the world to motivate creative lessons in the elementary classroom.

Participate in many hands-on activities including: papier mache masks, tie-dyed fabric, fish kites, tapa cloth designs, painted theatrical dragons, and murals.

PENELOPE GREEVEN, Instructor, CSUDH Center for Quality Education; Art Consultant, Long Beach and Los Angeles Unified School Districts. KEVIN DOHERTY, Art Workshop instructor, Long Beach Unified School District; Art Consultant, Downey Unified School District; private art instructor.

► **Tuesday and Thursday, June 23-July 9. 9 a.m.-3 p.m.** 5 meetings. Redondo Beach Community Resource Center, rm. 7. **\$125; plus \$5 materials fee, paid in class.** 2 semester units Professional Credit (Educ. 851). Seq. No. 08-310-0851.

## FUN WRITING THAT PAYS: GREETING CARDS, FILLERS, AND HUMOR

How often have you thought up a joke, a play on words, some clever lines for a greeting card, or a light inspirational short that others should share?

Why aren't you submitting those for profit? An hour a day or an occasional festively fevered evening or Saturday can earn you a steady income, your works in print, and a delightful vent for your creative fires.

Greeting cards are the most lucrative, per minute, of all forms of writing — and you needn't draw a thing! It's all explained in this seminar — plus more.

More fillers are bought than any other item. About a person, an event, a word or date, an observation or a memory, they can be heart-filling, ego-deflating, ironic, or flat out funny.

The workbook, not sold separately but distributed to every participant free, gives you valuable take-home tools from this four-hour how-to-session. Also free are the in-session laughs.

GORDON BURGETT, M.A., author of *Query Letter/Cover Letter: How They Sell Your Writing*, a Writer's Digest Book Club top choice; and *How to Sell 75% of Your Freelance Writing*, another Writer's Digest Book Club choice.

► **Tuesday, June 30. 6-10 p.m.** 1 meeting. Redondo Beach Community Resource Center, rm. 8. **\$40.** Non-credit. Seq. No. 06-041-511.

## NEWSPAPERS IN THE CLASSROOM:

### A Creative Tool to Enhance Reading, Writing and Critical Thinking Skills

Teachers, your daily newspaper is packed with valuable information which you can use to stimulate learning throughout your curriculum. By using all sections of the newspaper, including the comics and the classified advertisements, K-12 teachers will learn strategies for teaching reading comprehension, creative writing and high-level critical thinking skills.

Teachers will learn to use the newspaper to:

- Motivate students to read more often
- Provide an enjoyable and non-threatening option for remedial readers
- Create fresh lesson plans

Teachers will develop a lesson plan for use in their classroom, and will receive a free classroom set of *The Los Angeles Times*.

PATSY WILLIAMS, M.A., is Director of *The Los Angeles Times* in Education program.

► **Tuesday and Thursday, June 23 and 25. 8:30 a.m.-6 p.m.** 2 meetings. Redondo Beach Community Resource Center, rm. 8. **\$60.** 1 semester unit Professional Credit (Educ. 873). Seq. No. 08-011-0873.

## CHILDREN'S ART AND LANGUAGE EXPRESSION

Investigate the nature of creativity and the stages of development in a child's art expression. Explore teaching techniques, Kindergarten through sixth grades, which encourage originality and positive self-esteem. Activities will include: drawing, painting, printmaking, puppetry, and batik. Poems, stories and illustrations will be assembled in handmade books. Students need to bring the following supplies to class: assortment of marking pens, scissors, glue, and newspaper.

PENELOPE GREEVEN, Instructor, CSUDH Center for Quality Education; Art Consultant, Long Beach and Los Angeles Unified School Districts. KEVIN DOHERTY, Art Workshop instructor, Long Beach Unified School District; Art Consultant, Downey Unified School District; private art instructor.

► **Tuesday and Thursday, July 14-28. 9 a.m.-3 p.m.** 5 meetings. Redondo Beach Community Resource Center, rm. 7. **\$125; plus \$5 materials fee, paid in class.** 2 semester units Professional Credit (Educ. 857). Seq. No. 08-310-0857.

## BEFORE YOU WRITE THAT BOOK

Why write an unsold novel or reams of readerless nonfiction when for four hour's time and \$40 you can learn what success requires before you write that first selling word?

Better yet, by developing a market analysis and an operational plan — the purpose of this seminar — you can greatly reduce your writing time later while increasing your sales potential.

Magic? Hardly. Just plenty of fact-packed, immediately applicable how-to information. The workbook, free to participants, contains guidelines that will help take you from idea inception to manuscript sale in both fiction and nonfiction.

What will you learn?

In fiction, for example:

- How to find publishers and develop a market list
- How to determine a mainstream or category format
- What five elements your novel must contain
- How to create a no-nonsense guide/workbook

In nonfiction:

- How to sell the idea before you write a word
- How to get a contract three chapters later
- Where to find high-probability publishers
- When an article should precede a book

And just as important: when you should self-publish and how, plus pertinent information about agents, taxes, time, and word processors.

GORDON BURGETT, M.A., author of *Query Letter/Cover Letter: How They Sell Your Writing*, a Writer's Digest Book Club top choice; and *How to Sell 75% of Your Freelance Writing*, another Writer's Digest Book Club choice.

► **Thursday, July 16. 6-10 p.m.** 1 meeting. Redondo Beach Community Resource Center, rm. 8. **\$40.** Non-credit. Seq. No. 06-041-0512.

See page 29 for a map to the Redondo Beach Community Resource Center.

# University Extension Summer Courses

## IMPROVING YOUR SPEAKING VOICE

If you want people to listen to you, you must speak clearly and confidently. Whether you speak to large or small groups, how you use your voice will affect how well listeners comprehend your message and how they respond to you as a person. Effective speakers know that conveying a message clearly requires articulation and authoritative projection. In this intensive class you will learn how to use these skills and how to profit from critical listening.

Even if your job doesn't require special speaking abilities, you'll learn how to enhance your speaking voice for conversation and social interaction.

This class is recommended for:

- Anyone with special speaking demands such as briefings, conferences, class instruction, and supervisory responsibilities
- Professionals who wish to strengthen their voice skills for business or social life
- Those who find it generally difficult to "speak up"

CLARE E. SHAW is a speech and voice consultant with experience in speech therapy, voice science and communication techniques.

► **Wednesday, June 24-July 8. 6:30-9:30 p.m.** 3 meetings. Redondo Beach Community Resource Center, rm. 7. **\$60**; plus optional textbook, payable in class. 1 Continuing Education Unit. **Seq. No. 15-061-0900.**

## REGISTRATION FOR UNIVERSITY EXTENSION

### By Mail

Complete the registration form below and mail it to the Division of Extended Education with a check or money order (made payable to CSUDH Extension), or credit card authorization.

### By Phone

You may register by phone with your Visa or MasterCard by calling 213/516-3741, 8 a.m. to 5 p.m., Monday through Friday.

### Class Location

Unless otherwise noted, Summer '87 Extension classes will meet at the Redondo Beach Community Resource Center, which is located at 320 Knob Hill Avenue in Redondo Beach. For a map, see page 29.

## UNIVERSITY EXTENSION REFUND POLICY

To receive a refund of fees for a non-credit class, or a class offering Continuing Education or Professional Units, you must notify the Division of Extended Education between the hours of 8 a.m. and 5 p.m. at least 48 hours before the course begins. You will be asked to send a written request for a refund of fees to our office.

No refund will be approved if the student notifies our office on or after the day of the first class meeting.

## CREDIT FOR UNIVERSITY EXTENSION CLASSES

### Professional Credit

Professional credit is designed for professionals who benefit from credit for salary or step advancement. Courses numbered 800-899 offer professional credit in education; credit is not degree-applicable.

### Continuing Education Units (CEU)

One CEU equals ten hours of participation in lecture. Course numbering is 900-999.

## California State University, Dominguez Hills • Extension Registration

Course Title										Sequence Number											
Course Title										Sequence Number											
Student I.D. Number (if known)										Social Security No.											
First Name										M.I.		Last Name									
Address																					
City										State					Zip						
Phone / Area Code / Day					Ext.		Night			Home County					Male/Female						
Job Title																					
Employer's Name and Address																					

Total enclosed \$ \_\_\_\_\_  
 Check enclosed (payable to CSUDH Extension)

I wish to use:

VISA       MasterCard

Card Number \_\_\_\_\_ Exp. Date \_\_\_\_\_

Cardholder's Signature \_\_\_\_\_

Cardholder's Name (print clearly) \_\_\_\_\_

**Mail to:** Division of Extended Education, CSUDH, ERC C508, Carson, California 90747

For information concerning special services to accommodate a physical, perceptual or learning disability, please contact Disabled Student Services Office on campus (Phone 213/516-3660)

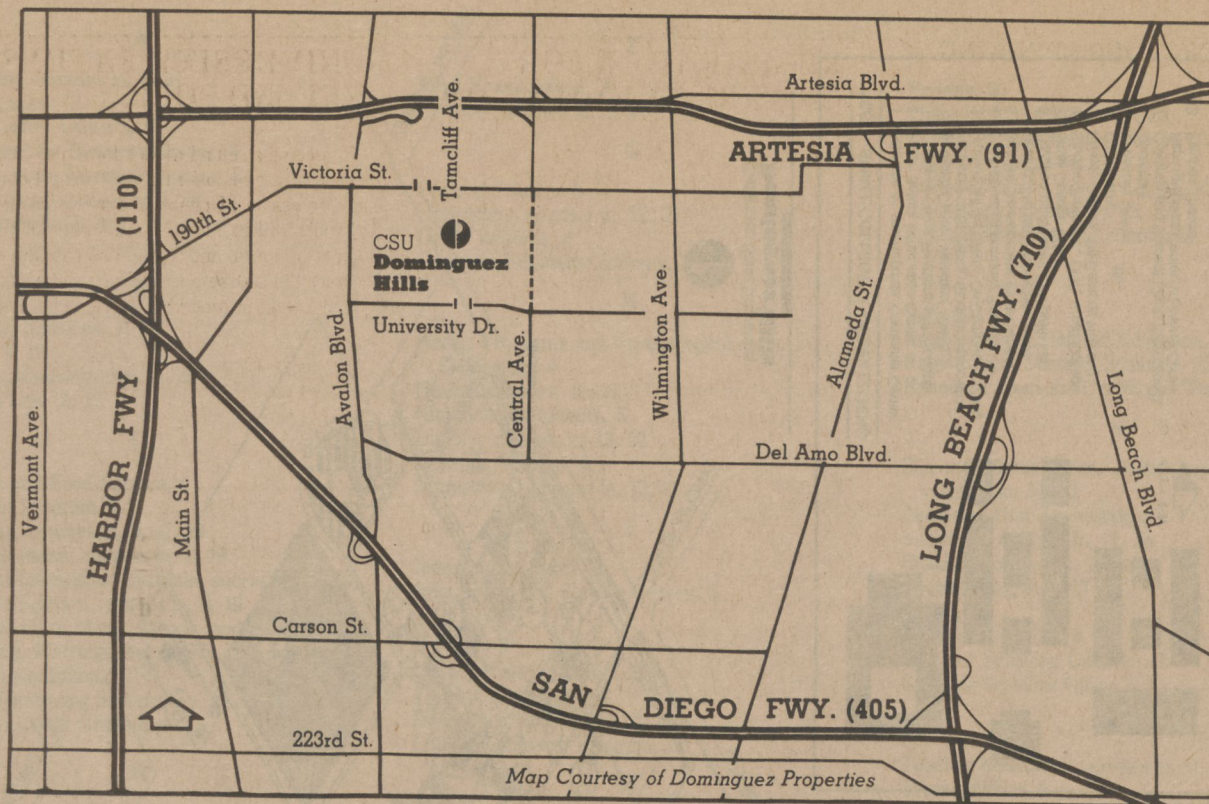

Map Courtesy of Dominguez Properties

Freeway access to California State University, Dominguez Hills.

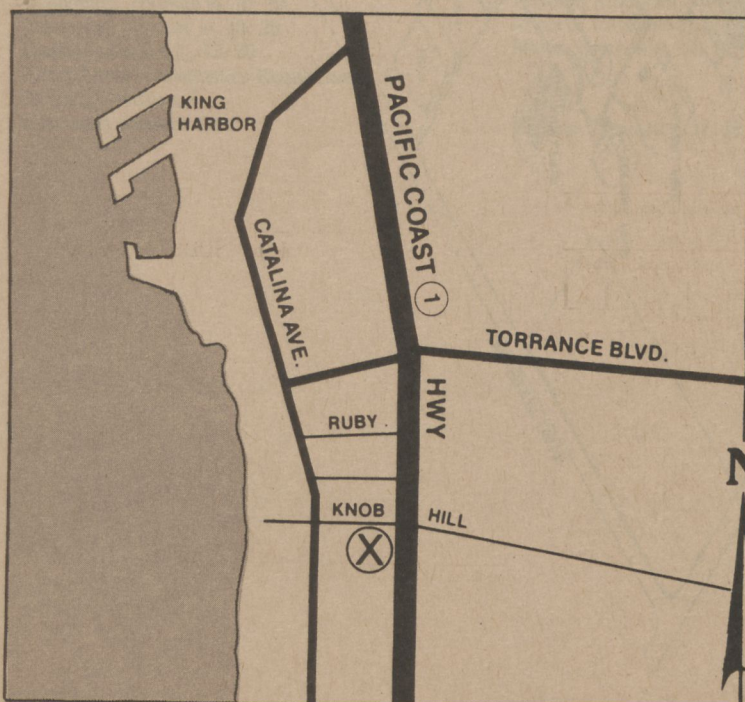

### Redondo Beach Community Resource Center

*formerly Patterson School*

320 Knob Hill (at Pacific Coast Highway)  
Redondo Beach, CA

**FROM SAN DIEGO FREEWAY (405)**

Exit at Crenshaw Blvd., head south on Crenshaw to Torrance Blvd. (about 2 miles) and turn right. Head west to Pacific Coast Highway (about 3 miles) and turn left. Turn right on to Knob Hill Ave. Center is on left.

**FROM HARBOR FREEWAY (110)**

Exit at Torrance Blvd., head west to Pacific Coast Highway (about 7 miles) and turn left. Head south to Knob Hill Ave., turn right. Center is on left.

**FROM PALOS VERDES**

Travel west on Pacific Coast Highway past Riviera Village to Knob Hill Ave. (about 4 miles from Crenshaw Blvd.), turn left. The Center is on the left.

**FROM EL SEGUNDO**

Head south on Sepulveda Blvd., which becomes Pacific Coast Highway, to Knob Hill (about 7 miles from El Segundo) and turn right. Center is on left.

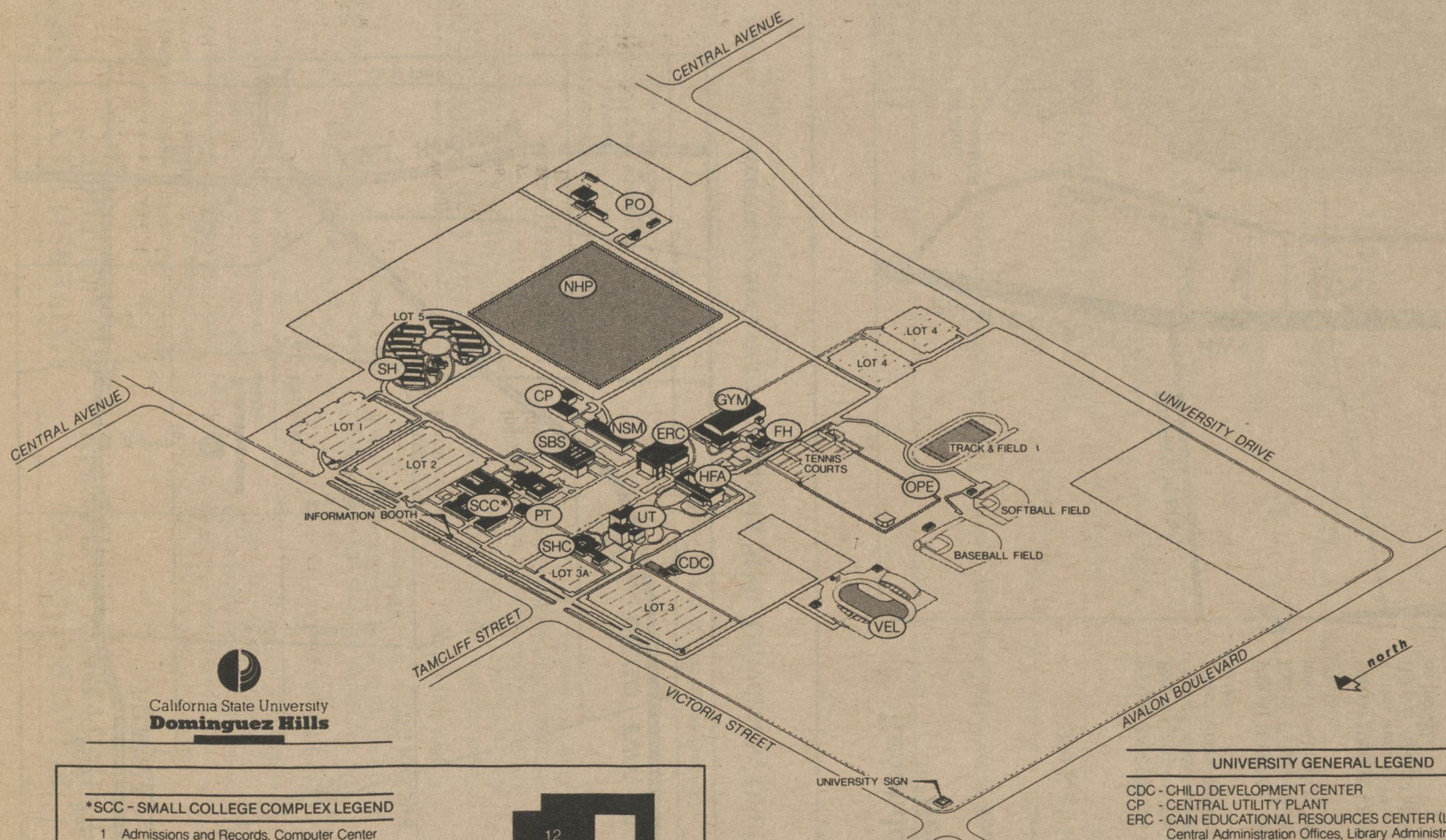

**\*SCC - SMALL COLLEGE COMPLEX LEGEND**

- 1 Admissions and Records, Computer Center
- 2 Public Safety, Information Center, Cashier's Office, Relations with Schools, Advising Center, Veterans' Affairs, International Students, Student Association
- 3 Student Affairs Office, On-Campus Housing
- 4 Educational Opportunity Program
- 5 Student Development, Financial Aid, Testing, Student Affirmative Action
- 6 Classrooms, Student Computer Lab
- 7 Small College Office
- 8 Student Programs, EPIC, Small College Faculty Offices, Off-Campus Housing
- 9 Classrooms
- 10 University Center
- 11 Bookstore
- 12 Cafeteria and Student Union (Commons), Reprographics Center, Women's Center
- 13 Playbox Theatre

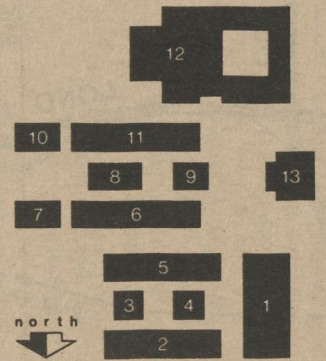

KELLYGRAPHICS '88

**UNIVERSITY GENERAL LEGEND**

- CDC - CHILD DEVELOPMENT CENTER
- CP - CENTRAL UTILITY PLANT
- ERC - CAIN EDUCATIONAL RESOURCES CENTER (LIBRARY)  
Central Administration Offices, Library Administration Offices  
Instructional Media, Learning Assistance Center,  
Television Studio, Student Newspaper Offices
- FH - FIELD HOUSE
- GYM - GYMNASIUM
- HFA - HUMANITIES AND FINE ARTS
- HFA - SCHOOL OF EDUCATION
- NHP - NATURAL HISTORY PRESERVE
- NSM - NATURAL SCIENCES AND MATHEMATICS  
(Science, Mathematics and Technology)
- OPE - OUTDOOR PHYSICAL EDUCATION
- PO - PLANT OPERATIONS  
Warehouse and Receiving
- PT - PLAYBOX THEATRE
- SBS - SOCIAL AND BEHAVIORAL SCIENCES  
SCHOOL OF MANAGEMENT  
Shinwa Japanese Garden
- SCC - SMALL COLLEGE COMPLEX (See legend at left)
- SH - STUDENT HOUSING (Pueblo Dominguez)
- SHC - STUDENT HEALTH CENTER  
Disabled Students Center
- UT - UNIVERSITY THEATRE
- VEL - VELODROME



- A**
- Accounting, courses in, 8, 18
  - Adding classes, 2
  - Administrative Officers, 6
  - Advisement for Business classes, 4
  - Advisement for Summer Courses, 5
  - Anthropology, courses in, 7, 18
  - Art, courses in, 7, 18
  - Audit, 4
- B**
- Behavioral Sciences, 7, 18
  - Biology, 7, 18
  - Business Administration, 8, 18
  - Business Law, 8, 19
- C**
- Cafeteria and Food Service, 6
  - Change of Program, 2
  - Chemistry, courses in, 9, 17, 19
  - Communications, courses in, 9, 19
  - Computer Information Systems, courses in, 8, 18
  - Computer Science, courses in, 9, 19
  - Conservatory of Music, Dance, and Drama, 25
  - Counseling, Marriage and Family, courses in, 13
  - Course Cancellation, 3, 18
  - Course Numbering System, 4
  - Credit/No Credit Grading, 4
- D**
- Dance, courses in, 9, 19
  - Disabled Student Services, 5
  - Dropping classes, 2
- E**
- Earth Sciences, courses in, 10, 19
  - Economics, courses in, 10, 19
  - Education, courses in, 10, 20
  - English, courses in, 12, 20
  - Entry Level Mathematics Requirement, 5
  - Evening Services, 6
  - Extension courses, 24
- F**
- Final Examinations, 4
  - Finance, courses in, 8, 19
- G**
- General Studies, 5
  - Geography, courses in, 12, 21
  - Grade Reports, 4
  - Graduate Education courses, 10, 20
- H**
- Health Programs and Psychological Counseling, 6
  - Health Sciences, 12, 21
  - High School Students, 5
  - History, courses in, 13, 21
  - Housing, Student, 5
  - Humanities, courses in, 13, 21
- I**
- Independent Study, 4
  - Information and Service Center, 6
- L**
- Library, courses in, 13, 21
  - Library, University, 6
  - Linguistics, courses in, 13, 21
  - London Semester Program, 17
- M**
- Management, courses in, 8, 19
  - Management, School of, 8
  - Maps, 29
  - Marketing, courses in, 8, 19
  - Mathematics, courses in, 13, 21
  - Maximum Student Unit Load, 4
  - Mexican American Studies, courses in, 14, 22
  - Mexico, travel study program, 17
  - Music, courses in, 14, 22
- O**
- Organic Chemistry, 17, 19
- P**
- Parking, 3
  - Philosophy, courses in, 15, 22
  - Physical Education, courses in, 15, 23
  - Physics, courses in, 15, 23
  - Political Science, courses in, 15, 23
  - Psychology, courses in, 15, 23
  - Public Administration, courses in, 16, 23
- R**
- Refunds, 3
  - Registration, Extended Education, 28
  - Registration, Summer Sessions, 2, 32
  - Resource Specialist Certificate Workshops, 17
- S**
- Science, Mathematics, Technology, courses in, 16, 23
  - Semester Unit Equivalency, 4
  - Sociology, courses in, 16, 24
  - Spanish, courses in, 16, 24
  - Special Programs, 17
  - STEP, 24
  - Student Activities, 6
  - Summer Sessions Calendar, 2
  - Summer Sessions Office, 5
- T**
- Teacher Education, courses in, 11, 20
  - Testing Office, 6
  - Theatre Arts, courses in, 16, 24
  - Tuition and Fees, 3
- U**
- University Bookstore, 6
  - University Extension Courses, 24
- V**
- Veterans' Services, 6
- W**
- Withdrawal, 2

# Registration Form Instructions

Print in block capitals, use ink.

Complete sections one through four.

**Section 1:** Provide all information requested. Give your full name, complete address, and a phone number at which you can be reached, including area code. Your Social Security number is requested for the purpose of accurate record keeping. CSUDH students: Please list your school, student identification number, and any other names you may have on file at CSUDH.

**Section 2:** Refer to schedule in this Bulletin for course information. Indicate schedule number (5-digit number), department name, course number, section number, number of units, course fee. Refer to example below.

**Section 3:** Calculate the total fees by adding total tuition plus \$13.00 in student fees. Please send check, money order, or credit card authorization; do not send cash.

**Section 4:** Sign and date the form.

Enclose stamped, self-addressed envelope if you wish your receipt/ID mailed to you.

**② COURSE INFORMATION:**

FIRST SESSION JUNE 13 - JULY 14 OR OFF-CYCLE (NON-STANDARD DATES) COURSES

SCHEDULE NO.	DEPARTMENT	COURSE	SECTION	UNITS	COURSE FEE	INSTRUCTOR/DEPT. CONSENT
13716	LIB	150	1	2	\$ 164.00	
13705	LIB	150	1L			

FIRST SESSION TUITION \$ 164.00

SECOND SESSION JUNE 22 - JULY 31

SCHEDULE NO.	DEPARTMENT	COURSE	SECTION	UNITS	COURSE FEE	INSTRUCTOR/DEPT. CONSENT
14722	PHY	402	1	3	\$ 246.00	

SECOND SESSION TUITION \$ 246.00

TOTAL TUITION \$ 410.00

STUDENT ACTIVITY FEE \$ 3.00

STUDENT CENTER FEE \$ 10.00

TOTAL FEES SUBMITTED \$ 423.00

**③ FEE PAYMENT**

STUDENT CENTER AND  
STUDENT ACTIVITY FEE PAID  
ONCE ONLY.

- Payment in full is required for all courses you list on the registration form.
- Please enclose a stamped, self-addressed envelope if you wish your receipt/summer ID to be mailed to you.
- Mail or deliver registration form and payment to *Summer Sessions Office, ERC C508, CSUDH, Carson, California 90747 (213/516-3746)*.

Registration forms and fees must be received by 4 p.m. May 20 for Advanced Registration in First Session courses, and 4 p.m. June 10 for Second Session courses.

• YOU ARE RESPONSIBLE FOR KNOWING THE REGULATIONS AND POLICIES, INCLUDING PREREQUISITES AND SPECIAL CONDITIONS FOR ENROLLMENT, LISTED IN THIS BULLETIN. SEE PAGES 2 - 3 FOR REGISTRATION AND REFUND PROCEDURES.





California State University  
**Dominguez Hills**

**OFFICE OF SUMMER SESSIONS**  
1000 East Victoria Street • ERC C508  
Carson, CA 90747

ESTABLISHED 1987

REGISTRATION INFORMATION

