



ummer '96 sessions

1 Monday, June 3 – Friday, July 12

2 Monday, June 24 – Friday, August 2

Registration
begins

April 1

Call

(310) 516-3741

for more
information



California State University
Dominguez Hills

Division of Extended Education

Summer Sessions 1996

Dates to remember

	May	June	July	August
Intensives				
First Session	June 3		July 12	
Second Session		June 24		August 2

Summer Sessions Information:

(310) 516-3741

Fax (310) 516-3971

Summer Sessions Office
California State University
Dominguez Hills
1000 East Victoria Street
Carson, CA 90747
SCC B141

Admissions

(310) 516-3600

(Formal application to the University is not necessary to attend Summer Sessions classes)

Graduate Admissions

(310) 516-3693

Financial Aid

(310) 516-3647

Housing

(310) 516-4228

Parking

(310) 516-3725/3639

Note: The Summer Sessions Bulletin is printed by the Division of Extended Education at no expense to taxpayers. Every effort is made to ensure the accuracy of this Bulletin. However, this Bulletin is subject to change without notice.

Summer Sessions Calendar 1 Registration & Tuition 2

Who May Register
How to register
Late Registration
Tuition & Fees

Add/Drop/Withdrawal 3

Adding a course
Dropping a course
Withdrawal

Refund Policy 4

Refund of Tuition Fee
Refund of Parking Fee
Dropped Course Fee

Academic Information 5-6

Summer Sessions Office
Maximum Student load
General Studies
Advisement for Summer Courses
School of Management
Advisement Center
Course Numbering System
High School Students
Grade Reports/Transcripts
Audit
Credit/No Credit Grading
Independent Study
Final Examinations
Entry Level Mathematics
Requirement

Student Services 7-8

University Bookstore
Disabled Student Services
University Library
Information Center
Testing Office
Cafeteria and Food Service
Health Programs & Psychological
Testing
Parking
Activities Office/Student Union
Student Housing

Summer Extension Programs 11

ESL/American Language & Culture Program 11-13

Schedule of Courses 14

Map 24

QUICK REFERENCE!

Summer Calendar 1

General Information 2

Special Features 9

Schedule of Classes

Intensives 14

First Session 18

Second Session 23

Map 24

Registration Form
Inside Back Cover



Summer Sessions 1996 Calendar



IMPORTANT DATES:	SESSION I	SESSION II
Registration begins	April 1	April 1
Mail-in Registration deadline	May 17	June 7
Courses begin	June 3	June 24
Regular Registration deadline	June 3	June 24
Last day to return books	June 10	July 1
Late Registration (\$25 fee assessed)	June 4 - June 14	June 25 - July 5
Last day to ADD a course	June 14	July 5
Last day to request CREDIT/NO CREDIT option	June 14	July 5
Last day to DROP/WITHDRAW without "W" on record	June 14	July 5
Holiday, campus closed	July 4	July 4
Last Day to Drop/Withdraw	July 5	July 26

NOTE:
INTENSIVE COURSE DATES VARY
Check listings

Who May Register

College students, graduates of high school, or individuals sufficiently knowledgeable to profit from college courses may register for Summer Sessions. High school juniors and seniors, with letters of recommendation, may enroll in lower-division courses (see details on page 6).

If you are a visiting student, it is especially important that you read the section on classification and numbering of courses. Descriptions of the courses are available in the University Catalog found in the University Bookstore.

Registration in CSUDH Summer Sessions courses does not constitute admission to the University as a regular student. If you are interested in admission to the University, inquire or apply at the University Information and Service Center, Small College Complex A-130, (310) 516-3696.

How to Register

Registration in CSUDH Summer Sessions is simple, and in most cases can be completed entirely through a mail-in procedure. Formal application to the University is not necessary, and transcripts are not required.

Some Summer Sessions courses, however, have prerequisites or special qualifications which are noted in the Schedule of Courses. In certain cases, before the request to register can be processed, permission to enroll in a course must be obtained from the instructor or department office, or students may be asked to provide proof of completion of prerequisites.

To attend Summer Sessions classes, registration for courses must be completed, including full payment of fees, by the appropriate deadline dates (refer to Calendar on page i). If you are registering for both Summer Sessions and University Extension courses, please use separate registration forms and write separate checks.

To Register By Mail:

Complete the Summer Sessions Registration Form on the inside back cover of this Bulletin and mail it to:



**CSU Dominguez Hills
Summer Sessions Office
1000 East Victoria
Carson, CA 90747**

Include your check, money order or credit card information; do not send cash. The deadline for Mail-in Registration is May 17, 1996, for the First Session and June 7 for the Second Session (see calendar on page 1).

To Register By Fax:



FAX your complete Summer Sessions Registration Form (inside back cover) and your credit card information to (310) 516-3971.

To Register in Person:

You can register in person at the Summer Sessions Office located on the CSU Dominguez Hills campus, SCC B141. The Summer Sessions Office



accepts checks, money orders, Visa and MasterCard.

Late Registration

(For adding courses to a program, see ADD Instructions.)

The late registration period begins June 4, and concludes June 14 for the First Session. Late registration begins June 25 and concludes July 5 for the Second Session. Completion of late registration is dependent upon availability of seats for each class and is subject to a \$25.00 late registration processing fee.

Non Standard Date or Intensive Courses

In order to register for a course which begins after the first week of either Session, the student must complete the late registration procedure by the second day of this class.

Tuition

Total course fees are listed in the Schedule with the course information. Some courses, such as laboratory or activity courses, have higher costs and may have fees that are higher than the standard instructional fee.

Standard instructional /lecture fee per unit	\$125
Special course fee	as listed

Fees

Student activity (pay once per summer)	\$3.00
Student Union (pay once per summer)	\$10.00
Late registration	\$25.00
Returned check	\$10.00
Transcript	\$4.00 each
Lab fees	\$25.00-75.00

Fees and refunds are subject to change by the Trustees of the California State University. Full payment of all tuition and fees must be made at the time of registration or adding a course. Payment of tuition and fees may be made by check, money order and Visa or MasterCard. Checks and money orders are payable to CALIFORNIA STATE UNIVERSITY, DOMINGUEZ HILLS. Until total fees are paid, registration is not valid.

Summer 1996

Where to Obtain a Money Order

7-Eleven
17920 Avalon (Avalon & Victoria)
Carson
Open 24 hrs., 7 days a week

First Interstate Bank
18005 Avalon (Avalon & Victoria)
Carson
M-F 9am-4pm, Sat 9am-1pm

Postal Annex
603 East University Dr. Suite B
Carson
M-F 8am-6pm, Sat 10am-4pm

Crown Drugs
657 University Dr., Carson
M-Sat 9am-7:45pm
Sun 9am-6:30pm

Nortrica's Market
20226 Avalon Carson
M-Sun 8am-10pm

Parking

All vehicles, including motorcycles, parked on this campus, must have a valid parking decal. Single entry parking permits can be obtained for \$1.50 from a yellow vending machine near the entrance of each general parking lot. Restricted parking areas are enforced at all times. Parking decals are available at the Cashier's Office (SCC B135).

Six-week auto decal	\$21.60
Nine-week	\$32.40
Ten-week	\$36.00
Short term, per week	\$3.60
Two-wheeled vehicle	\$9.00
Single entry machines	\$1.50

Returned Checks

All returned checks, whether for insufficient funds or stop payments, are considered to be enforceable debts, and are subject to a \$10.00 fee. If your check is returned, your registration will not be processed.

Adding Courses

To add a course before the start of the Session, submit your completed Add / Drop Form and the additional tuition to the registrar in the Summer Sessions Office.

To add a course after the start of the Session, you must file a Change of Program form available in the Summer Sessions Office and have it signed by the professor for the class you want to add.

Six-week courses may be added during the first two weeks of the session. Students wishing to add an Intensive of one week or less may only add on the first day of class.

For two to three-week courses they may only add during the first two days, and for four to five-week courses students may only add during the first week of the course.

The deadline for adding courses is June 14 for the First Session and July 5 for the Second Session. Provided that you are enrolled in a Summer Sessions course at the time you choose to add an additional course, you will not be charged a late fee.

Students may exchange one class for another within the same Session without penalty, if the unit and tuition value is the same.

If you will exceed a maximum unit load by adding courses, you must also submit a Petition to Exceed Maximum Units, available in the Summer Sessions Office (refer to policy on Maximum Unit Load).

Dropping / Withdrawing

Non-attendance in class, notifying the instructor, or stopping payment on a check does NOT officially constitute dropping or withdrawing from a course. The Summer Sessions Office must be notified and appropriate form must be filled.

Dropping a Course

If you decide to drop a course, you must file a Change of Program Form with the Summer Sessions Office. (If you are dropping all courses you enrolled in, follow withdrawal procedures.) Refer also to Refund Policies.

Drop, prior to first day of Session.

To drop a six-week course before a Session begins, file a Change of Program form and an Application for Refund of Fees in the Summer Session Office.

Drop, during the first two weeks of the Session.

Summer Sessions students may drop or withdraw from any six-week course prior to and during the first two weeks of a Session without permanent record of enrollment or "W" on transcript, and without the instructor's signature.

Drop, third through fifth weeks of the Session.

During the third and until the final week of the six-week Session, the instructor's and the school dean's or associate dean's signatures for each course are required on the Change of Program form in order to drop. Non-matriculated or Summer-only students need the signatures of the instructor and the Dean of Extended Education.

If a student drops or withdraws after the second week of a six-week Session, a grade of "W" for the course(s) will appear on the student's permanent transcript.

Courses less than 1 week

Prior to the first class meeting a student may withdraw and no grade is assigned: the enrollment does not appear on the student's permanent transcript. An administrative grade of "W" will be assigned if a student withdraws at any time during the course.

One Week Courses

During the first day of the week a student may withdraw and no grade is assigned: the enrollment does not appear on the student's permanent

Summer 1996

transcript. An administrative grade of "W" will be assigned if a student withdraws at any time after the first day of the week.

Two-Week Courses

During the first three days of the first week a student may withdraw and no grade is assigned; the enrollment does not appear on the student's permanent transcript. An administrative grade of "W" will be assigned if a student withdraws at any time after the first three days of the first week.

Three-Week Courses

During the first week a student may withdraw and no grade is assigned; the enrollment does not appear on the student's permanent transcript. Prior to the last two days of the session a student may withdraw with a "W". During the last two days of the session a student may withdraw with a "W" for serious and compelling reasons only.

Four and Five-Week Courses

During the first week a student may withdraw and no grade is assigned; the enrollment does not appear on the student's permanent transcript. Prior to the last four days of the session a student may withdraw with a "W". During the last four days of the session a student may withdraw with a "W" for serious and compelling reasons only.

Complete Withdrawal from Session

To withdraw from all courses, complete and submit a Withdrawal form, and, if you are eligible for a refund, an application for a refund of fees. Withdrawal forms are available in the Summer Sessions Office.

Complete withdrawal, prior to first day of Session. If you find it necessary to drop all courses before a Session begins, you must cancel your registration and you may be eligible to receive a full refund of fees, less a non-refundable processing fee. A completed Withdrawal Form and a

refund Application must be received by the Summer Sessions Office by June 2 for First Session or by June 23 for Second Session.

Complete withdrawal, during the first two weeks of the Session. You may withdraw during the first two weeks without a record of enrollment and without the instructor's signature. Complete a Withdrawal Form and a Refund Application and submit these forms to the Summer Sessions Office by the end of the second week.

Complete withdrawal, third through fifth week of the Session. A grade of "W" for each course appears on the permanent transcript if the student withdraws after the second week of the Session and is doing passing work. To withdraw from all courses after the second week of instruction, complete a Withdrawal form, obtain the signatures of the instructor and school dean (or Dean of Extended Education, if you are not a regular student) on the Withdrawal form. Submit these completed forms to the Summer Sessions Office.

Withdrawal from classes during final exam week (last week of Session) is not permitted, except in such cases as accident or serious illness where circumstances causing

the withdrawal are clearly beyond the student's control, and the assignment of a grade of Incomplete is not practical. Such requests require a Petition with the signature and approval of the instructor and school dean (Dean of Extended Education for Summer-only or non-matriculated students). The form is available in the Summer Sessions Office and must be filed in the Summer Sessions Office with documentation by the last day of the Session in which the student was enrolled.

Refund of Tuition Fee

Refunds are not automatic. Even if the University cancels a scheduled course, you must make an application to have your tuition fees refunded. Refunds are subject to change without notice by the Trustees of California State University System. Amounts of refund are calculated according to the Formula for Refunds established in Title 5 of the California Administrative Code. Refund Applications are available from the Summer Sessions Office. This form must be filed in person with the Summer Sessions Office. Your Schedule Confirmation and the tear off receipt from the Change of Program form (if applicable) must accompany the written request. No transaction will be

SCHEDULE FOR REFUND OF TUITION FEES

FIVE-WEEK OR LONGER SESSIONS

No. of Units	Amt. paid	Prior to first day of Session	First two days of Session	Any other day of first week	Any day of 2nd week
1	\$125.00	\$115.00	\$00.00	\$00.00	\$00.00
2	250.00	240.00	125.00	81.25	31.25
3	375.00	365.00	250.00	162.50	62.50
4	500.00	490.00	375.00	243.75	93.75

THREE OR FOUR-WEEK SESSIONS

1	\$125.00	\$115.00	\$00.00	\$00.00	\$00.00
2	250.00	240.00	125.00	81.25	00.00
3	375.00	365.00	250.00	162.50	00.00

2 WEEKS OR SHORTER SESSIONS: NO REFUNDS WILL BE MADE

Summer 1996

made without a receipt. Students must submit refund requests by the published deadlines (refer to Calendar and Refund Schedule). The effective date of the refund request, for purposes of calculating amount refunded, is the day it is received by the Summer Sessions Office. Allow approximately six weeks from the date the request is received for processing refunds.

Refund of Parking Fees

Written application for a refund of parking fees must be accompanied by a permit or decal which the University has issued. Applications for refund is determined by the following policy: 50% of all remaining full weeks; however no refund for remaining periods of less than two weeks.

Refund Schedule

The formula used for calculating the amount of fees refunded for five week or longer sessions is as follows. If you apply for a refund prior to the first day of the Session, May 31 or June 21, you may receive total tuition minus \$10.00. If you apply for a refund on the first or second day of the Session, you may receive total tuition minus the fee for one unit. During the remainder of the first week of the Session, if you apply, you may receive total tuition minus one unit times 65 percent. During the second week of the Session, if you apply, you may receive total tuition minus one unit times 25 percent. After the second week, none of the fee may be refunded. The late registration fee is non-refundable. Please note that tuition refunds are based upon the start date of the Session and not upon the first day a particular course meets.

Cancelled Course Policy

If you are enrolled in a course that is cancelled for any reason, you must complete an Application for Refund or arrange for another course by completing a Change of Program form. The University does not refund fees automatically in the event of a course cancellation.

Summer Sessions Office

Small College Complex SCC B-141, 310/516-3741,

Processing of general registration, late registration, adds, drops withdrawals, and other academic transactions related to Summer Sessions enrollment will take place in the Summer Sessions Office.

The office hours are 8:00 a.m.- 7:00 p.m., Monday through Thursday during the first week of both sessions and 8:00 a.m. - 6:00 p.m. throughout the remainder of the summer. The office closes on Fridays at 5:00p.m., and will be closed on weekends and on July 4.

Maximum Student Unit Load

The total units a summer student may earn:

Session 1.....	7 units
Session 2.....	7 units
Sessions 1 and 2.....	10 units

Exceptions to the above are based on proven academic ability and the feasibility of the student's schedule. Students wishing to exceed these unit limits must obtain and complete a special petition available in the Summer Sessions Office and request permission from the dean of the school governing their major. Visiting students or non-matriculated students must request permission from the Dean of Extended Education.

General Studies

The General Studies program is the nucleus of the undergraduate curriculum at CSUDH, deliberately structured to provide the intellectual and effective foundation required of a well-educated person. The philosophy underlying General Studies offerings is that they are courses for non-specialists, presenting subject matter related to wider context of knowledge and stimulating interest in lifelong learning. General Studies courses present breadth, deal with representative concepts, and provide some integration of concepts. Several of the courses which comprise this curriculum are offered in

Summer Sessions. These General Studies courses are designated by the "GS" symbol next to the Schedule number. For an overview of the General Studies program consult the University Catalog, pages 80 - 87 available in the University Bookstore.

University Advisement Center

Small College Complex SCC M-110 310/516-3538

Regularly enrolled students may obtain academic advisement for their summer schedules during Spring Semester when faculty and advisors are available. The Summer Sessions Office does not provide academic advisement. Many questions are answered in the University Catalog which includes course descriptions and course prerequisites in addition to policies and programs of the University. The Catalog is sold at the University Bookstore. In addition, the University Advisement Center is available for information advisement at (310) 516-3538. Contact the Advisement Center for office hours.

School of Management Advisement Center

Social & Behavioral Sciences Building A-306 310/516-3561

Summer Sessions students who wish to enroll in any undergraduate business courses must obtain approval to enroll from the Business Advisement Center. Visiting or non-matriculated students are asked to bring transcripts, grade reports, and/or college records to the Center before seeking approval. Call 310/516-3561 for days and hours of advisement. Any student wishing to enroll in a School of Management 500-level course must receive approval and signature from the MBA Program Office located in SBS B-306.

Course Numbering System

The course numbering system for the University is based upon three-digit numbers as follows:

- 000-099 Sub-collegiate courses, not for baccalaureate credit.
- 100-199 Lower division courses, normally taken in the freshman year.
- 200-299 Lower division courses, normally taken in the sophomore year.
- 300-399 Upper division courses, normally taken in the junior year.
- 400-499 Upper division courses, normally taken in the senior year.
- 500-599 Graduate courses, normally limited to graduate students.

High School Students

Qualified high school students who will enter the junior or senior year in Fall 1996 can register for Summer Sessions lower division (100 level) courses with a letter of recommendation from the school principal or counselor and written authorization from the parents. Address letters to the Dean of Extended Education, California State University, Dominguez Hills. Students pay regular summer fees, and the course credit they earn may be applicable to a degree from CSUDH or another institution.

Grade Reports and Transcripts

Student performance in each course is reported at the end of the Session by one of the following grades (with grade points earned):

GRADE POINTS	GRADE
A	4.0
A-	3.7
B+	3.3
B	3.0
B-	2.7
C+	2.3
C	2.0
C-	1.7
D+	1.3
D	1.0
F	

The following grades are to be used for approved courses only:

CR Credit (not counted in grade average, but units allowed). Undergraduate level only.

SP Satisfactory Progress (credit is deferred until completion of course sequence).

NC No Credit (not counted in GPA, no units allowed).

A report of final grades assigned in classes will be mailed to you about 3 weeks after the end of the session.

A student may obtain an official transcript of enrollment and grades upon completing a Request for Transcript available at the office of Records and Registration. This request should be filed no earlier than the last week of the session in which the student is enrolled. Allow at least three weeks after the end of the session for delivery of the transcript copy. A fee of \$4.00, payable at the Cashier's Office, is charged for the first transcript request. Transcripts are not issued to a student whose record indicates financial obligation to the University. Grades for nonstandard-date courses will be posted with standard course grades at end of Session.

Summer students may audit a course on a space available basis with the permission of the instructor. Auditors pay regular course fees. To enroll as an auditor, the student must submit a Change of Program form with the instructor's signature to the Summer Sessions Office.

Students must officially change their status in a course from credit to audit by the end of the first week of instruction.

Credit / No Credit Grading

In accordance with the current Credit / No Credit policies, the undergraduate Credit (CR) grade is the equivalent of an A, B or C letter grade, and the No Credit (NC) grade is the equivalent of a C-, D or F. CR / NC grades are recorded on student transcripts. An undergraduate may elect to be graded CR/NC in particular courses, subject to conditions which are described

in the University Catalog. To receive a Credit / No Credit grade in a Summer Sessions course (except when the course is graded solely on Credit / No Credit basis), the student must complete the Credit / No Credit form, available in the Summer Sessions Office by the end of the second week of instruction.

Independent Study

Independent or directed study courses are intended for the regularly enrolled, matriculated students in order to enhance or supplement their curriculum. To enroll for independent or directed study, the student must obtain a contract from the Summer Sessions Office. This contract must be completed, including the signature of Dean, and submitted with student's registration. A student will not be registered for independent or directed study unless a completed contract has been submitted. Only course numbers listed with departments may be used; be sure the correct Session and number of units are on the contract. The same registration deadlines and policies apply to independent study.

Final Examinations

Final examinations are administered during the final week the course is scheduled to meet. Usually the examination is given on the last day the the course meets. No adds or drops are accepted during or after the last week the class meets.

Entry Level Mathematics (ELM) Requirement

CSU students wishing to enroll in any Summer Sessions mathematics classes will have to provide evidence of having satisfied the ELM requirements. This requirement can be satisfied by any of the following methods.

1. Having an ELM score which meets the minimum for placement in a particular class.

2. Satisfactory test score on ACT / SAT test.
3. A transcript showing passing grades on a college level mathematics course above the level of Intermediate Algebra.

Evidence of any of the above should be sent to the Summer Sessions Office. California State University, Dominguez Hills graduates can have their records verified by the Office of Records and Registration.

Visitors from other Universities / Colleges should bring evidence that they have met the prerequisites for the course they wish to take.

University Bookstore Loker Student Union 310 / 516-3789

Textbooks, course materials, the University Catalog, supplies, giftware, and clothing are available at the Bookstore. Summer hours are:

Mon - Thur 8:00 am - 6:30 pm
Fri 8:00 am - 4:00 pm

During the first week of each Session, the Bookstore remains open until 7:00 pm; Monday - Thursday; until 4:00 pm Friday. The Bookstore is closed on weekends. Bookstore hours are subject to change. The last day to return textbooks for the First Session is Monday, June 10. The last day to return textbooks for Second Session is Monday, July 1.

Disabled Student Services Student Health Center A106, 310/516-3660 TDD/516-4028

Disabled Student Services is committed to the student with a disability and to his or her right to an equal educational experience. Students having a disability which is either permanent or temporary in nature are eligible for a variety of support services including: Admissions / Registration Assistance Priority Registration Readers - Notetakers - Interpreters- Assistive devices and equipment loans.

University Library

Educational Resources Center 310/516-3714

During Summer Sessions, June 3 to August 2, the library is open as follows:

Monday & Thursday: 8:00am-7:00pm
Tuesday & Wednesday: 8:00am-9:00pm
Friday: 8:00am-5:00pm
Saturday: 11:00am-3:00pm
Sunday: Closed
Thursday July 4: Closed

Information Center Small College Complex A-130, 310/516-3696

The center assists the Campus population, prospective University applicants, and community members by providing essential centralized information on campus resources, activities, and programs. The Center also makes appropriate referrals to other campus units. Brochures, maps, directories, and other materials are available to students and visitors.

The Center functions include handling all application requests, providing information on admission policies and procedures, giving preadmission advising. Summer hours are:
Monday-Friday 8:00am - 5 pm.

Testing Office Small College Complex BLDG. 11, Rmm 11207, 310/516-3909

The Testing Office provides information and registration materials for the GRE, SAT, ACT, GMAT, MCAT, CLEP (credit by exam programs), PRAXIS, EPT/ELM and CBEST.

Food Service Loker Student Union 310/516-3814

Concessions and catering services will be available Monday through Friday throughout the summer. Check with the office in the Cafeteria for hours of operation. Food vending machines are located in Social and Behavioral Sciences building (SBS) and outside of the first floor of the Educational Resources Center (ERC) building.

Health Programs and Psychological Counseling Student Health Center A141, 310/516-3818

The Health Programs and Psychological Counseling unit offers personal counseling during the Summer Sessions. Students must have attended Spring Semester 1996 in order to be eligible for counseling.

University Student Union 310/516-3556

The Donald P. and Katherine B. Loker University Student Union opened to the Dominguez Hills community in the Fall of 1992. Its purpose is to provide a dynamic educational, social, recreational, and cultural environment for residential and commuter students, faculty, administrators and the community. It is intended that the University Student Union's facilities, programs and services will play a central role in enriching University life and contribute to out-of-classroom learning experiences. It is a pedestrian crossroads of the campus community and its activities. The University Student Union houses the Union Administration Office and Information Desk, the Associated Students Inc., Bookstore and Campus Dining. Services available include, Food

Court, Coffee Shop and Bistro, University Bookstore, television rooms, recreation room (billiards, ping pong, video and board games), a variety of lounges and meeting rooms. Rooms for special events can be reserved and catering services provided; contact the union office for additional information.

Cashier

Small College Complex B-135, 310/516-3812

The Cashier's Office will be open:
10:00am to 6:30pm M-Th &
10:00am to 5:30pm Friday.

Veteran's Services Student Health Center A106, 310/516-3643

Veterans are assisted in dealing with the Veteran's Administration, the State of California Department of Veteran's Affairs, and with problems that are a barrier to their success on campus.

Veterans are encourage to utilize the following services available for both day and evening students.

- * Pre-admission advisement
- * Veteran's benefits counseling
- * Tutorial assistance
- * Special admissions to the University
- * Vocational Rehabilitation Program
- * Academic advisement

Student Housing P.O. 6228, Carson, CA 90749 310/516-4228

On-campus Summer Sessions Housing is available to all students attending, but space is limited. Information regarding on-campus housing may be obtained by writing or phoning the Department of Student Housing (address and phone above).

Parking

Small College Complex A122, Department of Public Safety, 310/516-3725/3639

All vehicles which park on this campus must display a valid parking permit. (Sec. 21113a CVC). Summer Parking permits are purchased from the dispensing machines located at: Lot 1, Information Booth, Lot 3a, Lot 3 and Lot 4. (Should a dispensing machine malfunction, please contact the Information Booth attendant or call the University Police at 516-3639, or use an emergency call box.) Vehicles are to park "head in" using marked stalls only.

Daily (\$1.50) parking permits must be displayed on the vehicle's dashboard. Summer Session permits are displayed inside the front windshield on the driver's side near the VN plate. This "static" type permit can be removed and transferred to another vehicle if the need arises. Permits must be displayed in plain view without obstruction. Car covers are not recommended. Motorcycles, scooters, and mopeds have special areas for parking: SW corner of Lot 2, SE corner of Lot 3 and NW corner of Lot 4.

Visitor parking areas are located in the front of the Small College Complex, outside of Lot 3a on the north perimeter road, and the gymnasium lot. These stalls are free, no permit required for 30 minutes. Loading zones are located adjacent to major campus buildings. No permit is required for 30 minute parking.

Those who receive parking citations are reminded that pursuant of Sec. 40202 and 40500 CVC, these citations cannot be cancelled or rescinded by the University Police. Should there be significant error on the part of an officer or campus official, the issuing officer will request the court to rescind the citation.

Failure to resolve a parking citation will result in difficulty with renewal of the vehicle's registration.

For further information, please contact the Parking Office at 310/516-3725.



NEW THIS SUMMER!
KIOSK ACCESS
TO STUDENT RECORDS

**TWO KIOSKS ARE NOW
LOCATED ON CAMPUS:
ADJACENT TO INFORMA-
TION CENTER AND IN
LOKER STUDENT UNION**

Students can now print their own schedule confirmations, grades, and unofficial transcripts without having to visit the Office of Extended Education for these services. To access these features, students will need an ID number and a pin number. The ID number is their Social Security number, and the initial PIN number is the student's birthdate. (Students are encouraged to change this PIN number after the initial login.)

Choose from these great courses & develop your knowledge of the Humanities

HUMANITIES!

HUM 200-11 & 21 Introduction to the Humanities (3)

Instructor: H. Holter (11)
& P. Rodney (21)

Prerequisite: ENG 111 or six units of IDS 107 or equivalent

Examines the interrelationships among the humanities (art, literature music, and philosophy) in Western culture by studying the theme of tradition and change in two periods, the Renaissance and the 20th Century (including the Harlem Renaissance).

HUM 310-11 Key Concepts: Myth as Reality (3)

Instructor: L. Smith

Prerequisite: HUM 200

Explores the nature of truth as myth, its relationship to ritual, dream, folk-tale, and its manifestations in literature and the individual. There will be a primary literary focus, which will draw on the discipline of philosophy and religion, anthropology and psychology.

HUM 310-12 Key Concepts: Lives of Faust (3)

Instructor: J. Nachev

Prerequisite: HUM 200

Analysis of a major concept in humanistic thought and expression; i.e. death, alienation, excellence, individual & society, classicism and romanticism, etc.

HUM 310-61 Key Concepts: Propaganda & Film (3)

Instructor: W. Wells

Prerequisite: HUM 200

Film and literature are used as propaganda weapons to persuade, frighten, justify, entertain, and instruct audiences in every part of the globe. Course uses a variety of politically oriented films and essays to broaden students' artistic, aesthetic, and political history perspectives.

HUM 314-11 Key Issues: International Film: Art/Image/Reality

Instructor: L. Lee

Prerequisite: HUM 200

International film is not only a purveyor

of culture for its national and international viewers but a vehicle for observing the intricate of the philosophical and sociological and artistic reality of various language groups. A view beyond the celluloid can be most revealing- come look!

HUM 314-61 Key Issues: French Perspectives: Enlightenment (3)

Instructor: C. Caloia

The 18th century in general, but in France in particular, is commonly known as the Age of the Enlightenment. A new light was shed on the man's thinking about the arts & sciences, about his personal & social relations, about the purpose of his existence, and about the kind of social and political institutions required to realize it. The changes this thinking brought about were immense—and how they affect us today will be addressed in this course.

CERAMICS!

The ART 150, 361 and 463 courses will be offered at the same time so that each level of expertise will inspire and help one another. The class will explore traditional and conceptual tile making for installation fabrication and utilitarian purposes. From architectural tiles through innovative silk screen, light and sound applications for cultural installation, participants will also study glaze theories and firing methods.

LITERATURE!

ENG 590 Literature Seminar: Narcissism and Confession (3)

Instructor: T. Giannotti

Prerequisite: Consent of Chair

A study of the relationship between narcissism (and related psychiatric metaphors) and confessional modes of narrative, such as autobiography and the first-person novel. Readings will focus on 20th-century literature.

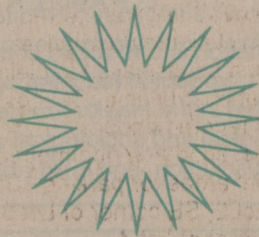

Summer Extension Courses are Fun - Exciting Career & Life- Enhancing

Just some of the courses available this summer:

- ☀ *Learn the Shopping Secrets of Southern California*
- ☀ *International Business: The New Era of Trade Pacts*
- ☀ *Importing & Exporting*
- ☀ *How to "Sell" on the Internet*
-- *Though It's not a "Selling" Medium*
- ☀ *Treatment Protocols for Managed Care Practice*
- ☀ *CPR for the Community - Adult, Child & Infant CPR*
- ☀ *Feel Better and Increase Energy*
Through Herbs and Natural Foods

Call (310) 516-3741 for the Summer Extension Bulletin today!

SUMMER SESSIONS 1996 FEATURES

Courses offered to satisfy requirements of the following areas during Summer Session '96

ONE YEAR OF ORGANIC CHEMISTRY IN A SINGLE SUMMER

Designed for premedical and pre-dental students, this ten-week program corresponds to a full year of organic chemistry with lab. The two sequential courses offer 8 semester units the required chemistry for professional schools. The course is helpful in preparing for the DAT and MACT.

Students who enroll for the entire 10 week program will have priority registration.

Upper Division

CHE 300 Organic Chemistry I (3) (Summer Only).

Prerequisite: CHE 112 or 1 year of general Chemistry

A detailed study of organic molecular structure, reaction mechanisms stereochemistry, and synthesis with emphasis on a aliphatic and aromatic systems. Three hours of lecture per week.

CHE 301 Organic Chemistry Laboratory I (1) (Summer Only).

Prerequisites: CHE 112 or 1 year of general chemistry; concurrent enrollment in CHE 300.

Basic experimental techniques of organic chemistry. Three hours of laboratory per week.

CHE 302 Organic Chemistry 11 (3) (Summer Only).

Prerequisites: CHE 300 and CHE 301. Concurrent enrollment in CHE 303.

Continuation of CHE 300 with emphasis on the chemistry of organic compounds containing oxygen and nitrogen. Three hours of lecture per week.

CHE 303 Organic Laboratory II (1)(Summer Only).

Prerequisites: CHE 112 or 1 year of general chemistry; concurrent enrollment in CHE 302.

Preparation of organic compounds and qualitative organic analysis. Three hours of Laboratory per week.

GENERAL STUDIES

ART 101
BIO 102
COM 130
EAR 100
ENG 110
ENG 111
THE 120
GEO 100
HIS 111
HUM 200
HUM 310
HUM 314
MAT 105
MAT 131
MAT 153
MAT 171
MAT 191
MAT 193
PHI 120
PSY 101
SBS 318
SPA 151

LIBERAL STUDIES

ART 101
BIO 102
ENG 308
ENG 314
ENG 350
GEO 360
HIS 111
HIS 301
HIS 341
MAT 107
MAT 207
PHI 120
PHY 108
PSY 350
SBS 318
SMT 310
THE 120

SCHOOL OF MANAGEMENT

ACC 230
ACC 231
ACC 333
ACC 337
BUS 445
BUS 495
BUS 595
FIN 360
FIN 480
MGT 312
MGT 490
MKT 350
ENG 308
QMS 322
QMS 423

HEALTH IN PUBLIC EDUCATION/ HEA 300-61 PAMELA KROCHALK

Health Education is a required course for professional multiple or single subject clear credential teaching applicants. The course covers all topics designated in the Health Framework for California including nutrition, the physiological and sociological effects of substance abuse, cardiopulmonary resuscitation, and child abuse.

COMING SPRING '97 a university in your living room?

Next January it will be possible for anyone to receive live broadcasts of our Distance Learning courses in their homes by subscribing to PacTel's Digital TV.

In addition to watching all of the local and cable TV channels, subscribers will be able to complete a bachelor's degree, earn an MBA or Master's degree in Behavioral Science, fulfill requirements for a teaching credential and enroll in many exciting classes.

Watch for information in the Fall '96 Extended Education Bulletin to find out how you can have a university in your living room.

NEW THIS SUMMER! KIOSK ACCESS TO STUDENT RECORDS

TWO KIOSKS ARE NOW LOCATED ON CAMPUS ADJACENT TO INFORMATION CENTER AND IN LOKER STUDENT UNION

Students can now print their own schedule confirmations, grades, and unofficial transcripts without having to visit the Office of Extended Education for these services. To access these features, students will need an ID number and a pin number. The ID number is their Social Security number, and the initial PIN number is the student's birthdate. (Students are encouraged to change PIN number after initial log-in.)

THE AMERICAN LANGUAGE & CULTURE PROGRAM

ENGLISH LANGUAGE COURSES FOR BEGINNING, INTERMEDIATE AND ADVANCED INTERNATIONAL STUDENTS

The American Language and Culture Program at California State University, Dominguez Hills, has courses for international students, business people and new residents who wish to improve their English language skills. Maximum enrollment in most classes is 15 students to ensure sufficient student practice and attention from the teacher.

WORK-SITE PROGRAMS (WSP)

ALCP can offer English language and culture programs at the work-site for non-native speakers of English. Programs can be developed for a wide range of work needs: on-the-line employees who need basic communication skills and orientation to an American work environment; executives who need high-level communication skills to negotiate business and operate in social environments or other special situations. English-for-Special-Purposes (ESP) programs are often offered in industries such as hospitality, tourism and travel, import/export, banking and manufacturing. ESP programs can include safety English, industry-specific terminology and jargon, company-specific terminology and jargon, writing skills (forms, memos, reports), oral communication/pronunciation, asking questions, giving/receiving directions, clarifying, expressing opinions, and expressing safety concepts.

INTENSIVE ENGLISH PROGRAM (IEP)

IEP offers an eight-week intensive English language program five times a year for students with academic or professional goals, including passing the TOEFL for entrance into an American university. The 20-hour per week IEP (9am-1pm daily) offers a coordinated program of conversation, grammar, writing, reading/vocabulary, pronunciation and listening. Students from all over the world enroll in this multi-level program and can continue to improve their skills by advancing from session to session. Qualified students from outside the U.S. are eligible for a student visa. Individual courses may also be taken by students. A certificate of achievement is awarded after successful completion of at least one session. Language skills studied are:

Conversation

Conversation Skills offers extensive individual student practice in speaking. Students learn to use authentic language in situations related to work, school, leisure and social life. They are encouraged to express their thoughts and ideas, plus their wants and needs, in classroom situations that make extensive use of pair work, small-group discussions, and information-sharing activities. These face-to-face discussions simulate real-life social interaction, encouraging the use of eye contact, exclamations, questions, accurate intonation and emotional tone. 24 meetings per session.

Writing

Writing Skills emphasizes the process of writing and highlights the various strategies writers can use in the process. The class teaches such organizational patterns as

1996 Schedule Intensive English Language Program

Spring Semester	Class Dates (Mon-Fri)	Weeks	Tuition	Orientation (Wednesdays)
Session A	January 29-March 22	eight	\$1,300	January 24
Session B	April 1- May 24	eight	\$1,300	March 27
Sessions A + B		sixteen	\$2,500	
Summer Semester	Class Dates	Weeks	Tuition	Orientation
Session A only	June 10 - August 2	eight	\$1,300	June 5
Fall Semester	Class Dates	Weeks	Tuition	Orientation
Session A	August 19 - Oct. 11	eight	\$1,300	August 14
Session B	October 21 - Dec 13	eight	\$1,300	October 16
Sessions A + B		sixteen	\$2,500	

generalizing, describing, defining, talking about differences and similarities, and expressing cause and result. Although the focus is on content-based writing, other language skills are integrated, and practice writing is combined with speaking and listening activities. In order to gather data for their writing, students share ideas, opinions, and suggestions in pair, small group, and whole-class discussions. These brainstorming activities lead to teacher and peer analyses of student essays where the focus is on topic sentences, supporting facts, discourse markers, and concluding sentences. 24 meetings per session.

Pronunciation

The Pronunciation class helps develop clear pronunciation and American English intonation patterns for increased spoken comprehension. Students learn acceptable pronunciation of single vowel and consonant sounds, groups of sounds, stress patterns in words, and intonation patterns in sentences. Students have the opportunity to listen and practice with tapes and to express their own views and opinions under the teacher's guidance. Students receive personal attention and special homework assignments focused on their specific pronunciation and intonation problems. Further pronunciation work can be done in the University's learning laboratory. 24 meetings per session.

Grammar

The Grammar class presents the important grammatical structures in English through a process of observing, describing and using the structures in written and spoken language. Controlled and open-ended exercises and tasks are practiced in class to help the students increase their mastery over

the forms. Special attention is given to grammar points that are most difficult for students. Additionally, the ways in which grammar is tested in the TOEFL are examined and practice TOEFL exercises are done. 16 meetings per session.

Reading & Vocabulary

The focus of Reading & Vocabulary is to help students increase their vocabulary within the context of meaningful, high-interest readings. Each student will learn the skills needed to find the meanings of unfamiliar words and then incorporate them into active, everyday use. Reading and vocabulary skills will be practiced through an integrated approach that uses a variety of topics, genres, moods and styles. Interesting subjects will be read and then examined through paired discussions, small group work and whole-class activities. 16 meetings per session.

Listening Skills

The Listening Skills class allows students to develop their aural skills in a supportive, active environment. Each student is given the opportunity to participate in a variety of in-class activities using tapes, videos and guest speakers. Students listen to and learn how to appropriately respond to questions presented in meaningful language contexts. Each listening exercise allows students to progress from controlled listening activities to more complex ones. Each student will be expected to strengthen his listening skills outside the classroom through assignments involving TV, radio and community service projects that require interaction with American speakers. Additional practice is available through tapes in the University's Learning Labs. 16 meetings per session.

Optional Afternoon Classes

- TOEFL Preparation
- Computer, e-mail, WWW and Internet
- Video, Films
- Conversation Partners

SHORT-TERM PROGRAMS:(STP)

Programs in a wide variety of language studies are given in January and June-August for students visiting the U.S. from abroad. Customized programs are available at any time of the year.

ADULT PROGRAMS

Aviation English

with Flight Training available at local flight schools: helicopter and fixed-wing training.

Business English

Conversation and American Culture

YOUNG STUDENTS PROGRAMS

Children's Conversation Program: Ages 8 -12

Youth Conversation Program: Ages 13 - 17

ESL TEACHERS' PROGRAMS

Speaking/Pronunciation Development for ESL Teachers

TESL Methodology, Theory & Textbooks (Summer 1996)

Adult Programs: 18 Years or Older

Aviation English	A) June 10 - July 5	4 weeks \$360
Mon/Wed/Fri 9 hours weekly	B) July 8 - Aug. 2	4 weeks \$360
Beginning & Intermediate Levels	Sessions A + B	\$690
(Can be combined with 8-week Intensive Program June 10-August 4)		
Business English	July 22 - Aug. 16	4 weeks \$720
Mon-Fri 20 hours weekly		
Intermediate & Advanced Levels		
Conversation & American Culture	A) July 8 - 26	3 weeks \$430
Mon-Thurs 16 hours weekly	B) July 29-Aug.16	3 weeks \$430
Beginning & Intermediate	Sessions A + B	\$795

Young Students Programs: 8 - 17 Years Old

Children's Conversation Program	A) July 1 - 12	2 weeks \$360
(ages 8-12) Mon-Fri 20 hours weekly	B) July 15 - 26	2 weeks \$360
Beginning & Intermediate	C) July 29 - Aug. 9	2 weeks \$360
Chaperons required	Sessions A + B + C	\$995
Youth Conversation Program	A) July 1 - 12	2 weeks \$360
(ages 13-17) Mon-Fri 20 hours weekly	B) July 15 - 26	2 weeks \$360
Beginning & Intermediate	C) July 29 - Aug. 9	2 weeks \$360
Chaperons required	Sessions A + B + C	\$995

ESL Teachers' Programs

Speaking/Pronunciation for ESL Teachers	July 1 - July 12	2 weeks \$450
Mon-Fri 25 hours weekly		
Intermediate & Advanced English Levels		
TESL Training:		
Methodology, Theory and Texts	A) July 15 - July 26	2 weeks \$450
	B) July 29 - Aug 9	2 weeks \$450
Speaking/Pronunciation + TESL		
Mon-Fri 25 hours weekly	Intermediate & Advanced English Levels	\$900

ESL

For more information:

Tel: (310) 516-3830
 Fax: (310) 516-4418
 E-mail: alcp@DHVX20.csudh.edu

WORLD WIDE WEB:
<http://dolphin.csudh.edu/~alcp/index.html>

To register: Tel. (310) 516-3830

INTENSIVES

#	Dept	Cr #	Sec	Title of Course	Units	Dates	Days	Hours	Room #	Instructor	Fee
ART											
LCH A111 (310) 516-3310											
30315	ART	150A	61	CERAMICS I CR LISTED: 30316 ART 361A 61 30320 ART 463A 61	3	6/3-6/24	M-TH	9:AM-12:50PM	LCH A118	I. REPASI	\$450
30318	ART	150A	62	CERAMICS I CR LISTED: 30319 ART 361A 62 30320 ART 463A 62	3	6/3-6/24	M-TH	1-4:50PM	LCH A118	J. NEUWALDER/ I REPASI	\$450
30316+	ART	361A	61	CERAMICS II CR LISTED: 30315 ART 150A 61 30317 ART 463A 61	3	6/3-6/24	M-TH	9AM-12:50PM	LCH A 118	I REPASI	\$450
30319+	ART	361A	62	CERAMICS II CR LISTED: 30318 ART 150A 62 30320 ART 463A 62	3	6/3-6/24	M-TH	1-4:50PM	LCH A118	J. NEUWALDER/ I REPASI	\$450
30320+	ART	463A	62	CERAMICS III CR LISTED: 30318 ART 15A 62 30319 ART 361A 62	3	6/3-6/24	M-TH	1-4:50PM	LCH A118	J. NEUWALDER/ I REPASI	\$450
30317+	ART	463A	61	CERAMICS III CR LISTED: 30315 ART 150A 61 30316 ART 361A 61 30322 ART 363A 63	3	6/3-6/24	M-TH	9:AM -12:50PM	LCH A118	I. REPASI	\$450

BEHAVIORAL SCIENCES

SBS G326 (310) 516-3434

30010+	BEH	535	61	ORGANIZATIONAL CONFLICT	3	4/3-6/12	W	6-9:45PM	ERC E133	R. EBERT	\$414
30011+	BEH	535	91	ORGANIZATIONAL CONFLICT	3	4/3-6/12	W	6-9:45PM	ERC E133	R. EBERT	\$504
30203+	BEH	595	61	SPE TPCS: MANAGING RACE AND ETHNIC CONFLICT	3	6/3-7/1	M-TH	6-9:50PM	SBS A232	WHITHERSPOON/ WHIPPLE	\$375

BIOLOGY

NSM A124 (310) 516-3381

30336+	BIO	458	61	HUMAN PARASITOLOGY	3	6/3-7/26	T TH	9AM-12:PM	SBS G122	D. SOLEYMANI	\$450
30337	BIO	458L	61	HUMAN PARASITOLOGY LAB	0	6/3-7/26	T TH	1-4PM	TBA	D. SOLEYMANI	\$0

BUSINESS ADMINISTRATION

SAC 2149 (310) 516-3465

30282+	BUS	495	61	SPE TPCS: PRINCIPLES OF MGMT	2	5/4-7/20	S	12:30-2:30PM	ERC A103	B MILLS	\$338
30283+	BUS	495	62	SPE TPCS: PRINCIPLES OF MKTNG	2	5/4-7/20	S	2:30-4:30PM	TBA	L HUTCHESON	\$338
30277+	BUS	595	61	SPE TPCS: MANAGING HUMAN RESOURCES	3	5/5-8/17	SUN	9AM-12PM	ERC A103	B. KLEINER	\$507
30276+	BUS	595	91	SEL TPCS: MANAGING HUMAN RACE	3	5/5-8/17	SUN	9AM-12PM	ERC A103	B KLEINER	\$597

CHEMISTRY

NSM B202 (310) 516-3376

30062+	CHE	300	61	ORGANIC CHEMISTRY I	3	6/3-7/8	M-TH	10AM-12:15PM	NSM C221	J. LYLE	\$375
30064+	CHE	300	62	ORGANIC CHEMISTRY I	3	6/3-7/8	M-TH	10AM-12:15PM	NSM C221	T. REILLY	\$375
30063+	CHE	301L	61	ORGANIC CHEMISTRY LAB I	1	6/4-7/3	T-TH	1-4PM		J. LYLE	\$235
30065+	CHE	301L	62	ORGANIC CHEMISTRY LAB I	1	6/4-7/3	T-TH	1PM-4:PM		T. REILLY	\$235
30066+	CHE	302	61	ORGANIC CHEMISTRY II	3	7/9-8/9	M-TH	10AM-12:15PM	NSM C221	J. LYLE	\$375
30068+	CHE	302	62	ORGANIC CHEMISTRY II	3	7/9-8/9	M-TH	10AM-12:15PM	NSM C221	T. REILLY	\$375
30067+	CHE	303L	61	ORGANIC CHEMISTRY LAB II	1	7/9-8/8	T-TH	1-4PM		J. LYLE	\$235
30069+	CHE	303L	62	ORGANIC CHEMISTRY LAB II	1	7/9-8/8	T-TH	1-4PM		T. REILLY	\$235

INTENSIVES

#	Dept	Cr #	Sec	Title of Course	Units	Dates	Days	Hours	Room #	Instructor	Fee
COMPUTER SCIENCE											
NSM A132 (310) 516-3398											
30216+	CSC	321	61	PROGRAMMING LANGUAGES	3	6/3-8/2	M W TH	6:15-7:45PM	SAC 3152	M. AHMADNIA	\$405
30213+	CSC	331	61	COMPUTER ORGANIZATION	3	6/3-8/2	M W TH	8-9:30PM	SBS A210	M. AHMADNIA	\$405
30214+	CSC	341	61	OPERATING SYSTEMS	3	6/3-8/2	M W TH	6:15-7:45PM	NSM D129	Z. KHWAJA	\$405

EARTH SCIENCE NSM B202 (310) 516-3376

30169	EAR	100	61	INTRO TO EARTH SCIENCES	3	6/3-6/20	M - TH	4-8PM	NSM B234	M. SCHWARTZ	\$375
-------	-----	-----	----	-------------------------	---	----------	--------	-------	----------	-------------	-------

EDUCATION SOE RM 1010 (310) 516-3519

GRADUATE EDUCATION SOE RM 1010 (310) 516-3524

30162	GED	524	61	LEGAL RIGHTS IN SPECIAL ED	3	6/4-6/22	T TH S	5:30-8:30PM 9AM-4PM	SCC E145	B. FARRAN	\$375
30034	GED	559S	61	GENERIC PRAC EXCEPT CHILD	4	7/1-8/2	M-F	8-12:30PM	LCH A 348	OKADA/ SIGNORELLI	\$760
30035	GED	561	61	TYP/ ATYP DEV PTRNS EXP CHILD	3	6/3-6/28	M W F	4-7:30PM	SBS B209	D. OKADA	\$375
30039	GED	595	61	SPE TPCS: COUNSELNG THEORY	3	6/3-7/3	M W	4-8:40PM	LCH A227	C. BOHMAN	\$375
30040	GED	597S	61	FIELDWORK COUNSELING	3	6/7-7/6	S	9AM-12PM	LCH A330	R. LEE	\$570

TEACHER EDUCATION SOE ROOM 1010 (310) 516-3522

30095	TED	304	61	FOUNDATIONS IN ED	1	6/10-6/27	M - TH	4-5:10PM	SAC 1107	R. GORDON	\$125
30097	TED	304	62	FOUNDATIONS IN ED	1	8/5-8/16	M - F	9AM-1:30PM	SCC E153	STAFF	\$125
30096+	TED	402	61	MOTIVATION AND LEARNING	2	6/10-6/27	M - TH	5:25-7:45PM	SAC 1107	R. GORDON	\$250
30098+	TED	402	62	MOTIVATION AND LEARNING	2	8/5-8/16	M - F	9AM-1:30PM	SCC E153	STAFF	\$250
30108+	TED	403	61	TEACHING READING/LANG. ART	3	6/24-7/3	M - F	4-9:30PM	SCC L149	D. WOLFF	\$375
30106	TED	405	61	MAINSTREAM CHLD SPC NEED	3	6/4-6/20	T - TH	4-8:45PM	SCC L149	D. WOLFF	\$375
30109	TED	405	62	MAINSTREAM CHLD SPC NEED	3	7/9-7/25	T - TH	4-8:45PM	SCC L149	D. WOLFF	\$375
30112	TED	407	61	LANGUAGE LEARNING	3	6/4-6/20	T - TH	4-8:45PM	SCC E173	S. RUSSELL	\$375
30114+	TED	408	61	ELEM METHODS IN ART/ MUSIC	2	6/3-6/19	M W	4-8:30PM	SCC E145	S. MERCER	\$250
30117+	TED	409A	61	ELEM METHODS IN PHYSICAL ED	1	6/4-6/20	T TH	4:30-8:30PM	GYM A 104	L. SKOW	\$135
30120+	TED	420	61	COMPUTER LIT FOR TCHRS	1	6/8-6/22	S	9AM-2PM	SCC E139	N. MACH	\$135
30121+	TED	420	62	COMPUTER LIT FOR TCHRS	1	6/24-7/10	M W	5-7:45PM	SOE 1117	P. DESBERG	\$135
30122+	TED	420	63	COMPUTER LIT FOR TCHRS	1	7/15-7/31	W	5-7:45PM	SOE 1117	P. DESBERG	\$135
30125+	TED	469	61	INTERDISCIPLINARY METHODS	3	6/4-6/20	T - TH	4-8:45PM	SCC E153	C. MCDERMOTT	\$375
30130	TED	494S	61	INDEPENDENT STUDY	1	6/3-6/21	TBA	TBA	TBA	STAFF	\$125
30131	TED	494S	62	INDEPENDENT STUDY	2	6/3-6/21	TBA	TBA	TBA	STAFF	\$250
30132	TED	494S	63	INDEPENDENT STUDY	3	6/3-6/21	TBA	TBA	TBA	STAFF	\$375
30133	TED	494S	64	INDEPENDENT STUDY	1	8/5-8/16	TBA	TBA	TBA	STAFF	\$125
30134	TED	494S	65	INDEPENDENT STUDY	2	8/5-8/16	TBA	TBA	TBA	STAFF	\$250
30135	TED	494S	66	INDEPENDENT STUDY	3	8/5-8/16	TBA	TBA	TBA	STAFF	\$375

HEALTH SHC A141 (310) 516-3818

30281	HEA	300	61	HEALTH IN PUBLIC EDUCATION	3	6/4-6/22	T TH S T TH	6-10PM S-6/8,6/15 S-6/22		P. KROCHALK	\$375
30029+	HEA	342	61	LOWER LIMB ORTHOTICS II (RESTRICTED ENROLLMENT)	3	6/3-8/9	T TH	2-5PM	SCC E149	D. CLARK	\$450
30030+	HEA	352	61	BELOW KNEE PROSTHETIC II (RESTRICTED ENROLLMENT)	3	6/3-8/9	T TH	8-11AM	SCCE149	STAFF	\$450

HUMANITIES LCH 338 (310) 516-3636

30142+	HUM	310	61	KEY CONCEPTS: FILM & PROPAGANDA	3	6/24-7/17	M T W	5:45-9:30PM	LCH A324	W. WELLS	\$375
30143+	HUM	314	61	KEY ISS: FRENCH PERSPECTIVES ON THE ENLIGHTENMENT	3	6/3-6/21	M - TH	1-4:30PM	LCH A230	C. CALOIA	\$375

INTENSIVES

#	Dept	Cr #	Sec	Title of Course	Units	Dates	Days	Hours	Room #	Instructor	Fee
INTERDISCIPLINARY STUDIES											
SBS B232 (310) 516-3640											
30249	IDS	326	61	SEXUALITY & GENDER IN COMPARATIVE PERSPECTIVE: US & CHINA	3	6/1-6/23	S SU	9AM-5:30PM	SBS A 144	L.POMERANTZ	\$375
30285	IDS	330	91	THE INDUSTRIAL REVOLUTION	3	6/3-7/10	M W	6:30-10PM	ERC E 127	D. HEIFETZ	\$504
PHYSICS											
NSM B202 (310) 516-3591											
30168+	PHY	108L	61	PHYSICAL SCIENCE II LAB	0	6/3-7/5	M T W	6-8:30PM	NSM C 243	H.K. LEE	\$0
				CO-REQ: PHY 108							
30167+	PHY	108	61	PHYSICAL SCIENCE II	3	6/3-7/5	M T W	4-5:45PM	NSM C243	H.K. LEE	\$450
				CO-REQ: PHY 108L							
PSYCHOLOGY											
SBS A336 (310) 516 - 3427											
30179	PSY	305	61	HISTORY & SYSTEMS PSYCH	3	6/24-7/11	M - TH	9AM-12:50PM	SBS B209	GRAY-SHELLBERG	\$375
30189+	PSY	563	61	SEMINAR IN PSYCHOPATHOLOGY	3	6/3-6/22	M W S			A. BOHART	\$375
								5:30-9:50PM			
								8:45-5PM	SAC 1103		
QUALITY ASSURANCE											
NSM C101 (310) 516-3880											
30468	QAS	515	61	HUMAN FACTORS IN QUAL ASSUR	3	6/1-7/25	M TH	N/A	N/A	E. WATSON	\$414
				<i>INTERNET COURSE. NOTE: PRIOR TO REGISTRATION, PLEASE CONTACT THE MSQA OFFICE AT (310) 516-3880</i>							
QUANTITATIVE METHODS											
SBS D321 (310) 516-3557											
30279+	QMS	502	61	ADV TOPICS IN OPERATIONS MGT	3	5/4-8/17	S	9AM-12PM	ERC A103	E. JEWELL	\$507
30280+	QMS	502	91	ADV TOPICS IN OPERATIONS MGT	3	5/4-8/17	S	9AM-12PM	ERC A103	E. JEWELL	\$597
SOCIAL & BEHAVIORAL SCIENCES											
NSM A115 (310) 516-3389											
30197	SBS	318	61	CULT PLUR: ETHNICITY & HEALTH	3	6/3-6/20	M - W	1-4:50PM	FH D003	S. ORELLANA	\$375
30200	SBS	318	62	CULT PLUR: MANAGING RACE & ETHNIC CONFLICT	3	8/5-8/23	M W F	6-9:50PM	SBS E220	WITHERSPOON / WHIPPLE	\$375
30365	SBS	318	63	CULT PLUR: EDUC SOC & LANG	3	5/31-6/14	F SA & SU	6-10PM 8AM-5:30PM	SBS A216	BRYAN	\$375
SCIENCE, MATH & TECHNOLOGY											
NSM B202 (310) 516-3376											
30248+	SMT	310	61	SCIENCE AND TECHNOLOGY	3	6/3-6/20	M - TH	9AM-12:50PM	NSM D129	G. WIGER	\$375
SPANISH											
LCH E307 (310) 516-3315											
30465	SPA	110	61	BEGINNING SPANISH	3	6/3-6/20	M - TH	9AM-12:50PM	LCH A227	J. CUERVO	\$375
30469	SPA	115	63	INTENSIVE BEGINNING SPANISH	6	7/1-8/9	M - TH	9AM-12:50PM	LCH A308	C. FERNANDEZ	\$750
30149	SPA	230	61	SPANISH CONVERSATION	3	6/3-6/20	M - TH	4-8PM	LCH A308	J. CUERVO	\$375
30153+	SPA	341	61	ADVANCED CONVERSATION	3	6/24-7/11	M - TH	9AM-12:50PM	LCH A227	F. LAUERHASS	\$375
30154+	SPA	400	61	TEACHING SCH SUBJECT MATTER	3	6/3-6/20	M - TH	4-8PM	SBS A204	M.DOMINGUEZ	\$375
30155+	SPA	494S	61	INDEPENDENT STUDY	3	7/1-8/9	TBA	TBA	TBA	J. CUERVO	\$375
THEATRE ARTS											
UTC A101 (310) 516-3588											
30156	THE	120	61	FUNDAMENTALS OF SPEECH	2	6/24-7/12	M - TH	1-3:30PM	UTA102	P. RODNEY	\$270
				CO-REQ: THE 120A							
30326	THE	120A	61	FUNDAMENTALS OF SPEECH	0	6/24-7/12	M - TH	1-3:30PM	UT A102	P. RODNEY	\$0
				CO-REQ: THE 120							
30157	THE	120	62	FUNDAMENTALS OF SPEECH	2	6/3-7/21	M - F	4-6PM	UTA102	S. WEINER	\$270
				CO-REQ: THE 120A							
30327	THE	120A	62	FUNDAMENTALS OF SPEECH	0	6/3-6/21	M - F	4-6PM	UT A102	S. WEINER	\$0
				CO-REQ: THE 120							
30158	THE	120	63	FUNDAMENTALS OF SPEECH	2	7/15-8/2	M - TH	1-3:30PM	UT A 102	P. RODNEY	\$270
				CO-REQ: THE 120A							
30328	THE	120A	63	FUNDAMENTALS OF SPEECH	0	7/15-8/2	M - TH	1-3:30PM	UT A102	P. RODNEY	\$0
				CO-REQ: THE 120							
30159	THE	320	61	SPEECH SKILLS & TECHNIQUES	3	6/3-6/21	M - TH	6-9:50PM	LCH A230	S. WEINER	\$375

FIRST SESSION

#	Dept	Cr #	Sec	Title of Course	Units	Dates	Days	Hours	Room #	Instructor	Fee
ACCOUNTING											
SBS D325 (310) 516-3556											
30048+	ACC	230	11	FINANCIAL ACCOUNTING	3	6/3-7/12	T TH	6-9:50PM	SBS D219	R. CHANG	\$375
30049+	ACC	231	11	MANAGERIAL ACCOUNTING	3	6/3-7/12	M W	6-9:50PM	SBS D219	M.AUERBACH	\$375
30050+	ACC	333	11	INCOME TAXATION I	3	6/3-7/12	T TH	6-9:50PM	SBS B203	EL-BADAWI	\$375
30051+	ACC	337	11	COST ACCOUNTING	3	6/3-7/12	M W	6-9:50PM	SBS E220	R. MAZHIN	\$375
ART											
LCH A111 (310) 516-3310											
30070	ART	101	11	EXPERIENCING CREATIVE ART	3	6/3-7/10	MW	3:45-7:30PM	LCH A115	B. BAKER	\$375
30348	ART	150A	11	CERAMICS I	3	6/3-7/12	MW	6-9:50PM	LCH A118	J. NEUWALDER	\$450
				CR LISTED: 30349 ART 361A-11 30021 ART 463A-11							
30021+	ART	463A	11	CERAMICS III	3	6/3-7/12	M W	6-9:50PM	LCH A118	J. NEUWALDER	\$450
30349+	ART	361A	11	CERAMICS II	3	6/3-7/12	MW	6-9:50PM	LCH A118	J. NEUWALDER	\$450
				CR LISTED: 30348 ART 150A-11 30021 ART 463A-11							
BEHAVIORAL SCIENCES											
SBS G326 (310) 516-3434											
30329+	BEH	525	11	DIVORCE MEDIATION	4	6/4-7/12	T TH	6-9:45PM	SAC 1101	R. MILLEN	\$500
30201+	BEH	531	11	DIVORCE & FAMILY MEDIATION	3	6/4-7/13	T TH	6-9:50PM	SAC 2107	B. CULP	\$375
30314	BEH	565	11	LONG TERM CARE FOR THE ELDERLY	3	6/4-7/9	T TH	6-10PM	SHC A145	E. WELLS	\$375
				CR LISTED: 30313 HEA 495-11							
30202+	BEH	595	11	SPE TPCS: NEGOTIATING CONTRACTS	3	6/3-7/12	M W	6-9:50PM	SAC 3135	G. WHALEY	\$375
BIOLOGY											
NSM A124 (310) 516-3381											
30330	BIO	120	11	PRINCIPLES OF BIOLOGY I	4	6/3-7/12	M W	9AM-12:50PM	NSM C 213	D. BREST	\$580
				CO-REQ: BIO 120L							
30331	BIO	120L	11	PRINCIPLES OF BIOLOGY I LAB	0	6/3-7/12	M W	1:30-5:PM	NSM B122	D. BREST	\$0
				CO-REQ: BIO 120							
30334+	BIO	250	11	ELEM HUM ANAT + PHYSIOL	3	6/3-7/12	T TH	9AM-12:50PM	NSM B252	J. THOMAS	\$375
30335+	BIO	251L	11	ELEM HUM ANAT PHYS LAB	1	6/3-7/12	T TH	1:30-5:PM	NSM C 121	J. THOMAS	\$235
30339+	BIO	374	11	DRUG ABUSE	3	6/3-6/12	T TH	9AM-12:50PM	SBS B231	R. GIACOSIE	\$375
BUSINESS ADMINISTRATION											
SAC 2149 (310) 516-3465											
30471+	BUS	445	11	INTERNATIONAL BUSINESS	3	6/3-7/12	M W	9AM-12:50PM	SBS F225	C. LOPILATO	\$375
30052+	BUS	595	11	SELECTED TOPICS IN BUSINESS	3	6/3-7/10	M W	6-9:50PM	SBS B203	J. BRITT	\$375
COMMUNICATIONS											
SAC 1166 (310) 516-3313											
30072	COM	100	11	MASS MEDIA & SOCIETY	3	6/3-7/10	M W	6-9:50PM	FH C008	E. WHETMORE	\$375
30073	COM	130	11	FILM CLASSICS	3	6/3-7/12	T TH	6-9:50PM	LCH A103	L. LEE	\$375
30077+	COM	250	11	NEWSWRITING FOR THE MEDIA	3	6/3-7/12	M W	9AM-12:50PM	FH B009	L. HESS	\$375
30074	COM	302	11	LAW OF THE MASS MEDIA	3	6/3-7/12	M W	8-11:50AM	FH C008	M. DAVIDSON	\$375
30076+	COM	496	11	INTERNSHIP/ COMMUNICATIONS	1	6/3-7/12	TBA	TBA	TBA	STAFF	\$125
COMPUTER INFORMATION SYSTEMS											
SBS A316 (310) 516-3579											
30212+	CSC	251	11	C LANG PROG AND UNIX	3	6/3-7/12	M W TH	5:30-8PM	NSM D123	STAFF	\$405
EDUCATION											
SOE RM 1010 (310) 516-3519											
GRADUATE EDUCATION											
SOE RM 1010 (310) 516-3524											
30161+	GED	460	11	INTRO TO EXCEPT CHILD	3	6/3-7/10	MW	4-7:30PM	SBS B231	P. PATTERSON	\$375
30031	GED	500	11	RESEARCH METH IN EDU	3	6/3-7/12	MW	6-9:50PM	SAC 1101	F. FISHER	\$375
30022	GED	501	11	SEM IN LEARN & DEV	3	6/3-7/10	MW	5-8:50PM	SCC K144	J. JACKSON	\$375

FIRST SESSION
JUNE 3 - JULY 12

FIRST SESSION

#	Dept	Cr #	Sec	Title of Course	Units	Dates	Days	Hours	Room #	Instructor	Fee
GRADUATE EDUCATION - CONTINUED											
30024	GED	508	11	SEMINAR IN ISSUES IN EDUC	3	6/3-7/10	MW	6-9:50PM	LCH A221	K. MCCOY	\$375
30025	GED	513	11	LITERATURE FOR CHILD & ADOLESCENTS	3	6/4-7/11	T TH	6-9:50PM	LCH A221	K. MCCOY	\$375
30026	GED	525	11	BIL/ MULT TEACHING METHODS	3	6/3-7/12	M W	4:30-6:45PM	SBS B 101	S. THOMPSON	\$375
30023+	GED	560	11	SPH/ LANG DEV DISORD/RDMED	3	6/4-7/11	T TH	5-8:50PM	SCC E167	J. JACKSON	\$375
30036+	GED	566S	11	PRACTICUM: DIRECTED TCHG W/ SEVERELY HANDICAPPED	5	6/3-7/12	M - F	8AM-3PM	LCH A348	D. OKADA	\$950
30166+	GED	568	11	CURRI INST LRNG HNDICP	3	6/3-7/10	M W	4:30-8PM	SBS A144	K. SKINDRUD	\$375
30028	GED	581	11	PRINC OF ED PSY: ASSESSMENT	3	6/3-7/11	T TH	4-8PM	SOE 1104	D. SHERBA	\$375
30037	GED	582	11	GRP DYNMICS FOR PERS GRWTH	3	6/4-7/11	T TH	6-9:50PM	LCH A225	R. LEE	\$375
30041	GED	594S	11	INDEPENDENT STUDY	3	6/3-7/12	TBA	TBA	TBA	M. CONTRERAS	\$375

TEACHER EDUCATION SOE ROOM 1010 (310) 516-3522

30093	TED	304	11	FOUNDATIONS IN EDUCATION	1	6/4-7/11	T TH	4-5:10PM	SBS F121	J. BRAUN	\$125
30099	TED	305S	11	INTRO TO URBAN/ MULTICUL	1	6/3-7/10	M W	4-7:30PM	SCC 11305	S. MCCRAY	\$125
30094+	TED	402	11	MOTIVATION AND LEARNING	2	6/4-7/11	T TH	5:25-7:45PM	SBS F121	J. BRAUN	\$250
30107+	TED	403	11	TEACHING READING/LANG. ARTS	3	6/3-7/10	M W	4-7:30PM	SBS G122	P. GONZALES	\$375
30100+	TED	415	11	MULTICULT PERSPECTIVE TCHRS	2	6/3-7/10	M W	4-7:30PM	SCC 11305	S. MCCRAY	\$250

PHYSICAL EDUCATION SAC 1138 (310) 516-3761

30015	PED	494S	11	PHYS ED INDEPENDENT STUDY	1	6/3-7/12	TBA	TBA	TBA	A. MARICH	\$125
30016	PED	494S	12	PHYS ED INDEPENDENT STUDY	2	6/3-7/12	TBA	TBA	TBA	A. MARICH	\$250
30017	PED	494S	13	PHYS ED INDEPENDENT STUDY	3	6/3-7/12	TBA	TBA	TBA	A. MARICH	\$375
30018+	PED	496S	11	INTERNSHIP IN PHYSICAL ED	1	6/3-7/12	TBA	TBA	TBA	A. MARICH	\$125
30020+	PED	496S	13	INTERNSHIP IN PHYSICAL ED	3	6/3-7/12	TBA	TBA	TBA	A. MARICH	\$375

ENGLISH LCH E315 (310) 516-3322

30079+	ENG	110	11	FRESHMAN COMP I	3	6/3-7/12	MW	9AM-12:50PM	LCH A221	S. MCMURRAY	\$375
30080+	ENG	111	11	FRESHMAN COMP II	3	6/3-7/12	MW	1-4:50PM	LCH A221	S. MCMURRAY	\$375
30084+	ENG	325	11	POETRY	3	6/3-7/12	MW	1-4:50PM	LCH A219	R. WARKENTIN	\$375
30085+	ENG	326	11	PROSE FICTION	3	6/3-7/12	T TH	1-4:50PM	LCH A228	S. WATERWORTH	\$375
30086+	ENG	341	11	AMERICAN LIT. 1865-PRESENT	3	6/3-7/12	T TH	9AM-12:50PM	LCH A324	W. WELLS	\$375
30087+	ENG	350	11	ADVANCED COMPOSITION	3	6/3-7/12	MW	6-9:50PM	LCH A219	R. WARKENTIN	\$375
30088+	ENG	350	12	ADVANCED COMPOSITION	3	6/3-7/12	T TH	1-4:50PM	LCH A219	L. SMITH	\$375
30090+	ENG	352	11	WRIT & SPKG SKILLS MGMT	3	6/3-7/12	MW	9AM-12:50PM	LCH A324	W. WELLS	\$375
30091+	ENG	352	12	WRIT & SPKG SKILLS MGMT	3	6/3-7/12	T TH	1-4:50PM	LCH A224	T. GIANNOTTI	\$375
30219+	ENG	494S	11	INDEPENDENT STUDY	1	6/3-7/12	TBA	TBA	TBA	STAFF	\$125
30220+	ENG	494S	12	INDEPENDENT STUDY	2	6/3-7/12	TBA	TBA	TBA	STAFF	\$250
30221+	ENG	494S	13	INDEPENDENT STUDY	3	6/3-7/12	TBA	TBA	TBA	STAFF	\$375
30361+	ENG	590	11	SEMINAR IN LITERATURE	3	6/3-7/12	T TH	6-9:50PM	LCH A224	T. GIANNOTTI	\$375
30225	ENG	594S	11	INDEPENDENT STUDY	3	6/3-7/12	TBA	TBA	TBA	STAFF	\$375
30226	ENG	594S	12	INDEPENDENT STUDY	2	6/3-7/12	TBA	TBA	TBA	STAFF	\$250
30227	ENG	594S	13	INDEPENDENT STUDY	3	6/3-7/12	TBA	TBA	TBA	STAFF	\$375

FINANCE SBS D324 (310) 516-3501

30053+	FIN	360	11	BUSINESS FINANCE	3	6/3-7/12	T TH	9AM-12:50PM	SBS B203	M. BLYN	\$375
30054+	FIN	480	11	ECONOMICS OF THE FIRM	3	6/3-7/12	M W	6-9:50PM	SBS A216	H. MILGRIM	\$375

GEOGRAPHY NSM B202 (310) 516-3376

30207	GEO	360	11	NORTH AMERICA	3	6/4-7/11	T - TH	6-8:30PM	NSM C239	S. KOLETTY	\$375
-------	-----	-----	----	---------------	---	----------	--------	----------	----------	------------	-------

HEALTH SHC A141 (310) 516-3818

30313	HEA	495	11	SPEC TPCS: LONG TERM CARE/ ELDERLY 3 CR LISTED: 30314 BEH 565-11	3	6/4-7/9	T TH	6-10PM	SHC A 145	E. WELLS	\$375
-------	-----	-----	----	---	---	---------	------	--------	-----------	----------	-------

HISTORY SBS A326(310) 516-3446

30174	HIS	111	11	WESTERN WORLD: MODERN EXPERIENCE	3	6/3-7/11	M - TH	6-9:50PM	SAC 2105	D. CADY	\$375
30171	HIS	301	11	INDIVI FAM & COM HIS PRESP	3	6/4-7/11	T - TH	2-4:30PM	SBS G126	R. PERKINS	\$375
30172	HIS	341	11	CALIFORNIA	3	6/4-7/11	T - TH	6-8:30PM	SBS D 121	R. PERKINS	\$375
30173	HIS	395	11	SPE TPCS IN HIS CHRISTIANITY: THE FIRST FOUR CENTURIES	3	6/3-7/12	M W	9AM-12:50PM	SBS A210	C. UDEZE	\$375

FIRST SESSION

#	Dept	Cr #	Sec	Title of Course	Units	Dates	Days	Hours	Room #	Instructor	Fee
HUMANITIES											
LCH 338 (310) 516-3636											
30139+	HUM 200	11		INTRO TO THE HUMANITIES	3	6/3-7/12	T TH	9AM-12:50PM	LCH A 219	H. HOLTER	\$375
30141+	HUM 310	11		KEY CONCEPTS: MYTH AS REALITY	3	6/3-7/12	M W	6-10PM	LCH A224	L. SMITH	\$375
30363+	HUM 310	12		KEY CONCEPTS: LIVES OF FAUST	3	6/3-7/12	MW	9AM-12:50PM	LCH A219	J. NACHEF	\$375
30144+	HUM 314	11		KEY ISS: INTRNATIONAL FILM: ART, IMAGE, REALITY	3	6/8-7/13	S	9AM-4PM			
						S-6/8-SCC E153		9AM-4PM		W.L. LEE	\$375
						S-6/15, 22 & 29		9AM-4PM	LCH A103		
						S7/6-13		9AM-4PM	LCH A103		
MATHEMATICS											
NSM A132 (310) 516-3378											
30251	MAT 005	11		ELEM. ALGEBRA & GEOMETRY	3	6/3-7/12	M - TH	9-11:30AM	SBS D219	STAFF	\$375
30252+	MAT 009	11		ALGEBRA	3	6/3-7/12	M - TH	9-11:30AM	FH D003	S. HUNIU	\$375
30254+	MAT 105	11		FINITE MATHEMATICS	3	6/3-7/12	T TH	6-9:50PM	SAC 1103	G. KALLO	\$375
30257+	MAT 131	11		ELEM STAT & PROBABILITY	3	6/3-7/12	T TH	9AM-12:50PM	SBS A216	STAFF	\$375
30261+	MAT 153	11		COLLEGE ALGEBRA & TRIGNMTRY	4	6/3-7/12	M W	6-9:20PM	SBS F121	STAFF	\$500
30259+	MAT 207	11		GEOM. FOR ELEM SCHL TCHER	3	6/3-7/12	T -TH	5-8:20PM	NSM C213	H. ANDERSON	\$405
MARRIAGE & FAMILY COUNSELING											
SBS G322 (310) 516-3435											
30191	MFC 576	11		HUMAN COMMUNICATION	3	6/4-7/11	T TH	1-4:50PM	SBS B231	H. CHARNOFSKY	\$375
30192	MFC 580	11		CROSS CULTURAL FAMILY VALUES AND BEHAVIOR	3	6/4-7/11	T TH	6-9:50PM	SBS A144	H. CHARNOFSKY	\$375
MANAGEMENT											
SBS D322 (310) 516-3551											
30055+	MGT 312	11		ORGANIZATIONAL BEHAVIOR	3	6/3-7/10	M W	9:50AM-12:50PM	SBS B203	B. CHRISPIN	\$375
30056+	MGT 490	11		STRATEGIC MGT SEMINAR	3	6/3-7/11	T TH	6-9:50PM	SBS E122	R. DOWLING	\$375
30247+	MGT 490	12		STRATEGIC MGT SEMINAR	3	6/3-7/10	M W	1-4:50PM	SBS B 203	J. BRITT	\$375
MARKETING											
SBS D325 (310) 516-3552											
30057+	MKT 350	11		PRINCIPLES OF MARKETING	3	6/3-7/12	M W	9AM-12:50PM	SBS A144	C. ZOERNER	\$375
30058+	MKT 350	12		PRINCIPLES OF MARKETING	3	6/3-7/12	T TH	6-9:50PM	SBS B143	J. KITSON	\$375
MUSIC											
LCH E303 (310) 516-3543											
30466+	MUS 120A	11		BEGINNING VOICE CLASS	1	6/10-7/8	M	1-4PM	TBA	J. NACHEF	\$135
30467+	MUS 220A	11		INTERMEDIATE VOICE CLASS	1	6/10-7/8	M	1-4PM	TBA	J. NACHEF	\$135
30286+	MUS 494S	11		INDEPENDENT STUDY	1	6/3-7/12	TBA	TBA	TBA	D. CHAMPION	\$125
30287+	MUS 494S	12		INDEPENDENT STUDY	2	6/3-7/12	TBA	TBA	TBA	D. CHAMPION	\$250
30288+	MUS 494S	13		INDEPENDENT STUDY	3	6/3-7/12	TBA	TBA	TBA	D. CHAMPION	\$375
30289+	MUS 496S	11		MUSIC INTERNSHIP	1	6/3-7/12	TBA	TBA	TBA	D. CHAMPION	\$125
30290+	MUS 496S	12		MUSIC INTERNSHIP	2	6/3-7/12	TBA	TBA	TBA	D. CHAMPION	\$250
30291+	MUS 496S	13		MUSIC INTERNSHIP	3	6/3-7/12	TBA	TBA	TBA	D. CHAMPION	\$375
30292+	MUS 594S	11		INDEPENDENT STUDY	1	6/3-7/12	TBA	TBA	TBA	D. CHAMPION	\$125
30293+	MUS 594S	12		INDEPENDENT STUDY	2	6/3-7/12	TBA	TBA	TBA	D. CHAMPION	\$250
30294+	MUS 594S	13		INDEPENDENT STUDY	3	6/3-7/12	TBA	TBA	TBA	D. CHAMPION	\$375
PHILOSOPHY											
LCH A342 (310) 516 - 3328											
30145	PHI 120	11		CRITICAL REASONING	3	6/3-7/11	M - TH	4-5:55PM	SBS A213	K. KATSENIS	\$375
POLITICAL SCIENCE											
SBS G 326 (310) 516 - 3434											
30175	POL 101	11		AMERICAN INSTITUTIONS	3	6/3-7/12	M W	6-9:50PM	SAC 2107	A. FISHER	\$375
PSYCHOLOGY											
SBS A336 (310) 516 - 3427											
30177+	PSY 235	11		INTRO TO RESEARCH METHODS	3	6/4-7/11	T TH	9AM-2PM	SBS A 232	D. HENSCHEL	\$405
						CO-REQ: PSY 235L					
30178+	PSY 235L	11		INTRO RESEARCH METHODS LAB	0	6/4-7/11	T TH	9AM-2PM	SBS A 232	D. HENSCHEL	\$0
						CO-REQ: PSY 235					
30182	PSY 360	11		THEORIES OF PERSONALITY	3	6/3-7/10	MW	9AM-12:50PM	SBS B131	D. HENSCHEL	\$375
30183	PSY 382	11		PSYCHOLOGICAL DEVELOPMENT OF THE BLACK CHILD	3	6/8-7/13	S	9AM-5:20PM	SBS B131	R. DAVIS	\$375

FIRST SESSION
JUNE 3 - JULY 12

FIRST SESSION

#	Dept	Cr #	Sec	Title of Course	Units	Dates	Days	Hours	Room #	Instructor	Fee
PSYCHOLOGY - CONTINUED											
30184+	PSY	396	11	PRACTICUM IN PSYCHOLOGY	3	6/6-7/11	TH	6-9:50PM	SBS F225	R. DAVIS	\$375
				CO-REQ: PSY 396S							
30186+	PSY	396S	11	PRACTICUM IN PSYCHOLOGY	0	6/6-7/11	TH	6-9:50PM	SBS F225	R. DAVIS	\$0
				CO-REQ: PSY 396							
30187+	PSY	490	11	SENIOR SEMINAR IN PSYCH: POST TRAUMATIC STRESS DISORDER	3	6/3-7/12	MW	1-4:50PM	SBS D219	A. HASS	\$375
30188+	PSY	496	11	INTERNSHIP	6	6/6-7/11	TH	6-9:50PM	SBS F225	R. DAVIS	\$750
				CO-REQ: PSY 496S							
30284+	PSY	496S	11	INTERNSHIP	0	6/6-7/11	TH	6-9:50PM	SBS F225	R. DAVIS	\$0
				CO-REQ: PSY 496							

PUBLIC ADMINISTRATION

SBS D311 (310) 516-3444

30059	PUB	301	11	ADMIN LEADERSHIP AND BEH	3	6/3-7/11	T TH	5-8:50PM	SBS E220	J. BELL WATERS	\$375
30060	PUB	304	11	ADMIN OF PUBLIC POLICY	3	6/3-7/13	MW	6-9:50PM	SBS G126	F. SMITH	\$375
30061+	PUB	305	11	APPLIED STATS IN PUB ADM	3	6/3-7/12	T TH	6-9:50PM	SBS G126	J. SHIANG	\$375
30461+	PUB	594S	11	INDEPENDENT STUDY	4	6/3-7/12	TBA	TBA	TBA	D. KARBER	\$500
30462+	PUB	599S	11	HONORS THESIS	4	6/3-7/12	TBA	TBA	TBA	D. KARBER	\$500

QUALITY ASSURANCE

NSM C101 (310) 516-3880

30352+	QAS	514	11	ADV EXPERIMENTAL DESIGN	3	6/3-7/12	TH	6-9PM	SAC 3141	D. DUNAHAY	\$375
30263+	QAS	516	11	MEASUREMENT & TESTING TCHNS	3	6/3-7/12	T TH	6-9PM	ANAHEIM	E. WATSON	\$414
30351	QAS	594S	11	IND STUDY ASSURANCE SCIENCE	3	6/3-7/12	S	9AM-2PM	SAN DIEGO	STAFF	\$597
30266+	QAS	595	11	SPE TPCS:BY DIR STUDY:QAS APPL	3	6/3-7/12	TBA	TBA	SAN DIEGO	W. TRAPPEN	\$597

QUANTITATIVE METHODS

SBS D321 (310) 516-3557

30473+	QMS	322	11	PRODUCTION MANAGEMENT	3	6/3-7/12	M W	9AM-12:50PM	SBS B231	M. NASHIF	\$375
30474+	QMS	423	11	INT TO OPERATIONS RESEARCH	3	6/3-7/12	M W	6-9:50PM	SBS B137	F. REZAYAT	\$375

RECREATION

SAC 1138 (310) 516- 3761

30046+	REC	494S	11	INDEPENDENT STDY: RECREATION	3	6/3-7/12	TBA	TBA	TBA	M. CAPPEL	\$375
--------	-----	------	----	------------------------------	---	----------	-----	-----	-----	-----------	-------

SOCIAL & BEHAVIORAL SCIENCES

NSM A115 (310) 516-3389

30193	SBS	318	11	CULT PLUR: PSYCH HIS/HLCAUST	3	6/3-7/12	M W	9AM-12:50PM	SBS A216	A. HASS	\$375
30194	SBS	318	12	CULT PLUR: AMERICANIZATION AND HISTORY	3	6/3-7/12	T TH	9AM-12:50PM	SBS A210	C. UDEZE	\$375
30195	SBS	318	13	CULT PLUR: ETHNIC POLITICS	3	6/3-7/12	T TH	6-9:50PM	SBS G122	A. FISHER	\$375
30196	SBS	318	14	CULT PLUR: CULT DIV IN SO CAL	3	6/4-7/11	T TH	6:30-10:20PM	SANTA MONICA	D. HEIFETZ	\$375

SOCIOLOGY

SBS B334 (310) 516-3431

30205	SOC	320	11	THE FAMILY	3	6/8-7/13	S	9AM-5PM	SBS E220	S. CARRIGAN	\$375
30217	SOC	365	11	DEVIANT BEHAVIOR	3	6/2-7/12	T TH	1-4:50PM	SBS A144	S. FELLOWS	\$375
30012+	SOC	494S	11	INDEPENDENT STUDY	3	6/3-6/12	TBA	TBA	TBA	F. HOSOKAWA	\$375
30013+	SOC	494S	12	INDEPENDENT STUDY	1	6/3-6/12	TBA	TBA	TBA	F. HOSOKAWA	\$125
30218	SOC	563	11	SEMINAR DRUG & ALCOHOL USE	3	6/4-7/12	T TH	9AM-12:50PM	SBS A144	S. FELLOWS	\$375

SPANISH

LCH E307 (310) 516-3315

30150+	SPA	305	11	ADV COMP, SYNTAX, STYLISTICS	3	6/3-7/12	M W	4-7:50PM	SAC 2103	L. WATTS	\$375
30151+	SPA	305	12	ADV COMP, SYNTAX, STYLISTICS PHONETIC SYSTEM	3	6/3-7/11	M T TH	2-4:30PM	LCH A229	F. LAUERHASS	\$375
30152	SPA	314	11	SPANISH PHONOLOGY	3	6/3-7/12	T TH	4-7:50PM	SAC 2103	L. WATTS	\$375
30147	SPA	115	11	INTENSIVE BEGINNING SPANISH	6	6/3-7/12	M-TH	4-7:50PM	SAC 2101	J. ARANCIBIA	\$750

THEATRE ARTS

UTC A101 (310) 516-3588

30160	THE	337	11	CREATIVE DRAMATICS	3	6/3-7/11	M W	9AM-12:50PM	UT A 102	W. DELUCA	\$375
-------	-----	-----	----	--------------------	---	----------	-----	-------------	----------	-----------	-------

SECOND SESSION

#	Dept	Cr #	Sec	Title of Course	Units	Dates	Days	Hours	Room #	Instructor	Fee
ART											
LCH A111 (310) 516-3310											
30071	ART	101	21	EXPERIENCING CREATIVE ART	3	6/25-8/1	T TH	3:45-7:30PM	LCH A115	B. BAKER	\$375
BEHAVIORAL SCIENCES											
SBS G326 (310) 516-3434											
30014	BEH	597S	21	DIRECTED READING	3	6/24-8/2	TBA	TBA	TBA	F.HOSOKAWA	\$375
30204	BEH	597S	22	DIRECTED READING	3	6/24-8/2	TBA	TBA	TBA	H.CHARNOFSKY	\$375
BIOLOGY											
NSM A124 (310) 516-3381											
30332	BIO	102	21	GENERAL BIOLOGY	3	6/24-8/2	MW	9-11:30AM	NSM D129	R. GIACOSIE	\$450
											CO-REQ: BIO 102L
30333	BIO	102L	21	GENERAL BIOLOGY LAB	0	6/24-8/2	MW	12:30-3:30PM	NSM B110	R. GIACOSIE	\$0
											CO-REQ: BIO 102
BUSINESS ADMINISTRATION											
SAC 2149 (310) 516-3465											
30472+	BUS	445	21	INTERNATIONAL BUSINESS	3	6/24-8/2	T TH	6-9:50PM	SBS B137	P. BASSEER	\$375
COMMUNICATIONS											
SAC 1166 (310) 516-3313											
30078+	COM	250	21	NEWSWRITING FOR THE MEDIA	3	6/24-8/2	T TH	9AM-12:50PM	FH B009	L. HESS	\$375
30075	COM	302	21	LAW OF THE MASS MEDIA	3	6/24-8/2	MW	12-3:50PM	FH D003	M. DAVIDSON	\$375
COMPUTER INFORMATION SYSTEMS											
SBS A316 (310) 516-3579											
30210+	CSC	121	21	INTRO TO CSC AND PROGRAM I	4	6/24-8/2	M - TH	11:30AM-1:20PM	SBS E 116	Z. KHWAJA	\$540
											CO-REQ: CSC 121A
30211+	CSC	121A	21	INTRO TO CSC PROGRAM I-ACT	0	6/24-8/2	T TH	2-4:20PM	SBS A110	Z. KHWAJA	\$0
											CO-REQ: CSC 121
30215+	CSC	453	21	DATA MANAGEMENT	3	6/24-8/2	MW TH	11AM-1:30PM	SBS G 126	W. WONG	\$405
ENGLISH											
LCH E315 (310) 516-3322											
30081+	ENG	308	21	CRIT APPRCH TO CHILDREN'S LIT	3	6/24-8/2	MW	1-4:50PM	LCH A228	S. WATERWORTH	\$375
30082+	ENG	314	21	ENGLISH SYNTAX--TRADITIONAL	3	6/24-8/2	T TH	1-4:50PM	LCH A221	K. ZOU	\$375
30083+	ENG	314	22	ENGLISH SYNTAX--TRADITIONAL	3	6/24-8/2	T TH	6-9:50PM	LCH A230	K. ZOU	\$375
30089+	ENG	350	21	ADVANCED COMPOSITION	3	6/24-8/2	MW	6-9:50PM	LCH A223	S. WATERWORTH	\$375
30092+	ENG	352	21	WRIT &SPKG SKILLS MGMT	3	6/24-8/2	T TH	6-9:50PM	LCH A228	C. BETAR	\$375
30222+	ENG	494S	21	INDEPENDENT STUDY	1	6/24-8/2	TBA	TBA	TBA	STAFF	\$125
30223+	ENG	494S	22	INDEPENDENT STUDY	2	6/24-8/2	TBA	TBA	TBA	STAFF	\$250
30224+	ENG	494S	23	INDEPENDENT STUDY	3	6/24-8/2	TBA	TBA	TBA	STAFF	\$375
30228	ENG	594S	21	INDEPENDENT STUDY	1	6/24-8/2	TBA	TBA	TBA	STAFF	\$125
30229	ENG	594S	22	INDEPENDENT STUDY	2	6/24-8/2	TBA	TBA	TBA	STAFF	\$250
30230	ENG	594S	23	INDEPENDENT STUDY	3	6/24-8/2	TBA	TBA	TBA	STAFF	\$375
EDUCATION											
SOE RM 1010 (310) 516-3519											
GRADUATE EDUCATION											
SOE RM 1010 (310) 516-3524											
30350	GED	500	21	RESEARCH METHODS IN EDUC	3	6/24-8/2	T TH	5-8:50PM	LCH A229	J. COOPER	\$375
30032	GED	501	21	SEM IN LEARN & DEV	3	6/25-8/1	T TH	4-7:50PM	SBS A 216	T. RICHARDSON	\$375
30362	GED	530	21	INTRO TO ASSIST TECHNOLOGY	3	6/24-8/2	T TH	4-7:50PM	COSTA MESA	L. BELKIN	\$375
30275	GED	535	21	INTRO TO COMPUTERS IN EDUC	3	6/24-8/2	MW	1-4:30PM	SCC E153	P. DESBERG	\$405
30353	GED	558	21	CLASSRM MGT EXCEPT CHILD	3	6/25-8/1	T TH	4:30-8PM	SBS B209	M. TAJAIMA	\$375
30033+	GED	559S	21	GENERIC PRAC EXCEPT CHILD	4	6/24-8/2	M-F	8AM-12:30PM	LCH A348	D. OKADA	\$760

SECOND SESSION
JUNE 24-AUGUST 2

SECOND SESSION

#	Dept	Cr #	Sec	Title of Course	Units	Dates	Days	Hours	Room #	Instructor	Fee
30165+	GED	562	21	ADV BEH MGT METH IND SED	3	6/25-8/1	T TH	4:30-8PM	LCH A223	M. LIEBERMAN	\$375
30164+	GED	563	21	COUNS VOC TRANSIT ED DIS	3	6/25-8/1	T TH	4:30-8PM	LCH A227	STAFF	\$375
30163+	GED	569S	21	PRAC: DIR TCHG LEARN HNDCP	5	6/24-8/2	M - F	8AM-3PM	SCC E167	STAFF	\$950
30038+	GED	588	21	SEM: INTERVENTION STRATEGIES	3	6/24-7/31	M W	4-7:50PM	LCH A230	T. RICHARDSON	\$375
30043	GED	594S	21	INDEPENDENT STUDY	3	6/24-8/2	TBA	TBA	TBA	M. CONTRERAS	\$375
30044+	GED	597S	21	FIELDWORK COUNSELING	3	6/25-8/1	T	2:45-3:45PM	TBA	T. RICHARDSON	\$570
30045+	GED	598S	21	FIELD WORK SCHOOL PSYCH	3	6/27-8/1	TH	2:45-3:45PM	TBA	T. RICHARDSON	\$570

TEACHER EDUCATION SOE ROOM 1010 (310) 516-3522

30101	TED	305S	21	INTRO TO URBAN /MULTICUL	1	6/24-7/31	M W	1-4:30PM	SBS B131	STAFF	\$125
30104	TED	305S	22	INTRO TO URBAN /MULTICUL	1	6/25-8/1	T TH	5-8:45PM	SBS B140	STAFF	\$125
30110	TED	405	21	INSTRMING CHLD SPC NEED	3	6/24-7/31	M W	5-8:30PM	SAC 1103	STAFF	\$375
30111+	TED	406	21	TEACHING SECONDARY READING	3	6/25-8/1	T TH	5-8:30PM	SCC E145	P. TEDESCO	\$375
30113	TED	407	21	LANGUAGE LEARNING	3	6/24-7/31	M W	5-8:30PM	SBS A204	STAFF	\$375
30115+	TED	408	21	ELEM METHODS IN ART / MUSIC	2	6/24-7/31	M W	5-7:30PM	SCC E145	S. MERCER	\$250
30116+	TED	409A	21	ELEM METHODS IN PHYSICAL ED	1	6/25-8/1	T TH	5-7:30PM	GYM A104	L.SKOW	\$135
30118	TED	410	21	ELEMENTARY MATH METHODS	2	6/25-8/1	T TH	9:30AM-12:15PM	SCC K144L	L. NEUBERGER	\$250
30126	TED	410	22	ELEMENTARY MATH METHODS	2	6/25-8/1	T TH	5-7:45PM	SOE 1107	STAFF	\$250
30127+	TED	412	21	EL SOC STUD/CONT READ/WRIT	2	6/24-7/31	M W	5-7:30PM	SOE 1107	STAFF	\$250
30128+	TED	412	22	EL SOC STUD/CONT READ/WRIT	2	6/25-7/31	T TH	5-7:45PM	SCC 11305	STAFF	\$250
30102+	TED	415	21	MULTIC PERSPECTIVE TCHRS	2	6/24-7/31	M W	1-4:30PM	SBS B131	STAFF	\$250
30105+	TED	415	22	MULTIC PERSPECTIVE TCHRS	2	6/25-8/1	T TH	5-8:45PM	SBS B140	STAFF	\$250
30119+	TED	416	21	ELEMENTARY SCIENCE METHODS	2	6/25-8/1	T TH	1:15-4PM	SCC K144	L. NEUBERGER	\$250
30129+	TED	416	22	ELEMENTARY SCIENCE METHODS	2	6/24-7/31	M W	5-7:30PM	SCC E149	STAFF	\$250
30123	TED	445S	21	FIELDWORK: ELEMENTARY	6	6/24-8/2	M - F	TBA	TBA	C. MCDERMOTT	\$960
30124+	TED	465S	21	FIELDWORK: SECONDARY	6	6/24-8/2	M - F	TBA	TBA	K. TAIRA	\$960
30103+	TED	467	21	TEACH METH I: SECONDARY	3	6/25-8/1	T TH	1-4:30PM	SCC 11305	S. PRESCOTT	\$375
30136	TED	494S	21	INDEPENDENT STUDY	1	6/24-8/2	TBA	TBA	TBA	STAFF	\$125
30137	TED	494S	22	INDEPENDENT STUDY	2	6/24-8/2	TBA	TBA	TBA	STAFF	\$250
30138	TED	494S	23	INDEPENDENT STUDY	3	6/24-8/2	TBA	TBA	TBA	STAFF	\$375

PHYSICAL EDUCATION SAC 1138 (310) 516-3761

30019	PED	496S	21	INTERNSHIP IN PHYSICAL ED	2	6/24-8/2	TBA	TBA	TBA	A. MARICH	\$250
-------	-----	------	----	---------------------------	---	----------	-----	-----	-----	-----------	-------

GEOGRAPHY NSM B202 (310) 516-3376

30170	GEO	100	21	EARTH THE HUMAN HOME I	3	6/24-8/1	M -TH	11:30AM-1:25PM	SBS A204	M. RENFREW	\$375
-------	-----	-----	----	------------------------	---	----------	-------	----------------	----------	------------	-------

HUMANITIES LCH 338 (310) 516-3636

30140+	HUM	200	21	INTRO TO THE HUMANITIES	3	6/24-8/2	M W	9AM-12:30PM	LCH A223	P. RODNEY	\$375
--------	-----	-----	----	-------------------------	---	----------	-----	-------------	----------	-----------	-------

MATHEMATICS NSM A132 (310) 516-3378

30234	MAT	005	21	ELEM. ALGEBRA & GEOMETRY	3	6/24-8/2	M W TH	6-8:30PM	SAC 3148	STAFF	\$375
30253+	MAT	009	21	ALGEBRA	3	6/24-8/2	M W TH	6-8:30PM	FH D003	STAFF	\$375
30255+	MAT	105	21	FINITE MATHEMATICS	3	6/24-8/2	M W	9AM-12:50PM	SBS G122	STAFF	\$375
30256+	MAT	107	21	MATH FOR ELM TEACH: RL NUMB	3	6/24-8/2	T TH	5-8:20PM	SAC 3142	J. WILKINS	\$375
30258+	MAT	131	21	ELEM STAT & PROBABILITY	3	6/24-8/2	M W	6-9:50PM	LCH A229	S. BOOK	\$375
30273+	MAT	171	21	CALC FOR MGT LIFE SCIENCE	4	6/24-8/2	T - TH	6-9:20PM	SCC E173	STAFF	\$500
30260+	MAT	191	21	CALCULUS I	4	6/24-8/2	T-TH	6-9:20PM	ERC C112	S. KRINSKY	\$500
30274+	MAT	193	21	CALCULUS II	4	6/24-8/2	M - TH	9-11:30AM	NSM D123	STAFF	\$500
30250+	MAT	497S	21	INDEPENDENT STUDY	3	6/24-8/2	TBA	TBA	TBA	G. HART	\$375

MUSIC LCH E303 (310) 516-354

30295+	MUS	494S	21	INDEPENDENT STUDY	1	6/24-8/2	TBA	TBA	TBA	D. CHAMPION	\$125
30296+	MUS	494S	22	INDEPENDENT STUDY	2	6/24-8/2	TBA	TBA	TBA	D. CHAMPION	\$250
30297+	MUS	494S	23	INDEPENDENT STUDY	3	6/24-8/2	TBA	TBA	TBA	D. CHAMPION	\$375
30298+	MUS	496S	21	MUSIC INTERNSHIP	1	6/24-8/2	TBA	TBA	TBA	D. CHAMPION	\$125
30299+	MUS	496S	22	MUSIC INTERNSHIP	2	6/24-8/2	TBA	TBA	TBA	D. CHAMPION	\$250
30300+	MUS	496S	23	MUSIC INTERNSHIP	3	6/24-8/2	TBA	TBA	TBA	D. CHAMPION	\$375
30301+	MUS	594S	21	INDEPENDENT STUDY	1	6/24-8/2	TBA	TBA	TBA	D. CHAMPION	\$125
30302+	MUS	594S	22	INDEPENDENT STUDY	2	6/24-8/2	TBA	TBA	TBA	D. CHAMPION	\$250
30303+	MUS	594S	23	INDEPENDENT STUDY	3	6/24-8/2	TBA	TBA	TBA	D. CHAMPION	\$375

SECOND SESSION

#	Dept	Cr #	Sec	Title of Course	Units	Dates	Days	Hours	Room #	Instructor	Fee
PHILOSOPHY											
LCH A342 (310) 516 - 3328											
30146	PHI	120	21	CRITICAL REASONING	3	6/24-8/1	M - TH	6-7:55PM	SBS A210	K. KATSENI	\$375
POLITICAL SCIENCE											
SBS G 326 (310) 516 - 3434											
30176	POL	354	21	AMERICAN POLITICAL THOUGHT	3	6/24-8/2	M - TH	2-3:55PM	SBS A 204	J. KAPLAN	\$375
PSYCHOLOGY											
SBS A336 (310) 516 - 3427											
30180	PSY	101	21	GEN. ST: UNDERSTAND HUM BEH	3	6/24-8/1	M W	1-4:50PM	SBS A216	GRAY-SHELLBERG	\$375
30181	PSY	350	21	DEVELOPMENTAL PSYCHOLOGY	3	6/24-7/31	M W	1-4:50PM	SBS E220	J. TODD	\$375
30185+	PSY	464	21	INTRO TO CLINICAL PSYCH	3	6/24-8/3	T TH	6-9:50PM	SBS B 101	A. BOHART	\$375
30190	PSY	567	21	INDIVIDUAL ASSESSMENT	3	6/24-7/31	M W	6-9:50PM	SBS E122	J. TODD	\$405
CO-REQ: PSY 567A											
30338	PSY	567A	21	INDIVIDUAL ASSESSMENT	0	6/24-7/31	M W	6-9:50PM	SBS E122	J. TODD	\$0
CO-REQ: PSY 567											
RECREATION											
SAC 1138 (310) 516-3761											
30047+	REC	494S	21	INDEPENDENT STDY: RECREATION	3	6/24-8/2	TBA	TBA	TBA	M. CAPPEL	\$375
SOCIAL & BEHAVIORAL SCIENCES											
NSM A115 (310) 516-3389											
30198	SBS	318	21	CULT PLUR: OF THE AFRICAN AMERICAN WORLD	3	6/25-8/2	T TH	9AM-12:50PM	SBS B101	K. PERSON-LYNN	\$375
30199	SBS	318	22	CULT PLUR: INTNL PERSPECTIVE	3	6/25-8/2	T TH	1-4:50PM	SBS B101	R. HOVARD	\$375
SOCIOLOGY											
SBS B334 (310) 516-3431											
30208	SOC	315	21	SOC OF WORK CR LISTED: 30364 SOC 595-21	3	6/25-8/2	T TH	6-9:50PM	SAC 3135	R. HOVARD	\$375
30206	SOC	325	21	SOCIOLOGY OF RELIGION	3	6/25-8/1	T TH	6-9:30PM	SBS A204	D. ROBERTSON	\$375
30209	SOC	395	21	SPE TPCS: SEX ROLES & SOCIETY	3	6/24-7/31	M W	6-9:30PM	SAC 3142	D. ROBERTSON	\$375
30231+	SOC	494S	21	INDEPENDENT STUDY	1	6/24-8/2	TBA	TBA	TBA	R. HOVARD	\$125
30232+	SOC	494S	22	INDEPENDENT STUDY	3	6/24-8/2	TBA	TBA	TBA	R. HOVARD	\$375
30364+	SOC	595	21	SPEC TPCS: SOC OF WORK CR LISTED: 30364 SOC 315-21	3	6/25-8/2	T TH	6-9:50PM	SAC 3135	R. HOVARD	\$375
30366	SOC	596	21	PRACTICUM IN TEACHING SOC	3	6/24-8/2	TBA	TBA	TBA	R. HOVARD	\$375
30267+	SOC	597S	21	DIR READING	1	6/24-8/2	TBA	TBA	TBA	R. HOVARD	\$125
30268+	SOC	597S	22	DIR READING	3	6/24-8/2	TBA	TBA	TBA	R. HOVARD	\$375
30269+	SOC	598S	21	DIR RESEARCH	1	6/24-8/2	TBA	TBA	TBA	R. HOVARD	\$125
30270+	SOC	598S	22	DIR RESEARCH	3	6/24-8/2	TBA	TBA	TBA	R. HOVARD	\$375
30271+	SOC	599S	21	GRAD CAPSTONE	1	6/24-8/2	TBA	TBA	TBA	R. HOVARD	\$125
30272+	SOC	599S	22	GRAD CAPSTONE	3	6/24-8/2	TBA	TBA	TBA	R. HOVARD	\$375
SPANISH											
LCH E307 (310) 516-3315											
30148	SPA	115	21	INTENSIVE BEGINNING SPANISH	6	6/24-8/2	M-TH	4-7:50PM	LCH A308	I. GAMINDE	\$750

SECOND SESSION
JUNE 24-AUGUST 2

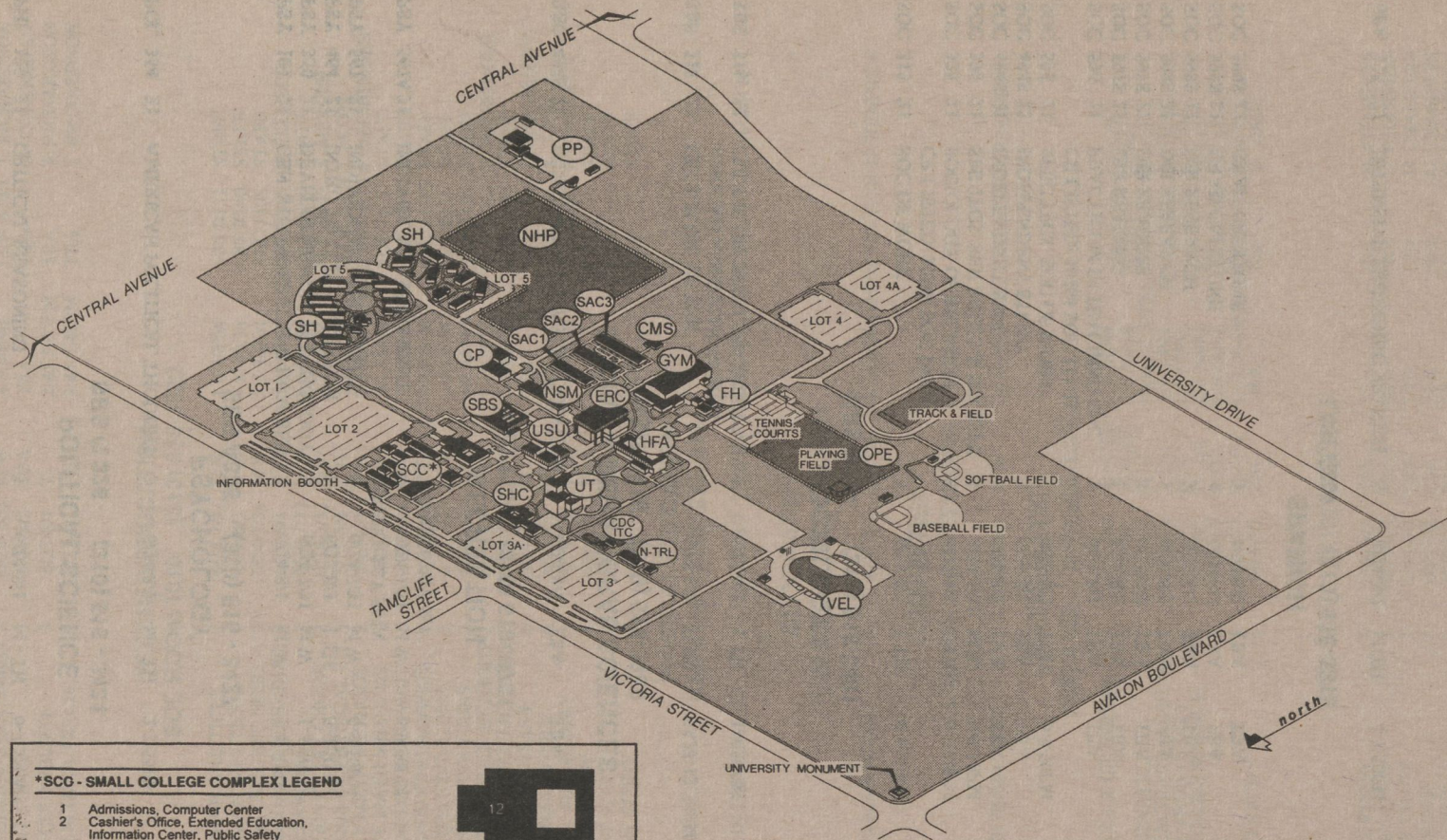

***SCG - SMALL COLLEGE COMPLEX LEGEND**

- 1 Admissions, Computer Center
- 2 Cashier's Office, Extended Education, Information Center, Public Safety
- 3 Advising Center
- 4 Educational Opportunity Program
- 5 Enrollment Services, Financial Aid, International Students, Student Affirmative Action, Student Development (Career and Counseling Center), Testing Classrooms, Student Computer Lab
- 6 Classrooms
- 7 Classrooms
- 8 Classrooms
- 9 Classrooms
- 10 (Future Site 1994) Orthotics and Prosthetics Program
- 11 (Future Site 1994) Learning Assistance Center, Talent Search, Testing, Women's Center
- 12 (Future Site 1994) School of Education
- 13 Registrar: Records and Registration

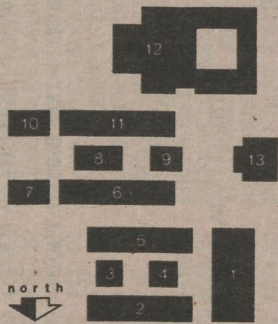

UNIVERSITY GENERAL LEGEND

- | | |
|--|---|
| CDC - CHILD DEVELOPMENT CENTER | SAC1 - SOUTH ACADEMIC COMPLEX 1
Department and Faculty Offices |
| CMS - THE CALIFORNIA ACADEMY OF MATHEMATICS AND SCIENCE LABORATORIES | SAC2 - SOUTH ACADEMIC COMPLEX 2
The California Academy of Mathematics and Science, Faculty Offices |
| CP - CENTRAL UTILITY PLANT | SAC3 - SOUTH ACADEMIC COMPLEX 3
The California Academy of Mathematics and Science |
| ERC - CAIN EDUCATIONAL RESOURCES CENTER
Central Administrative Offices, Instructional Media, TV Studios, University Library | SBS - SOCIAL AND BEHAVIORAL SCIENCES |
| CP - CAIN EDUCATIONAL RESOURCES CENTER
Central Administrative Offices, Instructional Media, TV Studios, University Library | SCC - SCHOOL OF MANAGEMENT, SHINWA JAPANESE GARDEN |
| FH - FIELD HOUSE (Athletics) | SH - STUDENT HOUSING |
| GYM - GYMNASIUM | SHC - STUDENT HEALTH CENTER
Disabled Students Center, Health Services and Psychological Counseling, Veterans Affairs |
| HFA - HUMANITIES AND FINE ARTS
School of Education | USU - DONALD P. AND KATHERINE B. LOKER
UNIVERSITY STUDENT UNION
Bookstore, Food Service, Dining and Meeting Facilities, Recreation, Associated Students, Inc., Student Activities |
| ITC - INFANT TODDLER CENTER | UT - UNIVERSITY THEATRE |
| NHP - NATURAL HISTORY PRESERVE | VEL - 7-ELEVEN OLYMPIC VELOCROME |
| NSM - NATURAL SCIENCES AND MATHEMATICS | |
| N-TRL - NURSING TRAILER (Temporary)
School of Health, Statewide Nursing Program | |
| OPE - OUTDOOR PHYSICAL EDUCATION | |
| PP - PHYSICAL PLANT
Receiving Warehouse | |

KELLYGRAPHICS 1993

Summer Sessions 1996

Registration Form

Social Security No: _____ **Birthdate:** _____ **Date of Application** _____
 month/day/year
Name: _____
 Last First M.I.
Address: _____
 Street City State Zip
Telephone: _____
 Daytime Evening FAX
 New Address? yes no male female Enrolled at CSUDH previously? yes no

SCHEDULE #	DEPARTMENT	COURSE	SECTION	UNITS	COURSE FEE	CONSENT INSTRUCTOR/DEPT

Check/Money Order, Made Payable to CSUDH
 I AUTHORIZE THE USE OF MY Visa MasterCard

NAME ON CARD _____

ACCOUNT NUMBER _____ EXP DATE _____
 I have read and understand the rules in the Summer Sessions Bulletin regarding registration, course prerequisites, refund policy and withdrawal policy, and I authorize the use of credit card number if entered above.

Signature: _____

Date: _____

Course Fee _____

Student Activity Fee _____ 3.00
(Mandatory)

Student Center Fee _____ 10.00
(Mandatory)

ITFS Fee _____

Late Fee _____

TOTAL FEE SUBMITTED _____

HOW TO REGISTER



MAIL OR WALK IN:
 CSU DOMINGUEZ HILLS,
 EXTENDED EDUCATION,
 SCC B141, 1000 EAST VICTORIA STREET
 CARSON, CA 90747-0005

FAX
 REGISTRATION:
 (310) 516-3971



CALL (310) 516-3741 FOR MORE INFORMATION

ISN'T IT TIME YOU JOINED THE PARTY?

Learn about the wonders of the Internet with courses through CSUDH Extension while you:

- Enhance your computer skills
- Earn one of 3 Internet Business & Marketing Certificates
- Take advantage of research resources
- Keep in contact with distant friends
- Pursue a new interest and make new friends on-line

Unlock your potential for world-wide communication!

Call the CSUDH Office of Extended Education at (310) 516-3741 for more information today!



2-415



California State University
Dominguez Hills

SUMMER SESSIONS OFFICE

1000 East Victoria Street
Carson, CA 90747

Non Profit
Organization
U.S. POSTAGE
PAID
Permit No.246
Gardena, CA