

CALIFORNIA STATE UNIVERSITY DOMINGUEZ HILLS

Summer Sessions 2000

First Session

Monday, June 5 - Friday, July 14

Second Session

Monday, June 26 - Friday, August 4

Third Session

Monday, July 17 - Friday, August 25

CSUDH
40
1960
2000
California State University
Dominguez Hills



DIVISION OF EXTENDED EDUCATION

A
Midsummers'
Night
Dream

Summer Sessions 2000

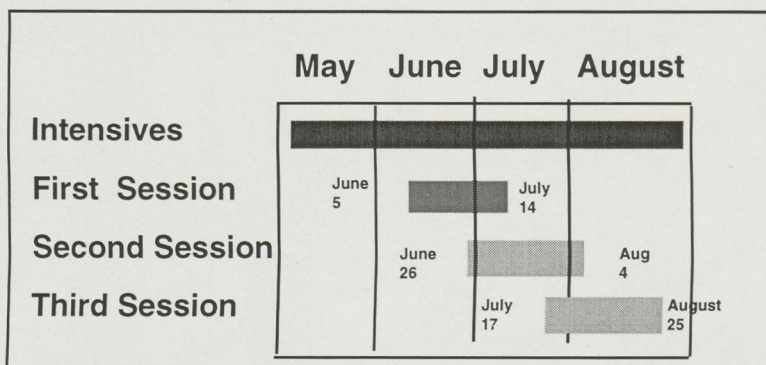

Summer Sessions Information:

(310) 243-3741

Fax (310) 516-3971

www.csudh.edu/extendeded

Summer Sessions Office

California State University

Dominguez Hills, EE 1100

1000 East Victoria Street

Carson, CA 90747

Main University Admissions

(310) 243-3600

(Formal application to the University is not necessary to attend Summer Sessions classes)

Financial Aid

(310) 243-3647

Housing

(310) 243-4228

Parking

(310) 243-3725/3639

**Cover: Bob Schuchman
Illustration, Redondo Beach**

Note: The Summer Sessions Bulletin is printed by the Division of Extended Education at no expense to taxpayers. Every effort is made to ensure the accuracy of this Bulletin. However, the information in this Bulletin is subject to change without notice.

Summer Sessions Calendar	6
Registration & Tuition	7
Who May Register	7
How to Register	7
Late Registration	7
Tuition & Fees	7
Add/Drop/Withdrawal	8
Adding a Course	8
Dropping a Course	8
Dropped Course Fee	8
Withdrawal	9
Refund Policy	9
Refund of Tuition Fee	9
Refund of Parking Fee	10
Academic Information	10
Summer Sessions Office	10
Maximum Student Load	10
General Studies	10
Advisement for Summer	10
School of Management	10
Advisement Center	10
Course Numbering System	11
High School Students	11
Grade Reports/Transcripts	11
Audit	11
Credit/No Credit Grading	11
Independent Study	11
Final Examinations	11
Entry Level Mathematics	11
Requirement	11
Student Services	12
University Bookstore	12
Disabled Student Services	12
University Library	12
Information Center	12
Testing Office	12
Cafeteria and Food Service	12
Health Programs &	12
Psychological Testing	12
Activities Office/Student Union	12
Parking	13
University Housing	13
ESL/American Language &	17
Culture Program	17
CalNet	19
Schedule of Courses	20
Map	32

QUICK REFERENCE! Touch-Tone Registration

	1
Summer Calendar	6
General Information	3
Schedule of Classes	16
Map	32

Registration Form
Inside Back Cover

3 Separate Sessions!

Summer Session I

Monday, June 5 - Friday, July 14

Start your summer studies early: take a course you need or take a pre-requisite course now and follow up with another course during Summer Session III.

Summer Session II

Monday, June 26 - Friday, August 4

Concentrate your studies in mid-summer.

Summer Session III

Monday, July 17 - Friday, August 25

Take a class in Session III for late summer studies or combine with a class in Session I for almost an entire semester of credits in just a few weeks' time!

Intensive classes are available all summer long!

See each section in the schedule of classes to find the courses you need to fulfill requirements or quench your thirst for knowledge!

Touch Tone Registration is here!

T.O.R.O.S. -- DIVISION OF EXTENDED EDUCATION TOUCHTONE REGISTRATION SYSTEM

Telephone Registration Systems (T.O.R.O.S.):

Registration	(310) 516-3409-3416	Register
		Add Classes
		Drop Classes
		Waitlist
		Review your schedule
		Check course availability

Additional Telephone Information System Applications

Financial Aid	(310) 243-3647	Status of Application
		Documents outstanding
		Documents received
		Loan processing
		Check disbursement

Grade Reporting	(310) 243-2308	Term Grades
		GPA
		Academic Standing

SUMMER TOUCHTONE REGISTRATION DATES

1st Session: April 3-June 4 • 2nd Session: April 3-June 25 • 3rd Session: April 3-July 16

Touchtone will be up between 6am-midnight, Monday-Saturday. If you need additional assistance, you may select the option to transfer to an operator during office hours.

Welcome to T.O.R.O.S., the Division of Extended Education at California State University Dominguez Hills Touchtone Registration and Billing System. During the Fall and Spring semesters, you may register and drop courses by Touchtone up to the day before the course begins. During the Winter and Summer Sessions, you may register and drop courses only up to the day before the session begins. Touchtone Registration for Extended Education courses is available only to students paying in FULL at the time of registration by credit card, and/or students with approved Financial Aid Award from CSUDH. You may pay by VISA, DISCOVER CARD, OR MASTERCARD. You will receive written confirmation of your registration within seven days from the date of registration.

Failure to pay in full for your classes at the time of registration may result in the immediate cancellation of your courses. If a Third Party pays your fees, please call (310) 243-3741 to register and make payment arrangements. All continuing students and students who have prior records at CSUDH are eligible to register via Touchtone. If you are enrolling for the first time at CSUDH, please call the Division of Extended Education at (310) 243-3741 to register if paying by credit card. First time enrollees may register by mailing their registration forms to the address provided in the catalog or by faxing their registration to (310) 516-3971. Access to grades and GPA information is now available on a separate line. Please call (310) 516-4308 to listen to your grades.

T.O.R.O.S. Checklist

- √ Read the information and instructions in your catalog.
- √ Note enrollment restrictions, prerequisite and co-requisite requirements.
- √ Complete the Registration Worksheet before attempting to register.
- √ Prepare a list of alternate sections in case your first choice classes are not available.
- √ Call T.O.R.O.S. (310) 516-3409 -3416 from any Touchtone telephone.
- √ Change your PIN (for security reasons).
- √ Make your entries permanent before exiting the system. Failure to do so will result in cancellation of your course requests.
- √ Refer to the "Troubleshooting" section if you encounter difficulty.
- √ Call back to add, waitlist, drop or review your schedule at any time after registering for your courses.
- √ Check your account balance to confirm that your payment has been received and credited to your account.

Student Identification Number (SID)

Your 9-digit Social Security Number is your Student Identification number.

Personal Identification Number

Your personal identification Number is your birth date (DDMMYY). For example, if you were born on April 12, 1972, your initial PIN number will be 041272. You are urged to change your PIN for security reasons and to keep your PIN in a safe place. Do not write your PIN in your Class Schedule. You may change your PIN by dialing T.O.R.O.S. and making the appropriate selection at the main menu. The recorded voice will guide you.

Holds

Students must clear holds at the appropriate office:

Admissions Hold: Admissions And Records Office, SCC J-103 (310) 243-3600

Financial Aid Hold: Financial Aid Office, SCC- 138A (310) 243-3647

Financial Hold: Cashier's Office, SCC B-135 (310) 243-3812

Library hold: Library ERC B-226, (310) 243-3712

Billing: Accounting Services (310) 243-3803

Extended Education Hold: Division of Extended Education (310) 243-3741

Humanities/External Degree Hold: Division of Extended Education (310) 243-3741

T.O.R.O.S. Information Making your Entries

Permanent: It is very important to make your entries permanent before exiting T.O.R.O.S. Failure to do so will result in cancellation of your request(s).

Co-requisites: Some courses require concurrent enrollments in laboratory or activity sections as well as in lecture or seminar sections, or concurrent enrollment in one or more other courses. Failure to add/waitlist both or all co-requisites will result in being dropped from your original request.

Enrollment restrictions: Some courses are restricted to students in specific degree programs, to specific class levels (e.g. seniors) or to certain student levels (e.g. graduates).

Some departments may choose not to print course reference numbers (CRN's) in the Course Listing section of the Class Schedule in order to screen students for eligibility. Other courses may not be available through T.O.R.O.S. but may be added with the instructor's approval.

Students who are not eligible for restricted courses may be able to obtain approval from the department in special circumstances. A signature of approval must be obtained from the appropriate department representative

Time conflicts: T.O.R.O.S. checks for time conflicts and will not allow registration in classes meeting at the same time. Students with permission from both instructors to enroll in classes with time conflicts will need to register in-person.

Full classes: If you attempt to register for a class that is already full, you will be given two options:

- 1) to check for open sections of the same course.
- 2) to place yourself on a waitlist for the requested section.

In order to secure a seat in the class, it is recommended that you check for open sections first and register for an open section, if any. If no open sections exist, you may wish to place yourself on a waitlist for the full section of your choice.

Cancelled classes: If you register for a course that is subsequently cancelled, you will receive written notification from the Division of Extended Education and should register for an alternate class or section as soon as possible. If you do not wish to enroll for an alternate class, you will be automatically issued a full refund for the canceled class.

Schedule adjustment/Schedule review: Remember, you may call back any time during the Registration period to change or review your schedule. If you choose to exchange one class for another, add the new class before dropping the other class (unless you have reached the maximum enrollment limit.)

11 STEPS TO REGISTER

Step 1

Call T.O.R.O.S. @ (310) 516-3409 through 3416.

Step 2

Press 1 for registration information.

Step 3

Press 1 to register for classes.

Step 4

Enter your 9-digit Student I.D. Number (Social Security Number).

Step 5

Enter PIN (personal I.D. number). Your PIN Number is your birth date (MMDDYY). Example: 041272 (April 12, 1972).

Step 6

Press 1 to register or drop classes, or 2 to review your schedule or 9 to return to main menu.

Step 7

If you entered 1 in Step 6, select one of the following options:

- √ Press 1 to add (go to step 8) or,
- √ Press 2 to drop.
- √ Press 3 to make your entries permanent (REQUIRED FOR ALL REGISTRATIONS AND DROPS).
- √ Press 4 to check course availability.
- √ Press 5 to list (review) your current schedule.
- √ Press 9 to return to main menu.

Step 8

Enter Course Reference Numbers from your registration worksheet. T.O.R.O.S. will announce the course and section. T.O.R.O.S. will prompt you to enter additional course reference numbers, or enter * and # to end this option and return to the previous menu (1 to add, 2 to drop, 3 to make your entries permanent and pay by credit card, etc.).

Step 9

If the course is full, Press 1 to Check for Open Sections or 2 to Waitlist.

Step 10

When you have entered all your Course Reference Numbers, press the * key followed by the # key to return to step 7. Press 3 to make your entries permanent. Do not hang up without completing this step. Failure to make your entries permanent will result in the cancellation of your registration and in losing all your entries. Stay on the line until the system completes this step and confirms the courses you are enrolled in. Once completed, press 1.

Step 11

If you have finished adding classes, press the * key and the number 6 to go back to the main menu. YOU MUST NOW PAY FOR YOUR COURSES BY CREDIT CARD. FAILURE TO PAY IN FULL FOR YOUR COURSES WILL RESULT IN THE IMMEDIATE CANCELLATION OF ALL YOUR COURSE ENTRIES. To proceed, press 2.

- √ To end this call at any time, press the * key followed by the 9 key.
- √ To return to the selections you heard at the beginning of the call, press the * followed by the 6 key.
- √ To have a prompt or selection repeated, press the * key followed by the 7 key. √ For menu help, press the * key followed by the 4 key at any time

Important Information:

Whenever you adjust your schedule, call back and review your schedule. Verify your entries against your worksheet. Verify your worksheet against the Schedule of Classes. You are responsible for dropping any unwanted courses and ensuring that you are properly registered.

Waitlist Instructions

Follow steps 1 - 6.

At step 7, press 1 to Register or Add. If the course is full, you will hear:

Example: "Ted 411, section 72, course request number 12345 is closed. To check for open sections of this course, press 1. A waiting list is open for this course; there are currently _ people on the waitlist. If you would like to be put on the waitlist, press 2, otherwise press 3."

Press 1 to check for open sections of the course and register for an alternate section if possible, to maximize your enrolled units. If you decide to register for an alternate section, follow steps 9 and 10.

If there are no available alternate sections or if you choose not to register for one, press the * star key followed by the # pound key to go back to the previous menu. You are now back at step 8.

To waitlist your first choice section:

At step 7, press 1 to Register or Add. Follow Step 9.

Press 2 to Waitlist.

You will hear:

Example: " When you make

your entries permanent, you will be waitlisted for TED 411, section 72, course request number 12345." Complete your registration and follow step 10. You will not be on the Waitlist if you do not to make your entries permanent.

Note: After the third invalid entry or if there are system problems, you will be transferred to an operator for help. For additional assistance, call the Registration help line (310) 243-3741.

Mon - Thu.....8am-6pm
Fri.....8am-5pm
Sat8am-1:30pm

Credit Card Payment Instructions

Press 1 for Account Balance. Select the term for which you would like billing information. Enter your nine digit Student ID Number (social security number).

Enter your Personal Identification Number (PIN).

1. Press 1 to review your balance (the current account balance will be spoken).

2. Press 2 to pay by credit card. Select type of credit card you will use to pay:

Press 1 for Visa.

Press 2 for MasterCard.

Press 3 for Discover Card

3. Enter your credit card number (The number you have entered will be spoken back for verification).

Press 1 if the number repeated is correct.

Press 2 if the number is incorrect and reenter the credit card number.

4. Enter your credit card Expiration Date ((The expiration date you have entered will be spoken back for verification)

Press 1 if the expiration date repeated is correct.

Press 2 if the expiration date is incorrect and reenter the expiration date.

5. Select the amount you wish to pay.

Press 1 to pay the full amount you currently owe.

Press 1 if the amount entered is repeated correctly.

Press 2 to enter a different amount.

The system will place you on hold while your credit card is authorized. The system will inform you that your credit card has been accepted and will instruct you to hold while your payment is applied to your account. If you credit card is denied, you may start over with a different credit card. (Note: you will need to contact your credit card issuer if you wish to find out why your card has been denied.)

When the payment is applied to your account, the system will indicate the remaining amount due for the account, if any. Press 9 to exit the main menu.

Troubleshooting

√ Can't access T.O.R.O.S.?

Check you are dialing the correct number. Are you using a true touch tone telephone? Not all push-button telephones are touchtone. Further, programmable telephones using the "#" or "*" key in programming cause access problems. Try another phone. To register while on campus, you may use the campus pay phones or the courtesy phones located throughout the campus.

√ T.O.R.O.S. not available?

Check date and hours of operation. If the system is not available during scheduled hours, try again later.

√ Busy signal? All lines are busy: Try again later.

√ Made a mistake?

Do not hang up: Wait for the recorded voice to prompt you.

√ Not able to register for a specific course?

Check for footnotes in the course offerings section. The course may:
 1) be full. Select Option 4 to listen to alternate open sections or place yourself on the waitlist;
 2) be a duplicate section of a course in which you are already registered;
 3) have a conflict with another course in which you are already registered;
 4) be restricted to certain majors, class levels or student levels;

5) require screening in the department (CRN may not be printed);
 6) require one or more co-requisite sections.

√ Unable to get on a Waitlist?

Check to make sure course is closed. You may only waitlist for courses that are closed or that are open with existing waitlists.

HELPLINE

If you need assistance with registration, call (310) 243-3741 during the following hours:

Mon-Thu.....8am-6pm
 Friday.....8am-5pm
 Sat.....8am-1:30pm

Registration Worksheet

Use the grids below to plan your registration and avoid time conflicts

First Choices

	Course Reference No	Course	Sec	Units	Days					
					M	T	W	Th	F	S
Example	12345	Ted 420	71	3	8-8:50		8-8:50		8-8:50	
1										
2										
3										
4										
5										
6										
7										
8										

Alternate Choices

	Course Reference No	Course	Sec	Units	Days					
					M	T	W	TH	F	S
1										
2										
3										
4										
5										
6										
7										
8										

Summer Sessions 2000 Calendar

IMPORTANT DATES:	SESSION I	SESSION II	SESSION III
Registration begins	April 3	April 3	April 3
Mail-in Registration deadline	May 12	June 2	June 23
Courses begin	June 5	June 26	July 17
Regular Registration deadline	June 5	June 26	July 17
Last day to return books	June 12	June 26	July 17
Late Registration (\$25 fee assessed)	June 6 -June 16	June 27-July 7	July 18-28
Last day to ADD a course	June 16	July 7	July 28
Last day to request CREDIT/NO CREDIT option	June 16	July 7	July 28
Last day to DROP/WITHDRAW without "W" on record	June 16	July 7	July 28
Holiday, campus closed	July 4	July 4	
Last Day to Drop/Withdraw	July 7	July 22	August 12

NOTE: INTENSIVE COURSE DATES VARY: Check listings

How to Use This Schedule of Classes

Look in all sections, Session I, Session II, Session III & Intensives for classes in **Alphabetical order by department.**

See the regular **University Catalog** for specific prerequisite information.

CRN # Course Reference
Number (you need this number to register for this particular course)

Department Abbreviation and course #

Units Class Days Class Hours Instructor Fee

Crn Dept Sec COURSE TITLE Units Days Hours Room # Instructor Fee

30117 CHE 302 61 Organic Chemistry II 3.0 MTW 5:00-10:15pm NSM C221 J Lyle

Co-req: CHE 303L 07-JUL-00 thru 07-AUG-00

(Note: some classes require co-requisites)

Session & Section #
(1=Session I, 2=Session 2, 0=Session 3, 6= Intensive)

Course Title (refer to university catalog for course description), prerequisites & co-requisites

Class Dates

Location on campus (building abbreviation and room number)

Who May Register

College students, graduates of high school, or individuals sufficiently knowledgeable to profit from college courses may register for Summer Sessions. High school juniors and seniors, with letters of recommendation, may enroll in lower-division courses (see details on page 11).

If you are a visiting student, it is especially important that you read the section on classification and numbering of courses. Descriptions of the courses are available in the University Catalog found in the University Bookstore.

Registration in CSUDH Summer Sessions courses does not constitute admission to the University as a regular student. If you are interested in admission to the University, inquire or apply at the University Information and Service Center, Small College Complex A-130, (310) 243-3696.

How to Register

Registration in CSUDH Summer Sessions is simple, and in most cases can be completed entirely through a mail-in procedure. Formal application to the University is not necessary, and transcripts are not required. Some Summer Sessions courses, however, have prerequisites or special qualifications which are noted in the Schedule of Courses. In certain cases, before the request to register can be processed, permission to enroll in a course must be obtained from the instructor or department office, or students may be asked to provide proof of completion of prerequisites. To attend Summer Sessions classes, registration for courses must be completed, including full payment of fees, by the appropriate deadline dates (refer to Calendar on page 2). If you are registering for both Summer Sessions and University Extension courses, please use separate registration forms and write separate checks.

To Register By Mail:

Complete the Summer Sessions



Registration Form on the inside back cover of this Bulletin and mail it to:

**CSU Dominguez Hills
Summer Sessions Office, EE 1100
1000 East Victoria
Carson, CA 90747**

Include your check, money order or credit card information; do not send cash. The deadline for Mail-in Registration is May 12, for the First Session, June 2 for the Second Session and June 23 for the Third Session (see calendar, page 6).

To Register By Fax:



FAX your complete Summer Sessions Registration Form (inside back cover) and your credit card information to (310) 516-3971.

To Register in Person:

You can register in person at the Summer Sessions Office located on the CSU Dominguez Hills campus, EE 1100. The Summer Sessions Office



accepts checks, money orders, Visa and MasterCard. Hours are 8am-6pm Monday-Thursday, 8am-5pm Friday and 8am-1:30pm Saturdays.

Late Registration

(For adding courses to a program, see ADD Instructions.)

The late registration period begins June 6, and concludes June 16 for the First Session. Late registration begins June 27 and concludes July 7 for the Second Session. Late registration for the Third Session begins July 18 and concludes July 28. Completion of late registration is dependent upon availability of seats for each class and is subject to a \$25.00 late registration processing fee.

Non Standard Date or Intensive Courses

In order to register for a course which begins after the first week of any session, the student must complete the late registration procedure by the second day of this class.

Tuition

Total course fees are listed in the Schedule with the course information. Some courses, such as laboratory or activity courses, have higher costs and may have fees that are higher than the standard instructional fee.

Standard instructional /lecture fee per unit	\$140
Special course fee	as listed

Fees

Student activity (pay once per summer)	\$3.00
Student Union (pay once per summer)	\$10.00
Late registration	\$25.00
Returned check	\$25.00
Transcript	\$4.00 each
Lab fees	varies

Fees and refunds are subject to change by the Trustees of the California State University. Full payment of all tuition and fees must be made at the time of registration or adding a course. Payment of tuition and fees may be made by check, money order and Visa or MasterCard. Checks and money orders are payable to CALIFORNIA STATE UNIVERSITY, DOMINGUEZ HILLS. Until total fees are paid, registration is not valid.

Where to Obtain a Money Order

7-Eleven
17920 Avalon (Avalon & Victoria)
Carson
Open 24 hrs., 7 days a week

Postal Annex
603 East University Dr. Ste. B, Carson
M-F 8am-6pm, Sat 10am-4pm

Crown Drugs
657 University Dr., Carson
M-Sat 9am-7:45pm
Sun 9am-6:30pm

Nortrica's Market
20226 Avalon, Carson
M-Sun 8am-10pm

Parking

All vehicles, including motorcycles, parked on this campus, must have a valid parking decal. Single entry parking permits can be obtained for \$2.00 from a yellow vending machine near the entrance of each general parking lot. Restricted parking areas are enforced at all times. Parking decal's are available at the Cashier's Office (SCC B135). Parking can only be purchased with cash or by check.

Fees subject to change

Entire Summer auto decal	\$42.00
Each Summer Session	\$25.00
Short term, per week	\$5.00
Two-wheeled vehicle	\$9.00
Single entry machines	\$2.00

Returned Checks

All returned checks, whether for insufficient funds or stop payments, are considered to be enforceable debts, and are subject to a \$25.00 fee*. If your check is returned, your registration will not be processed.

*Subject to change

Adding Courses

To add a course before the start of the session, submit your completed Add / Drop form and the additional tuition to the registrar in the Summer Sessions Office.

To add a course after the start of the session, you must file a Change of Program form available in the Summer Sessions Office and have it signed by the professor for the class you want to add.

Six-week courses may be added during the first two weeks of the session. Students wishing to add an Intensive of one week or less may only add on the first day of class. For two to three-week courses they may only add during the first two days, and for four to five-week courses students may only add during the first week of the course.

The deadline for adding courses is June 16 for the First Session, July 7 for the Second Session, and July 28 for the Third Session. Provided that you are enrolled in a Summer Sessions course at the time you choose to add an additional course, you will not be charged a late fee.

Students may exchange one class for another within the same session without penalty, if the unit and tuition value is the same.

If you will exceed a maximum unit load by adding courses, you must also submit a Petition to Exceed Maximum Units, available in the Summer Sessions Office (refer to policy on Maximum Unit Load).

Dropping / Withdrawing

Non-attendance in class, notifying the instructor, or stopping payment on a check does NOT officially constitute dropping or withdrawing from a course. The Summer Sessions Office must be notified and appropriate form must be filed.

Dropping a Course

If you decide to drop a course, you must file a Change of Program form with the Summer Sessions Office. (if you are dropping all courses you enrolled in, follow withdrawal procedures.) Refer also to Refund Policies.

Drop, prior to first day of session.

To drop a six-week course before a session begins, file a Change of Program form and an application for Refund of Fees in the Summer Sessions Office.

Drop, during the first two weeks of the session.

Summer Sessions students may drop or withdraw from any six-week course prior to and during the first two weeks of a session without permanent record of enrollment or "W" on transcript, and without the instructor's signature.

Drop, third through fifth weeks of the session.

During the third and until the final week of the six-week session, the instructor's and the school dean's or associate dean's signatures for each course are required on the Change of Program form in order to drop. Non-matriculated or Summer-only students need the signatures of the instructor and the Dean of Extended Education.

If a student drops or withdraws after the second week of a six-week session, a grade of "W" for the course(s) will appear on the student's permanent transcript.

Courses less than 1 week

Prior to the first class meeting a student may withdraw and no grade is assigned: the enrollment does not appear on the student's permanent transcript. An administrative grade of "W" will be assigned if a student withdraws at any time during the course.

One Week Courses

During the first day of the week a student may withdraw and no grade is assigned: the enrollment does not appear on the student's permanent

transcript. An administrative grade of "W" will be assigned if a student withdraws at any time after the first day of the week.

Two-Week Courses

During the first three days of the first week a student may withdraw and no grade is assigned; the enrollment does not appear on the student's permanent transcript. An administrative grade of "W" will be assigned if a student withdraws at any time after the first three days of the first week.

Three-Week Courses

During the first week a student may withdraw and no grade is assigned; the enrollment does not appear on the student's permanent transcript. Prior to the last two days of the session a student may withdraw with a "W". During the last two days of the session a student may withdraw with a "W" for serious and compelling reasons only.

Four and Five-Week Courses

During the first week a student may withdraw and no grade is assigned; the enrollment does not appear on the student's permanent transcript. Prior to the last four days of the session a student may withdraw with a "W". During the last four days of the session a student may withdraw with a "W" for serious and compelling reasons only.

Complete Withdrawal from session

To withdraw from all courses, complete and submit a Withdrawal form, and, if you are eligible for a refund, an application for a refund of fees. Withdrawal forms are available in the Summer Sessions Office.

Complete withdrawal, prior to first day of session. If you find it necessary to drop all courses before a session begins, you must cancel your registration and you may be eligible to receive a full refund of fees, less a non-refundable processing fee. A completed Withdrawal form and a

Refund Application must be received by the Summer Sessions Office by June 2 for First Session, June 23 for Second Session and July 14 for the Third Session.

Complete withdrawal, during the first two weeks of the session. You may withdraw during the first two weeks without a record of enrollment and without the instructor's signature. Complete a Withdrawal form and a Refund Application and submit these forms to the Summer Sessions Office by the end of the second week.

Complete withdrawal, third through fifth week of the session. A grade of "W" for each course appears on the permanent transcript if the student withdraws after the second week of the session and is doing passing work. To withdraw from all courses after the second week of instruction, complete a Withdrawal form, obtain the signatures of the instructor and school dean (or Dean of Extended Education, if you are not a regular student) on the Withdrawal form. Submit these completed forms to the Summer Sessions Office.

Withdrawal from classes during final exam week (last week of session) is not permitted, except in such cases as accident or serious illness where circumstances causing

the withdrawal are clearly beyond the student's control, and the assignment of a grade of Incomplete is not practical. Such requests require a Petition with the signature and approval of the instructor and school dean (Dean of Extended Education for Summer-only or non-matriculated students). The form is available in the Summer Sessions Office and must be filed in the Summer Sessions Office with documentation by the last day of the session in which the student was enrolled.

Refund of Tuition Fee

Refunds are not automatic. Even if the University cancels a scheduled course, you must make an application to have your tuition fees refunded. Refunds are subject to change without notice by the Trustees of California State University System. Amounts of refund are calculated according to the Formula for Refunds established in Title 5 of the California Administrative Code. Refund Applications are available from the Summer Sessions Office. This form must be filed in person with the Summer Sessions Office. Your Schedule Confirmation and the tear off receipt from the Change of Program form (if applicable) must accompany the written request. No transaction will

SCHEDULE FOR REFUND OF TUITION FEES

FIVE-WEEK OR LONGER SESSIONS

No. of Units	Amt. paid	Prior to first day of Session	First two days of Session	Any other day of first week	Any day of 2nd week
1	\$140.00	\$130.00	\$00.00	\$00.00	\$00.00
2	280.00	270.00	140.00	91.00	35.00
3	420.00	410.00	280.00	182.00	70.00
4	560.00	550.00	420.00	273.00	105.00

THREE OR FOUR-WEEK SESSIONS

1	\$140.00	\$130.00	\$00.00	\$00.00	\$00.00
2	280.00	270.00	140.00	91.00	00.00
3	420.00	410.00	280.00	182.00	00.00

2 WEEKS OR SHORTER SESSIONS: NO REFUNDS WILL BE MADE

be made without a receipt. Students must submit refund requests by the published deadlines (refer to Calendar and Refund Schedule). The effective date of the refund request, for purposes of calculating amount refunded, is the day it is received by the Summer Sessions Office. Allow approximately six weeks from the date the request is received for processing refunds.

Refund Schedule

The formula used for calculating the amount of fees refunded for five week or longer sessions is as follows. If you apply for a refund prior to the first day of the session, June 2, June 23, or July 14, you may receive total tuition minus \$10.00. If you apply for a refund on the first or second day of the session, you may receive total tuition minus the fee for one unit. During the remainder of the first week of the session, if you apply, you may receive total tuition minus one unit times 65 percent. During the second week of the session, if you apply, you may receive total tuition minus one unit times 25 percent. After the second week, none of the fee may be refunded. The late registration fee is non-refundable. **Please note that tuition refunds are based upon the start date of the session and not upon the first day a particular course meets.**

Cancelled Course Policy

If you are enrolled in a course that is cancelled for any reason, you must complete an Application for Refund or arrange for another course by completing a Change of Program form. The University does not refund fees automatically in the event of a course cancellation.

Refund of Parking Fees

Written application for a refund of parking fees must be accompanied by a permit or decal which the University has issued. Applications for refunds are determined by the following policy: 50% of all remaining full weeks; however no refund is issued for remaining periods of less than two weeks.

Summer Sessions Office

Small College Complex EE 1100, 310/243-3741

Processing of general registration, late registration, adds, drops, withdrawals, and other academic transactions related to Summer Sessions enrollment will take place in the Summer Sessions Office.

The office hours are 8am - 7pm, Monday through Thursday during the first week of both sessions and 8am - 6pm throughout the remainder of the summer. The office closes on Fridays at 5pm, and is open on Saturdays from 8am-1:30pm and will be closed on July 4.

Maximum Student Unit Load

The total units a summer student may earn:

Session 1.....	7 units
Session 2.....	7 units
Session 3.....	7 units
Sessions 1, 2 and 3.....	10 units

Exceptions to the above are based on proven academic ability and the feasibility of the student's schedule. Students wishing to exceed these unit limits must obtain and complete a special petition available in the Summer Sessions Office and request permission from the dean of the school governing their major. Visiting students or non-matriculated students must request permission from the Dean of Extended Education.

General Studies

The General Studies program is the nucleus of the undergraduate curriculum at CSUDH, deliberately structured to provide the intellectual and effective foundation required of a well-educated person. The philosophy underlying General Studies offerings is that they are courses for non-specialists, presenting subject matter related to wider context of knowledge and stimulating interest in lifelong learning. General Studies courses present breadth, deal with representative concepts, and provide some integration of concepts.

Several of the courses which comprise this curriculum are offered in Summer Sessions. For an overview of the General Studies program consult the University Catalog, pages 73-78 available in the University Bookstore.

University Advisement Center

Small College Complex SCC M-110 310/243-3538

Regularly enrolled students may obtain academic advisement for their summer schedules during Spring Semester when faculty and advisors are available. The Summer Sessions Office does not provide academic advisement. Many questions are answered in the University Catalog which includes course descriptions and course prerequisites in addition to policies and programs of the University. The Catalog is sold at the University Bookstore. In addition, the University Advisement Center is available for information and advisement at (310) 243-3538. Contact the Advisement Center for office hours.

School of Management Advisement Center

Social & Behavioral Sciences Building B 314 310/243-3561

Summer Sessions students may visit the Business Advisement Center. Call 310/243-3561 for days and hours of advisement.

Any student wishing to enroll in a School of Management 500-level course must receive approval and signature from the MBA Program Office located in SBS B-313 or call 310/243-3465.

Course Numbering System

The course numbering system for the University is based upon three-digit numbers as follows:

- 000-099 Sub-collegiate courses, not for baccalaureate credit.
- 100-199 Lower division courses, normally taken in the freshman year.
- 200-299 Lower division courses, normally taken in the sophomore year.
- 300-399 Upper division courses, normally taken in the junior year.
- 400-499 Upper division courses, normally taken in the senior year.
- 500-599 Graduate courses, normally limited to graduate students.

High School Students

Qualified high school students who will enter the junior or senior year in Fall 2000 can register for Summer Sessions lower division (100 level) courses with a letter of recommendation from the school principal or counselor and written authorization from the parents. Address letters to the Dean of Extended Education, California State University, Dominguez Hills. Students pay regular summer fees, and the course credit they earn may be applicable to a degree from CSUDH or another institution.

Grade Reports and Transcripts

Student performance in each course is reported at the end of the session by one of the following grades (with grade points earned):

GRADE POINTS	GRADE
A	4.0
A-	3.7
B+	3.3
B	3.0
B-	2.7
C+	2.3
C	2.0
C-	1.7
D+	1.3
D	1.0
F	0

The following grades are to be used for approved courses only:

CR Credit (not counted in grade average, but units allowed). Undergraduate level only.

SP Satisfactory Progress (credit is deferred until completion of course sequence).

NC No Credit (not counted in GPA, no units allowed).

A report of final grades assigned in classes will be mailed to you about 3 weeks after the end of the session.

A student may obtain an official transcript of enrollment and grades upon completing a Request for Transcript available at the office of Records and Registration. This request should be filed no earlier than the last week of the session in which the student is enrolled. Allow at least three weeks after the end of the session for delivery of the transcript copy. A fee of \$4.00, payable at the Cashier's Office, is charged for the first transcript request. Transcripts are not issued to a student whose record indicates a financial obligation to the University. Grades for nonstandard-date courses will be posted with standard course grades at end of session.

Summer students may audit a course on a space available basis with the permission of the instructor.

Auditors pay regular course fees. To enroll as an auditor, the student must submit a Change of Program form with the instructor's signature to the Summer Sessions Office.

Students must officially change their status in a course from credit to audit by the end of the first week of instruction.

Students may learn their grades by calling the Grades Hotline: (310) 516-4308 or by using the kiosks on campus (see page 9).

Credit / No Credit Grading

In accordance with the current Credit / No Credit policies, the undergraduate Credit (CR) grade is the equivalent of an A, B or C letter grade, and the No Credit (NC) grade is the equivalent of a C-, D or F. CR / NC grades are recorded on student tran-

scripts. An undergraduate may elect to be graded CR/NC in particular courses, subject to conditions which are described in the University Catalog. To receive a Credit / No Credit grade in a Summer Sessions course (except when the course is graded solely on Credit / No Credit basis), the student must complete the Credit / No Credit form, available in the Summer Sessions Office by the end of the second week of instruction.

Independent Study

Independent or directed study courses are intended for the regularly enrolled, matriculated students in order to enhance or supplement their curriculum. To enroll for independent or directed study, the student must obtain a contract from the Summer Sessions Office. This contract must be completed, including the signature of the dean, and submitted with student's registration. A student will not be registered for independent or directed study unless a completed contract has been submitted. Only course numbers listed with departments may be used; be sure the correct session and number of units are on the contract. The same registration deadlines and policies apply to independent study.

Final Examinations

Final examinations are administered during the final week the course is scheduled. Usually the examination is given on the last day the course meets. No adds or drops are accepted during or after the last week.

Entry Level Mathematics (ELM) Requirement

CSU students wishing to enroll in any of the following Summer Sessions mathematics classes will have to provide evidence of having satisfied the ELM requirements: MAT 009, 105, 107, 131, 153 and 207. This requirement can be satisfied by any of the following methods.

Summer 2000

1. Having an ELM score which meets the minimum for placement in a particular class.
2. Satisfactory test score on ACT / SAT test.
3. A transcript showing passing grades on a college level mathematics course above the level of Intermediate Algebra.

Evidence of any of the above should be sent to the Summer Sessions Office. California State University, Dominguez Hills graduates can have their records verified by the Office of Records and Registration. Valid approval stamps to enroll in MAT 009, 105, 107, 131, 153 and 207 may be obtained at the University Advisement Center or at the Math Department Office. Visitors from other Universities / Colleges should bring evidence that they have met the prerequisites for the course they wish to take.

University Bookstore Loker Student Union 310/ 243-3789

Textbooks, course materials, the University Catalog, supplies, giftware, and clothing are available at the Bookstore. Summer hours are:

Mon - Thu 8am - 6:30pm
 Fri 8am - 4pm
 Sat** 10am - 2pm

** 6/10, 17; 7/1, 15 & 22 only
Campus is closed July 4
 During the first week of each session, the Bookstore remains open until 7pm, M - Th, until 4pm Friday. The Bookstore hours are subject to change. The last day to return textbooks: First Session; Monday, June 12, Second Session; Monday, July 3, Third Session; Monday, July 24.

Disabled Student Services Student Health Center A106, 310/243-3660 TDD/243-2028

Disabled Student Services is committed to the student with a disability and to his or her right to an equal educational experience. Students having a disability which is either permanent or tempo-

rary in nature are eligible for a variety of support services including: Admissions / Registration Assistance Priority Registration Readers - Notetakers - Interpreters- Assistive devices and equipment loans.

Students with verified disabilities, which are permanent or temporary (e.g., broken bones, strained back, other sprains, etc.) are eligible for a variety of support services from the Disabled Student Services Office. Information regarding special facilities and services available to students with a disability may be obtained from the Director of Disabled Student Services Office, located in the Student Health Center, Room A-106, (310) 243-3660 (voice) or 243-2028 (TDD).

University Library Educational Resources Center 310/243-3714

During Summer Sessions, June 1 to August 21, the library is open as follows:

Mon - Thu	8am-7pm
Fri	8am-5pm
Sat	11am-3pm
Sun	Closed
Tuesday, July 4	Closed

Information Center Small College Complex A-130, 310/243-3696

The center assists the Campus population, prospective University applicants, and community members by providing essential centralized information on campus resources, activities, and programs. The Center also makes appropriate referrals to other campus units. Brochures, maps, directories, and other materials are available to students and visitors.

The Center functions include handling all application requests, providing information on admission policies and procedures, giving preadmission advising, CSUDH small group presentations, and providing guided tours. Summer hours are: Mon-Fri 8am - 5pm.

Testing Office Small College Complex Bldg 11, Rm 11207 310/243-3909

The Testing Office provides information and registration materials especially for the EPT/ELM, and GWE exams. In addition, it offers information on the ACT, SAT, GRE, CLEP (credit by exam programs), CBEST, GMAT, PRAXIS, SSAT, MSAT, LSAT, MCAT, Dental and Optometry admissions testing.

Campus Dining Loker Student Union 310/243-3814

Campus dining services will be available M - Th 8am-6pm; Fri, 8am-2pm, Sat, 8am-2pm. Food vending machines are located in Social and Behavioral Sciences building (SBS) and outside of the first floor of the Educational Resources Center (ERC) building.

Student Psychological Services Student Health Center A141, 310/243-3818

The Student Psychological Services Counseling unit offers psychological counseling during the Summer Sessions. Students must have attended Spring Semester 2000 in order to be eligible for counseling.

University Student Union 310/243-3559

The Loker University Student Union provides an environment which is designed to encourage interaction among the campus' constituent groups, enhance the sense of campus community, and expand the avenues through which the university educates its students. Located at the pedestrian crossroads of the campus, the Student Union houses the Game Room, lounge space, an ATM, as well as the University Bookstore, Campus

Summer 2000

Dining, Toro Shops, the offices of Associated Students, Inc. and the USU Administrative and Activities Office.

Summer hours of operation for the Student Union are

Mon - Thu	7:30am-7pm
Fri	7:30am-5pm
Sat	7:30am-3:30pm
Sun	Closed

Summer hours for Toro Shops

Student Union Location (West Entrance)

Mon - Thu	9am-3pm
Fri	9am-noon
Sat-Sun	Closed

Library Location

Mon - Thu	8am-7pm
Fri	8am-5pm
Sat	11am-3pm

Campus closed July 4

Cashier

**Small College Complex
B-135, 310/243-3812**

Summer hours: Mon-Thu 8am - 6:30pm & Fri 8am - 5:30pm.

**Veteran's Services
Student Health Center
A106, 310/243-3643**

Veterans are assisted in dealing with the Veteran's Administration, the State of California Department of Veteran's Affairs, and with problems that are a barrier to their success on campus. Veterans are encouraged to utilize the following services available for both day and evening students.

- * Pre-admission advisement
- * Veteran's benefits counseling
- * Tutorial assistance
- * Vocational Rehabilitation Program

**University Housing
P.O. 6228, Carson, CA 90749
310/243-2228**

On-campus Summer Sessions Housing is available to all students attending, but space is limited.

Information regarding on-campus housing may be obtained by writing or phoning the Department of University Housing (address and phone above). Information may also be obtained by sending an e-mail to:

housing@csudh.edu

Parking permits required.

**Parking
Small College Complex
A122, California State
University Police
310/243-3725/3639**

All vehicles which park on this campus must display a valid parking permit. (Sec. 21113a CVC). Summer Parking permits are purchased from the dispensing machines located at: Lot 1, Lot 7 Information Booth, Lot 3a, Lot 3, Lot 6 and Lot 4. (Should a dispensing machine malfunction, please contact the Information Booth attendant or call the University Police at 243-3639, or use an emergency call box.) Vehicles are to park "head in" using marked stalls only.

Daily (\$2.00) parking permits must be displayed on the vehicle's dashboard. Summer Sessions permits are displayed inside the front windshield on the driver's side near the VIN plate. Permits must be displayed in plain view without obstruction. Car covers are not recommended. Motorcycles, scooters, and mopeds have special areas for parking: SW corner of Lot 2, SE corner of Lot 3 and NW corner of Lot 4, NE corner of Lot 6. For further information, please contact the Parking Office at 310/243-3725 or 3639.

**KIOSK ACCESS
TO STUDENT RECORDS**

**KIOSKS ARE LOCATED
ON CAMPUS:
ADJACENT TO
INFORMATION CENTER,
IN THE LIBRARY AND IN
LOKER STUDENT UNION**

Students can now print their own schedule confirmations, grades, and unofficial transcripts without having to visit the Office of Extended Education for these services. To access these features, students will need an ID number and a pin number. The ID number is their Social Security number, and the initial PIN number is the student's birthdate. (Students are encouraged to change this PIN number after the initial log-in.)

Privacy Information

The University complies with Federal and State laws concerning privacy rights of students. These rights are summarized in the University Catalog. Questions about privacy rights may be directed to the Dean of Extended Education at (310) 243-3737 or the Vice President for student Affairs at (310) 243-3784.

Use of Social Security Number

Students are required to provide the university with their correct social security numbers (individual taxpayer identification numbers) pursuant to the authority contained in Section 41201, Title 5, California Code of Regulations, and Section 6109 of the Internal Revenue Code. The University uses the social security number to identify records pertaining to the student and, if needed, to collect debts owed the University. Also, the Internal Revenue Service requires the University to file information returns that include the student's social security number and other information such as the amount paid for qualified tuition, related expenses, and interest on educational loans. That information is used to help determine whether a student, or a person claiming a student as a dependent, may take a credit or deduction to reduce federal income taxes. Students who do not have a social security number at the time of enrollment will be required to obtain a social security number and submit it to the University within sixty days. Failure to furnish a correct social security number may result in the imposition of a penalty by the Internal Revenue Service.

Important Tax Credit Information

If you are enrolled in an eligible degree or certificate program or are taking courses to acquire or improve job skills, you may qualify for a **Hope Scholarship or Lifetime Learning Tax Credit**. The Hope Scholarship tax credit is available only to students in their first two years of postsecondary education who are enrolled at least half-time in an eligible program. The tax credits are based on the amount of qualified tuition and fees, less grants and other tax-free educational assistance and the taxpayer's modified adjusted gross income. Hope credits apply to fees paid after December 31, 1997. **The Lifetime Learning Tax Credit** The Lifetime Learning tax credit is available to students at all educational and enrollment levels who are enrolled at an eligible educational institution. As with the Hope Scholarship tax credit, this opportunity is based on the amount of qualified tuition and fees, less grants and other tax-free educational assistance and the taxpayer's modified adjusted gross income. The Lifetime Learning credit applies to fees paid after June 30, 1998. Consult IRS Publication 970 or your tax preparer for additional information on both programs.

Section 504 of the Rehabilitation Act of 1973

California State University, Dominguez Hills is an equal opportunity/affirmative action institution. As a unit of the university, the Division of Extended Education does not discriminate on the basis of race, color, religion, national origin, gender, sexual preference, age, disability or veteran status. This policy is applicable to employment and student admission, and to all educational programs and activities.

Immigration Requirements for Licensure

On August 27, 1996, Governor Pete Wilson issued Executive Order W-135-96 which requested that the CSU and other state agencies implement "as expeditiously as reasonably practicable" the provision of The Personal Responsibility and Work Opportunity Reconciliation Act (PRAWORA) of 1996 (P.L.104-193). The Act, also known as the Welfare Reform Act, included provisions to eliminate eligibility for federal and state public benefits for certain categories of lawful immigrants as well as benefits for all illegal immigrants.

Students who will require a professional or commercial license provided by a local, state, or federal government agency in order to engage in an occupation for which the CSU may be training them must meet the immigration requirements of the new Personal Responsibility and Work Opportunity Reconciliation Act to achieve licensure. Information concerning the regulation is available from the Office of the Chancellor.

**Humanities & AFS Classes
featuring
Munashe Furusa**

Professor Munashe Furusa is a visiting professor in the Department of Africana Studies. He is a tenured Senior Lecturer (Assistant Professor) in African Languages and Literature at the University of Zimbabwe where he teaches courses on Oral Literature, and Theories of Literature and Criticism. Professor Furusa is a specialist in the areas of African World Literatures as well as African Culture and Development. He is an active member of the National Council for Black Studies, African Studies Association, and regional and international associations concerned with the development of African and Diasporan communities. Professor Furusa has participated in organizing regional and international conferences on the utilization of indigenous knowledge systems in transforming these communities.

First Session:

HUM 312 African Literature and Culture

This course studies African Literature as an expression of culture and self-knowledge. Emphasis will be on self-definition, liberation and development as a people with a specific identity and destiny in a global context.

Second Session:

AFS 495/AFS 595 African Writers

The aim of the course is to familiarize students with major African authors. Authors chosen illustrate the variety of artistic creativity that has developed in Africa as a response to colonialism and the challenges of independence and self-definition.

**Courses offered to
satisfy requirements of the
following areas during Summer Sessions 2000**

**GENERAL
STUDIES**

- BIO 102
- BIO 103
- ENG 088
- ENG 099
- HIS 121
- HUM 200
- HUM 310
- HUM 312
- HUM 314
- MAT 003
- MAT 009
- MAT 105
- MAT 131
- MAT 171
- MAT 191
- MAT 193
- PHI 120
- POL 101
- PSY 110
- SBS 318

- ART 101
- ART 301
- ENG 305
- ENG 308
- ENG 314
- ENG 350
- GEO 360
- HIS 121
- HIS 301
- LBS 200

**SCHOOL OF
MANAGEMENT**

- ACC 231
- ACC 330
- ACC 333
- ACC 337
- ACC 502
- BUS 445
- BUS 595
- FIN 360
- FIN 480
- FIN 502
- MGT 310
- MGT 312
- MGT 490
- MGT 590
- QMS 321
- QMS 322
- QMS 423
- PUB 305
- PUB 434
- PUB 501

LIBERAL STUDIES

- LBS 400
- MAT 107
- MAT 207
- PHI 120
- PSY 350
- SBS 318
- SMT 310
- SOC 331
- THE 320
- THE 337

**ENG 088/099
and the
GENERAL STUDIES
ENGLISH REQUIREMENT**

For students who have not yet satisfied the EPT requirement it is now more important than ever to pass ENG 088/099 in a timely fashion.

**For additional information call the English Department
at (310) 243-3322**

**For guided group study workshops
for ENG 088/099, call Agnes Yamada
at (310) 243-3322**

**MAT 003/009
and the**

GENERAL STUDIES MATH REQUIREMENT

For students who have not yet satisfied the ELM requirement it is now more important than ever to pass MAT 003/009 in a timely fashion. A student who has already had MAT 003 Beginning Algebra or its equivalent can take MAT009 Intermediate Algebra in the first session and one of two courses in the third session (either MAT105 Finite Mathematics or MAT131 Elementary Statistics and Probability) and thereby satisfy the quantitative reasoning requirement by the end of Summer 1999.

**For additional information call the Math Department
at (310) 243-3378**

**For guided group study workshops for MAT 003/009, call
Caron Mellblom at (310) 243-3827**

Internet Courses:

**Be the master of your own time! Take courses over the Net
and gain an edge on your summer fun time!**

Online MBA

For the courses below, prerequisite is Graduate Standing, Consent of Instructor or Department. Contact: Ken Poertner (310) 243-3165 for more information

30326	BUS 595	41	3 units
Sel Topics:	TBA		
30329	FIN 502	41	3 units
Adv Top:	International Business		
30328	MGT 590	41	3 units
Strategic Management			
30330	MKT 500	41	3 units
Strategic Marketing			

**Online Certificate in
Assistive Technology**

Contact: Paul Richard, Coordinator:
(714) 966-4140

30234	GED 530	41	3 units
Intro to Assist Technology			
30235	GED 531	41	3 units
Basic Assistive Technology			

Online Scriptwriting

30310	COM 381	41	3 units
Scriptwriting for Electronic Media			

Online Humanities Course

Email instructor for approval to register:

HHolter@DHVX20.csudh.edu

HUM 310 41 3 units

Key Concepts: Success & Values in U.S.

Online Music Course

Contact the Instructor for the CRN & Approval to register: <http://MUSIC2.CSUDH.EDU/MUSIC101>

MUS 101 41 3 units

Introducing Music

Online MSQA

For the courses below, prerequisite is Graduate Standing. Contact: Eugene Watson, (310) 243-3880 for more information.

30085	QAS 495	41	1 unit
Sel Top:	Math for QAS		
30238	QAS 510	41	3 units
Adv Probability/Statistics			
30239	QAS 511	41	3 units
Quality Project Mgmt & TQM			
30240	QAS 512	41	3 units
Reliability			
30241	QAS 513	41	3 units
Stat Qual Control/Sampling			
30242	QAS 515	41	3 units
Human Factors in QAS			
30244	QAS 518	41	3 units
Quality Project Mgmt & Prod			
30247	QAS 594S	41	3 units
Ind Study in Assurance Science			
30248	QAS 595	41	3 units
Spec Top: Thesis Preparation			
30249	QAS 595	42	3 units
Spec Top: ISO 900X & Audit Function			
30250	QAS 595	43	3 units
Spec Top: Change Management			
30477	QAS 595	44	3 units
Spec Top: Clinical Epidemiology			

**See Schedule for
more information**

**ONE YEAR OF
ORGANIC CHEMISTRY
IN
A SINGLE SUMMER**

Designed for premedical and predoctoral students, this ten-week program corresponds to a full year of organic chemistry with lab. The two sequential courses offer 8 semester units the required chemistry for professional schools. The course is helpful in preparing for the DAT and MACT.

**Students who enroll for the
entire 10 week program will
have priority registration.**

Upper Division

**CHE 300 Organic Chemistry I
(3) (Summer Only)**

Prerequisite: CHE 112 or 1 year of general Chemistry

A detailed study of organic molecular structure, reaction mechanisms stereochemistry, and synthesis with emphasis on a aliphatic and aromatic systems. Three hours of lecture per week.

**CHE 301 Organic Chemistry
Laboratory I
(1) (Summer Only)**

Prerequisites: CHE 112 or 1 year of general chemistry; concurrent enrollment in CHE 300.

Basic experimental techniques of organic chemistry. Three hours of laboratory per week.

**CHE 302 Organic Chemistry II
(3) (Summer Only)**

Prerequisites: CHE 300 and CHE 301. Concurrent enrollment in CHE 303.

Continuation of CHE 300 with emphasis on the chemistry of organic compounds containing oxygen and nitrogen. Three hours of lecture per week.

**CHE 303 Organic Laboratory II
(1) (Summer Only)**

Prerequisites: CHE 112 or 1 year of general chemistry; concurrent enrollment in CHE 302.

Preparation of organic compounds and qualitative organic analysis. Three hours of laboratory per week.

THE AMERICAN LANGUAGE & CULTURE PROGRAM

ESL

ENGLISH LANGUAGE COURSES FOR Beginning, Intermediate and Advanced International students

The American Language and Culture Program at California State University, Dominguez Hills, has courses for international students, business people and new residents who wish to improve their English language skills. Maximum enrollment in most classes is 15 students to ensure sufficient student practice and attention from the teacher.

WORK-SITE PROGRAMS (WSP)

ALCP can offer English language and culture programs at the work-site for non-native speakers of English. Programs can be developed for a wide range of work needs: on-the-line employees who need basic communication skills and orientation to an American work environment; executives who need high-level communication skills to negotiate business and operate in social environments or other special situations. English-for-Special-Purposes (ESP) programs are often offered in industries such as hospitality, tourism and travel, import/export, banking and manufacturing. ESP programs can include safety English, industry-specific terminology and jargon, company-specific terminology and jargon, writing skills (forms, memos,

reports), oral communication/pronunciation, asking questions, giving/receiving directions, clarifying, expressing opinions, and expressing safety concepts.

INTENSIVE ENGLISH PROGRAM (IEP)

IEP offers an eight-week intensive English language program five times a year for students with academic or professional goals, including passing the TOEFL for entrance into an American university. The 20-hour per week IEP (9am-1pm daily) offers a coordinated program of conversation, grammar, writing, reading/vocabulary, pronunciation and listening. Students from all over the world enroll in this multi-level program and can continue to improve their skills by advancing from session to session. Qualified students from outside the U.S. are eligible for a student visa. Individual courses may also be taken by students. A certificate of achievement is awarded after successful completion of at least one session. Language skills studied are:

Conversation

Conversation Skills offers extensive individual student practice in speaking. Students learn to use authentic language in situations related to work, school, leisure and social life. They are encouraged to express their thoughts and ideas, plus their wants and needs, in classroom situations that make extensive use of pair work, small-group discussions, and information-sharing activities. These face-to-face discussions simulate real-life social interaction, encouraging the use of eye contact, exclamations, questions, accurate intonation and emotional tone.

Writing

Writing Skills emphasizes the process of writing and highlights the various strategies writers can use in the process. The class teaches such organizational patterns as generalizing, describing, defining, talking about differences and similarities, and expressing cause and result. Although the focus is on content-based writing, other language skills are integrated, and practice writing is combined with speaking and listening activities. In order to gather data for their writing, students share ideas, opinions, and suggestions in pair, small group, and whole-class discussions. These brainstorming activities lead to teacher and peer analyses of student essays where the focus is on topic sentences, supporting facts, discourse markers, and concluding sentences.

2000 Schedule Intensive English Language Program

Eight-Week Sessions

Summer A	May 1-2	May 3 - June 23	\$1,500
Summer B	June 26-27	June 28 - August 18	\$1,500
Fall A	August 28-29	August 30 - October 20	\$1,500
Fall B	October 23-24	October 25 - December 15	\$1,500

Registration and Payment for two consecutive 8-week session allow for a one-hundred-dollar discount. Prices and dates subject to change without prior notice.

Pronunciation

The Pronunciation class helps develop clear pronunciation and American English intonation patterns for increased spoken comprehension. Students learn acceptable pronunciation of single vowel and consonant sounds, groups of sounds, stress patterns in words, and intonation patterns in sentences. Students have the opportunity to listen and practice with tapes and to express their own views and opinions under the teacher's guidance. Students receive personal attention and special homework assignments focused on their specific pronunciation and intonation problems. Further pronunciation work can be done in the University's learning laboratory.

Grammar

The Grammar class presents the important grammatical structures in English through a process of observing, describing and using the structures in written and spoken language. Controlled and open-ended exercises and tasks are practiced in class to help the students increase their mastery over the forms. Special attention is given to grammar points that are most difficult for students. Additionally, the ways in which grammar is tested in the TOEFL are examined and practice TOEFL exercises are done.

Reading & Vocabulary

The focus of Reading & Vocabulary is to help students increase their vocabulary within the context of meaningful, high-interest readings. Each student will learn the skills needed to find the meanings of unfamiliar words and then incorporate them into active, everyday use. Reading and vocabulary

skills will be practiced through an integrated approach that uses a variety of topics, genres, moods and styles. Interesting subjects will be read and then examined through paired discussions, small group work and whole-class activities.

Listening Skills

The Listening Skills class allows students to develop their aural skills in a supportive, active environment. Each student is given the opportunity to participate in a variety of in-class activities using tapes, videos and guest speakers. Students listen to and learn how to appropriately respond to questions presented in meaningful language contexts. Each listening exercise allows students to progress from controlled

listening activities to more complex ones. Each student will be expected to strengthen his listening skills outside the classroom through assignments involving TV, radio and community service projects that require interaction with American speakers. Additional practice is available through tapes in the University's Learning Labs.

Optional Afternoon Classes

- TOEFL Preparation
- Computer, e-mail, WWW and Internet
- Video, Films
- Conversation Partners
- Pronunciation

TO APPLY, SEND:

1. Completed Application Form. See ALCP brochure or Web-Site.
2. \$55 U.S. Application Fee written to: CSUDH. Non-refundable.
Cash cannot be accepted.
3. Financial Verification. If you are requesting an I-20 in order to enter the U.S. on an F-1 Student Visa for full-time study only. The financial verification is usually a bank statement, which must verify a minimum of \$7,000 U.S. available for the student's studies.
4. Additional Costs: Health Insurance (required), text books, food, housing, transportation, miscellaneous.

For more information on ALCP/ESL classes:

Tel: (310) 243-3830 Fax: (310) 516-4418

E-mail: alcp@dhvx20.csudh.edu

World Wide Web:

<http://www.csudh.edu/alcp/index.html>

Registration: Tel. (310) 243-3830

ONE CALL: 5 UNIVERSITIES CALNET

DISTANCE LEARNING PROGRAMMING

CSU DOMINGUEZ HILLS • CSU FULLERTON

CSU LONG BEACH • CSU LOS ANGELES • CAL POLY POMONA

What is CALNET Distance Learning?

- You call one number to register, and gain information on the class
- You save commuting time and expenses by taking classes at home or at locations near home or work
- You can take a class you need at another CSU if it is not offered locally

Who can enroll?

If you are a registered student at any of the participating CSU campuses you may enroll in the classes offered. You will need to meet the prerequisites as described in your university catalog. You will receive credit on your home campus.

What kind of equipment do I need?

If you are taking online courses, you need access to a computer. If you are taking courses over TV, you need access to PBVS, Pacific Bell Video Services. In the future, there will be other forms of delivery.

Summer Schedule

CSUF

Principles of Communication Research

COMM 410 (3 units)
Internet

TWTH" 5/30-7/15

Code Numbers:

69-70-24 or 41-42-09

Inst: Dr. Edgar Trotter

Class Interaction Number:
(714) 278-2055

*Prerequisites: Comm 233 and
Junior Standing*

Research methods used to assess the effects of print, broadcast, and film communications on audience attitudes, opinions, knowledge, and behavior. Research design and data analysis in communications research.

AND THERE'S ROOM TO GROW!

Here's what's in your future when you take advantage of easy access classes by CALNET:

- More ways to access classes
- More classes offered in this format
- Combinations of distance and on-campus programs

Where do I begin? Call 1-888-5CALNET or visit the website at www.calnet.edu

Interested? Answers are as close as your phone or internet connection:

www.calnet.edu • tel: 1-888-5CALNET

NOTES: For independent study/internships, please contact your department chair or program coordinator. For additions to this bulletin after publication, please call (310) 243-3741 or check the web site: www.csudh.edu/extendeded/

Crn #	Dept	Sec	COURSE TITLE	Units	Days	Hours	Room #	Instructor	Fee
ACC Accounting									
FIRST SESSION									
30150	ACC 231	11	Managerial Accounting	3	TT	6:00-9:50pm 06-Jun-00-13-Jul-00	SBS E126	M Auerbach	\$420
30151	ACC 330	11	Intermediate Accounting I	3	MW	6:00-9:50pm 05-Jun-00-14-Jul-00	SBS D219	C Chang	\$420
30152	ACC 333	11	Income Taxation I	3	TT	6:00-9:50pm 06-Jun-00-13-Jul-00	SBS A210	M El-Badawi	\$420
30153	ACC 337	11	Cost Accounting	3	TT	6:00-9:50pm 06-Jun-00-13-Jul-00	SBS D121	R Mazhin	\$420
INTENSIVE									
30322	ACC 502	71	Adv Topics in Accounting Graduate Standing, Consent of Instructor or Department Contact Penny Putz (310) 243-2162	3	S	12:00-3:00pm 06-May-00-19-Aug-00	ERC A103	M El-Badawi	\$507
Televised MBA									
30323	ACC 502	91	Adv Topics in Accounting Graduate Standing, Consent of Instructor or Department Contact Penny Putz (310) 243-2162	3	S	12:00-3:00pm 06-May-00-19-Aug-00		M El-Badawi	\$597
AFS Africana Studies									
FIRST SESSION									
30228	AFS 205	11	Theories and Approaches in AFS	3	MTW	6:00-8:30pm 05-Jun-00-12-Jul-00	SAC 2103	M Johnson	\$420
SECOND SESSION									
30231	AFS 495	21	Spec Top: African Writers	3	MTW	2:00-4:30pm 26-Jun-00-3-Aug-00	SBS A216	M Furusa	\$420
30232	AFS 595	21	Spec Top: African Writers	3	MTW	2:00-4:30pm 26-Jun-00-3-Aug-00	SBS A216	M Furusa	\$420
THIRD SESSION									
30229	AFS 220	01	African World Peoples & Society	3	MTW	6:00-8:30pm 17-Jul-00-25-Aug-00	SAC 1101	M Johnson	\$420
ART Art									
FIRST SESSION									
30105	ART 301A	11	Arts/Crafts For Non-Major	3	MTW	1:00-4:50pm 05-Jun-00-12-Jul-00	LCH A115	J Goders	\$435
SECOND SESSION									
30106	ART 301A	21	Arts/Crafts For Non-Major	3	TWT	9:00-12:50pm 27-Jun-00-3-Aug-00	LCH A115	B Baker	\$435
THIRD SESSION									
30125	ART 301A	01	Arts/Crafts For Non-Major	3	TWT	1:00-4:50pm 18-Jul-00-24-Aug-00	LCH A115	L Bermudez	\$435
30126	ART 150A	01	Ceramics I Cr listed: ART 361A-01 (30127) ART 463A-01 (30128)	3	TWT	5:00-8:50pm 18-Jul-00-24-Aug-00	LCH A118	L Bermudez 10.00 lab fee	\$445
30127	ART 361A	01	Ceramics II CR listed: ART 150A-01 (30126) ART 463A-01 (30128)	3	TWT	5:00-8:50pm 18-Jul-00-24-Aug-00	LCH A118	L Bermudez 10.00 lab fee	\$445
30128	ART 463A	01	Ceramics III CR listed: ART 150A-01 (30126) ART 361A-01 (30127)	3	TWT	5:00-8:50pm 18-Jul-00-24-Aug-00	LCH A118	L Bermudez 10.00 lab fee	\$445
INTENSIVES									
30107	ART 100	61	Looking At Art	3	MTWT	9:00-12:50pm 05-Jun-00-22-Jun-00	LCH A228	B Baker	\$420
BEH Behavioral Science									
FIRST SESSION									
30456	BEH 531	11	Divorce Mediation	3	MW	6:00-9:50pm 05-Jun-00-14-Jul-00	SCC E149	B Culp	\$420
SECOND SESSION									
30200	BEH 597S	21	Directed Reading	3	TBA	TBA 26-Jun-00-4-Aug-00	TBA TBA	H Chamofsky	\$420
THIRD SESSION									
30060	BEH 597S	01	Directed Reading	3	TBA	TBA 17-Jul-00-25-Aug-00	TBA TBA	F Hosokawa	\$420
INTENSIVES									
30070	BEH 507	71	Seminar: Res Design/Intrepret	4	W	6:00-9:00pm 12-Apr-00-21-Jun-00	SBS B109	Staff	\$580
30071	BEH 507	91	Seminar: Res Design/Intrepret	4	W	6:00-9:00pm 12-Apr-00-21-Jun-00	TBA TBA	Staff	\$700

NOTES: For independent study/internships, please contact your department chair or program coordinator. For additions to this bulletin after publication, please call (310) 243-3741 or check the web site: www.csudh.edu/extendeded/

Crn #	Dept	Sec	COURSE TITLE	Units	Days	Hours	Room #	Instructor	Fee
30072	BEH 525	71	Mediation	4	M	6:00-9:00pm 10-Apr-00-19-Jun-00	TBA TBA	Staff	\$580
30073	BEH 525	91	Mediation	4	M	6:00-9:00pm 10-Apr-00-19-Jun-00	TBA TBA	Staff	\$700

BIO Biology FIRST SESSION

30211	BIO 102	11	General Biology	3	MW	9:00-12:00pm 05-Jun-00-12-Jul-00	NSM C213	R Giacosis	\$420
30212	BIO 103L	11	General Biology Laboratory	1	MW	12:30-3:30pm 05-Jun-00-02-Jul-00	NSM B110	R Giacosis	\$250
30475	BIO 324	11	Microbiology	3	TT	9:00-11:30am 06-Jun-00-13-Jul-00	SBS B101	D Soleymani	\$480
30476	BIO 324L	11	Microbiology Laboratory	0	TT	12:30-4:00pm 06-Jun-00-13-Jul-00	NSM C151	D Soleymani	\$0
30202	BIO 374	11	Drug Abuse	3	TT	9:00-12:50pm 06-Jun-00-13-Jul-00	NSM C239	R Giacosis	\$420

BUS Business FIRST SESSION

30065	BUS 595	11	Sel Top: Securities Analysis	3	MW	6:00-9:50pm 05-Jun-00-12-Jul-00	SBS D125	R Ulivi	\$420
-------	---------	----	------------------------------	---	----	------------------------------------	----------	---------	-------

THIRD SESSION

30069	BUS 445	01	International Business	3	TT	6:00-9:50pm 18-Jul-00-24-Aug-00	SBS E122	P Basseer	\$420
-------	---------	----	------------------------	---	----	------------------------------------	----------	-----------	-------

INTENSIVE

30320	BUS 595	71	Sel Topics: Investment Strategies Graduate Standing, Consent of Instructor or Department Contact Penny Putz (310) 243-2162	3	Su	12:00-3:00pm 07-May-00-20-Aug-00	ERC A103	P Mahn	\$507
-------	---------	----	--	---	----	-------------------------------------	----------	--------	-------

Televised MBA

30321	BUS 595	91	Sel Topics: Investment Strategies Graduate Standing, Consent of Instructor or Department Contact Penny Putz (310) 243-2162	3	Su	12:00-3:00pm 07-May-00-20-Aug-00		P Mahn	\$597
-------	---------	----	--	---	----	-------------------------------------	--	--------	-------

Online MBA

30326	BUS 595	41	Sel Topics: Lgl & Bus Aspcts/E-Com Graduate Standing, Consent of Instructor or Department Contact: Ken Poertner (310) 243-3165	3	TBA	TBA 03-April-00-26-Jun-00	TBA	B Severy	\$800
-------	---------	----	--	---	-----	------------------------------	-----	----------	-------

CHE Chemistry INTENSIVES

30049	CHE 300	62	Organic Chemistry I	3	MTWT	10:00-12:15pm 05-Jun-00-10-Jul-00	NSM C221	N Sturm	\$420
30047	CHE 300	61	Organic Chemistry I	3	MTWT	10:00-12:15pm 05-Jun-00-10-Jul-00	NSM C221	J Lyle	\$420
30048	CHE 301L	61	Organic Chemistry Lab I	1	TWT	1:00-2:00pm TWT 2:00-4:00pm 06-Jun-00-06-Jul-00	NSM C221 NSM C351	J Lyle	\$250
30050	CHE 301L	62	Organic Chemistry Lab I	1	TWT	1:00-2:00pm TWT 2:00-4:00pm 06-Jun-00-6-Jul-00	NSM C221 NSM C339	N Sturm	\$250
30051	CHE 302	61	Organic Chemistry II	3	MTWT	10:00-12:15pm 11-Jul-00-11-Aug-00	NSM C221	J Lyle	\$420
30053	CHE 302	62	Organic Chemistry II	3	MTWT	10:00-12:15pm 11-Jul-00-11-Aug-00	NSM C221	T Reilly	\$420
30052	CHE 303L	61	Organic Chemistry Lab II	1	TWT	1:00-2:00pm TWT 2:00-4:00pm 11-Jul-00-10-Aug-00	NSM C221 NSM C351	J Lyle	\$250
30054	CHE 303L	62	Organic Chemistry Lab II	1	TWT	1:00-2:00pm TWT 2:00-4:00pm 11-Jul-00-10-Aug-00	NSM C221 NSM C339	T Reilly	\$250

COM Communications FIRST SESSION

30436	COM 100	11	Mass Media & Society	3	MWF	9:00-11:30am 05-Jun-00-12-Jul-00	FH C008	L Hess	\$420
30438	COM 250	11	Newswriting for the Media	3	TT	9:00-12:50pm 06-Jun-00-13-Jul-00	FH A008	L Hess	\$420
30055	COM 397S	11	On Campus Internship	1	TBA	TBA 05-Jun-00-14-Jul-00	TBA TBA	D Silvis	\$140
30056	COM 496S	11	Internship In Communications	1	TBA	TBA 05-Jun-00-14-Jul-00	TBA TBA	D Silvis	\$140

NOTES: For independent study/internships, please contact your department chair or program coordinator. For additions to this bulletin after publication, please call (310) 243-3741 or check the web site: www.csudh.edu/extendeded/

Crn #	Dept	Sec	COURSE TITLE	Units	Days	Hours	Room #	Instructor	Fee
SECOND SESSION									
30437	COM 100	21	Mass Media & Society	3	TT	1:00-4:50pm 27-Jun-00-03-Aug-00	FH D003	L Hess	\$420
THIRD SESSION									
30311	COM 495	01	Writing the Story of Your Life 30 hrs in addition to class meetings, extensive internet component	3	W	9:00-12:00pm 19-Jul-00-23-Aug-00	SBS F101	C Clinch	\$435
30312	COM 495	02	Writing & Adapting News for Screen 30 hrs in addition to class meetings, extensive internet component	3	W	1:00-4:00pm 19-Jul-00-23-Aug-00	SBS F101	C Clinch	\$435
INTERNET									
30310	COM 381	41	Scriptwriting for Electronic Media	3	TBA TBA	05-Jun-00-04-Aug-00	TBA TBA	C Clinch	\$435
CSC Computer Science									
FIRST SESSION									
30089	CSC 101	11	Computr Appl For Sciencs Co-Requisite: CSC 101L (30090)	2	MW	6:00-6:50pm 05-Jun-00-12-Jul-00	SCC E139	M Eyadat	\$290
30090	CSC 101L	11	Compnr Appl For Sci-Lab Co-Requisite: CSC 101 (30089)	0	MW	7:00-9:30pm 05-Jun-00-12-Jul-00	SCC E139	M Eyadat	\$0
30091	CSC 111	11	Intro Computers And Basic	3	TT	6:00-9:30pm 06-Jun-00-13-Jul-00	SBS A204	M Eyadat	\$435
THIRD SESSION									
30088	CSC 251	01	C Lang Prog And Unix	3	TT	6:00-9:30pm 18-Jul-00-25-Aug-00	SBS G122	Z Khwaja	\$435
ECO Economics									
FIRST SESSION									
30087	ECO 210	11	Economic Theory 1A Micro	3	TT	6:00-9:50pm 06-Jun-00-13-Jul-00	LCH A230	C Chima	\$420
30086	ECO 211	11	Economic Theory 1B Macro	3	TT	1:00-4:50pm 06-Jun-00-13-Jul-00	LCH A230	C Chima	\$420
ENG English									
For independent study and/or internships, please contact Agnes Yamada at (310) 243-3522.									
FIRST SESSION									
30190	ENG 305	11	Critical Reading of Literature	3	MW	1:00-4:50pm 05-Jun-00-12-Jul-00	LCH A230	S Waterworth	\$420
30188	ENG 314	11	English Syntax: Traditional	3	TT	6:00-9:50pm 06-Jun-00-13-Jul-00	LCH A229	C Zoerner	\$420
30189	ENG 326	11	Prose Fiction	3	MW	1:00-4:50pm 05-Jun-00-12-Jul-00	LCH A224	T Giannotti	\$420
30187	ENG 350	11	Advanced Composition Prerequisite: Completion of ENG 110+ENG 111 or Equivalent	3	MW	6:00-9:50pm 05-Jun-00-12-Jul-00	LCH A224	T Giannotti	\$424
30191	ENG 350	12	Advanced Composition Prerequisite: Completion of ENG 110+ENG 111 or Equivalent	3	TT	1:00-4:50pm 06-Jun-00-13-Jul-00	LCH A229	J Zitter	\$424
30472	ENG 352	11	Writing & Spkg Skills for Management Prerequisite: Completion of ENG 350 or passing GWE score	3	TT	6:00-9:50pm 06-Jun-00-13-Jul-00	SBS G122	J Zitter	\$420
SECOND SESSION									
30441	ENG 088	23	Developmental Reading	3	TT	8:00-12:50pm 27-Jun-00-3-Aug-00	LCH A224	Staff	\$450
30440	ENG 099	22	Basic Writing Workshop	3	TT	1:00-5:50PM 27-Jun-00-3-Aug-00	LCH A224	Staff	\$450
30192	ENG 308	21	Crit Approach Child Lit	3	TT	1:00-4:50pm 27-Jun-00-3-Aug-00	LCH A219	S Waterworth	\$420
30193	ENG 308	22	Crit Approach Child Lit	3	TT	6:00-9:50pm 27-Jun-00-3-Aug-00	LCH A219	S Waterworth	\$420
30194	ENG 314	21	English Syntax: Trad	3	MW	1:00-4:50pm 26-Jun-00-2-Aug-00	LCH A229	B Agbayani	\$420
30195	ENG 350	21	Advanced Composition Prerequisite: Completion of ENG 110+ENG 111 or Equivalent	3	MW	6:00-9:50pm 26-Jun-00-2-Aug-00	SAC 3141	L Smith	\$424
30196	ENG 350	22	Advanced Composition Prerequisite: Completion of ENG 110+ENG 111 or Equivalent	3	TT	9:00-12:50pm 27-Jun-00-3-Aug-00	LCH A219	J Zitter	\$424
30197	ENG 590	21	Sem In Lit: Irish Autobiography Prerequisite: Consent of Instructor or Department	3	TT	6:00-9:50pm 27-Jun-00-3-Aug-00	LCH A224	T Giannotti	\$420
THIRD SESSION									
30483	ENG 305	01	Critical Reading of Literature	3	MW	1:00-4:50pm 17-Jul-00-23-Aug-00	LCH A324	M Becker	\$420
30198	ENG 314	01	English Syntax: Traditional	3	TT	1:00-4:50pm 18-Jul-00-24-Aug-00	SBS B131	B Agbayani	\$420
30484	ENG 350	01	Advanced Composition Prerequisite: Completion of ENG 110+ENG 111 or Equivalent	3	MW	6:00-9:50pm 17-Jul-00-23-Aug-00	LCH A224	M Becker	\$424

NOTES: For independent study/internships, please contact your department chair or program coordinator. For additions to this bulletin after publication, please call (310) 243-3741 or check the web site: www.csudh.edu/extendeded/

Crn #	Dept	Sec	COURSE TITLE	Units	Days	Hours	Room #	Instructor	Fee
FIN Finance FIRST SESSION									
30077	FIN 360	11	Business Finance	3	TT	6:00-9:50pm 06-Jun-00-13-Jul-00	SBS E122	R Ulivi	\$420
30074	FIN 480	11	Economics Of The Firm	3	MW	1:00-4:50pm 05-Jun-00-12-Jul-00	SBS B203	M Nashif	\$420
THIRD SESSION									
30067	FIN 502	01	Adv Top: International Business	3	MW	6:00-9:50pm 17-Jul-00-23-Aug-00	SBS E122	P Basseer	\$420
Online MBA									
30329	FIN 502	41	Adv Top: International Business Graduate Standing, Consent of Instructor or Department Contact: Ken Poertner (310) 243-3165	3	TBA	TBA 03-April-00-26-Jun-00	TBA	E Jewell	\$800
GEO Geography FIRST SESSION									
30313	GEO 360	11	Geography of North America	3	TW T	6:00-8:30pm 06-Jun-00-13-Jul-00	SBS F101	S Koletty	\$420
GED Graduate Education For independent study and/or internships, please contact Farah Fisher at (310) 243-3524. FIRST SESSION									
30453	GED 480	11	Organization & Administration of PPS Prerequisite: Graduate Standing	3	TT	5:30-9:30pm 06-Jun-00-13-Jul-00	SOE 1107	R Lee	\$420
30083	GED 500	11	Research Methods in Education	3	MW	4:00-7:50pm 05-Jun-00-14-Jul-00	SAC 1101	F Fisher	\$420
30129	GED 501	11	Seminar In Learn & Development	3	MW	4:00-7:50pm 05-Jun-00-14-Jul-00	SAC 1103	L Furtado	\$420
30130	GED 501	12	Seminar In Learn & Development	3	TT	4:00-7:50pm 06-Jun-00-13-Jul-00	SAC 1103	L Furtado	\$420
30104	GED 502	11	Counseling Theories	3	TT	4:00-7:50pm 06-Jun-00-13-Jul-00	SOE 1107	C Bohman	\$420
30082	GED 503	11	Soc-Cultrl Issues in Education	3	TT	4:00-7:50pm 06-Jun-00-13-Jul-00	SCC E149	P Robinson	\$420
30288	GED 520	13	Tchng Eng Spkrs Othr Lang	3	MTWT	6:00-9:45pm 05-Jun-00-26-Jun-00	SAC 3135	H Safi	\$420
30454	GED 526	11	Computer-Managed Instruction Consent of Instructor	3	TT	4:00-7:50pm 06-Jun-00-13-Jul-00	SBS B109	F Fisher	\$420
30146	GED 529	11	Adv Inst Curr Mod for Mld/Mod	3	MW	4:30-8:20pm 05-Jun-00-12-Jul-00	SAC 1107	K Skindrud	\$420
30222	GED 555	11	Prac Dir Tchng Eryl Chld Sp Ed	5	MTWTF	TBA 05-Jun-00-14-Jul-00	OFF CAMP	D Okada	\$995
30293	GED 555S	11	Prac Dir Tchng Eryl Chld Sp Ed	0	T	3:00-4:30pm 05-Jun-00-14-Jul-00	LCH A330	D Okada	\$0
30149	GED 560	11	Lang/Spc Dev/Dis & Alt Com Sys	3	TT	4:00-7:50pm 06-Jun-00-13-Jul-00	SAC 1101	M Parker	\$420
30302	GED 566	11	Dir Teach Inds Mod Sev Dis Co-requisite: GED 566S (30303)	5	MTWTF	TBA 05-Jun-00-14-Jul-00	OFF CAMP	P Patterson	\$995
30303	GED 566S	11	Dir Teach Inds Mod Sev Dis Co-requisite: GED 566 (30302)	0	M	3:30-5:00pm 06-Jun-00-14-Jul-00	SCC E149	P Patterson	\$0
30061	GED 581	11	Princ Ed Psyc Assessment	3	MW	4:00-7:50pm 05-Jun-00-14-Jul-00	SOE 1104	D Scherba	\$420
30062	GED 583	11	Sem Career & Voc Guidance	3	TT	4:00-7:50pm 06-Jun-00-13-Jul-00	SOE 1104	D Scherba	\$420
30223	GED 597S	11	Fieldwork Counseling	3	T	4:00-7:50pm 06-Jun-00-11-Jul-00	SOE TBA	L Murdock	\$597
30224	GED 598S	11	Fieldwk School Psych	3	W	4:00-7:50pm 07-Jun-00-12-Jul-00	SOE TBA	L Murdock	\$597
SECOND SESSION									
30081	GED 500	21	Research Methods in Education	3	MW	4:00-7:50pm 26-Jun-00-4-Aug-00	SBS B101	J Cooper	\$420
30324	GED 528	21	Adv Collaboration, Consultation & Communication for Spec Ed Specialists Graduate Standing, Consent of Instructor or Department	3	TT	5:00-8:50pm 27-Jun-00-03-Aug-00	SAC 3142	S Grandinetti	\$420
30103	GED 535	21	Intro Computers In Education	3	MW	1:00-4:50pm 26-Jun-00-3-Aug-00	SCC 11305	P Desberg	\$435
30209	GED 556S	21	Dir Fld Exper in Spec Gen Educ	4	MTWTF	TBA M seminar 2:00-3:30pm 26-Jun-00-4-Aug-00	OFF CAMP SCC L149	M Parker P Patterson	\$796
30294	GED 556S	22	Dir Fld Exper in Spec Gen Educ	4	T	9:00-12:00pm 26-Jun-00-1-Aug-00	SCC L149	C Blackaller	\$796
30290	GED 558	21	Mngng Lrn Envrmnts Spec Gen Eg	3	TT	4:30-8:20pm 27-Jun-00-3-Aug-00	SBS B137	M Tajima	\$420
30210	GED 559S	21	Fld Exp Infant Toddler Presch	4	MTWTF	TBA M seminar 9:00-12:00pm 26-Jun-00-4-Aug-00	SCC E153	D Okada	\$796

NOTES: For independent study/internships, please contact your department chair or program coordinator. For additions to this bulletin after publication, please call (310) 243-3741 or check the web site: www.csudh.edu/extendeded/

Crn #	Dept	Sec	COURSE TITLE	Units	Days	Hours	Room #	Instructor	Fee
30289	GED 562	21	Adv Beh Emot Environ Supports	3	MW S	5:00-8:45pm 9:00-3:00pm	SBS F125 7/8 & 7/22	M Lieberman	\$420
30147	GED 569	21	Dir Teach Inds Mild Mod Dis	5	MTWTFSS	8:00-3:00pm	OFF CAMP	K Skindrud	\$995
30148	GED 569S	21	Dir Teach Inds Mild Mod Dis	0	T	3:00- 4:30pm	SBS A210	K Skindrud	\$0
30075	GED 597S	21	Fieldwork Counseling	3	T	TBA TBA	TBA TBA	D Scherba	\$597
30076	GED 598S	21	Fieldwork School Psychology	3	T	TBA TBA	SOE 1104	D Scherba	\$597

INTENSIVES

30144	GED 460	61	Intro to Special Education	3	MTWT	4:00-7:50pm	SCC E167	C Blackaller	\$420
30084	GED 503	61	Soc-Cultrl Issues in Education	3	TW S 8/5&12	4:00-7:00pm 9:00-4:00pm	SBS D219	M Contreras	\$420
30080	GED 508	61	Sem Issues In Education: Language Development	3	MTT	4:00-7:50pm	SBS B215	S Medina	\$420
30291	GED 524	61	Adv Lead Mgrnt & Curr Mod Dis	3	TT	4:30-8:00pm	SBS B209	B Farran	\$420
30319	GED 525	61	BlI/Multi Teaching Methods	3	MTWT	4:00-7:50pm	SAC 1103	S Greenwood	\$420
30236	GED 537	71	Capstone in Assist Technology Location: Costa Mesa HS Annex	3	Th	4:00-7:00pm	OFF CAMP	L Belkin P Richard	\$420
30145	GED 561	61	TypAtyp Dev Asmt Iss Sp Gen Ed Westchester Cohort II	3	MTW	4:00-7:00pm	SCC L149	C Blackaller	\$420

INTERNET

30234	GED 530	41	Intro to Assist Technology Contact: Paul Richard, Coordinator: (714) 966-4140	3	TBA	TBA	TBA TBA	L Belkin P Richard	\$435
30235	GED 531	41	Basic Assistive Technology Contact: Paul Richard, Coordinator: (714) 966-4140	3	TBA	TBA	TBA TBA	L Belkin P Richard	\$435

HEA Health Science FIRST SESSION

30455	HEA 494	11	Independent Study in Health Science	3	W	TBA	TBA TBA	E Wells	\$420
-------	---------	----	-------------------------------------	---	---	-----	---------	---------	-------

INTENSIVE

30304	HEA 300	61	Health in Public Education	3	TT	6:00-10:00pm	SCC E153	P Krochalk	\$420
-------	---------	----	----------------------------	---	----	--------------	----------	------------	-------

Aug 8, 10, 15, 17, 22, 24
F 6:00-10:00pm
25-Aug-00 only
S 9:00-5:00pm
Aug 12 & 19 only

HIS History FIRST SESSION

30309	HIS 301	11	Inv, Fam, & Comm in Hist Persp	3	MW	6:00-9:50pm	SBS B203	E Endrijonas	\$420
-------	---------	----	--------------------------------	---	----	-------------	----------	--------------	-------

HUM Humanities FIRST SESSION

30204	HUM 200	11	Intro To Humanities Prereq: ENG 111 or equivalent	3	TT	9:00-12:50pm	LCH A229	P Rodney	\$420
30230	HUM 312	11	Key Movements: Afr Lit & Cult Prereq: HUM 200 or equivalent (lower div General Education)	3	MTW	9:00-11:30am	SBS G122	M Furusa	\$420

SECOND SESSION

30203	HUM 310	21	Key Cncpts:Power of Masks Prereq: HUM 200 or equivalent (lower div General Education)	3	MW	9:00-12:50pm	LCH A228	W DeLuca	\$420
30207	HUM 310	22	Key Cncpts:War & Human Exp Prereq: HUM 200 or equivalent (lower div General Education)	3	TT	9:00-12:50pm	LCH A228	L Luciano	\$420

INTENSIVE

30314	HUM 314	61	Art as Social Protest Prereq: HUM 200 or equivalent (lower div General Education)	3	TT S	6:00-9:50pm 9:00-2:00pm	TBA 6/3, 10 & 17	D Brooking	\$420
-------	---------	----	--	---	---------	----------------------------	---------------------	------------	-------

INTERNET

HUM 310	41		Key Cncpts:Success &Values in U.S. Email instructor for approval to register: HHolter@DHVX20.csudh.edu Prereq: HUM 200 or equivalent (lower div General Education)	3	TBA		TBA TBA	H Holter	\$435
---------	----	--	--	---	-----	--	---------	----------	-------

IDS Interdisciplinary Studies FIRST SESSION

30363	IDS 350	11	Environment & Human Disease Proc	3	TT	6:00-9:50pm	SBS E220	C Jacobs	\$420
-------	---------	----	----------------------------------	---	----	-------------	----------	----------	-------

NOTES: For independent study/internships, please contact your department chair or program coordinator. For additions to this bulletin after publication, please call (310) 243-3741 or check the web site: www.csudh.edu/extendeded/

Crn #	Dept	Sec	COURSE TITLE	Units	Days	Hours	Room #	Instructor	Fee
LIB Liberal Studies									
FIRST SESSION									
30206	LBS 200	11	Intro to Liberal Studies	1	TT	4:00-5:15pm 06-Jun-00-13-Jul-00	SAC 1107	M Frank	\$140
SECOND SESSION									
30208	LBS 400	21	Senior Seminar in Lib. Studies	2	TT	2:00-4:00pm 27-Jun-00-3-Aug-00	SOE 1120	S Mercer	\$280
INTENSIVE									
30205	LBS 200	61	Intro to Liberal Studies	1	M	1:00-4:45pm 17-Jul-00-7-Aug-00	SBS G122	J McGowan	\$140
MGT Management									
FIRST SESSION									
30214	MGT 312	11	Organizational Behavior	3	MW	1:00-4:50pm 05-Jun-00-12-Jul-00	SBS D121	J Britt	\$420
30216	MGT 490	11	Strategic Management Seminar	3	MW	9:00-12:50pm 05-Jun-00-12-Jul-00	SBS D121	J Britt	\$420
SECOND SESSION									
30066	MGT 590	21	Strategic Management	3	TT	6:00-9:50pm 27-Jun-00-3-Aug-00	SBS B209	H Milgrim	\$420
INTENSIVES									
30213	MGT 310	61	Management Theory	3	MWT	6:00-9:50pm 05-Jun-00-29-Jun-00	SBS E116	R Mills	\$420
30215	MGT 490	61	Strategic Management Seminar	3	MW	6:00-9:50pm 12-Jun-00-19-Jul-00	SBS D121	J Britt	\$420
Online MBA									
30328	MGT 590	41	Strategic Management Graduate Standing, Consent of Instructor or Department Contact: Ken Poertner (310) 243-3165	3	TBA	TBA 03-April-00-26-Jun-00	TBA	D Karber	\$800
MFT Marital & Family Therapy									
FIRST SESSION									
30199	MFT 576	11	Human Communication Graduate Standing, Consent of Instructor or Department	3	TT	1:00-4:50pm 06-Jun-00-13-Jul-00	SBS D219	H Charnofsky	\$420
30201	MFT 580	11	Cross-Cul Fam Val & Beh Graduate Standing, Consent of Instructor or Department	3	TT	6:00-9:50pm 06-Jun-00-13-Jul-00	SBS D219	H Charnofsky	\$420
MKT Marketing									
Online MBA									
30330	MKT 500	41	Strategic Marketing Graduate Standing, Consent of Instructor or Department Contact: Ken Poertner (310) 243-3165	3	TBA	TBA 03-April-00-26-Jun-00	TBA	J Selecky	\$800
MAT Mathematics									
FIRST SESSION									
30340	MAT 003	11	Beginning Algebra	3	MW	8:00-12:50pm 05-Jun-00-12-Jul-00	SBS F125	Staff	\$450
30341	MAT 003	12	Beginning Algebra	3	MW	5:00-9:50pm 05-Jun-00-12-Jul-00	LCH A228	Staff	\$450
30342	MAT 009	11	Intermediate Algebra	3	MW	8:00-12:50pm 05-Jun-00-12-Jul-00	SBS B209	Staff	\$450
30343	MAT 009	12	Intermediate Algebra	3	MW	5:00-9:50pm 05-Jun-00-12-Jul-00	SBS E122	Staff	\$450
30344	MAT 105	11	Finite Mathematics	3	MW	5:00-8:50pm 05-Jun-00-12-Jul-00	SAC 3142	Staff	\$420
30346	MAT 107	11	Mathematics for Elementary Teachers Real Numbers	3	TT	5:00-8:50pm 06-Jun-00-13-Jul-00	SBS B203	Wilkins	\$420
30347	MAT 131	11	Elementary Statistics & Probability	3	TT	9:00-12:50pm 06-Jun-00-13-Jul-00	SBS B203	Staff	\$420
30348	MAT 191	11	Calculus I	4	MWT	6:00-9:20pm 05-Jun-00-13-Jul-00	SAC 3152	Staff	\$560
30349	MAT 207	11	Mathematics for Elementary Teachers Geometry	3	TWT	4:00-5:35pm 06-Jun-00-13-Jul-00	SCC J146	Anderson	\$435
30350	MAT 207A	11	Mathematics for Elementary Teachers Geometry	0	TWT	5:40-7:20pm 06-Jun-00-13-Jul-00	SCC J146	Anderson	\$0
Co-Req: MAT 207A & Fulfillment of ELM requirement									
Co-Req: MAT 207 & Fulfillment of ELM requirement									

NOTES: For independent study/internships, please contact your department chair or program coordinator. For additions to this bulletin after publication, please call (310) 243-3741 or check the web site: www.csudh.edu/extendeded/

Crn #	Dept	Sec	COURSE TITLE	Units	Days	Hours	Room #	Instructor	Fee
SECOND SESSION									
30351	MAT 003	23	Beginning Algebra	3	TT	8:00-12:50pm	SBS B231	Staff	\$450
30352	MAT 003	24	Beginning Algebra	3	TT	5:00-9:50pm	SAC 3141	Staff	\$450
30353	MAT 003	25	Beginning Algebra	3	MW	8:00-12:50pm	SBS A204	Staff	\$450
30354	MAT 009	23	Intermediate Algebra	3	TT	8:00-12:50pm	SBS D219	Staff	\$450
30355	MAT 009	24	Intermediate Algebra	3	TT	5:00-9:50pm	SBS A216	Staff	\$450
30356	MAT 153	21	College Algebra & Trigonometry	4	MWT	6:00-9:20pm	SCC E167	Staff	\$560
30357	MAT 193	21	Calculus II	4	MWT	6:00-9:20pm	SCC E173	Staff	\$560
THIRD SESSION									
30358	MAT 009	01	Intermediate Algebra	3	MW	8:00-12:50pm	SBS B203	Staff	\$450
30359	MAT 009	02	Intermediate Algebra	3	MW	5:00-9:50pm	SBS B203	Staff	\$450
30360	MAT 105	01	Finite Mathematics	3	TT	6:00-9:50pm	SBS E220	Staff	\$420
30490	MAT 107	01	Mathematics for Elementary Teachers	3	TWT	6:00-9:20pm	SAC 1107	Staff	\$420
30361	MAT 131	01	Elementary Statistics & Probability	3	MW	9:00-12:50pm	SBS D121	Staff	\$420
30362	MAT 171	01	Survey of Calculus for Management & Life Sciences	4	TWT	6:00-9:20pm	SBS B131	Staff	\$560
MUS Music									
FIRST SESSION									
30159	MUS 494S	11	Independent Study	1	TBA	TBA	TBA TBA	D Champion	\$140
30160	MUS 494S	12	Independent Study	2	TBA	TBA	TBA TBA	D Champion	\$280
30161	MUS 494S	13	Independent Study	3	TBA	TBA	TBA TBA	D Champion	\$420
30171	MUS 496S	11	Music Internship	1	TBA	TBA	TBA TBA	D Champion	\$140
30172	MUS 496S	12	Music Internship	3	TBA	TBA	TBA TBA	D Champion	\$420
30178	MUS 594S	11	Independent Study	1	TBA	TBA	TBA TBA	D Champion	\$140
30179	MUS 594S	12	Independent Study	2	TBA	TBA	TBA TBA	D Champion	\$280
30180	MUS 594S	13	Independent Study	3	TBA	TBA	TBA TBA	D Champion	\$420
SECOND SESSION									
30162	MUS 494S	21	Independent Study	1	TBA	TBA	TBA TBA	D Champion	\$140
30163	MUS 494S	22	Independent Study	2	TBA	TBA	TBA TBA	D Champion	\$280
30164	MUS 494S	23	Independent Study	3	TBA	TBA	TBA TBA	D Champion	\$420
30173	MUS 496S	21	Music Internship	1	TBA	TBA	TBA TBA	D Champion	\$140
30174	MUS 496S	22	Music Internship	3	TBA	TBA	TBA TBA	D Champion	\$420
30181	MUS 594S	21	Independent Study	1	TBA	TBA	TBA TBA	D Champion	\$140
30182	MUS 594S	22	Independent Study	2	TBA	TBA	TBA TBA	D Champion	\$280
30183	MUS 594S	23	Independent Study	3	TBA	TBA	TBA TBA	D Champion	\$420
THIRD SESSION									
30168	MUS 494S	01	Independent Study	1	TBA	TBA	TBA TBA	D Champion	\$140
30169	MUS 494S	02	Independent Study	2	TBA	TBA	TBA TBA	D Champion	\$280
30170	MUS 494S	03	Independent Study	3	TBA	TBA	TBA TBA	D Champion	\$420
30176	MUS 496S	01	Music Internship	1	TBA	TBA	TBA TBA	D Champion	\$140
30175	MUS 496S	02	Music Internship	3	TBA	TBA	TBA TBA	D Champion	\$420

NOTES: For independent study/internships, please contact your department chair or program coordinator. For additions to this bulletin after publication, please call (310) 243-3741 or check the web site: www.csudh.edu/extendeded/

Crn #	Dept	Sec	COURSE TITLE	Units	Days	Hours	Room #	Instructor	Fee
30184	MUS 594S	01	Independent Study	1	TBA	TBA	TBA TBA	D Champion	\$140
30185	MUS 594S	02	Independent Study	2	TBA	TBA	TBA TBA	D Champion	\$280
30186	MUS 594S	03	Independent Study	3	TBA	TBA	TBA TBA	D Champion	\$420

INTERNET

MUS 101	41		Introducing Music	3	TBA	TBA	TBA TBA	D Champion	\$435
---------	----	--	-------------------	---	-----	-----	---------	------------	-------

Contact the Instructor for the CRN & Approval to register: <http://MUSIC2.CSUDH.EDU/MUSIC101>

PED Physical Education INTENSIVES

30307	PED 425	61	PE in the Elementary School	3	MTWT	9:00-12:00pm	FH D003	M Ernst	\$440
			Co-requisite: PED 425A (30308)			10-Jul-00-3-Aug-00	\$5 Activity Fee		
30308	PED 425A	61	PE in the Elementary School	0	MTWT	9:00-12:00pm	FH D003	M Ernst	\$0
			Co-requisite: PED 425 (30307)			10-Jul-00-3-Aug-00			
30306	PED 516	61	Public Relations in PE	3	MTWT	6:00-10:00pm	SAC 3141	C Casten	\$420
						01-Jun-00-20-Jun-00			

PHI Philosophy FIRST SESSION

30335	PHI 120	11	Critical Reasoning	3	MTW	6:00-8:30pm	SAC 3148	R Vanderpool	\$420
						06-Jun-00-12-Jul-00			

PHY Physics FIRST SESSION

30058	PHY 108	11	Physical Science II	3	MW	4:00-6:10pm	SBS A210	K Lee	\$450
			Co-requisite: PHY 108L (30059)			05-Jun-00-12-Jul-00			
30059	PHY 108L	11	Physical Science II Lab	0	MW	6:15-9:30pm	NSM C243	K Lee	\$0
			Co-requisite: PHY 108 (30058)			05-Jun-00-12-Jul-00			

POL Political Science FIRST SESSION

30165	POL 101	11	American Institutions	3	TT	6:00-9:50pm	SAC 1107	A Fisher	\$420
						06-Jun-00-13-Jul-00			

PSY Psychology FIRST SESSION

30112	PSY 110	11	Crit Thinking & Prob Solv	3	MW	6:00-9:50pm	SBS A204	L Carrier	\$420
						05-Jun-00-12-Jul-00			
30113	PSY 235	11	Intro To Research Methods	3	MW	8:00-12:40pm	SBS A232	D Henschel	\$450
			Co-requisite: PSY 235L (30114)			05-Jun-00-12-Jul-00			
30114	PSY 235L	11	Intro To Resrch Meth-Lab	0	MW	8:00-12:40pm	SBS A232	D Henschel	\$0
			Co-requisite: PSY 235 (30113)			05-Jun-00-12-Jul-00			
30115	PSY 314	11	Behavior Modification	3	MTW	2:00-4:30pm	SBS A204	M Ortiz-Hurtado	\$420
						05-Jun-00-13-Jul-00			
30116	PSY 350	11	Developmental Psychology	3	MW	6:00-9:50pm	SBS B110	D Henschel	\$420
						05-Jun-00-12-Jul-00			
30119	PSY 396	11	Practicum In Psychology	3	T	5:00-9:50pm	SBS A246	R Davis	\$450
			Co-requisite: PSY 396S (30131)			06-Jun-00-11-Jul-00			
30131	PSY 396S	11	Practicum In Psychology	0	T	5:00-9:50pm	SBS A246	R Davis	\$0
			Co-requisite: PSY 396 (30119)			06-Jun-00-11-Jul-00			
30120	PSY 464	11	Intro To Clinical Psychology	3	TT	6:00-9:30pm	SBS B101	A Bohart	\$420
						06-Jun-00-13-Jul-00			
30121	PSY 496	11	Internship	6	Th	6:00-9:50pm	SBS A246	R Davis	\$840
			Co-requisite: PSY 496S (30132)			08-Jun-00-13-Jul-00			
30132	PSY 496S	11	Internship	0	Th	6:00-9:50pm	SBS A246	R Davis	\$0
			Co-requisite: PSY 496 (30121)			08-Jun-00-13-Jul-00			

SECOND SESSION

30117	PSY 101	21	Gen St: Understand Hum Beh	3	TT	9:00-12:15pm	SBS E220	L Gray-Shellberg	\$420
						27-Jun-00-3-Aug-00			
30122	PSY 563	21	Sem In Psychopathology	3	MW	6:00-9:30pm	SBS E220	A Bohart	\$420
			Graduate Standing, Consent of Instructor or Department			26-Jun-00-2-Aug-00			

THIRD SESSION

30123	PSY 567	01	Individual Assessment	3	TT	6:00-9:50pm	SBS B101	M Cartiglia	\$420
			Graduate Standing, Consent of Instructor or Department			18-Jul-00-24-Aug-00			

INTENSIVE

30118	PSY 360	61	Theories Of Personality	3	MTWT	1:00-4:50pm	SBS E220	L Gray-Shellberg	\$420
						05-Jun-00-22-Jun-00			

NOTES: For independent study/internships, please contact your department chair or program coordinator. For additions to this bulletin after publication, please call (310) 243-3741 or check the web site: www.csudh.edu/extendeded/

Crn #	Dept	Sec	COURSE TITLE	Units	Days	Hours	Room #	Instructor	Fee
PUB Public Administration FIRST SESSION									
30219	PUB 305	11	Applied Stats In Pub Adm	3	TT	6:00-9:50pm 06-Jun-00-13-Jul-00	SBS G126	R Bittick	\$420
30220	PUB 434	11	Administrative Planning	3	MW	6:00-9:50pm 05-Jun-00-12-Jul-00	SBS A216	F Smith	\$420
30478	PUB 508	11	Public Personnel & Labor Relations	4	TT	5:30-9:50pm 06-Jun-00-13-Jul-00	SBS B140	J Bell	\$560
30479	PUB 494S	11	Independent Study Prereq: Consent of Instructor	1	TBA	TBA 05-Jun-00-12-Jul-00	TBA	F Smith	\$140
QAS Quality Assurance INTENSIVES									
30237	QAS 495	71	Sel Top: Math for QAS Prereq: Consent of Instructor	1	S	8:00-12:00pm 02-Jun-00-25-Aug-00	SBS E122	Z Khwaja	\$145
30245	QAS 522	71	Appl Sys Reli Maintain & Safe Prereq: Graduate Standing	3	F	4:00-7:00pm 02-Jun-00-25-Aug-00	SBS B131	Z Khwaja	\$435
INTERNET MSQA									
30085	QAS 495	41	Sel Top: Math for QAS Prereq: Consent of Instructor	1	TBA	TBA 13-Jun-00-25-Jul-00	TBA TBA	M Manning	\$435
30238	QAS 510	41	Adv Probability/Statistics Prereq: Graduate Standing	3	TBA	TBA 25-Apr-00-01-Aug-00	TBA TBA	M Manning	\$435
30239	QAS 511	41	Quality Project Mgmt & TQM Prereq: Graduate Standing	3	TBA	TBA 25-Apr-00-01-Aug-00	TBA TBA	W Trappen	\$435
30240	QAS 512	41	Reliability Prereq: Graduate Standing	3	TBA	TBA 25-Apr-00-01-Aug-00	TBA TBA	D Dunahay	\$435
30241	QAS 513	41	Stat Qual Control/Sampling Prereq: Graduate Standing	3	TBA	TBA 25-Apr-00-01-Aug-00	TBA TBA	D Dunahay	\$435
30242	QAS 515	41	Human Factors in QAS Prereq: Graduate Standing	3	TBA	TBA 25-Apr-00-01-Aug-00	TBA TBA	J Clauson	\$435
30244	QAS 518	41	Quality Project Mgmt & Prod Prereq: Graduate Standing	3	TBA	TBA 25-Apr-00-01-Aug-00	TBA TBA	W Trappen	\$435
30247	QAS 594S	41	Ind Study in Assurance Science Prereq: Graduate Standing/Cons of Inst/Dept	3	TBA	TBA 25-Apr-00-01-Aug-00	TBA TBA	E Watson	\$435
30248	QAS 595	41	Spec Top: Thesis Preparation Prereq: Graduate Standing	3	TBA	TBA 25-Apr-00-01-Aug-00	TBA TBA	E Watson	\$435
30249	QAS 595	42	Spec Top: ISO 900X & Audit Function Prereq: Graduate Standing	3	TBA	TBA 25-Apr-00-01-Aug-00	TBA TBA	W Trappen	\$435
30250	QAS 595	43	Spec Top: Change Management Prereq: Graduate Standing	3	TBA	TBA 25-Apr-00-01-Aug-00	TBA TBA	S McFerran	\$435
30477	QAS 595	44	QA in Clinical Epidemiology	3	TBA	TBA 25-Apr-00-01-Aug-00	TBA TBA	A Hoffar	\$435
QMS Quantitative Methods FIRST SESSION									
30068	QMS 423	11	Intro Operations Research	3	TT	6:00-9:50pm 06-Jun-00-13-Jul-00	SBS F125	E Chu	\$420
SECOND SESSION									
30217	QMS 321	21	Intro To Bus Statistics	3	TT	1:00-4:50pm 27-Jun-00-3-Aug-00	SBS D121	S Cokelez	\$420
THIRD SESSION									
30218	QMS 322	01	Production Management	3	TT	6:00-9:50pm 18-Jul-00-24-Aug-00	SBS B203	F Rezyat	\$420
REC Recreation & Leisure Studies FIRST SESSION									
30092	REC 494S	11	Independent Study	1	TBA	TBA 05-Jun-00-14-Jul-00	TBA TBA	M Cappel	\$140
30093	REC 494S	12	Independent Study	2	TBA	TBA 05-Jun-00-14-Jul-00	TBA TBA	M Cappel	\$280
30094	REC 494S	13	Independent Study	3	TBA	TBA 05-Jun-00-14-Jul-00	TBA TBA	M Cappel	\$420
SECOND SESSION									
30097	REC 494S	21	Independent Study	1	TBA	TBA 26-Jun-00-4-Aug-00	TBA TBA	M Cappel	\$140
30098	REC 494S	22	Independent Study	2	TBA	TBA 26-Jun-00-4-Aug-00	TBA TBA	M Cappel	\$280
30099	REC 494S	23	Independent Study	3	TBA	TBA 26-Jun-00-4-Aug-00	TBA TBA	M Cappel	\$420

NOTES: For independent study/internships, please contact your department chair or program coordinator. For additions to this bulletin after publication, please call (310) 243-3741 or check the web site: www.csudh.edu/extendeded/

Crn #	Dept	Sec	COURSE TITLE	Units	Days	Hours	Room #	Instructor	Fee
THIRD SESSION									
30295	REC 494S	01	Independent Study	1	TBA	TBA	TBA TBA	M Cappel	\$140
30101	REC 494S	02	Independent Study	2	TBA	TBA	TBA TBA	M Cappel	\$280
30102	REC 494S	03	Independent Study	3	TBA	TBA	TBA TBA	M Cappel	\$420
INTENSIVES									
30095	REC 493	61	Dir Field Exper Rec/Leis Studies	3	TBA	TBA	TBA TBA	M Cappel	\$420
30435	REC 493S	61	Dir Field Exper Rec/Leis Studies	0	TBA	TBA	TBA TBA	M Cappel	\$0
30096	REC 496S	61	Internship in Therapeutic Rec	6	TBA	TBA	TBA TBA	M Cappel	\$840
SBS Social & Behavioral Sciences									
FIRST SESSION									
30364	SBS 318	11	Cult Plur: Cult Diver in So Cal	3	TT	6:30-10:10pm	SBS D225	D Heifetz	\$420
30365	SBS 318	12	Ethnic Families Through Movies	3	MW	6:00-9:50pm	SCC E153	A Fisher	\$420
30366	SBS 318	13	Cult Plur: American Afrikan World	3	TT	1:00-4:50pm	SBS D225	K Person-Lynn	\$420
INTENSIVE									
30482	SBS 318	62	Cult Plur: Women in Global Perspct	3	FS	9:00-5:00pm	SBS D125	S Carrigan	\$420
SMT Science, Math and Technology									
INTENSIVE									
30057	SMT 310	61	Science And Technology	3	MTWT	9:00-12:50pm	NSM D129	G Wiger	\$420
SOC Sociology									
FIRST SESSION									
30368	SOC 365	11	Deviant Behavior	3	TT	1:00-4:50pm	SBS B203	S Fellows	\$420
30369	SOC 563	11	Sem in Soc of Alc&Drug Use Graduate Standing	3	TT	9:00-12:50pm	SBS A144	S Fellows	\$420
INTENSIVE									
30370	SOC 331	61	Minority Racial & Ethnic Relations	3	MT W	1:00-4:50pm	SBS F101	M Hunter	\$420
SPA Spanish									
FIRST SESSION									
30138	SPA 305	11	Adv Comp Syntax Stylistcs	3	MT W	3:00-5:30pm	FH C008	J Arancibia	\$420
30137	SPA 351	11	Cnt Hisp Cult Spa Spk Am	3	MTWT	7:20-9:20pm	LCH A227	L Watts	\$420
SECOND SESSION									
30133	SPA 314	21	Spanish Phonology	3	MTWT	4:00-6:00pm	LCH A227	L Watts	\$420
THIRD SESSION									
30134	SPA 230	01	Spanish Conversation	3	MTWT	3:00-4:55pm	SBS A204	B Gomez	\$420
30135	SPA 350	01	Contemp Hisp Cult Spain	3	MTWT	5:00-6:55pm	SAC 2101	B Gomez	\$420
INTENSIVES									
30136	SPA 400	61	School Subj Matter Spanish	3	MTWT	3:00-6:50pm	LCH A227	L Watts	\$420
30139	SPA 435	61	Socioling App Mex-Am Dial	3	MTWT	2:30-6:20pm	LCH A219	M Dominguez	\$420
TED Teacher Education									
For independent study and/or internships, please contact Sharon Russell, SOE 1035 (310) 243-2703.									
SECOND SESSION									
30268	TED 406	21	Teaching Secondary Reading	3	MW	4:00-7:45pm	SBS B231	J Davis	\$420
30273	TED 410	21	Elementary Math Methods	2	TT	9:30-12:00pm	SCC E167	L Neuberger	\$280
30282	TED 467	21	Teach Meth I: Secondary	3	MW	4:00-7:45pm	SOE 1107	B Weikel	\$420

NOTES: For independent study/internships, please contact your department chair or program coordinator. For additions to this bulletin after publication, please call (310) 243-3741 or check the web site: www.csudh.edu/extendeded/

Cr #	Dept	Sec	COURSE TITLE	Units	Days	Hours	Room #	Instructor	Fee
30281	TED 469	21	Interdisciplinary Methods	3	TT	4:00-7:45pm 27-Jun-00-3-Aug-00	SBS B231	R Spitzer	\$420
INTENSIVES									
30263	TED 304	63	Foundations In Education	1	TWT	4:00-5:39pm 27-Jun-00-18-Jul-00	SBS B215	J Gust	\$140
30261	TED 304	62	Foundations In Education	1	TWT	4:00-5:39pm 06-Jun-00-22-Jun-00	SAC 2107	R Gordon	\$140
30283	TED 304	64	Foundations In Education Take with TED 402-64 (30284)	1	S	9:00-4:30pm 10-Jun-00-17-Jun-00	SBS D125	C McDermott	\$140
30259	TED 304	61	Foundations In Education	1	S	9:00-4:30pm 08-Jul-00-15-Jul-00	SBS D225	M Hare	\$140
30285	TED 305S	65	Intro to Urban/Multicul Class Take with TED 415-65 (30286)	1	TWT	4:00- 5:39pm 25-Jul-00-10-Aug-00	SAC 2103	J McGregor	\$140
30257	TED 305S	64	Intro to Urban/Multicul Class Take with TED 415-64 (30258)	1	TWT	4:00- 5:39pm 06-Jun-00-22-Jun-00	SAC 2101	K Trimble	\$140
30255	TED 305S	63	Intro to Urban/Multicul Class Take with TED 415-63 (30256)	1	S	9:00-4:30pm 22-Jul-00-29-Jul-00	SBS D125	R Gordon	\$140
30253	TED 305S	62	Intro to Urban/Multicul Class Take with TED 415-62 (30284)	1	S	9:00-4:30pm 10-Jun-00-17-Jun-00	SBS G122	Staff	\$140
30251	TED 305S	61	Intro to Urban/Multicul Class Take with TED 415-61 (30252)	1	TWT	4:00-5:39pm 27-Jun-00-18-Jul-00	SAC 2105	Staff	\$140
30260	TED 402	61	Motivation And Learning	2	MW	4:00-9:00pm 26-Jun-00-12-Jul-00	SBS D225	M Hare	\$280
30284	TED 402	64	Motivation And Learning Take with TED 304-64 (30283)	2	TT	4:00-9:00pm 06-Jun-00-22-Jun-00	SBS D125	E Horton	\$280
30262	TED 402	62	Motivation And Learning	2	TWT	5:40-9:00pm 06-Jun-00-22-Jun-00	SAC 2107	R Gordon	\$280
30264	TED 402	63	Motivation And Learning	2	TWT	5:40-9:00pm 27-Jun-00-18-Jul-00	SBS B215	J Gust	\$280
30266	TED 405	62	Mainstream Ch/Spec Need	3	TWT	4:00-9:00pm 27-Jun-00-8-Jul-00	SBS B131	D Wolff	\$420
30267	TED 405	63	Mainstream Ch/Spec Need	3	TWT	4:00-9:00pm 05-Jul-00-25-Jul-00	SBS A144	P Patterson	\$420
30265	TED 405	61	Mainstream Ch/Spec Need	3	MW	4:00-9:00pm 05-Jun-00-21-Jun-00	SBS B131	D Wolff	\$420
30270	TED 407	62	Language Learning	3	MWT	4:00-9:00pm 26-Jun-00-13-Jul-00	SAC 2107	D Brassell	\$420
30269	TED 407	61	Language Learning	3	MWT	4:00-9:00pm 05-Jun-00-22-Jun-00	SAC 2105	J Lalas	\$420
30271	TED 408	61	Elem Methods In Art/Music Prereq: Consent of Dept	2	TT	4:00-9:00pm 06-Jun-00-22-Jun-00	SBS A144	J Cantor	\$280
30272	TED 409A	61	Elem Methods In Phy Educ	1	TT	5:00-7:30pm 20-Jun-00-11-Jul-00	GYM A104	Staff	\$145
30274	TED 410	61	Elementary Math Methods	2	TWT	4:00-7:20pm 11-Jul-00-27-Jul-00	SBS E116	G Brockman	\$280
30296	TED 412	61	El Soc Stud/Cont Readwrit Prereq: Consent of Dept	2	MW	4:00-9:00pm 05-Jun-00-21-Jun-00	SBS A144	J Cantor	\$280
30252	TED 415	61	Multic Perspective Tchrs Take with TED 305S-61(30251)	2	TWT	5:40-9:00pm 27-Jun-00-18-Jul-00	SAC 2105	Staff	\$280
30258	TED 415	64	Multic Perspective Tchrs Take with TED 305S-64 (30257)	2	TWT	5:40-9:00pm 06-Jun-00-22-Jun-00	SAC 2101	K Trimble	\$280
30286	TED 415	65	Multic Perspective Tchrs Take with TED 305S-65 (30285)	2	TWT	5:40-9:00pm 25-Jul-00-10-Aug-00	SAC 2103	J McGregor	\$280
30256	TED 415	63	Multic Perspective Tchrs Take with TED 305S-63 (30255)	2	TT	4:00-9:00pm 18-Jul-00-03-Aug-00	SBS D125	Staff	\$280
30254	TED 415	62	Multic Perspective Tchrs Take with TED 305S-62 (30253)	2	MW	4:00-9:00pm 05-Jun-00-21-Jun-00	SBS G122	Staff	\$280
30275	TED 416	61	Elementary Science Methods	2	MW	4:30-9:30pm 5-Jun-00-21-Jun-00	SBS B137	D Dulyea	\$280
30276	TED 416	62	Elementary Science Methods	2	TT	1:30-4:30pm 06-Jul-00-5-Aug-00	SCC E153	L Neuberger	\$280
30278	TED 420	62	Computer Literacy For Teachers	1	MW	5:00-7:45pm 10-Jul-00-26-Jul-00	SOE 1117	P Desberg	\$145
30277	TED 420	61	Computer Literacy For Teachers	1	MW	5:00-7:45pm 19-Jun-00-5-Jul-00	SOE 1117	P Desberg	\$145
30279	TED 420	63	Computer Literacy For Teachers	1	S	9:00-2:00pm 10-Jun-00-24-Jun-00	SOE 1117	N Mach	\$145
30280	TED 420	64	Computer Literacy For Teachers	1	S	9:00-2:00pm 10-Jun-00-24-Jun-00	SCC E139	J Zarro	\$145

TVA Television Arts INTENSIVES

	TVA 495	61	Spec Topics: Entertainment Industry Contact G. Vinovich at (310) 243-3945 for more information	3	TWT	6:00-9:50pm 06-Jun-00-29-Jun-00		G Vinovich	\$420
30474	TVA 427A	61	Independent TV Production	3	M	6:00-9:50pm 05-Jun-00-21-Aug-00	LCH A209	G Vinovich	\$435

NOTES: For independent study/internships, please contact your department chair or program coordinator. For additions to this bulletin after publication, please call (310) 243-3741 or check the web site: www.csudh.edu/extendeded/

Cr #	Dept	Sec	COURSE TITLE	Units	Days	Hours	Room #	Instructor	Fee
THE Theatre Arts FIRST SESSION									
30333	THE 120	11	Fundamentals of Speech Co-requisite: THE 120A (30334)	2	MTWT	1:00-3:30pm 06-Jun-00-23-Jun-00	UT A102	P Rodney	\$290
30334	THE 120A	11	Fundamentals of Speech Co-requisite: THE 120 (30333)	0	MTWT	1:00-3:30pm 06-Jun-00-23-Jun-00	UT A102	P Rodney	\$0
30225	THE 337	11	Creative Dramatics Co-requisite: THE 337A (30226)	3	TT	4:00-6:50pm 06-Jun-00-13-Jul-00	LCH A228	S Weiner	\$435
30226	THE 337A	11	Creative Dramatics Co-requisite: THE 337 (30225)	0	TT	4:00-6:50pm 06-Jun-00-13-Jul-00	LCH A228	S Weiner	\$0
INTENSIVE									
30227	THE 320	61	Speech Skills & Techniques	3	MTWT	6:00-9:50pm 26-Jun-00-13-Jul-00	SAC 2101	R Heuschkel	\$420

Elementary School Classroom Teachers & Specialists can take the state-required course **PED 425**

(also appropriate for PACE Students)

Online this fall!

Now Available:

MA in Education: Physical Education, Administration Option

For more information call (310) 243-3761

An Extension Course:

TEX 900-01 Grant Writing for Educators

2 CEUs CRN 30491

Fred Rodriguez, CSUDH faculty.

6 mtgs: TTh, Sa Aug 8-19 ; TTh: 6:00-9:00pm; Sa 9:00am-1:00pm
CSUDH SBS D125

\$145

Call (310) 243-3741 for more information

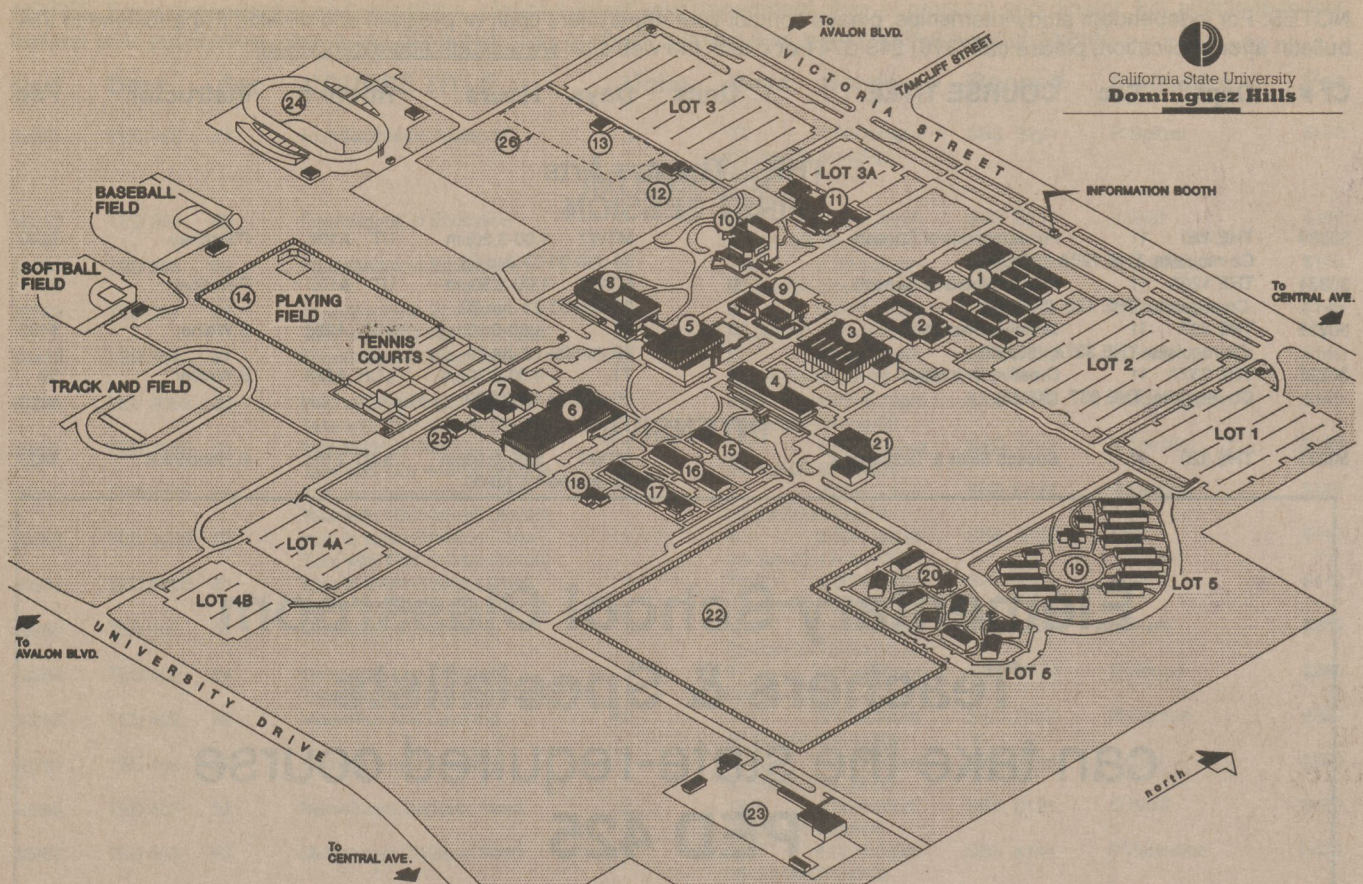

California State University, Dominguez Hills General Legend

CDC 12	Child Development Center	HC 25	Hughes Education and Athletic Center – Athletic Offices, Arthur Ashe Safe Passage Program	OPE 14	Outdoor Physical Education	SH 19	Student Housing – Buildings A through O
CMS 18	California Academy of Mathematics and Science Laboratory	ITC 12	Infant Toddler Center	PP 23	Physical Plant (receiving Warehouse)	SH 20	Student Housing – Buildings P through X
CP 21	Central Utility Plant	LCH 8	LaCorte Hall – School of Health, Art Gallery	SAC1 15	South Academic Complex 1	SHC 11	Student Health Center
ERC 5	Cain Educational Resources Center – Library, Central Administrative Offices, Distance Learning, Instructional Media	NHP 22	Natural History Preserve	SAC2 16	South Academic Complex 2 – California Academy of Mathematics and Science	SOE 2	School of Education
FH 7	Field House (Athletics)	NSM 4	Natural Science and Mathematics – College of Arts and Sciences Administration	SAC3 17	South Academic Complex 3 – California Academy of Mathematics and Science	USU 9	Donald P. and Katherine B. Loker University Student Union
GYM 6	Gymnasium	N-TRL 13	Nursing Trailer (Temporary) – International Nursing Program	SBS 3	Social and Behavioral Sciences – School of Management, Shinwa Japanese Garden	UT 10	University Theatre
				SCC 1	Small College Complex	VEL 24	Olympic Velodrome
						26	Future Site: Extended Education and University Foundation

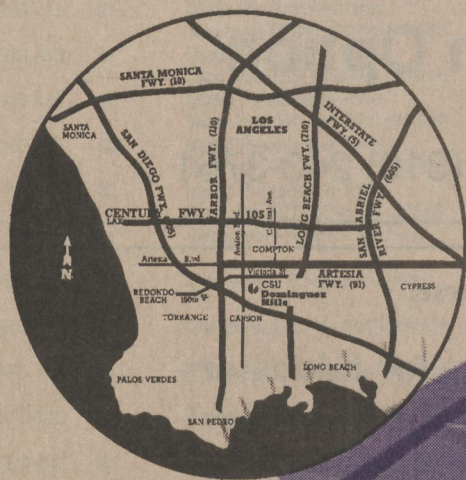

Register at the new home of Extended Education, at the western end of the campus. Enter at the Tamcliff stoplight, and turn right. You'll see the Extended Education Complex across Lot 3. The Registration Building is on the left.

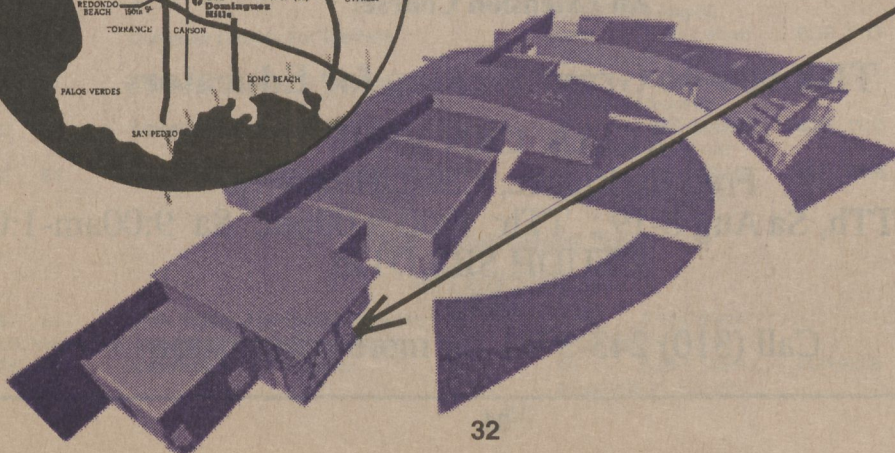

Summer Sessions

Registration Form

Social Security No: _____ Birthdate: _____ Date of Application _____
month/day/year

Name: _____
Last First M.I.

Address: _____
Street City State Zip

Telephone: _____ Email: _____
Daytime Evening Fax

New Address? yes no male female Enrolled at CSUDH previously? yes no

SCHEDULE #	DEPARTMENT	COURSE	SECTION	UNITS	COURSE FEE	INSTRUCTOR/DEPT CONSENT

Check/Money Order, Made Payable to CSUDH
I AUTHORIZE THE USE OF MY VISA MasterCard Discover Card

NAME ON CARD _____

ACCOUNT NUMBER _____ EXP DATE _____
I have read and understand the rules in the Summer Sessions Bulletin regarding registration, course prerequisites, refund policy and withdrawal policy, and I authorize the use of credit card number if entered above.

Signature: _____

Date: _____

Course Fee _____

Student Activity Fee _____ 3.00 (Mandatory)

Student Center Fee _____ 10.00 (Mandatory)

ITFS Fee _____

Late Fee _____

TOTAL FEE SUBMITTED _____

HOW TO REGISTER

MAIL OR STOP BY:



CSU DOMINGUEZ HILLS,
EXTENDED EDUCATION,
EE 1100,
1000 EAST VICTORIA STREET
CARSON, CA 90747-0005

FAX REGISTRATION:
(310) 516-3971



2-101



California State University
Dominguez Hills



DIVISION OF EXTENDED EDUCATION

1000 EAST VICTORIA STREET
CARSON, CA 90747

Non-Profit Organization
U.S. Postage
PAID
Permit No. 246
Gardena, CA

CSUDH certificate programs can give your career a wake-up call!

California State University, Dominguez Hills has degree programs, certificate programs and special interest classes designed to enhance your career and quality of life, delivered on campus, over TV & online. Certificate Programs with classes beginning this summer include:

Alcohol & Drug Counseling, Child Care Provider, Production & Inventory Control, Purchasing, Advanced Human Resource Management, Construction Management, Medical Insurance Billing, Occupational & Environmental Health & Safety, Safety & Security, Technical Writing, Internet, and much more!

Call (310) 243-3741 for a FREE Summer Extension Bulletin!

**New Course in
e-Commerce!**

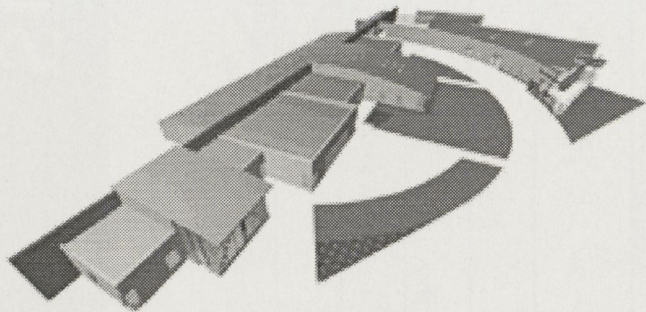

Now!
**Registration for Summer
Sessions and Extension Courses
has moved to our new home on
the west side of the campus.**